

Oklahoma Corporation Commission  
Oil & Gas Conservation Division  
Post Office Box 52000  
Oklahoma City, Oklahoma 73152-2000  
Rule 165: 10-3-25

Form 1002A

API No.: 35073250450001

**Completion Report**

Spud Date: November 11, 2017

OTC Prod. Unit No.: 073-223635

Drilling Finished Date: November 26, 2017

1st Prod Date: March 15, 2018

Completion Date: February 08, 2018

**Drill Type: HORIZONTAL HOLE**

Well Name: LINCOLN NORTH UNIT 83-2H-0

Purchaser/Measurer:

Location: KINGFISHER 4 17N 5W  
N2 S2 N2 NW  
940 FNL 1320 FWL of 1/4 SEC  
Latitude: 35.9830554 Longitude: -97.742327469  
Derrick Elevation: 0 Ground Elevation: 1116

First Sales Date:

Operator: HINKLE OIL & GAS INC 21639

5600 N MAY AVE STE 295  
OKLAHOMA CITY, OK 73112-4275

Completion Type	
X	Single Zone
	Multiple Zone
	Commingle

Location Exception	
Order No	
There are no Location Exception records to display.	

Increased Density	
Order No	
There are no Increased Density records to display.	

Casing and Cement							
Type	Size	Weight	Grade	Feet	PSI	SAX	Top of CMT
CONDUCTOR	16			76		8	SURFACE
SURFACE	9 5/8	36	J-55	418		300	SURFACE
PRODUCTION	7	29	P-110	6676		280	4824

Liner								
Type	Size	Weight	Grade	Length	PSI	SAX	Top Depth	Bottom Depth
LINER	4 1/2	13.5	P-110	6495	0	435	6072	12567

**Total Depth: 12567**

Packer	
Depth	Brand & Type
6129	MODEL R

Plug	
Depth	Plug Type
There are no Plug records to display.	

Initial Test Data
-------------------

Test Date	Formation	Oil BBL/Day	Oil-Gravity (API)	Gas MCF/Day	Gas-Oil Ratio Cu FT/BBL	Water BBL/Day	Pumpin or Flowing	Initial Shut-In Pressure	Choke Size	Flow Tubing Pressure
Jun 28, 2018	OSWEGO	110	45.8	71	645	1117	FLOWING		OPEN	100

Completion and Test Data by Producing Formation									
Formation Name: OSWEGO				Code: 404OSWG			Class: OIL		
Spacing Orders				Perforated Intervals					
Order No		Unit Size		From			To		
119269		UNIT		12394			12404		
Acid Volumes				Fracture Treatments					
716,772 GALLONS 15% HCL				228,447 BARRELS SLICK WATER, 2,745,940 30/50 SAND					

Formation	Top
COTTAGE GROVE	5541
CHECKERBOARD	5917
CLEVELAND	5983
BIG LIME	6131
2ND OSWEGO	6215
3RD OSWEGO	6243
4TH OSWEGO	6266

Were open hole logs run? No  
Date last log run:  
  
Were unusual drilling circumstances encountered? No  
Explanation:

Other Remarks
OCC - THE COMPLETION INTERVAL IS WITHIN THE LEGAL LIMITS ALLOWED BY THE UNITIZATION.

Lateral Holes
Sec: 28 TWP: 18N RGE: 5W County: KINGFISHER  SE SE SW SW  308 FSL 1317 FWL of 1/4 SEC  Depth of Deviation: 5695 Radius of Turn: 2325 Direction: 1 Total Length: 4547  Measured Total Depth: 12567 True Vertical Depth: 6219 End Pt. Location From Release, Unit or Property Line: 308

FOR COMMISSION USE ONLY
<div>Status: Accepted</div> <div>1140413</div>

API NO. 073-25045  
OTC PROD. UNIT NO. Merge #1892  
073-223635

PLEASE TYPE OR USE BLACK INK ONLY  
NOTE:

Attach copy of original 1002A  
if recompletion or reentry.

OKLAHOMA CORPORATION COMMISSION  
Oil & Gas Conservation Division  
Post Office Box 52000  
Oklahoma City, Oklahoma 73152-2000  
Rule 165:10-3-25

RECEIVED

Form 1002A  
Rev. 2009

JUL 17 2018

OKLAHOMA CORPORATION  
COMMISSION

☒ ORIGINAL  
☐ AMENDED (Reason)

COMPLETION REPORT

TYPE OF DRILLING OPERATION

☐ STRAIGHT HOLE ☐ DIRECTIONAL HOLE ☒ HORIZONTAL HOLE  
☐ SERVICE WELL

If directional or horizontal, see reverse for bottom hole location.

COUNTY	Kingfisher	SEC	4	TWP	17N	RGE	05W
LEASE NAME	Lincoln North Unit			WELL NO.	83-2190-240	1st PROD DATE	3/15/2008
N2 1/4 S2 1/4 N2 1/4 NW 1/4	(FNL of 1/4 SEC) 940'			FWL OF 1/4 SEC	1320'	RECOMP DATE	
ELEVATION N Derrick	Ground	1116'	Latitude (if known)	35.9830554	Longitude (if known)	-97.742327469	
OPERATOR NAME	Hinkle Oil & Gas, Inc.			OTC/OCC OPERATOR NO.	21639		
ADDRESS	5600 N. May Avenue, Suite 295						
CITY	Oklahoma City	STATE	OK	ZIP	73112		

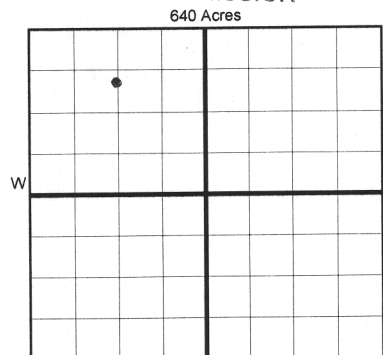

COMPLETION TYPE

<input checked="" type="checkbox"/> SINGLE ZONE
<input type="checkbox"/> MULTIPLE ZONE
Application Date
<input type="checkbox"/> COMMINGLED
Application Date
LOCATION
EXCEPTION ORDER
INCREASED DENSITY
ORDER NO.

CASING & CEMENT (Form 1002C must be attached)

TYPE	SIZE	WEIGHT	GRADE	FEET	PSI	SAX	TOP OF CMT
CONDUCTOR	16"			76'		8.5 yds	Surf.
SURFACE	9 5/8"	36#	J-55	418'		300	Surf.
INTERMEDIATE							
PRODUCTION	7"	29#	P110	6676'		280	4824'
LINER	4 1/2"	13.5#	P110	6072'--12,567'		435	6350'
						TOTAL DEPTH	12,567'

PACKER @ 6129' BRAND & TYPE Mod. R PLUG @ TYPE PLUG @ TYPE  
PACKER @ BRAND & TYPE PLUG @ TYPE PLUG @ TYPE

COMPLETION & TEST DATA BY PRODUCING FORMATION

FORMATION	Oswego						
SPACING & SPACING ORDER NUMBER	119269 (unit)						
CLASS: Oil, Gas, Dry, Inj, Disp, Comm Disp, Svc	Oil						
	12,394'-12,404'	6 spf					
PERFORATED INTERVALS							
ACID/VOLUME							
FRACTURE TREATMENT (Fluids/Prop Amounts)	228447 Bbl Sl. Wtr						
	2745940 30/50 Sd						
	716772 G. 15% HCL						

Monitor Report  
to Frac Focus

Min Gas Allowable (165:10-17-7) Gas Purchaser/Measurer  
OR First Sales Date  
Oil Allowable (165:10-13-3)

INITIAL TEST DATA

INITIAL TEST DATE	6/28/2018						
OIL-BBL/DAY	110						
OIL-GRAVITY ( API)	45.8						
GAS-MCF/DAY	71						
GAS-OIL RATIO CU FT/BBL	645						
WATER-BBL/DAY	1117						
PUMPING OR FLOWING	Flowing						
INITIAL SHUT-IN PRESSURE	N/A						
CHOKE SIZE	Open						
FLOW TUBING PRESSURE	100						

AS SUBMITTED

A record of the formations drilled through, and pertinent remarks are presented on the reverse. I declare that I have knowledge of the contents of this report and am authorized by my organization to make this report, which was prepared by me or under my supervision and direction, with the data and facts stated herein to be true, correct, and complete to the best of my knowledge and belief.

SIGNATURE	NAME (PRINT OR TYPE)	DATE	PHONE NUMBER
5600 N. May Avenue, Suite 295	Oklahoma City OK 73112	7/16/2018	405-848-0924
ADDRESS	CITY STATE ZIP	EMAIL ADDRESS	
		Laurahinkle@hoagi.com	

PLEASE TYPE OR USE BLACK INK ONLY  
FORMATION RECORD

Give formation names and tops, if available, or descriptions and thickness of formations drilled through. Show intervals cored or drillstem tested.

NAMES OF FORMATIONS	TOP
Cottage Grove	5541' TVD
Checkerboard	5917'
Cleveland	5983'
Big Lime	6131'
2nd Oswego	6215'
3rd Oswego	6243'
4th Oswego	6266'

LEASE NAME Lincoln North Unit WELL NO. 83-2HO

FOR COMMISSION USE ONLY		
ITD on file	<input type="checkbox"/> YES <input type="checkbox"/> NO	
APPROVED	DISAPPROVED	2) Reject Codes
<div></div> <div></div> <div></div> <div></div> <div></div>		

Were open hole logs run? ☐ yes ☒ no

Date Last log was run \_\_\_\_\_

Was CO<sub>2</sub> encountered? ☐ yes ☒ no at what depths? \_\_\_\_\_

Was H<sub>2</sub>S encountered? ☐ yes ☒ no at what depths? \_\_\_\_\_

Were unusual drilling circumstances encountered? ☐ yes ☒ no  
If yes, briefly explain below \_\_\_\_\_

Other remarks:

640 Acres

If more than three drainholes are proposed, attach a separate sheet indicating the necessary information.

Direction must be stated in degrees azimuth.  
Please note, the horizontal drainhole and its end point must be located within the boundaries of the lease or spacing unit.

Directional surveys are required for all drainholes and directional wells.

640 Acres

BOTTOM HOLE LOCATION FOR DIRECTIONAL HOLE

SEC	TWP	RGE	COUNTY
Spot Location	1/4	1/4	1/4
Measured Total Depth	True Vertical Depth	BHL From Lease, Unit, or Property Line:	

BOTTOM HOLE LOCATION FOR HORIZONTAL HOLE: (LATERALS)

LATERAL #1	SFC	TWP	RGE	COUNTY	Kingfisher
Spot Location	SE 1/4	SW 1/4	SW 1/4	SW 1/4	SW 1/4
Depth of Deviation	5695'	Radius of Turn	2325'	Direction	1 South
Measured Total Depth	12,567'	True Vertical Depth	6219'	BHL From Lease, Unit, or Property Line:	100' 308

LATERAL #2

SEC	TWP	RGE	COUNTY
Spot Location	1/4	1/4	1/4
Depth of Deviation	Radius of Turn	Direction	Total Length
Measured Total Depth	True Vertical Depth	BHL From Lease, Unit, or Property Line:	

LATERAL #3

SEC	TWP	RGE	COUNTY
Spot Location	1/4	1/4	1/4
Depth of Deviation	Radius of Turn	Direction	Total Length
Measured Total Depth	True Vertical Depth	BHL From Lease, Unit, or Property Line:	