

Oklahoma Corporation Commission  
Oil & Gas Conservation Division  
Post Office Box 52000  
Oklahoma City, Oklahoma 73152-2000  
Rule 165: 10-3-25

Form 1002A

API No.: 35051241000000

**Completion Report**

Spud Date: January 15, 2017

OTC Prod. Unit No.: 051-222731

Drilling Finished Date: July 11, 2017

1st Prod Date: November 23, 2017

Completion Date: November 23, 2017

**Drill Type: HORIZONTAL HOLE**

Well Name: NORTH CHEYENNE 3-10X3H

Purchaser/Measurer: `

Location: GRADY 10 4N 6W  
SE NE NE SW  
2305 FSL 2340 FWL of 1/4 SEC  
Latitude: 34.83304 Longitude: -97.81822  
Derrick Elevation: 0 Ground Elevation: 1173

First Sales Date: 11/23/2017

Operator: GULFPORT MIDCON LLC 24020

3001 QUAIL SPRINGS PKWY  
OKLAHOMA CITY, OK 73134-2640

Completion Type		Location Exception		Increased Density	
X	Single Zone	Order No		Order No	
	Multiple Zone	661321		662898	
	Commingle			663021	

Casing and Cement							
Type	Size	Weight	Grade	Feet	PSI	SAX	Top of CMT
SURFACE	20		J-55	737		805	SURFACE
INTERMEDIATE	13 3/8		J-55	3609		2055	844
INTERMEDIATE	9 5/8		J-55	12589		3035	4589
PRODUCTION	5 1/2 & 4 1/2		P-110	22907		895	11990

Liner								
Type	Size	Weight	Grade	Length	PSI	SAX	Top Depth	Bottom Depth
LINER	7		P-110	2890	0	444	12005	14895

**Total Depth: 22877**

Packer	
Depth	Brand & Type
There are no Packer records to display.	

Plug	
Depth	Plug Type
There are no Plug records to display.	

Initial Test Data
-------------------

Test Date	Formation	Oil BBL/Day	Oil-Gravity (API)	Gas MCF/Day	Gas-Oil Ratio Cu FT/BBL	Water BBL/Day	Pumpin or Flowing	Initial Shut-In Pressure	Choke Size	Flow Tubing Pressure
Jan 20, 2018	WOODFORD-HUNTON	343	56	10000	29178	2604	FLOWING	3617	34/64	

Completion and Test Data by Producing Formation

Formation Name: WOODFORD		Code: 319WDFD		Class: GAS	
Spacing Orders		Perforated Intervals			
Order No	Unit Size	From	To		
199355	640	15561	21048		
440798	640	21958	22779		
661729	MULTIUNIT				
Acid Volumes		Fracture Treatments			
1,822 BARRELS		375,992 BARRELS WATER, 16,018,521 POUNDS SAND			

Formation Name: HUNTON		Code: 269HNTN		Class: GAS	
Spacing Orders		Perforated Intervals			
Order No	Unit Size	From	To		
440798	640	21048	21958		
661729	MULTIUNIT				
Acid Volumes		Fracture Treatments			
428 BARRELS		54,267 BARRELT WATER, 2,025,596 POUNDS SAND			

Formation Name: WOODFORD-HUNTON		Code:		Class: GAS	

Formation	Top
WOODFORD	15306
HUNTON	21048

Were open hole logs run? No

Date last log run:

Were unusual drilling circumstances encountered? Yes

Explanation: WELL WAS SIDETRACKED AT APPROXIMATELY 12,274'. KOP SET 13,200', 415 SACKS CEMENT. CONDUCTOR SET 132'.

Other Remarks
OCC - REPUSH CORRECT PERFORATIONS ON WOODFORD. OCC - THIS DOCUMENT IS ACCEPTED BASED ON THE DATA SUBMITTED NEITHER THE FINAL LOCATION EXCEPTION NOR THE FINAL MULTIUNIT ORDERS HAVE BEEN ISSUED.

Lateral Holes
---------------

Sec: 3 TWP: 4N RGE: 6W County: GRADY

NW NW NE NW

64 FNL 1390 FWL of 1/4 SEC

Depth of Deviation: 14610 Radius of Turn: 900 Direction: 355 Total Length: 7517

Measured Total Depth: 22877 True Vertical Depth: 15210 End Pt. Location From Release, Unit or Property Line: 64

## FOR COMMISSION USE ONLY

1138810

Status: Accepted

API NO. 051-24100  
OTC PROD.  
UNIT NO.

PLEASE TYPE OR USE BLACK INK ONLY

NOTE:

Attach copy of original 1002A  
if recompletion or reentry.

OKLAHOMA CORPORATION COMMISSION  
Oil & Gas Conservation Division  
Post Office Box 52000  
Oklahoma City, Oklahoma 73152-2000  
Rule 165-10-3-25

RECEIVED

JAN 31 2018

OKLAHOMA CORPORATION  
COMMISSION

☒ ORIGINAL  
☐ AMENDED (Reason)

COMPLETION REPORT

TYPE OF DRILLING OPERATION

☐ STRAIGHT HOLE ☐ DIRECTIONAL HOLE ☒ HORIZONTAL HOLE  
☐ SERVICE WELL

If directional or horizontal, see reverse for bottom hole location.

COUNTY	Grady	SEC	10	TWP	04N	RGE	6W	SPUD DATE	1/15/17
LEASE NAME	North Cheyenne 3-10X3H							DATE OF WELL COMPLETION	11/23/17
1/4 SE 1/4 NE 1/4 NE 3/4 SW 1/4 SEC		2305	FWL OF 1/4 SEC		2340	1st PROD DATE		11/23/17	
ELEVATION	Ground	1173	Latitude (if known)		34.83304	Longitude (if known)		-97.81822	
OPERATOR NAME	Gulfport MidCon LLC							OTC/OCC OPERATOR NO.	24020
ADDRESS	3001 Quail Springs Parkway								
CITY	Oklahoma City	STATE	OK	ZIP	73134				

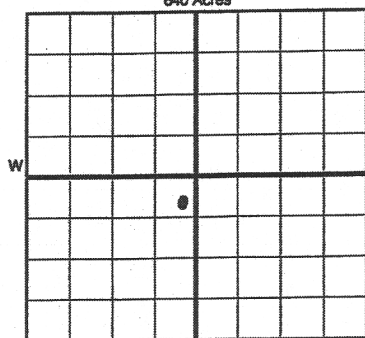

LOCATE WELL

COMPLETION TYPE

<input checked="" type="checkbox"/> SINGLE ZONE
<input type="checkbox"/> MULTIPLE ZONE
Application Date
<input type="checkbox"/> COMMINGLED
Application Date
LOCATION
EXCEPTION ORDER
INCREASED DENSITY
ORDER NO.

CASING & CEMENT (Form 1002C must be attached)

TYPE	SIZE	WEIGHT	GRADE	FEET	PSI	SAX	TOP OF CMT
SURFACE	20		J55	737		805	Surface
INTERMEDIATE	133/8		J55	3609		2055	844
INTERMEDIATE	9 5/8		J55	12,589		3035	4,589
PRODUCTION	5 1/2 4 1/2		P110	22907		895	11990
LINER	7		P110	12005-21127-14895		444	21,127-12005
						TOTAL DEPTH	22,877

PACKER @ BRAND & TYPE PLUG @ TYPE PLUG @ TYPE  
PACKER @ BRAND & TYPE PLUG @ TYPE PLUG @ TYPE

COMPLETION & TEST DATA BY PRODUCING FORMATION

FORMATION	(640) Woodford	Hunton	I.O.	Reported to
SPACING & SPACING ORDER NUMBER	199355 440798 (640)	440798 (640)	661729 (Multinif)	Fract Fracs
CLASS: Oil, Gas, Dry, Inj, Disp, Comm Disp, Svc	Gas	Gas		
PERFORATED INTERVALS	15561-21048	21048-21958		
	21958-22779			
ACID/VOLUME	1822bbl	428bbl		
FRACTURE TREATMENT (Fluids/Prop Amounts)	375,992bbl water	54,267bbl water		
	1bs sand 16,018,521	2,025,596 lbs Sand		

☐ Min Gas Allowable (165-10-17-7)  
OR  
☐ Oil Allowable (165-10-13-3)

Gas Purchaser/Measurer  
First Sales Date

11/23/2017

INITIAL TEST DATA

INITIAL TEST DATE	1/20/2018			
OIL-BBL/DAY	343			
OIL-GRAVITY (API)	56			
GAS-MCF/DAY	10,000			
GAS-OIL RATIO CU FT/BBL	29,178			
WATER-BBL/DAY	2,604			
PUMPING OR FLOWING	Flowing			
INITIAL SHUT-IN PRESSURE	3,617			
CHOKE SIZE	34/64			
FLOW TUBING PRESSURE	N/A			

AS SUBMITTED

A record of the formations drilled through, and pertinent remarks are presented on the reverse. I declare that I have knowledge of the contents of this report and am authorized by my organization to make this report, which was prepared by me or under my supervision and direction, with the data and facts stated herein to be true, correct, and complete to the best of my knowledge and belief.

SIGNATURE	Monica Pickens	DATE	1/25/2018	PHONE NUMBER	252-4703
ADDRESS	3001 Quail Springs Parkway	CITY	Oklahoma City	STATE	OK
		ZIP	73134	EMAIL ADDRESS	mpickens@gulfportenergy.com

PLEASE TYPE OR USE BLACK INK ONLY  
FORMATION RECORD

Give formation names and tops, if available, or descriptions and thickness of formations drilled through. Show intervals cored or drillstem tested.

NAMES OF FORMATIONS	TOP
Hunton	21048
Woodford	15306

LEASE NAME North Cheyenne WELL NO. 3-10X3H

FOR COMMISSION USE ONLY	
ITD on file <input type="checkbox"/> YES <input type="checkbox"/> NO	
APPROVED _____	DISAPPROVED _____
2) Reject Codes	
_____	
_____	
_____	
_____	

Were open hole logs run?	_____ yes <input checked="" type="checkbox"/> no
Date Last log was run	_____
Was CO <sub>2</sub> encountered?	_____ yes <input checked="" type="checkbox"/> no at what depths? _____
Was H <sub>2</sub> S encountered?	_____ yes <input checked="" type="checkbox"/> no at what depths? _____
Were unusual drilling circumstances encountered?	_____ <input checked="" type="checkbox"/> yes _____ no
If yes, briefly explain below	

Other remarks: Well was sidetracked at approx 12274 KOP set 13200 415 SAX cement. Conductor set 132ft

OTC PUN# 05122273100000

640 Acres

If more than three drainholes are proposed, attach a separate sheet indicating the necessary information.

Direction must be stated in degrees azimuth. Please note, the horizontal drainhole and its end point must be located within the boundaries of the lease or spacing unit.

Directional surveys are required for all drainholes and directional wells.

640 Acres

BOTTOM HOLE LOCATION FOR DIRECTIONAL HOLE

SEC	TWP	RGE	COUNTY	Spot Location	Feet From 1/4 Sec Lines	FSL	FWL
				1/4 1/4 1/4 1/4			
				Measured Total Depth	True Vertical Depth	BHL From Lease, Unit, or Property Line:	

BOTTOM HOLE LOCATION FOR HORIZONTAL HOLE: (LATERALS)

LATERAL #1	SEC	TWP	RGE	COUNTY	Spot Location	Feet From 1/4 Sec Lines	FSL	FWL
	03	04N	06W	Grady	NW 1/4 NW 1/4 NE 1/4 NW 1/4		117	1390
					Depth of Deviation	Radius of Turn	Direction	Total Length
					14,610	900	355	7,517
					Measured Total Depth	True Vertical Depth	BHL From Lease, Unit, or Property Line:	
					22,877	15,210	117 64	

LATERAL #2

SEC	TWP	RGE	COUNTY	Spot Location	Feet From 1/4 Sec Lines	FSL	FWL
				1/4 1/4 1/4 1/4			
				Depth of Deviation	Radius of Turn	Direction	Total Length
				Measured Total Depth	True Vertical Depth	BHL From Lease, Unit, or Property Line:	

LATERAL #3

SEC	TWP	RGE	COUNTY	Spot Location	Feet From 1/4 Sec Lines	FSL	FWL
				1/4 1/4 1/4 1/4			
				Depth of Deviation	Radius of Turn	Direction	Total Length
				Measured Total Depth	True Vertical Depth	BHL From Lease, Unit, or Property Line:	

2/1/18

RECEIVED

Form 1002A  
Rev. 2009

JAN 31 2018

OKLAHOMA CORPORATION  
COMMISSIONAPI  
NO. 051-24100  
OTC PROD.  
UNIT NO.PLEASE TYPE OR USE BLACK INK ONLY  
NOTE:Attach copy of original 1002A  
if recompletion or reentry.OKLAHOMA CORPORATION COMMISSION  
Oil & Gas Conservation Division  
Post Office Box 52000  
Oklahoma City, Oklahoma 73152-2000  
Rule 165:10-3-25

## COMPLETION REPORT

☒ ORIGINAL  
☐ AMENDED (Reason)

## TYPE OF DRILLING OPERATION

☐ STRAIGHT HOLE ☐ DIRECTIONAL HOLE ☒ HORIZONTAL HOLE  
☐ SERVICE WELL

If directional or horizontal, see reverse for bottom hole location.

COUNTY	Grady	SEC	10	TWP	04N	RGE	6W
LEASE NAME	North Cheyenne 3-10X3H						
1/4 SE 1/4 NE 1/4 NE SW	PSL OF 1/4 SEC		2305	FWL OF 1/4 SEC		2340	
ELEVATION	Ground	1173	Latitude (if known)		34.83304	Longitude (if known)	
OPERATOR NAME	Gulfport MidCon LLC				OTC/OCC OPERATOR NO. 24020		
ADDRESS	3001 Quail Springs Parkway						
CITY	Oklahoma City	STATE	OK	ZIP	73134		

SPUD DATE 1/15/17

DRLG FINISHED DATE 7/11/17

DATE OF WELL COMPLETION 11/23/17

1st PROD DATE 11/23/17

RECOMP DATE

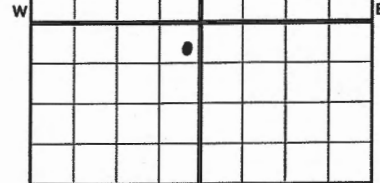

LOCATE WELL

## COMPLETION TYPE

<input checked="" type="checkbox"/> SINGLE ZONE
<input type="checkbox"/> MULTIPLE ZONE
Application Date
<input type="checkbox"/> COMMINGLED
Application Date
LOCATION
EXCEPTION ORDER
INCREASED DENSITY
ORDER NO.

## CASING &amp; CEMENT (Form 1002C must be attached)

TYPE	SIZE	WEIGHT	GRADE	FEET	PSI	SAX	TOP OF CMT
SURFACE	20		J55	737		805	Surface
INTERMEDIATE	133/8		J55	3609		2055	844
INTERMEDIATE	9 5/8		J55	12,589		3035	4,589
PRODUCTION	5 1/2 4 1/2		P110	22907		895	11990
LINER	7		P110	12005 31127-14895		444	31,127-12005
						TOTAL DEPTH	22,877

PACKER @ BRAND &amp; TYPE

PLUG @ TYPE

PLUG @ TYPE

PACKER @ BRAND &amp; TYPE

PLUG @ TYPE

PLUG @ TYPE

## COMPLETION &amp; TEST DATA BY PRODUCING FORMATION

FORMATION	Woodford	Hunton		
SPACING & SPACING ORDER NUMBER	199355 440798 (640)	440798 (640)	661729 (Multinut)	Reported to FracFocus
CLASS: Oil, Gas, Dry, Inj, Disp, Comm Disp, Svc	Gas	Gas		
PERFORATED INTERVALS	15561-21048	21048-21958		
	21958-22779			
ACID/VOLUME	1822bbl	428bbl		
FRACTURE TREATMENT (Fluids/Prop Amounts)	375,992bbl water	54,267bbl water		
	16,018,521 lbs sand	2,025,596 lbs sand		

## INITIAL TEST DATA

INITIAL TEST DATE	1/20/2018			
OIL-BBL/DAY	343			
OIL-GRAVITY (API)	56			
GAS-MCF/DAY	10,000			
GAS-OIL RATIO CU FT/BBL	29,178			
WATER-BBL/DAY	2,604			
PUMPING OR FLOWING	Flowing			
INITIAL SHUT-IN PRESSURE	3,617			
CHOKE SIZE	34/64			
FLOW TUBING PRESSURE	N/A			

AS SUBMITTED

A record of the formations drilled through, and pertinent remarks are presented on the reverse. I declare that I have knowledge of the contents of this report and am authorized by my organization to make this report, which was prepared by me or under my supervision and direction, with the data and facts stated herein to be true, correct, and complete to the best of my knowledge and belief.

SIGNATURE	Monica Pickens	DATE	1/25/2018	PHONE NUMBER	252-4703
3001 Quail Springs Parkway	Oklahoma City	OK	73134	mpickens@gulfportenergy.com	
ADDRESS	CITY	STATE	ZIP	EMAIL ADDRESS	

SCANNED

per  
OK