

Oklahoma Corporation Commission  
Oil & Gas Conservation Division  
Post Office Box 52000  
Oklahoma City, Oklahoma 73152-2000  
Rule 165: 10-3-25

Form 1002A

API No.: 35019261680002

**Completion Report**

Spud Date: March 27, 2015

OTC Prod. Unit No.: 019-212281

Drilling Finished Date: April 01, 2015

**Amended**

1st Prod Date: June 26, 2015

Amend Reason: CONVERT TO INJECTOR

Completion Date: June 24, 2015

Recomplete Date: February 19, 2018

**Drill Type: STRAIGHT HOLE**

**SERVICE WELL**

Well Name: BRADY 151

Purchaser/Measurer:

Location: CARTER 5 2S 2W  
NE SW NW SE  
1920 FSL 390 FWL of 1/4 SEC  
Derrick Elevation: 1068 Ground Elevation: 1061

First Sales Date:

Operator: KODIAK OIL & GAS INC 23226

204 N WALNUT ST  
MUNSTER, TX 76252-2766

Completion Type		Location Exception		Increased Density	
X	Single Zone	Order No		Order No	
	Multiple Zone	There are no Location Exception records to display.		There are no Increased Density records to display.	
	Commingled				

Casing and Cement							
Type	Size	Weight	Grade	Feet	PSI	SAX	Top of CMT
PRODUCTION	5 1/2	15.5	J-55	2550		400	SURFACE

Liner								
Type	Size	Weight	Grade	Length	PSI	SAX	Top Depth	Bottom Depth
There are no Liner records to display.								

**Total Depth: 2580**

Packer	
Depth	Brand & Type
2100	ARROW TENSION

Plug	
Depth	Plug Type
2550	PBTD

Initial Test Data										
Test Date	Formation	Oil BBL/Day	Oil-Gravity (API)	Gas MCF/Day	Gas-Oil Ratio Cu FT/BBL	Water BBL/Day	Pumpin or Flowing	Initial Shut-In Pressure	Choke Size	Flow Tubing Pressure
There are no Initial Data records to display.										

Completion and Test Data by Producing Formation			
Formation Name: DEESE		Code: 404DEESS	Class: INJ
<b>Spacing Orders</b>		<b>Perforated Intervals</b>	
<b>Order No</b>	<b>Unit Size</b>	<b>From</b>	<b>To</b>
There are no Spacing Order records to display.		2144	2224
<b>Acid Volumes</b>		<b>Fracture Treatments</b>	
There are no Acid Volume records to display.		There are no Fracture Treatments records to display.	

Formation	Top
SEE ORIGINAL	0

Were open hole logs run? Yes  
Date last log run: April 01, 2015  
  
Were unusual drilling circumstances encountered? No  
Explanation:

Other Remarks
CONVERT TO INJECTOR. PERMIT NUMBER 1808580049

FOR COMMISSION USE ONLY	
Status: Accepted	1139196

API NO. 019-26168  
OTC PROD. 019  
UNIT NO. 212281

PLEASE TYPE OR USE BLACK INK ONLY

NOTE:

Attach copy of original 1002A  
if recompletion or reentry.

OKLAHOMA CORPORATION COMMISSION  
Oil & Gas Conservation Division  
Post Office Box 52000  
Oklahoma City, Oklahoma 73152-2000  
Rule 165:10-3-25

RECEIVED

MAR 22 2018

Form 1002A  
Rev. 2009

☐ ORIGINAL  
☒ AMENDED (Reason)

CONVERT TO MJS.

COMPLETION REPORT

TYPE OF DRILLING OPERATION

☒ STRAIGHT HOLE ☐ DIRECTIONAL HOLE ☐ HORIZONTAL HOLE  
☒ SERVICE WELL

If directional or horizontal, see reverse for bottom hole location.

COUNTY CARTER SEC 5 TWP 25 RGE 2W  
LEASE NAME BRADY WELL NO. 151  
NE 1/4 SW 1/4 NW 1/4 SE 1/4 FSL OF 1/4 SEC 1920 FWL OF 1/4 SEC 390  
ELEVATION 1068 Ground 1061 Latitude (if known) Longitude (if known)  
OPERATOR NAME KODIAK O&G GAS, INC. OTC/OCC OPERATOR NO. 23226  
ADDRESS 204 N. WALNUT ST.  
CITY MUNSTER STATE TEXAS ZIP 76252

SPUD DATE 3/27/15  
DRILG FINISHED DATE 4/1/15  
DATE OF WELL COMPLETION 6/24/15  
1st PROD DATE 6/26/15  
RECOMP DATE 2/19/18

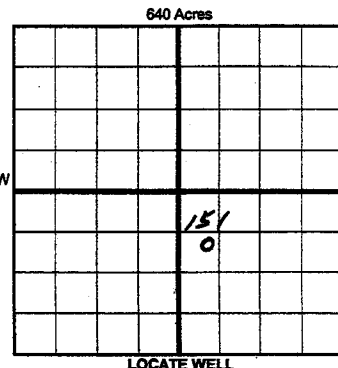

COMPLETION TYPE

☒ SINGLE ZONE  
☐ MULTIPLE ZONE  
Application Date  
☐ COMMINGLED  
Application Date  
LOCATION  
EXCEPTION ORDER  
INCREASED DENSITY  
ORDER NO.

CASING & CEMENT (Form 1002C must be attached)

TYPE	SIZE	WEIGHT	GRADE	FEET	PSI	SAX	TOP OF CMT
CONDUCTOR							
SURFACE							
INTERMEDIATE							
PRODUCTION	<u>5 1/2</u>	<u>15.5</u>	<u>355</u>	<u>2550</u>		<u>400</u>	<u>SURF CBL</u>
LINER							

PACKER @ 2100 BRAND & TYPE ARROW TENSION PLUG @ \_\_\_\_\_ TYPE \_\_\_\_\_ PLUG @ \_\_\_\_\_ TYPE \_\_\_\_\_ TOTAL DEPTH 2580  
PACKER @ \_\_\_\_\_ BRAND & TYPE \_\_\_\_\_ PLUG @ \_\_\_\_\_ TYPE \_\_\_\_\_ PLUG @ \_\_\_\_\_ TYPE \_\_\_\_\_ PBTD 2550

COMPLETION & TEST DATA BY PRODUCING FORMATION

FORMATION	<u>DEESE</u>						
SPACING & SPACING ORDER NUMBER	<u>10 AC OIL</u>						
CLASS: Oil, Gas, Dry, Inj. Disp, Comm Disp, Svc	<u>INS</u>						
PERFORATED INTERVALS	<u>2144-2224</u> <u>(OA)</u>						
ACID/VOLUME							
FRACTURE TREATMENT (Fluids/Prop Amounts)							

Min Gas Allowable (165:10-17-7)

Gas Purchaser/Measurer



OR

First Sales Date

INITIAL TEST DATA

Oil Allowable (165:10-13-3)

INITIAL TEST DATE	<u>2/19/18</u>						
OIL-BBL/DAY	<u>INS</u>						
OIL-GRAVITY (API)							
GAS-MCF/DAY							
GAS-OIL RATIO CU FT/BBL							
WATER-BBL/DAY							
PUMPING OR FLOWING							
INITIAL SHUT-IN PRESSURE							
CHOKE SIZE							
FLOW TUBING PRESSURE							

AS SUBMITTED

A record of the formations drilled through, and pertinent remarks are presented on the reverse. I declare that I have knowledge of the contents of this report and am authorized by my organization to make this report, which was prepared by me or under my supervision and direction, with the data and facts stated herein to be true, correct, and complete to the best of my knowledge and belief.

JOHN R. LAWS 2/19/18 580-220-8455  
SIGNATURE NAME (PRINT OR TYPE) DATE PHONE NUMBER  
1515 WARD RD., ARDMORE, OK, 73401 JRLAWS@HOTMAIL.COM  
ADDRESS CITY STATE ZIP EMAIL ADDRESS

PLEASE TYPE OR USE BLACK INK ONLY  
FORMATION RECORD

Give formation names and tops, if available, or descriptions and thickness of formations drilled through. Show intervals cored or drillstem tested.

NAMES OF FORMATIONS	TOP
SEE ORIGINAL	

LEASE NAME BRADY

WELL NO. 151

FOR COMMISSION USE ONLY	
ITD on file <input type="checkbox"/> YES <input type="checkbox"/> NO	
APPROVED _____	DISAPPROVED _____
2) Reject Codes	
_____	
_____	
_____	
_____	

Were open hole logs run?	<input checked="" type="checkbox"/> yes <input type="checkbox"/> no
Date Last log was run	<u>4-1-15</u>
Was CO <sub>2</sub> encountered?	<input type="checkbox"/> yes <input checked="" type="checkbox"/> no at what depths? _____
Was H <sub>2</sub> S encountered?	<input type="checkbox"/> yes <input checked="" type="checkbox"/> no at what depths? _____
Were unusual drilling circumstances encountered?	<input type="checkbox"/> yes <input checked="" type="checkbox"/> no
If yes, briefly explain below	

Other remarks:

CONVERT TO INJECTOR Permit 1808580049

640 Acres

If more than three drainholes are proposed, attach a separate sheet indicating the necessary information.

Direction must be stated in degrees azimuth.  
Please note, the horizontal drainhole and its end point must be located within the boundaries of the lease or spacing unit.

Directional surveys are required for all drainholes and directional wells.

640 Acres

BOTTOM HOLE LOCATION FOR DIRECTIONAL HOLE

SEC	TWP	RGE	COUNTY
Spot Location	1/4	1/4	1/4
Measured Total Depth	True Vertical Depth	BHL From Lease, Unit, or Property Line:	

BOTTOM HOLE LOCATION FOR HORIZONTAL HOLE: (LATERALS)

SEC	TWP	RGE	COUNTY
Spot Location	1/4	1/4	1/4
Depth of Deviation	Radius of Turn	Direction	Total Length
Measured Total Depth	True Vertical Depth	BHL From Lease, Unit, or Property Line:	

LATERAL #2

SEC	TWP	RGE	COUNTY
Spot Location	1/4	1/4	1/4
Depth of Deviation	Radius of Turn	Direction	Total Length
Measured Total Depth	True Vertical Depth	BHL From Lease, Unit, or Property Line:	

LATERAL #3

SEC	TWP	RGE	COUNTY
Spot Location	1/4	1/4	1/4
Depth of Deviation	Radius of Turn	Direction	Total Length
Measured Total Depth	True Vertical Depth	BHL From Lease, Unit, or Property Line:	