

Oklahoma Corporation Commission
Oil & Gas Conservation Division
Post Office Box 52000
Oklahoma City, Oklahoma 73152-2000
Rule 165: 10-3-25

Form 1002A

API No.: 35019253290001

Completion Report

Spud Date: September 30, 2009

OTC Prod. Unit No.: 019-1930120

Drilling Finished Date: October 01, 2009

Amended

1st Prod Date: November 25, 2009

Amend Reason: CONVERT TO INJECTOR

Completion Date: November 23, 2009

Recomplete Date: February 19, 2018

Drill Type: STRAIGHT HOLE

SERVICE WELL

Well Name: AKERS 66

Purchaser/Measurer:

Location: CARTER 5 2S 2W
SW NE NE SE
2204 FSL 2145 FWL of 1/4 SEC
Derrick Elevation: 1012 Ground Elevation: 1005

First Sales Date:

Operator: KODIAK OIL & GAS INC 23226

204 N WALNUT ST
MUNSTER, TX 76252-2766

Completion Type		Location Exception		Increased Density	
X	Single Zone	Order No		Order No	
	Multiple Zone	There are no Location Exception records to display.		There are no Increased Density records to display.	
	Commingled				

Casing and Cement							
Type	Size	Weight	Grade	Feet	PSI	SAX	Top of CMT
PRODUCTION	5 1/2	15.5	J-55	1722		310	SURFACE

Liner								
Type	Size	Weight	Grade	Length	PSI	SAX	Top Depth	Bottom Depth
There are no Liner records to display.								

Total Depth: 1750

Packer		Plug	
Depth	Brand & Type	Depth	Plug Type
1550	ARROW TENSION	1722	PBTD

Initial Test Data										
Test Date	Formation	Oil BBL/Day	Oil-Gravity (API)	Gas MCF/Day	Gas-Oil Ratio Cu FT/BBL	Water BBL/Day	Pumpin or Flowing	Initial Shut-In Pressure	Choke Size	Flow Tubing Pressure
There are no Initial Data records to display.										

Completion and Test Data by Producing Formation			
Formation Name: DEESE		Code: 404DEESS	Class: INJ
Spacing Orders		Perforated Intervals	
Order No	Unit Size	From	To
There are no Spacing Order records to display.		1585	1663
Acid Volumes		Fracture Treatments	
There are no Acid Volume records to display.		There are no Fracture Treatments records to display.	

Formation	Top
SEE ORIGINAL	0

Were open hole logs run? No
Date last log run: October 01, 2009

Were unusual drilling circumstances encountered? No
Explanation:

Other Remarks
CONVERT PRODUCER TO INJECTOR. PERMIT NUMBER 1808580050

FOR COMMISSION USE ONLY	
Status: Accepted	1139195

API NO. 019-25329
OTC PROD. 919
UNIT NO. 1936/20

PLEASE TYPE OR USE BLACK INK ONLY

NOTE:

Attach copy of original 1002A
if recompletion or reentry.

OKLAHOMA CORPORATION COMMISSION
Oil & Gas Conservation Division
Post Office Box 52000
Oklahoma City, Oklahoma 73152-2000
Rule 165:10-3-25

MAR 22 2018

Form 1002A
Rev. 2009

☐ ORIGINAL
☒ AMENDED (Reason)

CONVERT TO INJECTOR

COMPLETION REPORT

TYPE OF DRILLING OPERATION

☒ STRAIGHT HOLE ☐ DIRECTIONAL HOLE ☐ HORIZONTAL HOLE
☒ SERVICE WELL

If directional or horizontal, see reverse for bottom hole location.

COUNTY CARTER SEC 5 TWP 25 RGE 2W DATE OF WELL COMPLETION 11/23/09
LEASE NAME AKERS WELL NO. 66 1st PROD DATE 11/25/09
SW 1/4 NE 1/4 NE 1/4 SE 1/4 FSL OF 1/4 SEC 2204 FWL OF 1/4 SEC 2145 RECOMP DATE 2/19/18
ELEVATION 1012 Ground 1005 Latitude (if known) Longitude (if known)
OPERATOR NAME KODIAK OIL & GAS, INC. OTC/OCC OPERATOR NO. 23226
ADDRESS 204 N. WALNUT ST.
CITY MUENSTER STATE TEXAS ZIP 76252

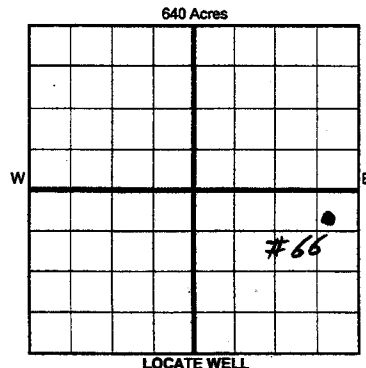

COMPLETION TYPE

☒ SINGLE ZONE
☐ MULTIPLE ZONE
Application Date
☐ COMINGLED
Application Date
LOCATION
EXCEPTION ORDER
INCREASED DENSITY
ORDER NO.

CASING & CEMENT (Form 1002C must be attached)

TYPE	SIZE	WEIGHT	GRADE	FEET	PSI	SAX	TOP OF CMT
CONDUCTOR							
SURFACE							
INTERMEDIATE							
PRODUCTION	<u>5 1/2</u>	<u>15.5</u>	<u>J-55</u>	<u>1722'</u>		<u>310</u>	<u>SURF</u>
LINER							

PACKER @ 1550 BRAND & TYPE ARROW TENSION PLUG @ _____ TYPE _____ PLUG @ _____ TYPE _____ TOTAL DEPTH 1750
PACKER @ _____ BRAND & TYPE _____ PLUG @ _____ TYPE _____ PLUG @ _____ TYPE _____ PSTD 1722

COMPLETION & TEST DATA BY PRODUCING FORMATION

FORMATION	<u>DEESE</u>						
SPACING & SPACING ORDER NUMBER	<u>UNSPACED</u>						
CLASS: Oil, Gas, Dry, Inj, Disp, Comm Disp, Svc	<u>INTJ.</u>						
PERFORATED INTERVALS	<u>1585-1663</u>						
ACID/VOLUME							
FRACTURE TREATMENT (Fluids/Prop Amounts)							

Min Gas Allowable (165:10-17-7)

Gas Purchaser/Measurer

☐

OR

First Sales Date

INITIAL TEST DATA

Oil Allowable (165:10-13-3)

INITIAL TEST DATE	<u>2/19/18</u>						
OIL-BBL/DAY	<u>INTJ.</u>						
OIL-GRAVITY (API)							
GAS-MCF/DAY							
GAS-OIL RATIO CU FT/BBL							
WATER-BBL/DAY							
PUMPING OR FLOWING							
INITIAL SHUT-IN PRESSURE							
CHOKE SIZE							
FLOW TUBING PRESSURE							

AS SUBMITTED

A record of the formations drilled through, and pertinent remarks are presented on the reverse. I declare that I have knowledge of the contents of this report and am authorized by my organization to make this report, which was prepared by me or under my supervision and direction, with the data and facts stated herein to be true, correct, and complete to the best of my knowledge and belief.

SIGNATURE JOHN R. LAWS DATE 2/19/18 PHONE NUMBER 580-220-8455
ADDRESS 1515 WARD RD. AROMORE OK 73401 CITY STATE ZIP
EMAIL ADDRESS JRLAWS@HOTMAIL.COM

Give formation names and tops, if available, or descriptions and thickness of formations drilled through. Show intervals cored or drillstem tested.

LEASE NAME AKERS WELL NO. 66

NAMES OF FORMATIONS	TOP
<i>SEE ORIGINAL</i>	

FOR COMMISSION USE ONLY	
ITD on file	<input type="checkbox"/> YES <input type="checkbox"/> NO
APPROVED	DISAPPROVED
2) Reject Codes	

Were open hole logs run? yes ✓ no

Date Last log run 10/1/09

Was CO₂ encountered? yes ✓ no at what depths?

Was H₂S encountered? yes ✓ no at what depths?

Were unusual drilling circumstances encountered? yes ✓ no

If yes, briefly explain below

Other remarks:

CONVERT PRODUCER TO INJECTOR Permit 1808580050

640 Acres

The image shows a grid representing 640 acres. The grid is 8 units wide and 4 units high, totaling 32 units by 4 units. A thick vertical line runs down the center, and a thick horizontal line runs across the middle. The text '640 Acres' is written above the grid.

Direction must be stated in degrees azimuth.
Please note, the horizontal drainhole and its end
point must be located within the boundaries of the
lease or spacing unit.

640 Acres

Unit Square

SEC	TWP	RGE	COUNTY
Spot Location			
1/4	1/4	1/4	1/4
Measured Total Depth	True Vertical Depth	BHL From Lease, Unit, or Property Line:	

LATERAL #1						
SEC	TWP	RGE	COUNTY			
Spot Location			Feet From 1/4 Sec Lines		FSL	FWL
1/4		1/4	1/4			
Depth of Deviation		Radius of Turn	Direction		Total Length	
Measured Total Depth		True Vertical Depth	BHL From Lease, Unit, or Property Line:			

SEC	TWP	RGE	COUNTY			
Spot Location				Feet From 1/4 Sec Lines	FSL	FWL
1/4	1/4	1/4	1/4			
Depth of Deviation		Radius of Turn		Direction	Total Length	
Measured Total Depth		True Vertical Depth		BHL From Lease, Unit, or Property Line:		

SEC	TWP	RGE	COUNTY			
Spot Location						
1/4	1/4	1/4	1/4	Feet From 1/4 Sec Lines	FSL	FWL
Depth of Deviation		Radius of Turn	Direction	Total Length		
Measured Total Depth		True Vertical Depth	BHL From Lease, Unit, or Property Line:			