

Oklahoma Corporation Commission
Oil & Gas Conservation Division
Post Office Box 52000
Oklahoma City, Oklahoma 73152-2000
Rule 165: 10-3-25

Form 1002A

API No.: 35037293160000

Completion Report

Spud Date: October 05, 2015

OTC Prod. Unit No.:

Drilling Finished Date: October 09, 2015

1st Prod Date: November 04, 2015

Completion Date: October 16, 2015

Drill Type: STRAIGHT HOLE

Well Name: WILLIE CATCH 1A

Purchaser/Measurer:

Location: CREEK 22 18N 8E
C N2 NW SW
2310 FSL 660 FWL of 1/4 SEC
Derrick Elevation: 0 Ground Elevation: 944

First Sales Date:

Operator: BARNES DARRELL 8153

10015 S 433RD WEST AVE
DRUMRIGHT, OK 74030-5879

Completion Type		Location Exception		Increased Density	
X	Single Zone	Order No		Order No	
	Multiple Zone	There are no Location Exception records to display.		There are no Increased Density records to display.	
	Commingled				

Casing and Cement								
Type		Size	Weight	Grade	Feet	PSI	SAX	Top of CMT
SURFACE		7	23	J-55	831		170	SURFACE
PRODUCTION		4 1/2	11.5	J-55	3480	4000	220	960

Liner								
Type	Size	Weight	Grade	Length	PSI	SAX	Top Depth	Bottom Depth
There are no Liner records to display.								

Total Depth: 3500

Packer		Plug	
Depth	Brand & Type	Depth	Plug Type
There are no Packer records to display.		3335	PBTD

Initial Test Data										
Test Date	Formation	Oil BBL/Day	Oil-Gravity (API)	Gas MCF/Day	Gas-Oil Ratio Cu FT/BBL	Water BBL/Day	Pumpin or Flowing	Initial Shut-In Pressure	Choke Size	Flow Tubing Pressure
Nov 04, 2015	RED FORK	3	34			3	PUMPING			

Completion and Test Data by Producing Formation			
Formation Name: RED FORK		Code: 404RDFK	Class: OIL
Spacing Orders		Perforated Intervals	
Order No	Unit Size	From	To
There are no Spacing Order records to display.		2680	2695
Acid Volumes		Fracture Treatments	
500 15.00% HCL		There are no Fracture Treatments records to display.	

Formation	Top
RED FORK	2680

Were open hole logs run? Yes
Date last log run: October 09, 2015

Were unusual drilling circumstances encountered? No
Explanation:

Other Remarks
There are no Other Remarks.

FOR COMMISSION USE ONLY	
Status: Accepted	1139219

API NO. 037-29316
OTC PROD.
UNIT NO.

PLEASE TYPE OR USE BLACK INK ONLY
NOTE:

Attach copy of original 1002A
if recompletion or reentry.

OKLAHOMA CORPORATION COMMISSION
Oil & Gas Conservation Division
Post Office Box 52000
Oklahoma City, Oklahoma 73152-2000
Rule 165:10-3-25

RECEIVED

MAR 28 2018

OKLAHOMA CORPORATION
COMMISSION

Form 1002A
Rev. 2009

☒ ORIGINAL
☐ AMENDED (Reason)

TYPE OF DRILLING OPERATION

☒ STRAIGHT HOLE ☐ DIRECTIONAL HOLE ☐ HORIZONTAL HOLE
☐ SERVICE WELL

If directional or horizontal, see reverse for bottom hole location.

COUNTY	CREEK	SEC	22	TWP	18N	RGE	8E
LEASE NAME	WILLIE CATCH			WELL NO.	1A		
N/2 1/4 NW 1/4 SW 1/4 1/4	FSL OF 1/4 SEC	2310	FWL OF 1/4 SEC	660			
ELEVATION N Derrick	Ground	944	Latitude (if known)				
OPERATOR NAME	DARRELL BARNES			OTC/OCC OPERATOR NO.	8153		
ADDRESS	10015 S. 433RD WEST AVE.						
CITY	DRUMRIGHT	STATE	OK	ZIP	74030		

SPUD DATE 10-05-2015
DRLG FINISHED DATE 10-09-2015
DATE OF WELL COMPLETION 10-16-2015
1st PROD DATE 11-04-2015
RECOMP DATE

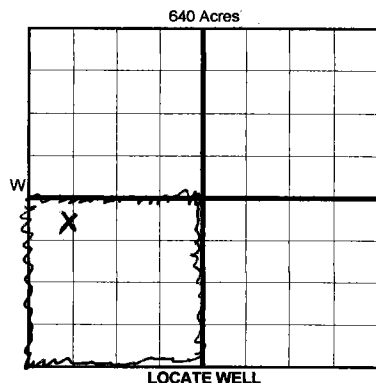

COMPLETION TYPE

☒ SINGLE ZONE
☐ MULTIPLE ZONE
Application Date
☐ COMMINGLED
Application Date
LOCATION
EXCEPTION ORDER
INCREASED DENSITY
ORDER NO.

CASING & CEMENT (Form 1002C must be attached)

TYPE	SIZE	WEIGHT	GRADE	FEET	PSI	SAX	TOP OF CMT
CONDUCTOR							
SURFACE	7	23	J55	831		170 100	SURFACE
INTERMEDIATE							
PRODUCTION	4 1/2	11.5	J55	3480	4000	220	960
LINER	PLUG	BACK	TD	3335			
TOTAL DEPTH							3,500

PACKER @ _____ BRAND & TYPE _____

PACKER @ _____ BRAND & TYPE _____

PLUG @ 3335 TYPE PBTD

PLUG @ _____ TYPE _____

COMPLETION & TEST DATA BY PRODUCING FORMATION

FORMATION	RED FORK						No Frac
SPACING & SPACING ORDER NUMBER							
CLASS: Oil, Gas, Dry, Inj, Disp, Comm Disp, Svc	OIL						
PERFORATED INTERVALS	2680-2686						
	2692-2695						
ACID/VOLUME	500						
	15.00% HCL						
FRACTURE TREATMENT (Fluids/Prop Amounts)							

Min Gas Allowable (165:10-17-7)

Gas Purchaser/Measurer



OR

First Sales Date

INITIAL TEST DATA

Oil Allowable (165:10-13-3)

INITIAL TEST DATE	11/4/2015					
OIL-BBL/DAY	3					
OIL-GRAVITY (API)	34					
GAS-MCF/DAY						
GAS-OIL RATIO CU FT/BBL						
WATER-BBL/DAY	3					
PUMPING OR FLOWING	PUMPING					
INITIAL SHUT-IN PRESSURE						
CHOKE SIZE						
FLOW TUBING PRESSURE						

AS SUBMITTED

A record of the formations drilled through, and pertinent remarks are presented on the reverse. I declare that I have knowledge of the contents of this report and am authorized by my organization to make this report, which was prepared by me or under my supervision and direction, with the data and facts stated herein to be true, correct, and complete to the best of my knowledge and belief.

SIGNATURE DARRELL BARNES NAME (PRINT OR TYPE)
10015 S 433RD WEST AVE DRUMRIGHT OK 74030
ADDRESS CITY STATE ZIP
DATE 3/16/2018 PHONE NUMBER 918-352-2308
EMAIL ADDRESS

Give formation names and tops, if available, or descriptions and thickness of formations drilled through. Show intervals cored or drillstem tested.

WELL NO. _____

FOR COMMISSION USE ONLY	
ITD on file <input type="checkbox"/> YES <input type="checkbox"/> NO	
<u>APPROVED</u>	<u>DISAPPROVED</u>
2) Reject Codes	
<hr/>	
<hr/>	
<hr/>	
<hr/>	
<hr/>	

Other remarks:

If more than three drainholes are proposed, attach a separate sheet indicating the necessary information.

Direction must be stated in degrees azimuth.
Please note, the horizontal drainhole and its end
point must be located within the boundaries of the
lease or spacing unit.

Directional surveys are required for all drainholes and directional wells.

BOTTOM HOLE LOCATION FOR DIRECTIONAL HOLE

BOTTOM HOLE LOCATION FOR HORIZONTAL HOLE: (LATERALS)

LATERAL #3							
SEC	TWP	RGE	COUNTY				
Spot Location					Feet From 1/4 Sec Lines	FSL	FWL
1/4		1/4		1/4			
Depth of Deviation		Radius of Turn	Direction			Total Length	
Measured Total Depth		True Vertical Depth	BHL From Lease, Unit, or Property Line:				