

Oklahoma Corporation Commission
Oil & Gas Conservation Division
Post Office Box 52000
Oklahoma City, Oklahoma 73152-2000
Rule 165: 10-3-25

Form 1002A

API No.: 35109218570002

Completion Report

Spud Date: October 07, 1992

OTC Prod. Unit No.:

Drilling Finished Date: November 10, 1992

Amended

1st Prod Date: January 05, 1993

Amend Reason: RUN 4" CASING LINER

Completion Date: January 05, 1993

Recomplete Date: December 08, 2017

Drill Type: DIRECTIONAL HOLE

Well Name: TROSPER PARK A 39

Purchaser/Measurer:

Location: OKLAHOMA 12 11N 3W
NW SE NE SE
1978 FSL 2098 FWL of 1/4 SEC
Derrick Elevation: 0 Ground Elevation: 1238

First Sales Date:

Operator: STEPHENS & JOHNSON OPERATING CO 19113
PO BOX 2249
811 6TH ST STE 300
WICHITA FALLS, TX 76307-2249

Completion Type		Location Exception		Increased Density	
X	Single Zone	Order No		Order No	
	Multiple Zone	There are no Location Exception records to display.		There are no Increased Density records to display.	
	Commingled				

Casing and Cement							
Type	Size	Weight	Grade	Feet	PSI	SAX	Top of CMT
SURFACE	8 5/8	24	K-55	1452		675	SURFACE
PRODUCTION	5 1/2	14 / 15.5	K-55	6426		580	SURFACE

Liner								
Type	Size	Weight	Grade	Length	PSI	SAX	Top Depth	Bottom Depth
LINER	4 1/2	11.6	J-55	0	0	275	SURFACE	6104

Total Depth: 6427

Packer		Plug	
Depth	Brand & Type	Depth	Plug Type
There are no Packer records to display.		There are no Plug records to display.	

Initial Test Data

Test Date	Formation	Oil BBL/Day	Oil-Gravity (API)	Gas MCF/Day	Gas-Oil Ratio Cu FT/BBL	Water BBL/Day	Pumpin or Flowing	Initial Shut-In Pressure	Choke Size	Flow Tubing Pressure
Jan 09, 1993	JOHNSON (SIMPSON)	96	40	150	1562		FLOWING	680		520
Jan 31, 2018	JOHNSON (SIMPSON)	16	40	30	1875	250	PUMPING	300		

Completion and Test Data by Producing Formation									
Formation Name: JOHNSON (SIMPSON)				Code: 202JNSN			Class: OIL		
Spacing Orders				Perforated Intervals					
Order No		Unit Size		From			To		
NON SPACED				6246			6249		
Acid Volumes				Fracture Treatments					
NONE				There are no Fracture Treatments records to display.					

Formation Name: JOHNSON (SIMPSON)		Code: 202JNSN		Class: OIL	
Spacing Orders		Perforated Intervals			
Order No	Unit Size	From	To		
NON SPACED		6236	6240		
Acid Volumes		Fracture Treatments			
500 GALLONS		There are no Fracture Treatments records to display.			

Formation	Top
PAWHUSKA	3225
HOOVER SAND	4035
LAYTON	5016
OSWEGO	6058
JOHNSON	6230
ARBUCKLE	6398

Were open hole logs run? No
Date last log run:

Were unusual drilling circumstances encountered? No
Explanation:

Other Remarks
RUN 4 1/2" CASING TO REPAIR CASING LEAK PROBLEMS, SET PIPE ABOVE JOHNSON SAND AND DRILLED OUT SHOE AFTER CEMENTING CASING. CEMENTED CASING WITH 275 SACKS, CIRCULATED CEMENT.

Bottom Holes
Sec: 12 TWP: 11N RGE: 3W County: OKLAHOMA
S2 SW NE SE
1426 FSL 1712 FWL of 1/4 SEC
Depth of Deviation: 0 Radius of Turn: 0 Direction: 0 Total Length: 0
Measured Total Depth: 6380 True Vertical Depth: 6217 End Pt. Location From Release, Unit or Property Line: 0

Status: Accepted

RECEIVED

Form 1002A
Rev. 2009

MAR 29 2018

OKLAHOMA CORPORATION COMMISSION

API NO. 109-21857-X
OTC PROD.
UNIT NO.

PLEASE TYPE OR USE BLACK INK ONLY
NOTE:

Attach copy of original 1002A
if recompletion or reentry.

OKLAHOMA CORPORATION COMMISSION
Oil & Gas Conservation Division
Post Office Box 52000
Oklahoma City, Oklahoma 73152-2000
Rule 165:10-3-25

☐ ORIGINAL
☒ AMENDED (Reason)

Run 4" csg liner

COMPLETION REPORT

TYPE OF DRILLING OPERATION
☐ STRAIGHT HOLE ☒ DIRECTIONAL HOLE ☐ HORIZONTAL HOLE
☐ SERVICE WELL
If directional or horizontal, see reverse for bottom hole location.

SPUD DATE 10-7-92
ORLG FINISHED DATE 11-10-92
DATE OF WELL COMPLETION 1-5-93
1st PROD DATE 1-5-93
RECOMP DATE 12-8-17

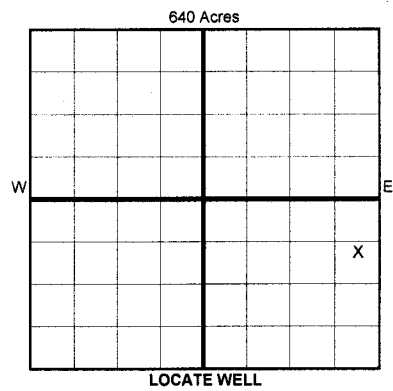

COUNTY Oklahoma SEC 12 TWP 11N RGE 3W
LEASE NAME Trosper Park A WELL NO. 39
NW 1/4 SE 1/4 NE 1/4 SE 1/4 FSL OF 1/4 SEC 1978' FWL OF 1/4 SEC 2098'
ELEVATION Ground 1238' Latitude (if known) Longitude (if known)
OPERATOR NAME Stephens & Johnson Operating Co. OTC/OCC OPERATOR NO. 19113-0
ADDRESS P O Box 2249
CITY Wichita Falls STATE Tx ZIP 76307

COMPLETION TYPE
☒ SINGLE ZONE
☐ MULTIPLE ZONE
Application Date
COMINGLED
Application Date
LOCATION
EXCEPTION ORDER
INCREASED DENSITY
ORDER NO.

CASING & CEMENT (Form 1002C must be attached)

TYPE	SIZE	WEIGHT	GRADE	FEET	PSI	SAX	TOP OF CMT
CONDUCTOR							
SURFACE	8 5/8"	24	K-55	1452'		675	SURF
INTERMEDIATE							
PRODUCTION	5 1/2"	14/15.5	K-55	6426'		580	CIRC to Surface
LINER	4 1/2"	11.6	J-55	6104' - surface		2252.75	CIRC to Surface
							6427'

PACKER @ BRAND & TYPE PLUG @ TYPE PLUG @ TYPE
PACKER @ BRAND & TYPE PLUG @ TYPE PLUG @ TYPE

COMPLETION & TEST DATA BY PRODUCING FORMATION 2202 JNSN

FORMATION	JOHNSON SD	JOHNSON SD	
SPACING & SPACING ORDER NUMBER	NON SPACED	NON SPACED	
CLASS: Oil, Gas, Dry, Inj, Disp, Comm Disp, Svc	OIL	OIL	
PERFORATED INTERVALS	6246-6249'	6236-6240'	
ACID/VOLUME	NONE	500 gals	
FRACTURE TREATMENT (Fluids/Prop Amounts)			

Min Gas Allowable (165:10-17-7) Gas Purchaser/Measurer
OR First Sales Date
Oil Allowable (165:10-13-3)

INITIAL TEST DATA	1/9/1993	1/31/2018
INITIAL TEST DATE	1/9/1993	1/31/2018
OIL-BBL/DAY	96	16
OIL-GRAVITY (API)	40	40
GAS-MCF/DAY	150	30
GAS-OIL RATIO CU FT/BBL	1562	1875
WATER-BBL/DAY	0	250
PUMPING OR FLOWING	FLOWING	pumping
INITIAL SHUT-IN PRESSURE	680	300
CHOKE SIZE		
FLOW TUBING PRESSURE	520	

AS SUBMITTED

A record of the formations drilled through, and pertinent remarks are presented on the reverse. I declare that I have knowledge of the contents of this report and am authorized by my organization to make this report which was prepared by me or under my supervision and direction, with the data and facts stated herein to be true, correct, and complete to the best of my knowledge and belief.

SIGNATURE BOB GILMORE 3/26/2018 940-723-2166
P O Box 2249 Wichita Falls Tx 76307
ADDRESS CITY STATE ZIP
EMAIL ADDRESS bgilmore@sjoc.net

FORMATION RECORD

LEASE NAME

Trosper Park A

WELL NO. 39

NAMES OF FORMATIONS	TOP
Pawhuska	3,225
Hoover Sd	4,035
Layton	5,016
Oswego	6,058
Johnson	6,230
Arbuckle	6,398

FOR COMMISSION USE ONLY	
ITD on file <input type="checkbox"/> YES <input type="checkbox"/> NO	
APPROVED DISAPPROVED	2) Reject Codes

Were open hole logs run? yes X no

Date Last log was run _____

Was CO₂ encountered? yes X no at what depths? _____

Was H₂S encountered? yes X no at what depths? _____

Were unusual drilling circumstances encountered? yes X no

If yes, briefly explain below

Other remarks: Run 4 1/2" CSG to repair csg leak problems, set pipe above Johnson Sd and drilled out shoe after cementing csg.
Cemented csg with 225 sx, circ cement.

640 Acres

Direction must be stated in degrees azimuth.
Please note, the horizontal drainhole and its end
point must be located within the boundaries of the
lease or spacing unit.

Directional surveys are required for all drainholes and directional wells.

640 Acres

SEC 12	TWP 11N	RGE 3W	COUNTY OKLAHOMA
Spot Location			
S/2 1/4	SW 1/4	NE 1/4	SE 1/4
Measured Total Depth		Feet From 1/4 Sec Lines	
6380'		FSL 1426 FWL 1712	
True Vertical Depth		BHL From Lease, Unit, or Property Line:	
6217'			

LATERAL #1						
SEC	TWP	RGE	COUNTY			
Spot Location				Feet From 1/4 Sec Lines	FSL	FWL
1/4	1/4	1/4	1/4			
Depth of Deviation		Radius of Turn	Direction	Total Length		
Measured Total Depth		True Vertical Depth	BHL From Lease, Unit, or Property Line:			

SEC	TWP	RGE	COUNTY			
Spot Location				Feet From 1/4 Sec Lines	FSL	FWL
1/4	1/4	1/4	1/4			
Depth of Deviation		Radius of Turn	Direction	Total Length		
Measured Total Depth		True Vertical Depth	BHL From Lease, Unit, or Property Line:			

SEC	TWP	RGE	COUNTY			
Spot Location				Feet From 1/4 Sec Lines	FSL	FWL
1/4	1/4	1/4	1/4			
Depth of Deviation		Radius of Turn	Direction	Total Length		
Measured Total Depth		True Vertical Depth	BHL From Lease, Unit, or Property Line:			