

Oklahoma Corporation Commission
Oil & Gas Conservation Division
Post Office Box 52000
Oklahoma City, Oklahoma 73152-2000
Rule 165: 10-3-25

Form 1002A

API No.: 35139000790002

Completion Report

Spud Date: October 19, 1950

OTC Prod. Unit No.:

Drilling Finished Date: November 22, 1950

1st Prod Date: November 06, 1950

Completion Date: December 04, 1950

Amended

Amend Reason: RETURN STATUS TO GAS

Drill Type: STRAIGHT HOLE

Well Name: STONEBRAKER A 1

Purchaser/Measurer:

Location: TEXAS 21 3N 12E CM
NW NW NW SE
2540 FSL 100 FWL of 1/4 SEC
Derrick Elevation: 3426 Ground Elevation: 3414

First Sales Date:

Operator: MERIT ENERGY COMPANY 18934

13727 NOEL RD STE 1200
DALLAS, TX 75240-7312

Completion Type		Location Exception		Increased Density	
X	Single Zone	Order No		Order No	
	Multiple Zone	There are no Location Exception records to display.		There are no Increased Density records to display.	
	Commingled				

Casing and Cement							
Type	Size	Weight	Grade	Feet	PSI	SAX	Top of CMT
SURFACE	8 5/8	22.7		393		200	SURFACE
PRODUCTION	5 1/2	14		2765		700	SURFACE

Liner								
Type	Size	Weight	Grade	Length	PSI	SAX	Top Depth	Bottom Depth
There are no Liner records to display.								

Total Depth: 2775

Packer		Plug	
Depth	Brand & Type	Depth	Plug Type
There are no Packer records to display.		There are no Plug records to display.	

Initial Test Data										
Test Date	Formation	Oil BBL/Day	Oil-Gravity (API)	Gas MCF/Day	Gas-Oil Ratio Cu FT/BBL	Water BBL/Day	Pumpin or Flowing	Initial Shut-In Pressure	Choke Size	Flow Tubing Pressure
Dec 06, 1950	GUYMON-HUGOTON			10200			FLOWING	412		

Completion and Test Data by Producing Formation

Formation Name: GUYMON-HUGOTON

Code: 451GYHG

Class: GAS

Spacing Orders

Order No	Unit Size
17867	640

Perforated Intervals

From	To
2616	2740

Acid Volumes

There are no Acid Volume records to display.

Fracture Treatments

There are no Fracture Treatments records to display.

Formation	Top
GYP AND SAND	0
CLAY AND SAND	120
RED BEDS AND SAND	339
RED BEDS AND SANDY	375
GYP	624
RED BEDS	655
GYP	900
GYP AND SHALE	910
SHALE AND SHELLS	1065
RED BEDS AND GYP	1390
SHALE, GYP AND SAND ROCK	1625
ANHYDRITE	1720
SHALE AND SAND ROCK	1751
GYP AND SHALE	1879
GYP	1900
GYP SHALE AND ANHYDRITE	1912
SHALE AND GYP	1987
GYP SHALE AND SHELLS	2150
SHALE AND LIME	2254
SHALE AND GYP	2310
ANHYDRITE, GYP AND SHALE	2370
SHALE AND LIME	2415
LIME	2508
SHALE AND LIME	2619
LIME	2735

Were open hole logs run? No

Date last log run:

Were unusual drilling circumstances encountered? No

Explanation:

Other Remarks

There are no Other Remarks.

Status: Accepted

API NO. 139-00079
OTC PROD.
UNIT NO.

(PLEASE TYPE OR USE BLACK INK ONLY)

OKLAHOMA CORPORATION COMMISSION

Oil & Gas Conservation Division

Post Office Box 52000

Oklahoma City, Oklahoma 73152-2000

Rule 165:10-3-25

RECEIVED

APR 24 2018

OKLAHOMA CORPORATION COMMISSION

Form 1002A

Rev. 2009

ORIGINAL
☒ AMENDED (Reason)

Return status to gas

COMPLETION REPORT

TYPE OF DRILLING OPERATION

☒ STRAIGHT HOLE ☐ DIRECTIONAL HOLE ☐ HORIZONTAL HOLE
☐ SERVICE WELL

If directional or horizontal, see reverse for bottom hole location.

COUNTY Texas SEC 21 TWP 03N RGE 12ECM
LEASE NAME Stonebraker A WELL NO. 1
NW 1/4 NW 1/4 NW 1/4 SE 1/4 FSL OF 1/4 SEC 2540 FWL OF 1/4 SEC 100
ELEVATION Derrick FL 3426 Ground 3414 Latitude (if known) Longitude (if known)
OPERATOR NAME Merit Energy Company OTC/OCC OPERATOR NO. 18934
ADDRESS 13727 Noel Road, Suite 1200
CITY Dallas STATE TX ZIP 75240

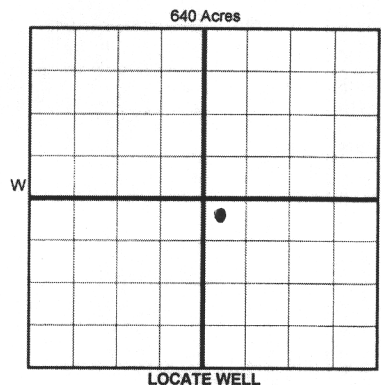

COMPLETION TYPE

☒ SINGLE ZONE
☐ MULTIPLE ZONE
Application Date
☐ COMMINGLED
Application Date
LOCATION EXCEPTION ORDER NO.
INCREASED DENSITY ORDER NO.

CASING & CEMENT (Form 1002C must be attached)

TYPE	SIZE	WEIGHT	GRADE	FEET	PSI	SAX	TOP OF CMT
CONDUCTOR							
SURFACE	8 5/8	22.7		393		200	Surface
INTERMEDIATE							
PRODUCTION	5 1/2	14		2765		700	Surface
LINER							

PACKER @ BRAND & TYPE PLUG @ TYPE PLUG @ TYPE TOTAL DEPTH 2770 2775
PACKER @ BRAND & TYPE PLUG @ TYPE PLUG @ TYPE

COMPLETION & TEST DATA BY PRODUCING FORMATION

451 GY HG

FORMATION	Hollenberg	Herington	U Krider	L Krider	Winfield	Guyman - Hughton
SPACING & SPACING ORDER NUMBER						
CLASS: Oil, Gas, Dry, Inj, Disp, Comm Disp, Svc	Gas	Gas	Gas	Gas	Gas	
PERFORATED INTERVALS	2616-2621 20 Shots	2648-2658 60 Shots	2670-2678 48 Shots	2690-2700 60 Shots	2730-2740 60 Shots	
ACID/VOLUME						
FRACTURE TREATMENT (Fluids/Prop Amounts)						

Min Gas Allowable (165:10-17-7)

Gas Purchaser/Measurer

☐

OR

First Sales Date

INITIAL TEST DATA

Oil Allowable (165:10-13-3)

INITIAL TEST DATE 5/3/1995 12-6-1950
OIL-BBL/DAY
OIL-GRAVITY (API)
GAS-MCF/DAY 10,200
GAS-OIL RATIO CU FT/BBL
WATER-BBL/DAY
PUMPING OR FLOWING flowing
INITIAL SHUT-IN PRESSURE 412#
CHOKE SIZE
FLOW TUBING PRESSURE

AS SUBMITTED

A record of the formations drilled through, and pertinent remarks are presented on the reverse. I declare that I have knowledge of the contents of this report and am authorized by my organization to make this report, which was prepared by me or under my supervision and direction, with the data and facts stated herein to be true, correct, and complete to the best of my knowledge and belief.

Katherine McClurkan
SIGNATURE
13727 Noel Road, Suite 1200
ADDRESS
Dallas TX 75240
CITY STATE ZIP
4/16/2018 972-628-1660
DATE PHONE NUMBER
kathy.mcclurkan@meritenergy.com
EMAIL ADDRESS

Give formation names and tops, if available, or descriptions and thickness of formations drilled through. Show intervals cored or drillstem tested.

LEASE NAME Stonebraker A WELL NO. 1

FOR COMMISSION USE ONLY	
ITD on file	<input type="checkbox"/> YES <input type="checkbox"/> NO
APPROVED	DISAPPROVED
2) Reject Codes	

Other remarks:	Gyp 1900', Gyp Shale & Anhyd 1912'; Shale & Gyp 1987'; Gyp Shale & Shells 2150'; Shale & Lime 2254'; Shale & Gyo 2310'; Anhyd, Gyo & Shale 2370'; Shale & Lime 2425'; Lime 2508'; Shale & Lime 2619'; Lime 2735

If more than three drainholes are proposed, attach a separate sheet indicating the necessary information.

Direction must be stated in degrees azimuth.
Please note, the horizontal drainhole and its end
point must be located within the boundaries of the
lease or spacing unit.

Directional surveys are required for all drainholes and directional wells.

BOTTOM HOLE LOCATION FOR DIRECTIONAL HOLE

BOTTOM HOLE LOCATION FOR HORIZONTAL HOLE: (LATERALS)

LATERAL #1

LATERAL #2

LATERAL #3

SEC	TWP	RGE	COUNTY			
Spot Location						
1/4	1/4	1/4	1/4	Feet From 1/4 Sec Lines	FSL	FWL
Depth of Deviation		Radius of Turn		Direction	Total Length	
Measured Total Depth		True Vertical Depth		BHL From Lease, Unit, or Property Line:		

API NO. 139-00079
OTC PROD UNIT NO. 139-013962

(PLEASE TYPE OR USE BLACK INK ONLY)

OKLAHOMA CORPORATION COMMISSION

Oil & Gas Conservation Division

Post Office Box 52000

Oklahoma City, Oklahoma 73152-2000

Rule 165:10-3-25

RECEIVED

APR 24 2018

OKLAHOMA CORPORATION COMMISSION

1016EZ

ORIGINAL
☒ AMENDED (Reason)

Return status to gas

COMPLETION REPORT

TYPE OF DRILLING OPERATION

☒ STRAIGHT HOLE ☐ DIRECTIONAL HOLE ☐ HORIZONTAL HOLE
☐ SERVICE WELL

If directional or horizontal, see reverse for bottom hole location.

COUNTY Texas SEC 21 TWP 03N RGE 12ECM
LEASE NAME Stonebraker A WELL NO. 1
NW 1/4 NW 1/4 NW 1/4 SE 1/4 FSL OF 1/4 SEC 2540 FWL OF 1/4 SEC 100
ELEVATION Derrick FL 3426 Ground 3414 Latitude (if known) Longitude (if known)
OPERATOR NAME Merit Energy Company OTC/OCC OPERATOR NO. 18934
ADDRESS 13727 Noel Road, Suite 1200
CITY Dallas STATE TX ZIP 75240

COMPLETION TYPE

☒ SINGLE ZONE
☐ MULTIPLE ZONE
Application Date
COMINGLED
Application Date
LOCATION EXCEPTION
ORDER NO.
INCREASED DENSITY
ORDER NO.

CASING & CEMENT (Form 1002C must be attached)

TYPE	SIZE	WEIGHT	GRADE	FEET	PSI	SAX	TOP OF CMT
CONDUCTOR							
SURFACE	8 5/8	22.7		393		200	Surface
INTERMEDIATE							
PRODUCTION	5 1/2	14		2765		700	Surface
LINER							

PACKER @ BRAND & TYPE PLUG @ TYPE PLUG @ TYPE
PACKER @ BRAND & TYPE PLUG @ TYPE PLUG @ TYPE

TOTAL DEPTH 2770

2775

COMPLETION & TEST DATA BY PRODUCING FORMATION

FORMATION	Hollenberg	Herington	U Krider	L Krider	Winfield	Guyman - Hughton
SPACING & SPACING ORDER NUMBER						
CLASS: Oil, Gas, Dry, Inj, Disp, Comm Disp, Svc	Gas	Gas	Gas	Gas	Gas	
	2616-2621	2648-2658	2670-2678	2690-2700	2730-2740	
PERFORATED INTERVALS	20 Shots	60 Shots	48 Shots	60 Shots	60 Shots	
ACID/VOLUME						
FRACTURE TREATMENT (Fluids/Prop Amounts)						

Corrected back to producing gas classification - original status reinstated.

Min Gas Allowable (165:10-17-7)
OR
Oil Allowable (165:10-13-3)

Gas Purchaser/Measurer
First Sales Date

INITIAL TEST DATA

INITIAL TEST DATE 5/3/1995 12-6-1950
OIL-BBL/DAY
OIL-GRAVITY (API)
GAS-MCF/DAY 10,200
GAS-OIL RATIO CU FT/BBL
WATER-BBL/DAY
PUMPING OR FLOWING flowing
INITIAL SHUT-IN PRESSURE 412#
CHOKE SIZE
FLOW TUBING PRESSURE

AS SUBMITTED

A record of the formations drilled through, and pertinent remarks are presented on the reverse. I declare that I have knowledge of the contents of this report and am authorized by my organization to make this report, which was prepared by me or under my supervision and direction, with the data and facts stated herein to be true, correct, and complete to the best of my knowledge and belief.
SIGNATURE Katherine McClurkan
13727 Noel Road, Suite 1200 Dallas TX 75240
ADDRESS CITY STATE ZIP
DATE 4/16/2018 PHONE NUMBER 972-628-1660
EMAIL ADDRESS kathy.mcclurkan@meritenergy.com