

Oklahoma Corporation Commission  
Oil & Gas Conservation Division  
Post Office Box 52000  
Oklahoma City, Oklahoma 73152-2000  
Rule 165: 10-3-25

Form 1002A

API No.: 35139243040002

**Completion Report**

Spud Date: November 19, 2007

OTC Prod. Unit No.:

Drilling Finished Date: November 22, 2007

**Amended**

1st Prod Date: January 19, 2008

Amend Reason: RETURN STATUS TO GAS

Completion Date: December 29, 2007

Recomplete Date: April 16, 2018

**Drill Type: STRAIGHT HOLE**

Well Name: JACKSON B 4

Purchaser/Measurer:

Location: TEXAS 7 5N 15E CM  
C N2 N2 NW  
2310 FSL 1320 FWL of 1/4 SEC  
Derrick Elevation: 3218 Ground Elevation: 3213

First Sales Date:

Operator: MERIT ENERGY COMPANY 18934

13727 NOEL RD STE 1200  
DALLAS, TX 75240-7312

Completion Type		Location Exception		Increased Density	
X	Single Zone	Order No		Order No	
	Multiple Zone	543306		There are no Increased Density records to display.	
	Commingled				

Casing and Cement							
Type	Size	Weight	Grade	Feet	PSI	SAX	Top of CMT
SURFACE	8 5/8	24	J-55	650		400	SURFACE
PRODUCTION	4 1/2	11.6	J-55	3268		640	674

Liner								
Type	Size	Weight	Grade	Length	PSI	SAX	Top Depth	Bottom Depth
There are no Liner records to display.								

**Total Depth: 3270**

Packer	
Depth	Brand & Type
There are no Packer records to display.	

Plug	
Depth	Plug Type
There are no Plug records to display.	

Initial Test Data										
Test Date	Formation	Oil BBL/Day	Oil-Gravity (API)	Gas MCF/Day	Gas-Oil Ratio Cu FT/BBL	Water BBL/Day	Pumpin or Flowing	Initial Shut-In Pressure	Choke Size	Flow Tubing Pressure
Mar 07, 2008	COUNCIL GROVE			17		85				

**Completion and Test Data by Producing Formation**

Formation Name: COUNCIL GROVE

Code: 451CCGV

Class: GAS

**Spacing Orders**

Order No	Unit Size
143591	640

**Perforated Intervals**

From	To
3011	3048

**Acid Volumes**

There are no Acid Volume records to display.
--

**Fracture Treatments**

273 BARRELS 75% N2 FOAM, 60,000 POUNDS 16/30 BROWN SAND
---

Formation	Top
HOLLENBERG	2656
CHASE GROUP	2680
KRIDER	2716
ODELL	2764
WINFIELD	2779
GAGE	2813
TOWANDA	2834
FORT RILEY	2890
WREFORD	2990
COUNCIL GROVE GROUP	3010
A1 LIME	3020
B1 SHALE	3072
B1 LIME	3080
B2 LIME	3104
B3 LIME	3128
B4 LIME	3142
B5 LIME	3153

Were open hole logs run? Yes

Date last log run: November 26, 2007

Were unusual drilling circumstances encountered? No

Explanation:

**Other Remarks**

There are no Other Remarks.

**FOR COMMISSION USE ONLY**

1139642

Status: Accepted

API NO. 139-24304  
OTC PROD.  
UNIT NO.

(PLEASE TYPE OR USE BLACK INK ONLY)

OKLAHOMA CORPORATION COMMISSION

Oil & Gas Conservation Division

Post Office Box 52000

Oklahoma City, Oklahoma 73152-2000

Rule 165:10-3-25

RECEIVED

APR 25 2018

OKLAHOMA CORPORATION COMMISSION

Form 1002A

Rev. 2009

ORIGINAL  
☒ AMENDED (Reason)

Return status to Gas

COMPLETION REPORT

TYPE OF DRILLING OPERATION

☒ STRAIGHT HOLE ☐ DIRECTIONAL HOLE ☐ HORIZONTAL HOLE  
☐ SERVICE WELL

If directional or horizontal, see reverse for bottom hole location.

COUNTY Texas SEC 7 TWP 05N RGE 15ECM  
LEASE NAME Jackson B WELL NO. 4  
C 1/4 N2 1/4 N2 1/4 NW 1/4 FSL OF 1/4 SEC 2310 FWL OF 1/4 SEC 1320  
ELEVATION Derrick FL 3218 Ground 3213 Latitude (if known) Longitude (if known)  
OPERATOR NAME Merit Energy Company OTC/OCC OPERATOR NO. 18934  
ADDRESS 13727 Noel Road, Suite 1200  
CITY Dallas STATE TX ZIP 75240

SPUD DATE 11/19/2007  
DRLG FINISHED DATE 11/22/2007  
DATE OF WELL COMPLETION 12/29/2007  
1st PROD DATE 01/19/2008  
RECOMP DATE 4-16-2018

640 Acres  
LOCATE WELL

COMPLETION TYPE

☒ SINGLE ZONE  
☐ MULTIPLE ZONE  
Application Date  
COMINGLED  
Application Date  
LOCATION EXCEPTION  
ORDER NO. 543306  
INCREASED DENSITY  
ORDER NO.

CASING & CEMENT (Form 1002C must be attached)

TYPE	SIZE	WEIGHT	GRADE	FEET	PSI	SAX	TOP OF CMT
CONDUCTOR							
SURFACE	8 5/8	24	J-55	650		400	Surface
INTERMEDIATE							
PRODUCTION	4 1/2	11.6	J-55	3268		640	674
LINER							
TOTAL DEPTH						3,270	

PACKER @ BRAND & TYPE PLUG @ TYPE PLUG @ TYPE  
PACKER @ BRAND & TYPE PLUG @ TYPE PLUG @ TYPE

COMPLETION & TEST DATA BY PRODUCING FORMATION

FORMATION Council Grove  
SPACING & SPACING ORDER NUMBER 143591 (640)  
CLASS: Oil, Gas, Dry, Inj, Disp, Comm Disp, Svc Gas  
PERFORATED INTERVALS 3011-3014 3021-3025 3034-3040 3044-3048  
ACID/VOLUME  
FRACTURE TREATMENT (Fluids/Prop Amounts) 273BBIs 75% N2 Foam 60,000# 16/30 Brown Sand

Min Gas Allowable (165:10-17-7) Gas Purchaser/Measurer  
OR First Sales Date  
Oil Allowable (165:10-13-3)

INITIAL TEST DATA

INITIAL TEST DATE 3/7/2008  
OIL-BBL/DAY 0  
OIL-GRAVITY (API)  
GAS-MCF/DAY 17  
GAS-OIL RATIO CU FT/BBL  
WATER-BBL/DAY 85  
PUMPING OR FLOWING  
INITIAL SHUT-IN PRESSURE  
CHOKE SIZE  
FLOW TUBING PRESSURE

AS SUBMITTED

A record of the formations drilled through, and pertinent remarks are presented on the reverse. I declare that I have knowledge of the contents of this report and am authorized by my organization to make this report, which was prepared by me or under my supervision and direction, with the data and facts stated herein to be true, correct, and complete to the best of my knowledge and belief.

SIGNATURE Katherine McClurkan 4/16/2018 972-628-1660  
13727 Noel Road, Suite 1200 Dallas TX 75240 kathy.mcclurkan@meritenergy.com  
ADDRESS CITY STATE ZIP EMAIL ADDRESS

PLEASE TYPE OR USE BLACK INK ONLY

## FORMATION RECORD

Give formation names and tops, if available, or descriptions and thickness of formations drilled through. Show intervals cored or drillstem tested.

LEASE NAME Jackson BWELL NO. 4

NAMES OF FORMATIONS	TOP
Hollenberg	2,656
Chase Group	2,680
Krider	2,716
Odell	2,764
Windfield	2,779
Gage	2,813
Towanda	2,834
Fort Riley	2,890
Wreford	2,990
Council Grove Group	3,010
A1 LM	3,020
B1 SH	3,072
B1 LM	3,080
B2 LM	3,104
B3 LM	3,128

FOR COMMISSION USE ONLY	
ITD on file <input type="checkbox"/> YES <input type="checkbox"/> NO	
APPROVED _____	DISAPPROVED _____
2) Reject Codes	
_____	
_____	
_____	
_____	

Were open hole logs run?	<u>X</u> yes <input type="checkbox"/> no
Date Last log was run	<u>11/26/2007</u>
Was CO <sub>2</sub> encountered?	<input type="checkbox"/> yes <input type="checkbox"/> no at what depths? _____
Was H <sub>2</sub> S encountered?	<input type="checkbox"/> yes <input type="checkbox"/> no at what depths? _____
Were unusual drilling circumstances encountered?	<input type="checkbox"/> yes <input type="checkbox"/> no
If yes, briefly explain below	

Other remarks: B4 LM 3142'; B5 LM 3153'

640 Acres

If more than three drainholes are proposed, attach a separate sheet indicating the necessary information.

Direction must be stated in degrees azimuth.  
Please note, the horizontal drainhole and its end point must be located within the boundaries of the lease or spacing unit.

Directional surveys are required for all drainholes and directional wells.

640 Acres

## BOTTOM HOLE LOCATION FOR DIRECTIONAL HOLE

SEC	TWP	RGE	COUNTY
Spot Location	1/4	1/4	1/4
Measured Total Depth	True Vertical Depth		BHL From Lease, Unit, or Property Line:

## BOTTOM HOLE LOCATION FOR HORIZONTAL HOLE: (LATERALS)

SEC	TWP	RGE	COUNTY
Spot Location	1/4	1/4	1/4
Depth of Deviation	Radius of Turn		Direction
Measured Total Depth	True Vertical Depth		BHL From Lease, Unit, or Property Line:

## LATERAL #2

SEC	TWP	RGE	COUNTY
Spot Location	1/4	1/4	1/4
Depth of Deviation	Radius of Turn		Direction
Measured Total Depth	True Vertical Depth		BHL From Lease, Unit, or Property Line:

## LATERAL #3

SEC	TWP	RGE	COUNTY
Spot Location	1/4	1/4	1/4
Depth of Deviation	Radius of Turn		Direction
Measured Total Depth	True Vertical Depth		BHL From Lease, Unit, or Property Line:

API NO. 139-24304  
OTC PROD.  
UNIT NO. 139-063909

(PLEASE TYPE OR USE BLACK INK ONLY)

OKLAHOMA CORPORATION COMMISSION

Oil & Gas Conservation Division  
Post Office Box 52000  
Oklahoma City, Oklahoma 73152-2000  
Rule 165:10-3-25

RECEIVED

Form 1002A

Rev. 2009

APR 25 2018

OKLAHOMA CORPORATION COMMISSION

ORIGINAL  
☒ AMENDED (Reason)

Return status to Gas

COMPLETION REPORT

TYPE OF DRILLING OPERATION

☒ STRAIGHT HOLE ☐ DIRECTIONAL HOLE ☐ HORIZONTAL HOLE  
☐ SERVICE WELL

If directional or horizontal, see reverse for bottom hole location.

COUNTY	Texas	SEC	7	TWP	05N	RGE	15ECM
LEASE NAME	Jackson B	WELL NO.	4	DATE OF WELL COMPLETION	12/29/2007	1st PROD DATE	01/19/2008
C	1/4 N2 1/4 N2 1/4 NW 1/4	FSL OF 1/4 SEC	2310	FWL OF 1/4 SEC	1320	RECOMP DATE	4-16-2018
ELEVATION Derrick FL	3218	Ground	3213	Latitude (if known)		Longitude (if known)	
OPERATOR NAME	Merit Energy Company	OTC/OCC OPERATOR NO.	18934				
ADDRESS	13727 Noel Road, Suite 1200						
CITY	Dallas	STATE	TX	ZIP	75240		

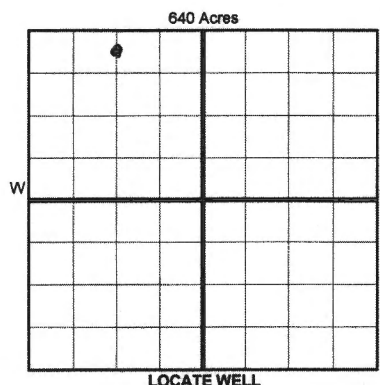

COMPLETION TYPE

<input checked="" type="checkbox"/> SINGLE ZONE
<input type="checkbox"/> MULTIPLE ZONE
Application Date
COMINGLED
Application Date
LOCATION EXCEPTION
ORDER NO. 543306
INCREASED DENSITY
ORDER NO.

CASING & CEMENT (Form 1002C must be attached)

TYPE	SIZE	WEIGHT	GRADE	FEET	PSI	SAX	TOP OF CMT
CONDUCTOR							
SURFACE	8 5/8	24	J-55	650		400	Surface
INTERMEDIATE							
PRODUCTION	4 1/2	11.6	J-55	3268		640	674
LINER							
						TOTAL DEPTH	3,270

PACKER @ BRAND & TYPE PLUG @ TYPE PLUG @ TYPE  
PACKER @ BRAND & TYPE PLUG @ TYPE PLUG @ TYPE

COMPLETION & TEST DATA BY PRODUCING FORMATION

FORMATION	Council Grove	No New Frac
SPACING & SPACING ORDER NUMBER	143591 (640)	
CLASS: Oil, Gas, Dry, Inj, Disp, Comm Disp, Svc	Gas	
PERFORATED INTERVALS	3011-3014 3021-3025 3034-3040	3044-3048
ACID/VOLUME		
FRACTURE TREATMENT (Fluids/Prop Amounts)	273BBIs 75% N2 Foam 60,000# 16/30 Brown Sand	

Min Gas Allowable (165:10-17-7)

Gas Purchaser/Measurer

OR  
Oil Allowable (165:10-13-3)

First Sales Date

INITIAL TEST DATA

INITIAL TEST DATE	3/7/2008
OIL-BBL/DAY	0
OIL-GRAVITY ( API)	
GAS-MCF/DAY	17
GAS-OIL RATIO CU FT/BBL	
WATER-BBL/DAY	85
PUMPING OR FLOWING	
INITIAL SHUT-IN PRESSURE	1-875
CHOKE SIZE	
FLOW TUBING PRESSURE	

AS SUBMITTED

A record of the formations drilled through, and pertinent remarks are presented on the reverse. I declare that I have knowledge of the contents of this report and am authorized by my organization to make this report, which was prepared by me or under my supervision and direction, with the data and facts stated herein to be true, correct, and complete to the best of my knowledge and belief.

Katherine McClurkan	Katherine McClurkan	4/16/2018	972-628-1660
SIGNATURE	NAME (PRINT OR TYPE)	DATE	PHONE NUMBER
13727 Noel Road, Suite 1200	Dallas TX 75240	kathy.mcclurkan@meritenergy.com	
ADDRESS	CITY STATE ZIP	EMAIL ADDRESS	