

Oklahoma Corporation Commission
Oil & Gas Conservation Division
Post Office Box 52000
Oklahoma City, Oklahoma 73152-2000
Rule 165: 10-3-25

Form 1002A

API No.: 35073257480000

Completion Report

Spud Date: October 02, 2017

OTC Prod. Unit No.:

Drilling Finished Date: October 12, 2017

1st Prod Date:

Completion Date: October 31, 2017

Drill Type: STRAIGHT HOLE

SERVICE WELL

Well Name: BIG GULP SWD 1

Purchaser/Measurer:

Location: KINGFISHER 30 18N 6W
NE NE NE SE
200 FNL 280 FEL of 1/4 SEC
Latitude: 36.007246 Longitude: -97.8722783
Derrick Elevation: 0 Ground Elevation: 1105

First Sales Date:

Operator: HINKLE OIL & GAS INC 21639

5600 N MAY AVE STE 295
OKLAHOMA CITY, OK 73112-4275

Completion Type		Location Exception		Increased Density	
X	Single Zone	Order No		Order No	
	Multiple Zone	There are no Location Exception records to display.		There are no Increased Density records to display.	
	Commingled				

Casing and Cement							
Type	Size	Weight	Grade	Feet	PSI	SAX	Top of CMT
CONDUCTOR	16			138			SURFACE
SURFACE	9 5/8	36	J-55	418		300	SURFACE
PRODUCTION	7	29	P-110	8665		295	6540

Liner								
Type	Size	Weight	Grade	Length	PSI	SAX	Top Depth	Bottom Depth
There are no Liner records to display.								

Total Depth: 8665

Packer		Plug	
Depth	Brand & Type	Depth	Plug Type
8355	AS-III	8600	SHOE JT.

Initial Test Data

Test Date	Formation	Oil BBL/Day	Oil-Gravity (API)	Gas MCF/Day	Gas-Oil Ratio Cu FT/BBL	Water BBL/Day	Pumpin or Flowing	Initial Shut-In Pressure	Choke Size	Flow Tubing Pressure
There are no Initial Data records to display.										
Completion and Test Data by Producing Formation										
Formation Name: WILCOX			Code: 202WLCX			Class: DISP				
Spacing Orders				Perforated Intervals						
Order No		Unit Size		From			To			
There are no Spacing Order records to display.				8390			8510			
Acid Volumes				Fracture Treatments						
8,000 GALLONS 15% HCL				189,924 GALLONS 20 & 25 BORATE GEL, 23,520 GALLONS LINEAR GEL, 461,920 POUNDS 20/40 SAND						

Formation	Top
COTTAGE GROVE	5738
CHECKERBOARD	6071
BIG LIME	6387
2ND OSWEGO	6468
3RD OSWEGO	6494
4TH OSWEGO	6520
VERDIGRIS	6630
PINK LIME	6740
RED FORK	6781
MISSISSIPPI	7108
WOODFORD	7604
HUNTON	7640
SYLVAN	7926
VIOLA	8036
1ST WILCOX	8355
TULIP CREEK	8540

Were open hole logs run? Yes

Date last log run: October 09, 2017

Were unusual drilling circumstances encountered? No

Explanation:

Other Remarks
OCC - UIC PERMIT NUMBER 1802050041

FOR COMMISSION USE ONLY	
Status: Accepted	1138358

API NO. 073-25748
OTC PROD.
UNIT NO.

PLEASE TYPE OR USE BLACK INK ONLY
NOTE:

Attach copy of original 1002A
if recompletion or reentry.

OKLAHOMA CORPORATION COMMISSION
Oil & Gas Conservation Division
Post Office Box 52000
Oklahoma City, Oklahoma 73152-2000
Rule 165:10-3-25

RECEIVED

NOV 03 2017

OKLAHOMA CORPORATION
COMMISSION

Form 1002A
Rev. 2009

☒ ORIGINAL
☐ AMENDED (Reason)

TYPE OF DRILLING OPERATION

☒ STRAIGHT HOLE ☐ DIRECTIONAL HOLE ☐ HORIZONTAL HOLE
☒ SERVICE WELL

If directional or horizontal, see reverse for bottom hole location.

COUNTY	Kingfisher	SEC	30	TWP	18N	RGE	06W
LEASE NAME	Big Gulp SWD			WELL NO.	1		
NE 1/4	NE 1/4	NE 1/4	SE 1/4	FNL OF 1/4 SEC	200'	FEL OF 1/4 SEC	280'
ELEVATION N Derrick	Ground	1105'	Latitude (if known)	36.007246		Longitude (if known)	-97.8722783
OPERATOR NAME	Hinkle Oil & Gas, Inc.			OTC/OCC OPERATOR NO.	21639		
ADDRESS	5600 N. May Avenue, Suite 295						
CITY	Oklahoma City	STATE	OK	ZIP	73112		

COMPLETION REPORT

SPUD DATE 10/2/2017
DRLG FINISHED DATE 10/12/2017
DATE OF WELL COMPLETION 10/31/2017
1st PROD DATE
RECOMP DATE

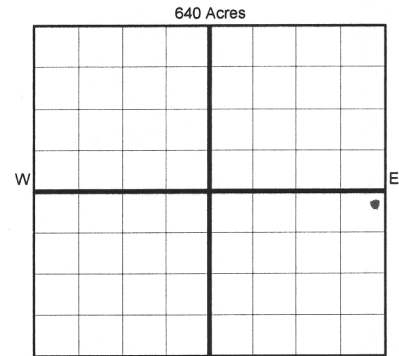

COMPLETION TYPE

<input checked="" type="checkbox"/> SINGLE ZONE
<input type="checkbox"/> MULTIPLE ZONE
Application Date
<input type="checkbox"/> COMMINGLED
Application Date
LOCATION
EXCEPTION ORDER
INCREASED DENSITY
ORDER NO.

CASING & CEMENT (Form 1002C must be attached)

TYPE	SIZE	WEIGHT	GRADE	FEET	PSI	SAX	TOP OF CMT
CONDUCTOR	16			138'			Surface
SURFACE	9 5/8"	36#	J-55	418'		300	Surface
INTERMEDIATE							
PRODUCTION	7"	29#	P110	8665'		295	6540'
LINER							
TOTAL DEPTH							8665'

PACKER @ 8355' BRAND & TYPE AS-III PLUG @ 8600' TYPE Shoe Jt. PLUG @ TYPE
PACKER @ BRAND & TYPE PLUG @ TYPE PLUG @ TYPE

COMPLETION & TEST DATA BY PRODUCING FORMATION

FORMATION	Wilcox						
SPACING & SPACING ORDER NUMBER	1802050041	see remarks					Reported to Flow Focus
CLASS: Oil, Gas, Dry, Inj, Disp, Comm Disp, Svc	Disposal						
PERFORATED INTERVALS	8390'-8430'	(6 spf - 240 Total)					
	8450'-8510'	(6 spf - 360 Total)					
ACID/VOLUME							
FRACTURE TREATMENT (Fluids/Prop Amounts)	8000 Gal. 15% HCL						
	189924 Gal. 20&25	BorateGel, 23520	Gal. Linear Gel				
	461920# 20/40 Sand						

Min Gas Allowable (165:10-17-7)

Gas Purchaser/Measurer

☐

OR

First Sales Date

INITIAL TEST DATA

Oil Allowable (165:10-13-3)

INITIAL TEST DATE	N/A						
OIL-BBL/DAY							
OIL-GRAVITY (API)							
GAS-MCF/DAY							
GAS-OIL RATIO CU FT/BBL							
WATER-BBL/DAY							
PUMPING OR FLOWING							
INITIAL SHUT-IN PRESSURE							
CHOKE SIZE							
FLOW TUBING PRESSURE							

A record of the formations drilled through, and pertinent remarks are presented on the reverse. I declare that I have knowledge of the contents of this report and am authorized by my organization to make this report, which was prepared by me or under my supervision and direction, with the data and facts stated herein to be true, correct, and complete to the best of my knowledge and belief.

B. Hinkle
SIGNATURE
5600 N. May Avenue, Suite 295
ADDRESS
Oklahoma City
CITY
OK
STATE
73112
ZIP
11/2/2017
DATE
405-848-0924
PHONE NUMBER
Laurahinkle@hoagi.com
EMAIL ADDRESS

PLEASE TYPE OR USE BLACK INK ONLY
FORMATION RECORD

Give formation names and tops, if available, or descriptions and thickness of formations drilled through. Show intervals cored or drillstem tested.

NAMES OF FORMATIONS	TOP
Cottage Grove	5738' TVD
Checkerboard	6071'
Big Lime	6387'
2nd Oswego	6468'
3rd Oswego	6494'
4th Oswego	6520'
Verdigris	6630'
Pink Lime	6740'
Red Fork	6781'
Mississippi	7108'
Woodford	7604'
Hunton	7640'
Sylvan	7926'
Viola	8036'
1st Wilcox	8355'

LEASE NAME Big Gulp SWD WELL NO. 1

FOR COMMISSION USE ONLY	
ITD on file <input type="checkbox"/> YES <input type="checkbox"/> NO	
APPROVED _____	DISAPPROVED _____
2) Reject Codes _____	

Were open hole logs run?	<input checked="" type="checkbox"/> yes <input type="checkbox"/> no
Date Last log was run	<u>10/9/2017</u>
Was CO ₂ encountered?	<input type="checkbox"/> yes <input checked="" type="checkbox"/> no at what depths? _____
Was H ₂ S encountered?	<input type="checkbox"/> yes <input checked="" type="checkbox"/> no at what depths? _____
Were unusual drilling circumstances encountered?	<input type="checkbox"/> yes <input checked="" type="checkbox"/> no
If yes, briefly explain below _____	

Other remarks: Tulip Creek 8540'

OCC - UIC permit #1802050041

640 Acres

If more than three drainholes are proposed, attach a separate sheet indicating the necessary information.

Direction must be stated in degrees azimuth. Please note, the horizontal drainhole and its end point must be located within the boundaries of the lease or spacing unit.

Directional surveys are required for all drainholes and directional wells.

640 Acres

BOTTOM HOLE LOCATION FOR DIRECTIONAL HOLE

SEC	TWP	RGE	COUNTY
Spot Location	1/4	1/4	1/4
Measured Total Depth	True Vertical Depth		BHL From Lease, Unit, or Property Line:
Feet From 1/4 Sec Lines	FSL	FWL	

BOTTOM HOLE LOCATION FOR HORIZONTAL HOLE: (LATERALS)

LATERAL #1

SEC	TWP	RGE	COUNTY
Spot Location	1/4	1/4	1/4
Depth of Deviation	Radius of Turn		Direction
Measured Total Depth	True Vertical Depth		BHL From Lease, Unit, or Property Line:
Feet From 1/4 Sec Lines	FNL	FEL	
Total Length			

LATERAL #2

SEC	TWP	RGE	COUNTY
Spot Location	1/4	1/4	1/4
Depth of Deviation	Radius of Turn		Direction
Measured Total Depth	True Vertical Depth		BHL From Lease, Unit, or Property Line:
Feet From 1/4 Sec Lines	FSL	FWL	
Total Length			

LATERAL #3

SEC	TWP	RGE	COUNTY
Spot Location	1/4	1/4	1/4
Depth of Deviation	Radius of Turn		Direction
Measured Total Depth	True Vertical Depth		BHL From Lease, Unit, or Property Line:
Feet From 1/4 Sec Lines	FSL	FWL	
Total Length			