

Oklahoma Corporation Commission
Oil & Gas Conservation Division
Post Office Box 52000
Oklahoma City, Oklahoma 73152-2000
Rule 165: 10-3-25

Form 1002A

API No.: 35071248700000

Completion Report

Spud Date: September 07, 2017

OTC Prod. Unit No.:

Drilling Finished Date: September 12, 2017

1st Prod Date: October 30, 2017

Completion Date: October 11, 2017

Drill Type: STRAIGHT HOLE

Well Name: STORMY 6

Purchaser/Measurer:

Location: KAY 33 25N 1W
NE NE NW SE
2475 FSL 1270 FWL of 1/4 SEC
Derrick Elevation: 994 Ground Elevation: 981

First Sales Date:

Operator: DONRAY PETROLEUM LLC 21690

2525 NW EXPRESSWAY STE 640
OKLAHOMA CITY, OK 73112-7230

| Completion Type | | Location Exception | | Increased Density | |
|-----------------|---------------|--------------------|--|-------------------|--|
| X | Single Zone | Order No | | Order No | |
| | Multiple Zone | 662209 | | 662910 | |
| | Commingled | | | | |

| Casing and Cement | | | | | | | |
|-------------------|------|--------|-------|------|-----|-----|------------|
| Type | Size | Weight | Grade | Feet | PSI | SAX | Top of CMT |
| SURFACE | 8.58 | 32 | | 312 | | 185 | SURFACE |
| PRODUCTION | 5.5 | 17 | | 2746 | | 250 | 1600 |

| Liner | | | | | | | | |
|--|------|--------|-------|--------|-----|-----|-----------|--------------|
| Type | Size | Weight | Grade | Length | PSI | SAX | Top Depth | Bottom Depth |
| There are no Liner records to display. | | | | | | | | |

Total Depth: 2776

| Packer | | Plug | |
|---|--------------|-------|-----------|
| Depth | Brand & Type | Depth | Plug Type |
| There are no Packer records to display. | | 2746 | CIBP |

| Initial Test Data | | | | | | | | | | |
|-------------------|-----------|-------------|-------------------|-------------|-------------------------|---------------|-------------------|--------------------------|------------|----------------------|
| Test Date | Formation | Oil BBL/Day | Oil-Gravity (API) | Gas MCF/Day | Gas-Oil Ratio Cu FT/BBL | Water BBL/Day | Pumpin or Flowing | Initial Shut-In Pressure | Choke Size | Flow Tubing Pressure |
| Oct 30, 2017 | TONKAWA | 18 | 40 | 30 | 1666 | 650 | PUMPING | 600 | | |

Completion and Test Data by Producing Formation

Formation Name: TONKAWA

Code: 406TNKW

Class: OIL

Spacing Orders

| Order No | Unit Size |
|----------|-----------|
| 647452 | 40 |

Perforated Intervals

| From | To |
|------|------|
| 2556 | 2600 |

Acid Volumes

| |
|---------------------|
| 750 GALLONS 12% HCL |
|---------------------|

Fracture Treatments

| |
|-----------------------------|
| 500 BSW, 22,500 POUNDS SAND |
|-----------------------------|

| Formation | Top |
|------------|------|
| NEWKIRK | 1600 |
| PAWHUSKA | 1850 |
| HOOVER | 1900 |
| ELGIN | 2050 |
| CARMICHAEL | 2150 |
| OREAD | 2170 |
| ENDICOTT | 2300 |
| LOVELL | 2400 |
| TONKAWA | 2550 |

Were open hole logs run? Yes

Date last log run: September 11, 2017

Were unusual drilling circumstances encountered? No

Explanation:

Other Remarks

There are no Other Remarks.

FOR COMMISSION USE ONLY

1138345

Status: Accepted

API NO. 07124870
OTC PROD UNIT NO. 071222251

PLEASE TYPE OR USE BLACK INK ONLY

NOTE:

Attach copy of original 1002A if recompletion or reentry.

OKLAHOMA CORPORATION COMMISSION

Oil & Gas Conservation Division
Post Office Box 52000
Oklahoma City, Oklahoma 73152-2000
Rule 165:10-3-25

RECEIVED

NOV 29 2017

OKLAHOMA CORPORATION COMMISSION

Form 1002A
Rev. 2009

☒ ORIGINAL
☐ AMENDED (Reason)

COMPLETION REPORT

TYPE OF DRILLING OPERATION

☒ STRAIGHT HOLE ☐ DIRECTIONAL HOLE ☐ HORIZONTAL HOLE
☐ SERVICE WELL

If directional or horizontal, see reverse for bottom hole location.

| | | | | | | | | | |
|-----------------------------|--------------------------|--------|-------|---------------------|----------------------|----------------------|----------|-------------------------|----------|
| COUNTY | kay | SEC | 33 | TWP | 25n | RGE | 1w | SPUD DATE | 9-7-17 |
| LEASE NAME | stormy | | | WELL NO. | 6 | DRLG FINISHED DATE | 9-12-17 | DATE OF WELL COMPLETION | 10-11-17 |
| ne 1/4 ne 1/4 nw 1/4 se 1/4 | FSL OF 1/4 SEC 2475 | | | FWL OF 1/4 SEC 1270 | 1st PROD DATE | | 10-30-17 | | |
| ELEVATION Derrick FL | 994 | Ground | 981 | Latitude (if known) | | Longitude (if known) | | | |
| OPERATOR NAME | donray petroleum llc. | | | | OTC/OCC OPERATOR NO. | 21690 | | | |
| ADDRESS | 2525 nw expressway # 640 | | | | | | | | |
| CITY | okc | | STATE | ok | | ZIP | 73112 | | |

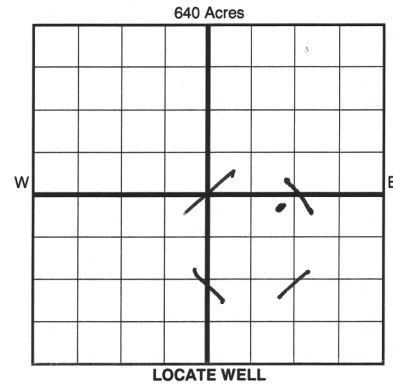

COMPLETION TYPE

| |
|---|
| <input checked="" type="checkbox"/> SINGLE ZONE |
| <input type="checkbox"/> MULTIPLE ZONE |
| Application Date |
| <input type="checkbox"/> COMMINGLED |
| Application Date |
| LOCATION |
| EXCEPTION ORDER |
| INCREASED DENSITY |
| ORDER NO. 662910-002017009331 |

CASING & CEMENT (Form 1002C must be attached)

| TYPE | SIZE | WEIGHT | GRADE | FEET | PSI | SAX | TOP OF CMT |
|--------------|------|--------|-------|------|-----|-------|------------|
| CONDUCTOR | | | | | | | |
| SURFACE | 8.58 | 32 | | 312 | | 185 | surface |
| INTERMEDIATE | | | | | | | |
| PRODUCTION | 5.5 | 17 | | 2746 | | 250 | 1600 |
| LINER | | | | | | | |
| TOTAL DEPTH | | | | | | 2,776 | |

PACKER @ _____ BRAND & TYPE _____ PLUG @ 2746 TYPE cibp PLUG @ _____ TYPE _____
PACKER @ _____ BRAND & TYPE _____ PLUG @ _____ TYPE _____ PLUG @ _____ TYPE _____

COMPLETION & TEST DATA BY PRODUCING FORMATION

406 TNKW

| | | | | | | | | | |
|---|-----------------|--|--|--|--|--|--|--|--|
| FORMATION | tonkawa | | | | | | | | |
| SPACING & SPACING ORDER NUMBER | 647452 (40) | | | | | | | | |
| CLASS: Oil, Gas, Dry, Inj, Disp, Comm Disp, Svc | oil | | | | | | | | |
| PERFORATED INTERVALS | 2556-60/ 62-64 | | | | | | | | |
| | 2568-70 | | | | | | | | |
| | 2586-2600 | | | | | | | | |
| ACID/VOLUME | 750 gal 12% hcl | | | | | | | | |
| FRACTURE TREATMENT (Fluids/Prop Amounts) | 500bsw | | | | | | | | |
| | 22500# snd | | | | | | | | |
| | | | | | | | | | |

Monitor
Report to
Frac Focus

Min Gas Allowable (165:10-17-7)

Gas Purchaser/Measurer

OR
Oil Allowable (165:10-13-3)

First Sales Date

INITIAL TEST DATA

| | | | | | | |
|--------------------------|------------|--|--|--|--|--|
| INITIAL TEST DATE | 10/30/2017 | | | | | |
| OIL-BBL/DAY | 18 bpd | | | | | |
| OIL-GRAVITY (API) | 40 | | | | | |
| GAS-MCF/DAY | 30 mcfpd | | | | | |
| GAS-OIL RATIO CU FT/BBL | 1666 | | | | | |
| WATER-BBL/DAY | 650 bpd | | | | | |
| PUMPING OR FLOWING | pump | | | | | |
| INITIAL SHUT-IN PRESSURE | 600# | | | | | |
| CHOKE SIZE | | | | | | |
| FLOW TUBING PRESSURE | | | | | | |

AS SUBMITTED

A record of the formation drilled through, and pertinent remarks are presented on the reverse. I declare that I have knowledge of the contents of this report and am authorized by my organization to make this report, which was prepared by me or under my supervision and direction, with the data and facts stated herein to be true, correct, and complete to the best of my knowledge and belief.

| | | | |
|-------------------------|----------------------|-------------------------|----------------|
| SIGNATURE | NAME (PRINT OR TYPE) | DATE | PHONE NUMBER |
| 2525 nw expressway #640 | okc ok 73112 | 11/28/2017 | (405) 418-4348 |
| ADDRESS | CITY STATE ZIP | EMAIL ADDRESS | |
| | | ray@donraypetroleum.com | |

FORMATION RECORD

LEASE NAME stormy WELL NO. 6

| NAMES OF FORMATIONS | TOP |
|---------------------|-------|
| newkirk | 1,600 |
| pawhuska | 1,850 |
| hoover | 1900 |
| elgin | 2,050 |
| carmichael | 2,150 |
| oread | 2,170 |
| endicott | 2,300 |
| lovell | 2,400 |
| tonkawa | 2,550 |

| FOR COMMISSION USE ONLY | | |
|-------------------------|------------------------------|-----------------------------|
| ITD on file | <input type="checkbox"/> YES | <input type="checkbox"/> NO |
| APPROVED | DISAPPROVED | 2) Reject Codes |
| | | |

Were open hole logs run? X yes _____ no

Date Last log was run 9/11/2017

Was CO₂ encountered? _____ yes X no at what depths? _____

Was H₂S encountered? _____ yes X no at what depths? _____

Were unusual drilling circumstances encountered? _____ yes X no

If yes, briefly explain below

| | |
|--|--|
| | |
| | |
| | |
| | |
| | |
| | |

A blank 10x10 grid with a bold cross dividing it into four 5x5 quadrants. The grid is used for plotting a graph.

Direction must be stated in degrees azimuth.
Please note, the horizontal drainhole and its end point must be located within the boundaries of the lease or spacing unit.

A blank 10x10 grid with a bold cross dividing it into four 5x5 quadrants. The grid is used for plotting a graph.

| | | | | | |
|----------------------|-----|---------------------|---|-----|-----|
| SEC | TWP | RGE | COUNTY | | |
| Spot Location | | | Feet From 1/4 Sec Lines | FSL | FWL |
| 1/4 | 1/4 | 1/4 | 1/4 | | |
| Measured Total Depth | | True Vertical Depth | BHL From Lease, Unit, or Property Line: | | |

| LATERAL #1 | | | | | | |
|----------------------|-----|---------------------|--------|---|-------------------------|--------------|
| SEC | TWP | RGE | COUNTY | | | |
| Spot Location | | | | | | |
| 1/4 | | 1/4 | | 1/4 | Feet From 1/4 Sec Lines | FSL |
| Depth of Deviation | | Radius of Turn | | Direction | | Total Length |
| Measured Total Depth | | True Vertical Depth | | BHL From Lease, Unit, or Property Line: | | |

| | | | | | | |
|----------------------|-----|---------------------|--------|---|--------------|-----|
| SEC | TWP | RGE | COUNTY | | | |
| Spot Location | | | | | | |
| 1/4 | 1/4 | 1/4 | 1/4 | Feet From 1/4 Sec Lines | FSL | FWL |
| Depth of Deviation | | Radius of Turn | | Direction | Total Length | |
| Measured Total Depth | | True Vertical Depth | | BHL From Lease, Unit, or Property Line: | | |

| | | | | | | |
|----------------------|-----|---------------------|--------|---|--------------|-----|
| SEC | TWP | RGE | COUNTY | | | |
| Spot Location | | | | | | |
| 1/4 | 1/4 | 1/4 | 1/4 | Feet From 1/4 Sec Lines | FSL | FWL |
| Depth of Deviation | | Radius of Turn | | Direction | Total Length | |
| Measured Total Depth | | True Vertical Depth | | BHL From Lease, Unit, or Property Line: | | |