

Oklahoma Corporation Commission
Oil & Gas Conservation Division
Post Office Box 52000
Oklahoma City, Oklahoma 73152-2000
Rule 165: 10-3-25

Form 1002A

API No.: 35003219000003

Completion Report

Spud Date: May 09, 2008

OTC Prod. Unit No.: 003-123738

Drilling Finished Date: May 15, 2008

1st Prod Date: June 03, 2008

Amended

Completion Date: June 03, 2008

Amend Reason: CHANGE BACK TO GAS

Drill Type: STRAIGHT HOLE

Min Gas Allowable: Yes

Well Name: DIEL 2-24

Purchaser/Measurer:

Location: ALFALFA 24 27N 12W
C SW SE
660 FSL 660 FWL of 1/4 SEC
Derrick Elevation: 0 Ground Elevation: 1223

First Sales Date:

Operator: SANDRIDGE EXPLORATION & PRODUCTION LLC 22281

123 ROBERT S KERR AVE STE 1702
OKLAHOMA CITY, OK 73102-6406

Completion Type	
	Single Zone
	Multiple Zone
X	Commingled

Location Exception
Order No
There are no Location Exception records to display.

Increased Density
Order No
553487

Casing and Cement							
Type	Size	Weight	Grade	Feet	PSI	SAX	Top of CMT
CONDUCTOR	20			80		12	SURFACE
SURFACE	8 5/8	24	J-55	1010		720	SURFACE
PRODUCTION	5 1/2	17	J-55	5500		250	3724

Liner								
Type	Size	Weight	Grade	Length	PSI	SAX	Top Depth	Bottom Depth
There are no Liner records to display.								

Total Depth: 5500

Packer	
Depth	Brand & Type
There are no Packer records to display.	

Plug	
Depth	Plug Type
There are no Plug records to display.	

Initial Test Data

Test Date	Formation	Oil BBL/Day	Oil-Gravity (API)	Gas MCF/Day	Gas-Oil Ratio Cu FT/BBL	Water BBL/Day	Pumpin or Flowing	Initial Shut-In Pressure	Choke Size	Flow Tubing Pressure
Jun 16, 2008	CHEROKEE-MISSISSIPPI LIME			13		37	PUMPING	1500	24/64	62

Completion and Test Data by Producing Formation									
Formation Name: CHEROKEE			Code: 404CHRK			Class: GAS			
Spacing Orders					Perforated Intervals				
Order No		Unit Size			From		To		
122698		320			5294		5303		
Acid Volumes					Fracture Treatments				
4,500 GALLONS ACID					4,625 BARRELS FLUID, 78,000 POUNDS PROPPANT				
Formation Name: MISSISSIPPI LIME			Code: 351MSSLM			Class: GAS			
Spacing Orders					Perforated Intervals				
Order No		Unit Size			From		To		
553709		320			5312		5324		
Acid Volumes					Fracture Treatments				
4,500 GALLONS ACID					4,625 BARRELS FLUID, 78,000 POUNDS PROPPANT				
Formation Name: CHEROKEE-MISSISSIPPI LIME			Code:			Class: GAS			

Formation	Top
CHEROKEE	5291
MISSISSIPPI LIME	5311

Were open hole logs run? Yes
 Date last log run: May 27, 2008

 Were unusual drilling circumstances encountered? No
 Explanation:

Other Remarks
There are no Other Remarks.

FOR COMMISSION USE ONLY	
Status: Accepted	1139415

API NO. 003-21900-03
OTC PROD. 003-123738
UNIT NO.

(PLEASE TYPE OR USE BLACK INK ONLY)

OKLAHOMA CORPORATION COMMISSION

Oil & Gas Conservation Division

Post Office Box 52000

Oklahoma City, Oklahoma 73152-2000

Rule 165:10-3-25

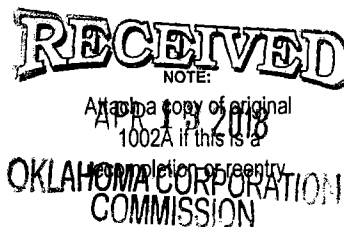

Form 1002A

Rev. 2009

☐ ORIGINAL
☒ AMENDED (Reason)

CHANGE BACK TO GAS

COMPLETION REPORT

TYPE OF DRILLING OPERATION

☒ STRAIGHT HOLE ☐ DIRECTIONAL HOLE ☐ HORIZONTAL HOLE
☐ SERVICE WELL

If directional or horizontal, see reverse for bottom hole location.

COUNTY ALFALFA SEC 24 TWP 27N RGE 12W
LEASE NAME DIEL WELL NO. 2-24
1/4 C 1/4 SW 1/4 SE 1/4 FSL OF 1/4 SEC 660 FWL OF 1/4 SEC 660
ELEVATION Derrick FL Ground 1223 Latitude (if known) Longitude (if known)
OPERATOR NAME SANDRIDGE EXPL. AND PROD., LLC OTC/OCC OPERATOR NO. 22281
ADDRESS 123 ROBERT S. KERR AVE.
CITY OKLAHOMA CITY STATE OK ZIP 73102

SPUD DATE 5/9/2008
DRLG FINISHED DATE 5/15/2008
DATE OF WELL COMPLETION 6/3/2008
1st PROD DATE 6/3/2008
RECOMP DATE

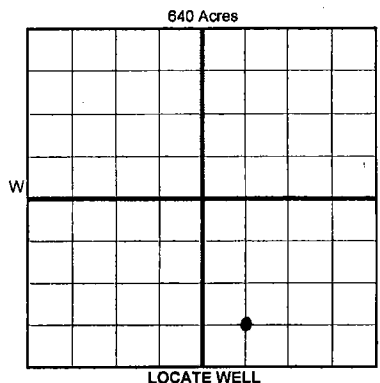

COMPLETION TYPE

☐ SINGLE ZONE
☐ MULTIPLE ZONE
☒ COMMINGLED
LOCATION EXCEPTION ORDER NO. 553487
INCREASED DENSITY ORDER NO.

CASING & CEMENT (Form 1002C must be attached)

TYPE	SIZE	WEIGHT	GRADE	FEET	PSI	SAX	TOP OF CMT
CONDUCTOR	20			80		12	SURFACE
SURFACE	8 5/8	24	J-55	1010		720	SURFACE
INTERMEDIATE							
PRODUCTION	5 1/2	17	J-55	5500		250	3724
LINER							
						TOTAL DEPTH	5,500

PACKER @ BRAND & TYPE PLUG @ TYPE PLUG @ TYPE
PACKER @ BRAND & TYPE PLUG @ TYPE PLUG @ TYPE

COMPLETION & TEST DATA BY PRODUCING FORMATION

FORMATION	CHEROKEE	MISS LIME	Mississippi Lime		
SPACING & SPACING ORDER NUMBER	122698/320	553709/320			
CLASS: Oil, Gas, Dry, Inj, Disp, Comm Disp, Svc	GAS	GAS			
PERFORATED INTERVALS	5294-5303	5312-5324			
ACID/VOLUME	4500 GAL ACID	TREATED /W			
FRACTURE TREATMENT (Fluids/Prop Amounts)	4625 BBLS FLUID	TREATED /W			
	78000# PROPPANT	CHEROKEE			

Min Gas Allowable (165:10-17-7) Gas Purchaser/Measurer
OR First Sales Date
Oil Allowable (165:10-13-3)

INITIAL TEST DATA

INITIAL TEST DATE	6/16/2008				
OIL-BBL/DAY	0				
OIL-GRAVITY (API)					
GAS-MCF/DAY	13				
GAS-OIL RATIO CU FT/BBL					
WATER-BBL/DAY	37				
PUMPING OR FLOWING	PUMPING				
INITIAL SHUT-IN PRESSURE	1500				
CHOKE SIZE	24/64				
FLOW TUBING PRESSURE	62				

AS SUBMITTED

A review of the formations drilled through, and pertinent remarks are presented on the reverse. I declare that I have knowledge of the contents of this report and am authorized by my organization to make this report, which was prepared by me or under my supervision and direction, with the data and facts stated herein to be true, correct, and complete to the best of my knowledge and belief.

SIGNATURE LACI BEVANS DATE 4/12/2018 PHONE NUMBER (405) 429-5610
123 ROBERT S. KERR AVE. OKLAHOMA CITY OK 73102 LBEVANS@SANDRIDGEENERGY.COM
ADDRESS CITY STATE ZIP EMAIL ADDRESS

PLEASE TYPE OR USE BLACK INK ONLY

FORMATION RECORD

Give formation names and tops, if available, or descriptions and thickness of formations drilled through. Show intervals cored or drillstem tested.

LEASE NAME _____

WELL NO. _____

NAMES OF FORMATIONS	TOP
CHEROKEE	5,291
MISSISSIPPI LIME	5,311

FOR COMMISSION USE ONLY

ITD on file ☐ YES ☐ NO

APPROVED _____ DISAPPROVED _____

2) Reject Codes _____

Were open hole logs run? X yes ____ no

Date Last log was run 5/27/2008

Was CO₂ encountered? ____ yes ____ no at what depths? _____

Was H₂S encountered? ____ yes ____ no at what depths? _____

Were unusual drilling circumstances encountered? ____ yes ____ no
If yes, briefly explain below

Other remarks: _____

640 Acres

If more than three drainholes are proposed, attach a separate sheet indicating the necessary information.

Direction must be stated in degrees azimuth.
Please note, the horizontal drainhole and its end point must be located within the boundaries of the lease or spacing unit.

Directional surveys are required for all drainholes and directional wells.

640 Acres

BOTTOM HOLE LOCATION FOR DIRECTIONAL HOLE

SEC	TWP	RGE	COUNTY
Spot Location			
1/4	1/4	1/4	1/4
Measured Total Depth		True Vertical Depth	BHL From Lease, Unit, or Property Line:

BOTTOM HOLE LOCATION FOR HORIZONTAL HOLE: (LATERALS)

LATERAL #1

SEC	TWP	RGE	COUNTY
Spot Location			
1/4	1/4	1/4	1/4
Depth of Deviation		Radius of Turn	Direction
Measured Total Depth		True Vertical Depth	BHL From Lease, Unit, or Property Line:

LATERAL #2

SEC	TWP	RGE	COUNTY
Spot Location			
1/4	1/4	1/4	1/4
Depth of Deviation		Radius of Turn	Direction
Measured Total Depth		True Vertical Depth	BHL From Lease, Unit, or Property Line:

LATERAL #3

SEC	TWP	RGE	COUNTY
Spot Location			
1/4	1/4	1/4	1/4
Depth of Deviation		Radius of Turn	Direction
Measured Total Depth		True Vertical Depth	BHL From Lease, Unit, or Property Line:

API NO. 003-21900-03
OTC PROD. 003-123738
UNIT NO.

(PLEASE TYPE OR USE BLACK INK ONLY)

☐ ORIGINAL
☒ AMENDED (Reason)

CHANGE BACK TO GAS

OKLAHOMA CORPORATION COMMISSION
Oil & Gas Conservation Division
Post Office Box 52000
Oklahoma City, Oklahoma 73152-2000
Rule 165:10-3-25

COMPLETION REPORT

TYPE OF DRILLING OPERATION

☒ STRAIGHT HOLE ☐ DIRECTIONAL HOLE ☐ HORIZONTAL HOLE
☐ SERVICE WELL

If directional or horizontal, see reverse for bottom hole location.

COUNTY ALFALFA SEC 24 TWP 27N RGE 12W
LEASE NAME DIEL
WELL NO. 2-24
1st PROD DATE 6/3/2008
RECOMP DATE
ELEVATION Ground 1223
FSL OF 1/4 SEC 660 FWL OF 1/4 SEC 660
Latitude (if known) Longitude (if known)
OPERATOR NAME SANDRIDGE EXPL. AND PROD., LLC OTC/OCC OPERATOR NO. 22281
ADDRESS 123 ROBERT S. KERR AVE.
CITY OKLAHOMA CITY STATE OK ZIP 73102

SPUD DATE 5/9/2008
DRLG FINISHED DATE 5/15/2008
DATE OF WELL COMPLETION 6/3/2008
1st PROD DATE 6/3/2008
RECOMP DATE

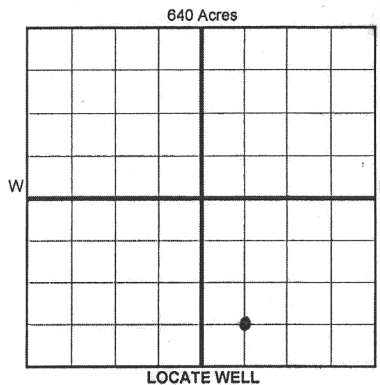

COMPLETION TYPE

☐ SINGLE ZONE
☐ MULTIPLE ZONE
☒ COMMINGLED
LOCATION EXCEPTION ORDER NO. 553487
INCREASED DENSITY ORDER NO.

CASING & CEMENT (Form 1002C must be attached)

TYPE	SIZE	WEIGHT	GRADE	FEET	PSI	SAX	TOP OF CMT
CONDUCTOR	20			80		12	SURFACE
SURFACE	8 5/8	24	J-55	1010		720	SURFACE
INTERMEDIATE							
PRODUCTION	5 1/2	17	J-55	5500		250	3724
LINER							

PACKER @ BRAND & TYPE PLUG @ TYPE PLUG @ TYPE TOTAL DEPTH 5,500
PACKER @ BRAND & TYPE PLUG @ TYPE PLUG @ TYPE

COMPLETION & TEST DATA BY PRODUCING FORMATION

FORMATION	CHEROKEE	MISS LIME	
SPACING & SPACING ORDER NUMBER	122698/320	553709/320	
CLASS: Oil, Gas, Dry, Inj, Disp, Comm Disp, Svc	GAS	GAS	
PERFORATED INTERVALS	5294-5303	5312-5324	
ACID/VOLUME	4500 GAL ACID	TREATED W/	
FRACTURE TREATMENT (Fluids/Prop Amounts)	4625 BBLs FLUID	TREATED W/	
	78000# PROPPANT	CHEROKEE	

Min Gas Allowable (165:10-17-7) Gas Purchaser/Measurer
OR
Oil Allowable (165:10-13-3) First Sales Date 6/3/08

INITIAL TEST DATA

INITIAL TEST DATE	6/16/2008		
OIL-BBL/DAY	0		
OIL-GRAVITY (API)			
GAS-MCF/DAY	13		
GAS-OIL RATIO CU FT/BBL			
WATER-BBL/DAY	37		
PUMPING OR FLOWING	PUMPING		
INITIAL SHUT-IN PRESSURE	1500		
CHOKE SIZE	24/64		
FLOW TUBING PRESSURE	62		

AS SUBMITTED

A record of the formations drilled through, and pertinent remarks are presented on the reverse. I declare that I have knowledge of the contents of this report and am authorized by my organization to make this report, which was prepared by me or under my supervision and direction, with the data and facts stated herein to be true, correct, and complete to the best of my knowledge and belief.

SIGNATURE LACI BEVANS 4/12/2018 (405) 429-5610
123 ROBERT S. KERR AVE. OKLAHOMA CITY OK 73102 LBEVANS@SANDRIDGEENERGY.COM
ADDRESS CITY STATE ZIP EMAIL ADDRESS