

Oklahoma Corporation Commission  
Oil & Gas Conservation Division  
Post Office Box 52000  
Oklahoma City, Oklahoma 73152-2000  
Rule 165: 10-3-25

Form 1002A

API No.: 35093233500003

**Completion Report**

Spud Date: September 05, 1987

OTC Prod. Unit No.: 093-091035

Drilling Finished Date: September 27, 1987

1st Prod Date: October 31, 1987

**Amended**

Completion Date: October 27, 1987

Amend Reason: CHANGE BACK TO GAS

**Drill Type: STRAIGHT HOLE**

Min Gas Allowable: Yes

Well Name: REDGATE FEDERAL 1-19

Purchaser/Measurer:

Location: MAJOR 19 23N 16W  
C SE SE  
660 FSL 1980 FWL of 1/4 SEC  
Derrick Elevation: 1683 Ground Elevation: 1673

First Sales Date:

Operator: SANDRIDGE EXPLORATION & PRODUCTION LLC 22281

123 ROBERT S KERR AVE STE 1702  
OKLAHOMA CITY, OK 73102-6406

Completion Type		Location Exception		Increased Density	
	Single Zone	Order No		Order No	
	Multiple Zone	317049		There are no Increased Density records to display.	
X	Commingled				

Casing and Cement							
Type	Size	Weight	Grade	Feet	PSI	SAX	Top of CMT
CONDUCTOR	16	42	5LX-42	56		142	SURFACE
SURFACE	8 5/8	24	J-55	597		425	SURFACE
PRODUCTION	5 1/2	17	N-80	8848		1150	4650

Liner								
Type	Size	Weight	Grade	Length	PSI	SAX	Top Depth	Bottom Depth
There are no Liner records to display.								

**Total Depth: 8850**

Packer		Plug	
Depth	Brand & Type	Depth	Plug Type
7400	BAKER "R"	There are no Plug records to display.	

Initial Test Data
-------------------

Test Date	Formation	Oil BBL/Day	Oil-Gravity (API)	Gas MCF/Day	Gas-Oil Ratio Cu FT/BBL	Water BBL/Day	Pumpin or Flowing	Initial Shut-In Pressure	Choke Size	Flow Tubing Pressure
Oct 31, 1987	CHEROKEE-CHESTER LIME-MERAMEC			580		530	FLOWING	1075	34/64	160

#### Completion and Test Data by Producing Formation

Formation Name: CHEROKEE

Code: 404CHRK

Class: GAS

##### Spacing Orders

Order No	Unit Size
132650	640

##### Perforated Intervals

From	To
6696	6700

##### Acid Volumes

There are no Acid Volume records to display.

##### Fracture Treatments

There are no Fracture Treatments records to display.

Formation Name: CHESTER LIME

Code: 354CRLM

Class: GAS

##### Spacing Orders

Order No	Unit Size
132650	640

##### Perforated Intervals

From	To
6805	7370

##### Acid Volumes

There are no Acid Volume records to display.

##### Fracture Treatments

There are no Fracture Treatments records to display.

Formation Name: MERAMEC

Code: 353MRMC

Class: GAS

##### Spacing Orders

Order No	Unit Size
74653	640

##### Perforated Intervals

From	To
7500	8310

##### Acid Volumes

There are no Acid Volume records to display.

##### Fracture Treatments

There are no Fracture Treatments records to display.

Formation Name: CHEROKEE-CHESTER LIME-MERAMEC

Code:

Class: GAS

Formation	Top
CHEROKEE	6586
CHESTER LIME	6804
MERAMEC	7434

Were open hole logs run? Yes

Date last log run: September 27, 1987

Were unusual drilling circumstances encountered? No

Explanation:

#### Other Remarks

There are no Other Remarks.

**FOR COMMISSION USE ONLY**

1139413

Status: Accepted

API NO. 093-23350-03  
OTC PROD. 093-091035  
UNIT NO.

(PLEASE TYPE OR USE BLACK INK ONLY)

OKLAHOMA CORPORATION COMMISSION

Oil & Gas Conservation Division

Post Office Box 52000

Oklahoma City, Oklahoma 73152-2000

Rule 165:10-3-25

COMPLETION REPORT

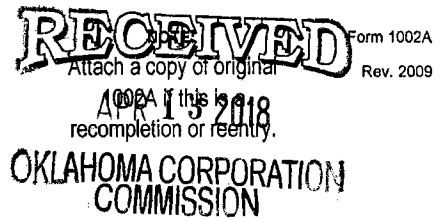

ORIGINAL  
☒ AMENDED (Reason)

CHANGE BACK TO GAS

TYPE OF DRILLING OPERATION

☒ STRAIGHT HOLE ☐ DIRECTIONAL HOLE ☐ HORIZONTAL HOLE  
☐ SERVICE WELL

If directional or horizontal, see reverse for bottom hole location.

COUNTY MAJOR SEC 19 TWP 23N RGE 16W  
LEASE NAME REDGATE FEDERAL WELL NO. 1-19  
1/4 C 1/4 SE 1/4 SE 1/4 FSL OF 660 FWL OF 1980  
ELEVATION 1683 Ground 1673 Latitude (if known) Longitude (if known)  
OPERATOR NAME SANDRIDGE EXPL. AND PROD., LLC OTC/OCC OPERATOR NO. 22281  
ADDRESS 123 ROBERT S. KERR AVE.  
CITY OKLAHOMA CITY STATE OK ZIP 73102

SPUD DATE 9/5/1987  
DRLG FINISHED DATE 9/27/1987  
DATE OF WELL COMPLETION 10/27/1987  
1st PROD DATE 10/31/1987  
RECOMP DATE

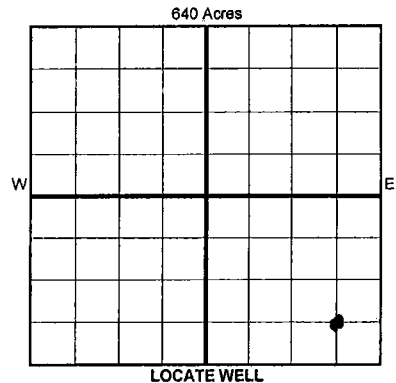

COMPLETION TYPE

☐ SINGLE ZONE  
☐ MULTIPLE ZONE  
☒ COMMINGLED  
LOCATION EXCEPTION ORDER NO. 317049  
INCREASED DENSITY ORDER NO.

CASING & CEMENT (Form 1002C must be attached)

TYPE	SIZE	WEIGHT	GRADE	FEET	PSI	SAX	TOP OF CMT
CONDUCTOR	16	42	5LX-42	56		142	SURFACE
SURFACE	8 5/8	24	J-55	597		425	SURFACE
INTERMEDIATE							
PRODUCTION	5 1/2	17	N-80	8848		1150	4650
LINER							

PACKER @ 7,400 BRAND & TYPE BAKER "R" PLUG @ TYPE PLUG @ TYPE  
PACKER @ BRAND & TYPE PLUG @ TYPE PLUG @ TYPE

TOTAL DEPTH 8,850

COMPLETION & TEST DATA BY PRODUCING FORMATION

FORMATION	CHEROKEE	CHESTER LIME	MERAMEC
SPACING & SPACING ORDER NUMBER	132650/640	132650/640	74653/640
CLASS: Oil, Gas, Dry, Inj, Disp, Comm Disp, Svc	GAS	GAS	GAS
PERFORATED INTERVALS	6696-6700	6805-7370	7500-8310
ACID/VOLUME			
FRACTURE TREATMENT (Fluids/Prop Amounts)			

Min Gas Allowable (165:10-17-7)

Gas Purchaser/Measurer

☒

OR

First Sales Date

INITIAL TEST DATA

INITIAL TEST DATE	10/31/1987
OIL-BBL/DAY	0
OIL-GRAVITY ( API)	
GAS-MCF/DAY	580
GAS-OIL RATIO CU FT/BBL	
WATER-BBL/DAY	530
PUMPING OR FLOWING	FLOWING
INITIAL SHUT-IN PRESSURE	1075
CHOKE SIZE	34/64
FLOW TUBING PRESSURE	160

AS SUBMITTED

A record of the formations drilled through, and pertinent remarks are presented on the reverse. I declare that I have knowledge of the contents of this report and am authorized by my organization to make this report, which was prepared by me or under my supervision and direction, with the data and facts stated herein to be true, correct, and complete to the best of my knowledge and belief.

SIGNATURE LACI BEVANS DATE 4/13/2018 PHONE NUMBER (405) 429-5610  
123 ROBERT S. KERR AVE. OKLAHOMA CITY OK 73102 LBEVANS@SANDRIDGEENERGY.COM  
ADDRESS CITY STATE ZIP EMAIL ADDRESS

PLEASE TYPE OR USE BLACK INK ONLY

FORMATION RECORD

Give formation names and tops, if available, or descriptions and thickness of formations drilled through. Show intervals cored or drillstem tested.

LEASE NAME \_\_\_\_\_

WELL NO. \_\_\_\_\_

NAMES OF FORMATIONS	TOP
CHEROKEE	6,586
CHESTER LIME	6,804
MERAMEC	7,434

FOR COMMISSION USE ONLY	
ITD on file <input type="checkbox"/> YES <input type="checkbox"/> NO	
APPROVED _____	DISAPPROVED _____
2) Reject Codes	

Were open hole logs run?	<u>X</u> yes	no
Date Last log was run	<u>9/27/1987</u>	
Was CO <sub>2</sub> encountered?	yes	no at what depths? _____
Was H <sub>2</sub> S encountered?	yes	no at what depths? _____
Were unusual drilling circumstances encountered?	yes	no
If yes, briefly explain below		

Other remarks:

640 Acres

If more than three drainholes are proposed, attach a separate sheet indicating the necessary information.

Direction must be stated in degrees azimuth.  
Please note, the horizontal drainhole and its end point must be located within the boundaries of the lease or spacing unit.

Directional surveys are required for all drainholes and directional wells.

640 Acres

BOTTOM HOLE LOCATION FOR DIRECTIONAL HOLE

SEC	TWP	RGE	COUNTY
Spot Location	1/4	1/4	1/4
Measured Total Depth	True Vertical Depth		Feet From 1/4 Sec Lines
FSL		FWL	
BHL From Lease, Unit, or Property Line:			

BOTTOM HOLE LOCATION FOR HORIZONTAL HOLE: (LATERALS)

LATERAL #1

SEC	TWP	RGE	COUNTY
Spot Location	1/4	1/4	1/4
Depth of Deviation	Radius of Turn		Direction
Measured Total Depth	True Vertical Depth		Total Length
FSL		FWL	
BHL From Lease, Unit, or Property Line:			

LATERAL #2

SEC	TWP	RGE	COUNTY
Spot Location	1/4	1/4	1/4
Depth of Deviation	Radius of Turn		Direction
Measured Total Depth	True Vertical Depth		Total Length
FSL		FWL	
BHL From Lease, Unit, or Property Line:			

LATERAL #3

SEC	TWP	RGE	COUNTY
Spot Location	1/4	1/4	1/4
Depth of Deviation	Radius of Turn		Direction
Measured Total Depth	True Vertical Depth		Total Length
FSL		FWL	
BHL From Lease, Unit, or Property Line:			

5/1/18

API NO. 093-23350-03  
OTC PROD. UNIT NO. 093-091035

(PLEASE TYPE OR USE BLACK INK ONLY)

A: 122002 S

☐ ORIGINAL  
☒ AMENDED (Reason)

CHANGE BACK TO GAS

OKLAHOMA CORPORATION COMMISSION  
Oil & Gas Conservation Division  
Post Office Box 52000  
Oklahoma City, Oklahoma 73152-2000  
Rule 165:10-3-25  
COMPLETION REPORT

RECEIVED  
Attach a copy of original  
1002A if this is a  
recompletion or reentry.  
APR 13 2018  
1016EZ  
OKLAHOMA CORPORATION  
COMMISSION

TYPE OF DRILLING OPERATION

☒ STRAIGHT HOLE ☐ DIRECTIONAL HOLE ☐ HORIZONTAL HOLE  
☐ SERVICE WELL

If directional or horizontal, see reverse for bottom hole location.

COUNTY MAJOR SEC 19 TWP 23N RGE 16W  
LEASE NAME REDGATE FEDERAL WELL NO. 1-19  
1/4 C 1/4 SE 1/4 SE 1/4 FSL OF 1/4 SEC 660 FWL OF 1/4 SEC 1980  
ELEVATION Derrick FL 1683 Ground 1673 Latitude (if known) Longitude (if known)  
OPERATOR NAME SANDRIDGE EXPL. AND PROD., LLC OTC/OCC OPERATOR NO. 22281  
ADDRESS 123 ROBERT S. KERR AVE.  
CITY OKLAHOMA CITY STATE OK ZIP 73102

SPUD DATE 9/5/1987  
DRLG FINISHED DATE 9/27/1987  
DATE OF WELL COMPLETION 10/27/1987  
1st PROD DATE 10/31/1987  
RECOMP DATE

640 Acres  
W E  
LOCATE WELL

COMPLETION TYPE

☐ SINGLE ZONE  
☐ MULTIPLE ZONE  
☒ COMMINGLED  
LOCATION EXCEPTION ORDER NO. 317049  
INCREASED DENSITY ORDER NO.

CASING & CEMENT (Form 1002C must be attached)

TYPE	SIZE	WEIGHT	GRADE	FEET	PSI	SAX	TOP OF CMT
CONDUCTOR	16	42	5LX-42	56		142	SURFACE
SURFACE	8 5/8	24	J-55	597		425	SURFACE
INTERMEDIATE							
PRODUCTION	5 1/2	17	N-80	8848		1150	4650
LINER							
				TOTAL DEPTH		8,850	

PACKER @ 7,400 BRAND & TYPE BAKER "R"

PLUG @ TYPE PLUG @ TYPE  
PLUG @ TYPE PLUG @ TYPE

COMPLETION & TEST DATA BY PRODUCING FORMATION

FORMATION	CHEROKEE	CHESTER LIME	MERAMEC	
SPACING & SPACING ORDER NUMBER	132650/640	132650/640	74653/640	
CLASS: Oil, Gas, Dry, Inj, Disp, Comm Disp, Svc	GAS	GAS	GAS	
PERFORATED INTERVALS	6696-6700	6805-7370	7500-8310	
ACID/VOLUME				
FRACTURE TREATMENT (Fluids/Prop Amounts)				

Min Gas Allowable (165:10-17-7)

Gas Purchaser/Measurer  
First Sales Date

INITIAL TEST DATA

☒

Oil Allowable (165:10-13-3)

INITIAL TEST DATE	10/31/1987			
OIL-BBL/DAY	0			
OIL-GRAVITY (API)				
GAS-MCF/DAY	580			
GAS-OIL RATIO CU FT/BBL				
WATER-BBL/DAY	530			
PUMPING OR FLOWING	FLOWING			
INITIAL SHUT-IN PRESSURE	1075			
CHOKE SIZE	34/64			
FLOW TUBING PRESSURE	160			

AS SUBMITTED

Corrected back to producing gas classification - original status reinstated.

A record of the formations drilled through, and pertinent remarks are presented on the reverse. I declare that I have knowledge of the contents of this report and am authorized by my organization to make this report, which was prepared by me or under my supervision and direction, with the data and facts stated herein to be true, correct, and complete to the best of my knowledge and belief.

SIGNATURE LACI BEVANS  
123 ROBERT S. KERR AVE. OKLAHOMA CITY OK 73102  
ADDRESS CITY STATE ZIP

DATE 4/13/2018 PHONE NUMBER (405) 429-5610  
EMAIL ADDRESS LBEVANS@SANDRIDGEENERGY.COM

SCANNED

ER