

Oklahoma Corporation Commission
Oil & Gas Conservation Division
Post Office Box 52000
Oklahoma City, Oklahoma 73152-2000
Rule 165: 10-3-25

Form 1002A

API No.: 35047210780002

Completion Report

Spud Date: March 03, 1976

OTC Prod. Unit No.: 047-050282

Drilling Finished Date: March 20, 1976

1st Prod Date: May 22, 1976

Amended

Completion Date: May 22, 1976

Amend Reason: CHANGE BACK TO GAS

Drill Type: STRAIGHT HOLE

Min Gas Allowable: Yes

Well Name: LANDWEHR 35-1

Purchaser/Measurer:

Location: GARFIELD 35 23N 8W
C S2 SE
660 FSL 1320 FWL of 1/4 SEC
Derrick Elevation: 0 Ground Elevation: 1299

First Sales Date:

Operator: SANDRIDGE EXPLORATION & PRODUCTION LLC 22281

123 ROBERT S KERR AVE STE 1702
OKLAHOMA CITY, OK 73102-6406

Completion Type	
X	Single Zone
	Multiple Zone
	Commingled

Location Exception	
Order No	
118843	
119181	

Increased Density	
Order No	
There are no Increased Density records to display.	

Casing and Cement							
Type	Size	Weight	Grade	Feet	PSI	SAX	Top of CMT
SURFACE	8 5/8	24	J-55	627		500	SURFACE
PRODUCTION	4 1/2	10.5	J-55	7165		400	5340

Liner								
Type	Size	Weight	Grade	Length	PSI	SAX	Top Depth	Bottom Depth
There are no Liner records to display.								

Total Depth: 7200

Packer		Plug	
Depth	Brand & Type	Depth	Plug Type
There are no Packer records to display.		There are no Plug records to display.	

Initial Test Data										
Test Date	Formation	Oil BBL/Day	Oil-Gravity (API)	Gas MCF/Day	Gas-Oil Ratio Cu FT/BBL	Water BBL/Day	Pumpin or Flowing	Initial Shut-In Pressure	Choke Size	Flow Tubing Pressure
Oct 28, 1976	MISSISSIPPIAN	26	38	440	16923	27	FLOWING	568	24/64	212

Completion and Test Data by Producing Formation			
Formation Name: MISSISSIPPIAN		Code: 359MSSP	Class: GAS
Spacing Orders		Perforated Intervals	
Order No	Unit Size	From	To
57897	640	6526	6990
Acid Volumes		Fracture Treatments	
There are no Acid Volume records to display.		There are no Fracture Treatments records to display.	

Formation	Top
MISSISSIPPIAN	6504

Were open hole logs run? No
Date last log run:

Were unusual drilling circumstances encountered? No
Explanation:

Other Remarks
There are no Other Remarks.

FOR COMMISSION USE ONLY	
Status: Accepted	1139424

API NO. 047-21078-02
OTC PROD. 047-050282
UNIT NO.

(PLEASE TYPE OR USE BLACK INK ONLY)

OKLAHOMA CORPORATION COMMISSION
Oil & Gas Conservation Division
Post Office Box 52000
Oklahoma City, Oklahoma 73152-2000
Rule 165:10-3-25

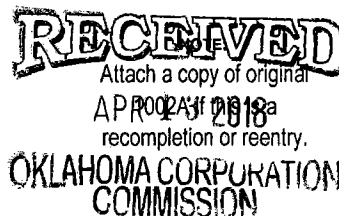

Form 1002A
Rev. 2009

☐ ORIGINAL
☒ AMENDED (Reason)

CHANGE BACK TO GAS

COMPLETION REPORT

TYPE OF DRILLING OPERATION

☒ STRAIGHT HOLE ☐ DIRECTIONAL HOLE ☐ HORIZONTAL HOLE
☐ SERVICE WELL

If directional or horizontal, see reverse for bottom hole location.

COUNTY	GARFIELD	SEC	35	TWP	23N	RGE	8W	SPUD DATE	3/3/1976	
LEASE NAME	LANDWEHR			WELL NO.	35-1			DRLG FINISHED DATE	3/20/1976	
1/4	C	1/4	S2	1/4	SE	1/4	FSL OF 1/4 SEC	660	DATE OF WELL COMPLETION	5/22/1976
ELEVATION	Ground			1299	FWL OF 1/4 SEC	1320			1st PROD DATE	5/22/1976
OPERATOR NAME	SANDRIDGE EXPL. AND PROD., LLC						OTC/OCC OPERATOR NO.	22281		
ADDRESS	123 ROBERT S. KERR AVE.									
CITY	OKLAHOMA CITY			STATE	OK		ZIP	73102		

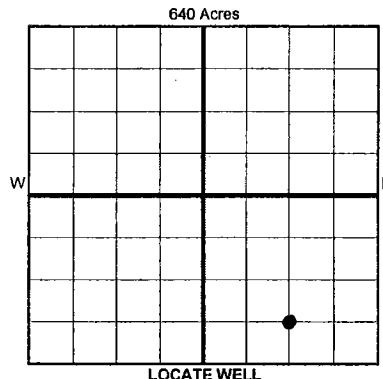

COMPLETION TYPE

☒ SINGLE ZONE
☐ MULTIPLE ZONE
Application Date
☐ COMINGLED
Application Date
LOCATION EXCEPTION
ORDER NO. 118843, 119181
☐ INCREASED DENSITY
ORDER NO.

CASING & CEMENT (Form 1002C must be attached)

TYPE	SIZE	WEIGHT	GRADE	FEET	PSI	SAX	TOP OF CMT
CONDUCTOR							
SURFACE	8 5/8	24	J-55	627		500	SURFACE
INTERMEDIATE							
PRODUCTION	4 1/2	10.5	J-55	7165		400	5340
LINER							
TOTAL DEPTH						7,200	

PACKER @ _____ BRAND & TYPE _____ PLUG @ _____ TYPE _____ PLUG @ _____ TYPE _____
PACKER @ _____ BRAND & TYPE _____ PLUG @ _____ TYPE _____ PLUG @ _____ TYPE _____

COMPLETION & TEST DATA BY PRODUCING FORMATION

FORMATION	MISSISSIPPIAN					
SPACING & SPACING ORDER NUMBER	57897/640					
CLASS: Oil, Gas, Dry, Inj, Disp, Comm Disp, Svc	GAS					
PERFORATED INTERVALS	6526-6990					
ACID/VOLUME						
FRACTURE TREATMENT (Fluids/Prop Amounts)						

Min Gas Allowable (165:10-17-7)
OR
Oil Allowable (165:10-13-3)

Gas Purchaser/Measurer
First Sales Date

INITIAL TEST DATA

INITIAL TEST DATE	10/28/1976				
OIL-BBL/DAY	26				
OIL-GRAVITY (API)	38				
GAS-MCF/DAY	440				
GAS-OIL RATIO CU FT/BBL	16923				
WATER-BBL/DAY	27				
PUMPING OR FLOWING	FLOWING				
INITIAL SHUT-IN PRESSURE	568				
CHOKE SIZE	24/64				
FLOW TUBING PRESSURE	212				

AS SUBMITTED

A record of the formations drilled through, and pertinent remarks are presented on the reverse. I declare that I have knowledge of the contents of this report and am authorized by my organization to make this report which was prepared by me or under my supervision and direction, with the data and facts stated herein to be true, correct, and complete to the best of my knowledge and belief.

SIGNATURE	LACI BEVANS	DATE	4/12/2018	PHONE NUMBER	(405) 429-5610
123 ROBERT S. KERR AVE.	OKLAHOMA CITY OK 73102	LBEVANS@SANDRIDGEENERGY.COM			
ADDRESS	CITY STATE ZIP	EMAIL ADDRESS			

PLEASE TYPE OR USE BLACK INK ONLY

FORMATION RECORD

Give formation names and tops, if available, or descriptions and thickness of formations drilled through. Show intervals cored or drillstem tested.

LEASE NAME _____

WELL NO. _____

NAMES OF FORMATIONS	TOP
MISSISSIPPIAN	6,504

FOR COMMISSION USE ONLY	
ITD on file <input type="checkbox"/> YES <input type="checkbox"/> NO	
APPROVED _____	DISAPPROVED _____
2) Reject Codes	

Were open hole logs run?	_____ yes <input checked="" type="checkbox"/> no
Date Last log was run	_____
Was CO ₂ encountered?	_____ yes _____ no at what depths? _____
Was H ₂ S encountered?	_____ yes _____ no at what depths? _____
Were unusual drilling circumstances encountered?	_____ yes _____ no
If yes, briefly explain below	

Other remarks:

640 Acres

If more than three drainholes are proposed, attach a separate sheet indicating the necessary information.

Direction must be stated in degrees azimuth. Please note, the horizontal drainhole and its end point must be located within the boundaries of the lease or spacing unit.

Directional surveys are required for all drainholes and directional wells.

640 Acres

BOTTOM HOLE LOCATION FOR DIRECTIONAL HOLE

SEC	TWP	RGE	COUNTY
Spot Location			
1/4	1/4	1/4	1/4
Measured Total Depth		True Vertical Depth	BHL From Lease, Unit, or Property Line:

BOTTOM HOLE LOCATION FOR HORIZONTAL HOLE: (LATERALS)

LATERAL #1			
SEC	TWP	RGE	COUNTY
Spot Location			
1/4	1/4	1/4	1/4
Depth of Deviation		Radius of Turn	Direction
Measured Total Depth		True Vertical Depth	BHL From Lease, Unit, or Property Line:

LATERAL #2

SEC	TWP	RGE	COUNTY
Spot Location			
1/4	1/4	1/4	1/4
Depth of Deviation		Radius of Turn	Direction
Measured Total Depth		True Vertical Depth	BHL From Lease, Unit, or Property Line:

LATERAL #3

SEC	TWP	RGE	COUNTY
Spot Location			
1/4	1/4	1/4	1/4
Depth of Deviation		Radius of Turn	Direction
Measured Total Depth		True Vertical Depth	BHL From Lease, Unit, or Property Line:

API NO. 047-21078-02
OTC PROD. 047-050282
UNIT NO.

ORIGINAL
☒ AMENDED (Reason)

(PLEASE TYPE OR USE BLACK INK ONLY)

CHANGE BACK TO GAS

OKLAHOMA CORPORATION COMMISSION
Oil & Gas Conservation Division
Post Office Box 52000
Oklahoma City, Oklahoma 73152-2000
Rule 165:10-3-25

COMPLETION REPORT

RECEIVED
Attach a copy of original
APPROVAL 2018
recompletion or reentry.
OKLAHOMA CORPORATION COMMISSION

Form 1002A
Rev. 2009

1016EZ

TYPE OF DRILLING OPERATION

☒ STRAIGHT HOLE ☐ DIRECTIONAL HOLE ☐ HORIZONTAL HOLE
☐ SERVICE WELL

If directional or horizontal, see reverse for bottom hole location.

COUNTY GARFIELD SEC 35 TWP 23N RGE 8W
LEASE NAME LANDWEHR WELL NO. 35-1
1/4 C 1/4 S2 1/4 SE 1/4 FSL OF 660 FWL OF 1320
ELEVATION Ground 1299 Latitude (if known) Longitude (if known)
OPERATOR NAME SANDRIDGE EXPL. AND PROD., LLC OTC/OCC OPERATOR NO. 22281
ADDRESS 123 ROBERT S. KERR AVE.
CITY OKLAHOMA CITY STATE OK ZIP 73102

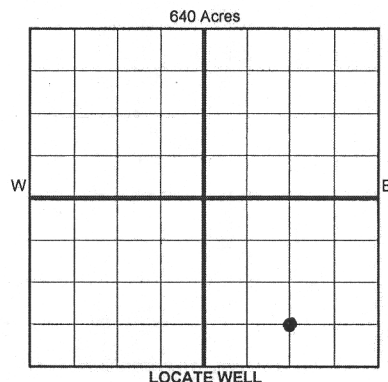

COMPLETION TYPE

☒ SINGLE ZONE
☐ MULTIPLE ZONE
Application Date
COMINGLED
Application Date
LOCATION EXCEPTION 118843, 119181
ORDER NO.
INCREASED DENSITY
ORDER NO.

CASING & CEMENT (Form 1002C must be attached)

TYPE	SIZE	WEIGHT	GRADE	FEET	PSI	SAX	TOP OF CMT
CONDUCTOR							
SURFACE	8 5/8	24	J-55	627		500	SURFACE
INTERMEDIATE							
PRODUCTION	4 1/2	10.5	J-55	7165		400	5340
LINER							
						TOTAL DEPTH	7,200

PACKER @ _____ BRAND & TYPE _____ PLUG @ _____ TYPE _____ PLUG @ _____ TYPE _____
PACKER @ _____ BRAND & TYPE _____ PLUG @ _____ TYPE _____ PLUG @ _____ TYPE _____

COMPLETION & TEST DATA BY PRODUCING FORMATION

FORMATION	MISSISSIPPIAN						
SPACING & SPACING ORDER NUMBER	57897/640						
CLASS: Oil, Gas, Dry, Inj, Disp, Comm Disp, Svc	GAS						
PERFORATED INTERVALS	6526-6990						
ACID/VOLUME							
FRACTURE TREATMENT (Fluids/Prop Amounts)							

Min Gas Allowable (165:10-17-7) Gas Purchaser/Measurer
☒ OR
Oil Allowable (165:10-13-3) First Sales Date 5/22/76

INITIAL TEST DATA

INITIAL TEST DATE	10/28/1976						
OIL-BBL/DAY	26						
OIL-GRAVITY (API)	38						
GAS-MCF/DAY	440						
GAS-OIL RATIO CU FT/BBL	16923						
WATER-BBL/DAY	27						
PUMPING OR FLOWING	FLOWING						
INITIAL SHUT-IN PRESSURE	568						
CHOKE SIZE	24/64						
FLOW TUBING PRESSURE	212						

AS SUBMITTED

A record of the formations drilled through, and pertinent remarks are presented on the reverse. I declare that I have knowledge of the contents of this report and am authorized by my organization to make this report, which was prepared by me or under my supervision and direction, with the data and facts stated herein to be true, correct, and complete to the best of my knowledge and belief.

SIGNATURE LACI BEVANS DATE 4/12/2018 PHONE NUMBER (405) 429-5610
123 ROBERT S. KERR AVE. OKLAHOMA CITY OK 73102 LBEVANS@SANDRIDGEENERGY.COM
ADDRESS CITY STATE ZIP EMAIL ADDRESS