

Oklahoma Corporation Commission
Oil & Gas Conservation Division
Post Office Box 52000
Oklahoma City, Oklahoma 73152-2000
Rule 165: 10-3-25

Form 1002A

API No.: 35051242270000

Completion Report

Spud Date: December 04, 2017

OTC Prod. Unit No.: 051-223478

Drilling Finished Date: March 14, 2018

1st Prod Date: May 04, 2018

Completion Date: May 04, 2018

Drill Type: HORIZONTAL HOLE

Well Name: CLEBURNE 7R-12X13H

Purchaser/Measurer:

Location: GRADY 12 4N 7W
NE NE NW NE
300 FNL 1544 FEL of 1/4 SEC
Latitude: 34.84050609 Longitude: -97.88363843
Derrick Elevation: 0 Ground Elevation: 1266

First Sales Date: 05/04/2018

Operator: GULFPORT MIDCON LLC 24020

3001 QUAIL SPRINGS PKWY
OKLAHOMA CITY, OK 73134-2640

Completion Type	
X	Single Zone
	Multiple Zone
	Commingled

Location Exception	
Order No	
657409	

Increased Density	
Order No	
There are no Increased Density records to display.	

Casing and Cement							
Type	Size	Weight	Grade	Feet	PSI	SAX	Top of CMT
CONDUCTOR	30			100			
SURFACE	20		K-55	805		875	SURFACE
INTERMEDIATE	13 3/8		J-55	3515		1740	3515
INTERMEDIATE	9 5/8			14960		1565	8065
PRODUCTION	5 1/2		P-110	27739		2390	16130

Liner								
Type	Size	Weight	Grade	Length	PSI	SAX	Top Depth	Bottom Depth
There are no Liner records to display.								

Total Depth: 27829

Packer	
Depth	Brand & Type
There are no Packer records to display.	

Plug	
Depth	Plug Type
There are no Plug records to display.	

Initial Test Data

Test Date	Formation	Oil BBL/Day	Oil-Gravity (API)	Gas MCF/Day	Gas-Oil Ratio Cu FT/BBL	Water BBL/Day	Pumpin or Flowing	Initial Shut-In Pressure	Choke Size	Flow Tubing Pressure
Jun 12, 2018	WOODFORD	2		14498	7249000	2700	FLOWING	4300	30/64	

Completion and Test Data by Producing Formation

Formation Name: WOODFORD		Code: 319WDFD		Class: GAS	
Spacing Orders		Perforated Intervals			
Order No	Unit Size	From	To		
656811	640	18230	27616		
656879	640				
658257	MULTIUNIT				
Acid Volumes		Fracture Treatments			
2,212 BARRELS 20% HCL		613,575 BARRELS WATER, 21,225,639 POUNDS SAND			

Formation	Top
WOODFORD	17999

Were open hole logs run? No

Date last log run:

Were unusual drilling circumstances encountered? No

Explanation:

Other Remarks
SURFACE HOLE WAS MOVED FROM THE ORIGINAL HOLE AND DRILLED IN CURRENT LOCATION AND NAMED CLEBURNE 7R-12X13H. ORIGINAL HOLE WAS PLUGGED. OCC - THIS DOCUMENT IS ACCEPTED BASED ON THE DATA SUBMITTED NEITHER THE FINAL LOCATION EXCEPTION NOR THE FINAL MULTIUNIT ORDERS HAVE BEEN SUBMITTED.

Lateral Holes
Sec: 13 TWP: 4N RGE: 7W County: GRADY
SE NW SE SE
676 FSL 1268 FEL of 1/4 SEC
Depth of Deviation: 16218 Radius of Turn: 573 Direction: 179 Total Length: 9982
Measured Total Depth: 27829 True Vertical Depth: 19218 End Pt. Location From Release, Unit or Property Line: 676

FOR COMMISSION USE ONLY
<div>1140361</div> <div>Status: Accepted</div>

API NO. 051-24227
OTC PROD.
UNIT NO. 051223478

(PLEASE TYPE OR USE BLACK INK ONLY)

OKLAHOMA CORPORATION COMMISSION

Oil & Gas Conservation Division

Post Office Box 52000

Oklahoma City, Oklahoma 73152-2000

Rule 165:10-3-25

COMPLETION REPORT

RECEIVED

JUL 05 2018

OKLAHOMA CORPORATION
COMMISSION

Form 1002A

Rev. 2009

☒ ORIGINAL
☐ AMENDED (Reason)

TYPE OF DRILLING OPERATION

☐ STRAIGHT HOLE ☐ DIRECTIONAL HOLE ☒ HORIZONTAL HOLE
☐ SERVICE WELL

If directional or horizontal, see reverse for bottom hole location.

COUNTY	Grady	SEC	12	TWP	4N	RGE	7W		
LEASE NAME	Cleburne			WELL NO. 7R-12X13H					
NE 1/4	NE 1/4	NW 1/4	NE 1/4	FNL OF 1/4 SEC	300	FEL OF 1/4 SEC	1544		
ELEVATION	Ground	1266	Latitude (if known)	34.84050609				Longitude (if known)	-97.88363843
OPERATOR NAME	Gulfport MidCon LLC			OTC/OCC OPERATOR NO.				24020	
ADDRESS	3001 Quail Springs Parkway								
CITY	Oklahoma City	STATE	OK	ZIP	73134				

COMPLETION TYPE

<input checked="" type="checkbox"/> SINGLE ZONE	
<input type="checkbox"/> MULTIPLE ZONE	
Application Date	
<input type="checkbox"/> COMMINGLED	
Application Date	
LOCATION EXCEPTION ORDER NO.	657409/659963
INCREASED DENSITY ORDER NO.	

CASING & CEMENT (Form 1002C must be attached)

TYPE	SIZE	WEIGHT	GRADE	FEET	PSI	SAX	TOP OF CMT
CONDUCTOR	30			100			
SURFACE	20		K55	805		875	Surface
INTERMEDIATE	13 3/8		J55	3,515		1740	3,515
INTERMEDIATE	9 5/8			14960		1565	8065
LINEAR Product	5 1/2		P110	27739		2390	16,130
						TOTAL DEPTH	27,829

PACKER @ _____ BRAND & TYPE _____ PLUG @ _____ TYPE _____ PLUG @ _____ TYPE _____
PACKER @ _____ BRAND & TYPE _____ PLUG @ _____ TYPE _____ PLUG @ _____ TYPE _____

COMPLETION & TEST DATA BY PRODUCING FORMATION

FORMATION	Woodford				
SPACING & SPACING ORDER NUMBER	656811 (640)	656879 (640)	658257 (Multinut)		Reported to Frac Focus
CLASS: Oil, Gas, Dry, Inj, Disp, Comm Disp, Svc	Gas				
	18230-27616				
PERFORATED INTERVALS					
ACID/VOLUME	2212bbl 20% HCL				
FRACTURE TREATMENT (Fluids/Prop Amounts)	613,575 bbl Water				
	21,225,639 lbs Sand				

Min Gas Allowable (165:10-17-7)

Gas Purchaser/Measurer

☐ OR
Oil Allowable (165:10-13-3)

First Sales Date

5/4/2018

INITIAL TEST DATA

INITIAL TEST DATE	6/12/2018				
OIL-BBL/DAY	2				
OIL-GRAVITY (API)	N/A				
GAS-MCF/DAY	14,498				
GAS-OIL RATIO CU FT/BBL	7,249,000				
WATER-BBL/DAY	2700				
PUMPING OR FLOWING	Flowing				
INITIAL SHUT-IN PRESSURE	4300				
CHOKE SIZE	30/64				
FLOW TUBING PRESSURE	N/A				

AS SUBMITTED

A record of the formations drilled through, and pertinent remarks are presented on the reverse. I declare that I have knowledge of the contents of this report and am authorized by my organization to make this report, which was prepared by me or under my supervision and direction, with the data and facts stated herein to be true, correct, and complete to the best of my knowledge and belief.

Monica Pickens

6/28/2018

252-4703

SIGNATURE

NAME (PRINT OR TYPE)

DATE

PHONE NUMBER

3001 Quail Springs Parkway

Oklahoma City

OK

73160

mpickens@gulfportenergy.com

ADDRESS

CITY

STATE

ZIP

EMAIL ADDRESS

PLEASE TYPE OR USE BLACK INK ONLY
FORMATION RECORD

Give formation names and tops, if available, or descriptions and thickness of formations drilled through. Show intervals cored or drillstem tested.

NAMES OF FORMATIONS	TOP
Woodford	17,999

LEASE NAME Cleburne WELL NO. 7R12X13H

FOR COMMISSION USE ONLY	
ITD on file <input type="checkbox"/> YES <input type="checkbox"/> NO	
APPROVED _____ DISAPPROVED _____	2) Reject Codes

Were open hole logs run?	<input type="checkbox"/> yes <input checked="" type="checkbox"/> no
Date Last log was run	_____
Was CO ₂ encountered?	<input type="checkbox"/> yes <input checked="" type="checkbox"/> no at what depths? _____
Was H ₂ S encountered?	<input type="checkbox"/> yes <input checked="" type="checkbox"/> no at what depths? _____
Were unusual drilling circumstances encountered?	<input checked="" type="checkbox"/> yes <input type="checkbox"/> no
If yes, briefly explain below _____	

Other remarks: OTC# 051223478/ Surface hole was moved from the original hole and drilled in current location and named Cleburne 7R-12X13H.

Original hole was plugged.

640 Acres

If more than three drainholes are proposed, attach a separate sheet indicating the necessary information.

Direction must be stated in degrees azimuth.
Please note, the horizontal drainhole and its end point must be located within the boundaries of the lease or spacing unit.

Directional surveys are required for all drainholes and directional wells.

640 Acres

BOTTOM HOLE LOCATION FOR DIRECTIONAL HOLE

SEC	TWP	RGE	COUNTY	Spot Location	Feet From 1/4 Sec Lines	FSL	FWL
				1/4 1/4 1/4 1/4			
				Measured Total Depth	True Vertical Depth	BHL From Lease, Unit, or Property Line:	

BOTTOM HOLE LOCATION FOR HORIZONTAL HOLE: (LATERALS)

LATERAL #1	SEC	TWP	RGE	COUNTY	Spot Location	Feet From 1/4 Sec Lines	FSL	FEL
	13	04N	07W	Grady	SW 1/4 NW 1/4 SE 1/4 SE 1/4		676	1268
					Depth of Deviation	Radius of Turn	Direction	Total Length
					16,218	573	179.175	9,982
					Measured Total Depth	True Vertical Depth	BHL From Lease, Unit, or Property Line:	
					27,829	19,218	175 676	

LATERAL #2	SEC	TWP	RGE	COUNTY	Spot Location	Feet From 1/4 Sec Lines	FSL	FWL
					1/4 1/4 1/4 1/4			
					Depth of Deviation	Radius of Turn	Direction	Total Length
					Measured Total Depth	True Vertical Depth	BHL From Lease, Unit, or Property Line:	

LATERAL #3	SEC	TWP	RGE	COUNTY	Spot Location	Feet From 1/4 Sec Lines	FSL	FWL
					1/4 1/4 1/4 1/4			
					Depth of Deviation	Radius of Turn	Direction	Total Length
					Measured Total Depth	True Vertical Depth	BHL From Lease, Unit, or Property Line:	

8/1/18

RECEIVED

Form 1002A
Rev. 2009

JUL 05 2018

OKLAHOMA CORPORATION COMMISSION

API NO. 051-24227
OTC PROD.
UNIT NO. 051223478

(PLEASE TYPE OR USE BLACK INK ONLY)

OKLAHOMA CORPORATION COMMISSION
Oil & Gas Conservation Division
Post Office Box 52000
Oklahoma City, Oklahoma 73152-2000
Rule 165:10-3-25

☒ ORIGINAL
☐ AMENDED (Reason)

COMPLETION REPORT

TYPE OF DRILLING OPERATION
☐ STRAIGHT HOLE ☐ DIRECTIONAL HOLE ☒ HORIZONTAL HOLE
☐ SERVICE WELL
If directional or horizontal, see reverse for bottom hole location.

COUNTY	Grady	SEC	12	TWP	4N	RGE	7W
LEASE NAME	Cleburne			WELL NO. 7R-12X13H			
NE 1/4	NE 1/4	NW 1/4	NE 1/4	FNL OF 1/4 SEC	300	FEL OF 1/4 SEC	1544
ELEVATION	Ground	1266	Latitude (if known)	34.84050609			
Longitude (if known)	-97.88363843						
OPERATOR NAME	CAMANO Gulfport MidCont LLC			OTC/OCC OPERATOR NO.	2409724020		
ADDRESS	3001 Quail Springs Parkway						
CITY	Oklahoma City	STATE	OK	ZIP	73134		

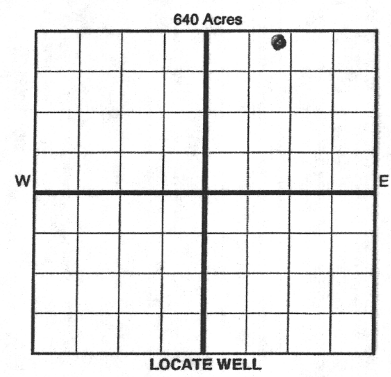

COMPLETION TYPE
☒ SINGLE ZONE
☐ MULTIPLE ZONE
Application Date
COMINGLED
Application Date
LOCATION EXCEPTION
ORDER NO. 657409/669863
INCREASED DENSITY
ORDER NO.

CASING & CEMENT (Form 1002C must be attached)

TYPE	SIZE	WEIGHT	GRADE	FEET	PSI	SAX	TOP OF CMT
CONDUCTOR	30			100			
SURFACE	20		K55	805		875	Surface
INTERMEDIATE	13 3/8		J55	3,515		1740	3,515
INTERMEDIATE	9 5/8			14960		1565	8065
LINER Production	5 1/2		P110	27739		2390	16,130
						TOTAL DEPTH	27,829

PACKER @ BRAND & TYPE PLUG @ TYPE PLUG @ TYPE
PACKER @ BRAND & TYPE PLUG @ TYPE PLUG @ TYPE

COMPLETION & TEST DATA BY PRODUCING FORMATION

FORMATION	Woodford				
SPACING & SPACING	656811 (640)	656879 (640)	658257 (Multunit)		
ORDER NUMBER					
CLASS: Oil, Gas, Dry, Inj, Disp, Comm Disp, Svc	Gas				
PERFORATED INTERVALS	18230-27616				
ACID/VOLUME	2212bbl 20% HCL				
FRACTURE TREATMENT (Fluids/Prop Amounts)	613,575 bbl Water				
	21,225,639 lbs Sand				

Min Gas Allowable (165:10-17-7) OR Oil Allowable (165:10-13-3) Gas Purchaser/Measurer First Sales Date 5/4/2018

INITIAL TEST DATA

INITIAL TEST DATE	6/12/2018
OIL-BBL/DAY	2
OIL-GRAVITY (API)	N/A
GAS-MCF/DAY	14,498
GAS-OIL RATIO CU FT/BBL	7,249,000
WATER-BBL/DAY	2700
PUMPING OR FLOWING	Flowing
INITIAL SHUT-IN PRESSURE	4300
CHOKE SIZE	30/64
FLOW TUBING PRESSURE	N/A

AS SUBMITTED

A record of the formations drilled through, and pertinent remarks are presented on the reverse. I declare that I have knowledge of the contents of this report and am authorized by my organization to make this report, which was prepared by me or under my supervision and direction, with the data and facts stated herein to be true, correct, and complete to the best of my knowledge and belief.

SIGNATURE	Monica Pickens	DATE	6/28/2018	PHONE NUMBER	252-4703
ADDRESS	3001 Quail Springs Parkway	CITY	Oklahoma City	STATE	OK
		ZIP	73160	EMAIL ADDRESS	mpickens@gulfportenergy.com

E2 E2

2R

SCANNED