

Oklahoma Corporation Commission  
Oil & Gas Conservation Division  
Post Office Box 52000  
Oklahoma City, Oklahoma 73152-2000  
Rule 165: 10-3-25

Form 1002A

API No.: 35085206990001

**Completion Report**

Spud Date: January 27, 1983

OTC Prod. Unit No.:

Drilling Finished Date: April 29, 1983

**Amended**

1st Prod Date: May 30, 1983

Amend Reason: RECOMPLETE

Completion Date: July 02, 1983

Recomplete Date: July 15, 2017

**Drill Type: STRAIGHT HOLE**

Well Name: GARTH SMITH 1

Purchaser/Measurer:

Location: LOVE 4 6S 2W  
C N2 NW  
1980 FSL 1320 FWL of 1/4 SEC  
Derrick Elevation: 0 Ground Elevation: 911

First Sales Date:

Operator: PSA INC 20947

960812 S HIGHWAY 18  
CHANDLER, OK 74834-4222

Completion Type		Location Exception		Increased Density	
X	Single Zone	Order No		Order No	
	Multiple Zone	There are no Location Exception records to display.		There are no Increased Density records to display.	
	Commingled				

Casing and Cement							
Type	Size	Weight	Grade	Feet	PSI	SAX	Top of CMT
SURFACE	9 5/8	36	K-55	1015	850	475	SURFACE
PRODUCTION	5 1/2	17	N-80	12314	2500	350	9760

Liner								
Type	Size	Weight	Grade	Length	PSI	SAX	Top Depth	Bottom Depth
There are no Liner records to display.								

**Total Depth: 12314**

Packer	
Depth	Brand & Type
There are no Packer records to display.	

Plug	
Depth	Plug Type
10940	10,000 POUND CIBP 10' CEM

Initial Test Data										
Test Date	Formation	Oil BBL/Day	Oil-Gravity (API)	Gas MCF/Day	Gas-Oil Ratio Cu FT/BBL	Water BBL/Day	Pumpin or Flowing	Initial Shut-In Pressure	Choke Size	Flow Tubing Pressure
Jul 26, 2017	WOODFORD-HUNTON	0.33	45				PUMPING			

Completion and Test Data by Producing Formation			
Formation Name: WOODFORD-HUNTON		Code: 319WDHN	Class: OIL
<b>Spacing Orders</b>		<b>Perforated Intervals</b>	
<b>Order No</b>	<b>Unit Size</b>	<b>From</b>	<b>To</b>
231473	160	10278	10358
<b>Acid Volumes</b>		<b>Fracture Treatments</b>	
2,200 GALLONS ACID		N/A	

Formation	Top
SEE ORIGINAL 1002A	0

Were open hole logs run? No  
Date last log run:  
  
Were unusual drilling circumstances encountered? No  
Explanation:

Other Remarks
OCC - D-V TOOL SET AT 11,215'

FOR COMMISSION USE ONLY	
Status: Accepted	1138104

20699-01

API NO. 08520784  
OTC PROD.  
UNIT NO.PLEASE TYPE OR USE BLACK INK ONLY  
NOTE:Attach copy of original 1002A  
if recompletion or reentry.OKLAHOMA CORPORATION COMMISSION  
Oil & Gas Conservation Division  
Post Office Box 52000  
Oklahoma City, Oklahoma 73152-2000  
Rule 165-10-3-25

RECEIVED

NOV 07 2017

Form 1002A  
Rev. 2009OKLAHOMA CORPORATION  
COMMISSION☐ ORIGINAL  
☒ AMENDED (Reason)

Recomplete

## COMPLETION REPORT

## TYPE OF DRILLING OPERATION

☒ STRAIGHT HOLE ☐ DIRECTIONAL HOLE ☐ HORIZONTAL HOLE  
☐ SERVICE WELL

If directional or horizontal, see reverse for bottom hole location.

COUNTY	Love	SEC	4	TWP	6S	RGE	2W
LEASE NAME	Garth Smith	WELL NO.	1	DATE OF WELL COMPLETION	7-2-83	1st PROD DATE	5-30-83
1/4	1/4	FSL OF 1/4 SEC	870	FWL OF 1/4 SEC	990	RECOMP DATE	7-15-17
ELEVATION IN Derrick	Ground	Latitude (if known)	1320	Longitude (if known)		OTC/OCC OPERATOR NO.	20947
OPERATOR NAME	PSA, inc	ADDRESS	960812 S. HWY 18	CITY	Chandler	STATE	OK
						ZIP	74834

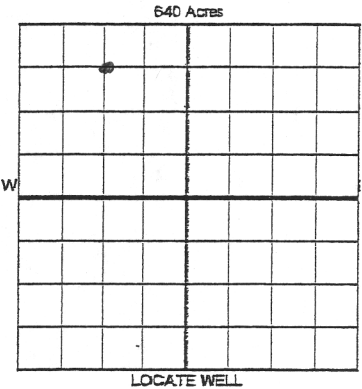

## COMPLETION TYPE

<input checked="" type="checkbox"/> SINGLE ZONE
<input type="checkbox"/> MULTIPLE ZONE
<input type="checkbox"/> COMMINGLED
<input type="checkbox"/> LOCATION
<input type="checkbox"/> EXCEPTION ORDER
<input type="checkbox"/> INCREASED DENSITY
<input type="checkbox"/> ORDER NO.

## CASING &amp; CEMENT (Form 1002C must be attached)

TYPE	SIZE	WEIGHT	GRADE	FEET	PSI	SAX	TOP OF CMT
CONDUCTOR							
SURFACE	9 5/8	36	K-55	1015	850	475	surface
INTERMEDIATE							
PRODUCTION	5 1/2	17	N-80	12314	2500	350	9760
LINER							

PACKER @ \_\_\_\_\_ BRAND & TYPE CIRP PLUG @ 10,940' TYPE 10' Cement PLUG @ our Plug TYPE Plug TOTAL DEPTH 12314

PACKER @ \_\_\_\_\_ BRAND & TYPE \_\_\_\_\_ PLUG @ \_\_\_\_\_ TYPE \_\_\_\_\_ PLUG @ \_\_\_\_\_ TYPE \_\_\_\_\_

## COMPLETION &amp; TEST DATA BY PRODUCING FORMATION

319 WPHN

FORMATION	Woodford-Huntton					No Frac
SPACING & SPACING ORDER NUMBER	231473-(160)					
CLASS: Oil, Gas, Dry, Inj, Disp, Comm Disp, Svc	oil					
PERFORATED INTERVALS	10,278-10,308 2SPF					
	10,328-10,358 2SPF					
ACID/VOLUME	2200 gal Acid					
FRACTURE TREATMENT (Fluids/Prop Amounts)	N/A					

Min Gas Allowable (165-10-17-7)

Gas Purchaser/Measurer



OR

First Sales Date

## INITIAL TEST DATA

Oil Allowable (165-10-13-3)

INITIAL TEST DATE	7-26-17					
OIL-BBL/DAY	1/3 BOD					
OIL-GRAVITY (API)	45°					
GAS-MCF/DAY						
GAS-OIL RATIO CU FT/BBL						
WATER-BBL/DAY						
PUMPING OR FLOWING	Pumping					
INITIAL SHUT-IN PRESSURE						
CHOKE SIZE						
FLOW TUBING PRESSURE						

AS SUBMITTED

A record of the formations drilled through, and pertinent remarks are presented on the reverse. I declare that I have knowledge of the contents of this report and am authorized by my organization to make this report, which was prepared by me or under my supervision and direction, with the data and facts stated herein to be true, correct, and complete to the best of my knowledge and belief.

Signature: Alan Buck NAME (PRINT OR TYPE): Alan Buck DATE: 11-3-17 PHONE NUMBER: 405-401-9372

ADDRESS: 960812 S. HWY 18 Chandler CITY: OK STATE: OK ZIP: 74863 EMAIL ADDRESS: N/A

### FORMATION RECORD

LEASE NAME

WELL NO.

NAMES OF FORMATIONS	TOP
<p><i>see original 1002A</i></p>	

FOR COMMISSION USE ONLY	
<p>ITD on file <input type="checkbox"/> YES <input type="checkbox"/> NO</p> <p>APPROVED _____ DISAPPROVED _____</p>	<p>2) Reject Codes</p> <p>_____</p> <p>_____</p> <p>_____</p> <p>_____</p> <p>_____</p>

Were open hole logs run? \_\_\_\_\_ yes \_\_\_\_\_ no

Date Last log was run \_\_\_\_\_

Was CO<sub>2</sub> encountered? \_\_\_\_\_ yes \_\_\_\_\_ no at what depths? \_\_\_\_\_

Was H<sub>2</sub>S encountered? \_\_\_\_\_ yes \_\_\_\_\_ no at what depths? \_\_\_\_\_

Were unusual drilling circumstances encountered? \_\_\_\_\_ yes \_\_\_\_\_ no

If yes, briefly explain below \_\_\_\_\_

Other remarks:

OCC - D-V tool set at 11215'

640 Acres

A large, empty 10x10 grid of squares, intended for drawing a picture.

If more than three drainholes are proposed, attach a separate sheet indicating the necessary information.

Direction must be stated in degrees azimuth.  
Please note, the horizontal drainhole and its end point must be located within the boundaries of the lease or spacing unit.

Directional surveys are required for all drainholes and directional wells.

640 ACRES

A large, empty grid of squares, approximately 10 columns wide and 10 rows high, intended for drawing a picture.

BOTTOM HOLE LOCATION FOR DIRECTIONAL HOLE

SEC	TWP	RGE	COUNTY					
Spot Location		1/4	1/4	1/4	1/4	Feet From 1/4 Sec Lines	FSL	FWL
Measured Total Depth		True Vertical Depth		BHL From Lease, Unit, or Property Line:				

BOTTOM HOLE LOCATION FOR HORIZONTAL HOLE: (LATERALS)

## LATERAL #1

SEC	TWP	RGE	COUNTY			
Spot Location				Feet From 1/4 Sec Lines	FSL	FWL
1/4	1/4	1/4	1/4			
Depth of Deviation		Radius of Turn	Direction	Total Length		
Measured Total Depth		True Vertical Depth	BHL From Lease, Unit, or Property Line:			

LATERAL #2

SEC	TWP	RGE	COUNTY			
Spot Location				Feet From 1/4 Sec Lines	FSL	FWL
1/4	1/4	1/4	1/4			
Depth of Deviation		Radius of Turn	Direction	Total Length		
Measured Total Depth		True Vertical Depth	BHL From Lease, Unit, or Property Line:			

LATERAL #3

SEC	TWP	RGE	COUNTY			
Spot Location				Feet From 1/4 Sec Lines	FSL	FWL
1/4	1/4	1/4	1/4			
Depth of Deviation		Radius of Turn	Direction	Total Length		
Measured Total Depth		True Vertical Depth	BHL From Lease, Unit, or Property Line:			