

Oklahoma Corporation Commission  
Oil & Gas Conservation Division  
Post Office Box 52000  
Oklahoma City, Oklahoma 73152-2000  
Rule 165: 10-3-25

Form 1002A

API No.: 35095206340001

**Completion Report**

Spud Date: May 31, 2014

OTC Prod. Unit No.: 095-22224

Drilling Finished Date: June 15, 2014

1st Prod Date: October 19, 2017

Completion Date: October 19, 2017

**Drill Type:** STRAIGHT HOLE

Min Gas Allowable: Yes

Well Name: LOGAN BEARD 3-36

Purchaser/Measurer: TARGA

Location: MARSHALL 36 4S 5E  
NE SW NE NE  
717 FNL 722 FEL of 1/4 SEC  
Derrick Elevation: 0 Ground Elevation: 792

First Sales Date: 10/19/2017

Operator: XTO ENERGY INC 21003

810 HOUSTON ST  
FORT WORTH, TX 76102-6203

Completion Type		Location Exception		Increased Density	
	Single Zone		Order No		Order No
	Multiple Zone		623459		623858
X	Commingled				

Casing and Cement							
Type	Size	Weight	Grade	Feet	PSI	SAX	Top of CMT
SURFACE	9 5/8	36	J-55	624		140	SURFACE
PRODUCTION	5 1/2	17	J-55	7500		400	5710

Liner								
Type	Size	Weight	Grade	Length	PSI	SAX	Top Depth	Bottom Depth
There are no Liner records to display.								

**Total Depth: 7500**

Packer	
Depth	Brand & Type
There are no Packer records to display.	

Plug	
Depth	Plug Type
There are no Plug records to display.	

Initial Test Data
-------------------

Test Date	Formation	Oil BBL/Day	Oil-Gravity (API)	Gas MCF/Day	Gas-Oil Ratio Cu FT/BBL	Water BBL/Day	Pumpin or Flowing	Initial Shut-In Pressure	Choke Size	Flow Tubing Pressure
Oct 20, 2017	SYCAMORE- WOODFORD-HUNTON- VIOLA	55	39	450	8182	150	FLOWING	200	40/64	95

**Completion and Test Data by Producing Formation**

Formation Name: SYCAMORE

Code: 352SCMR

Class: OIL

**Spacing Orders**

Order No	Unit Size
533420	640

**Perforated Intervals**

From	To
6455	6529

**Acid Volumes**

4,000 GALLONS HCL
-------------------

**Fracture Treatments**

7,406 BTW, 20,133 POUNDS 100 MESH, 130,153 POUNDS 40/70
---

Formation Name: WOODFORD

Code: 319WDFD

Class: OIL

**Spacing Orders**

Order No	Unit Size
533420	640

**Perforated Intervals**

From	To
6621	6926

**Acid Volumes**

2,100 GALLONS HCL
-------------------

**Fracture Treatments**

7,392 BTW, 18,110 POUNDS 100 MESH, 148,486 POUNDS 40/70
---

Formation Name: HUNTON

Code: 269HNTN

Class: OIL

**Spacing Orders**

Order No	Unit Size
533420	640

**Perforated Intervals**

From	To
7024	7046

**Acid Volumes**

10,000 GALLONS HCL
--------------------

**Fracture Treatments**

2,401 BTW, 7,000 POUNDS MESH, 20,000 POUNDS 40/70
---

Formation Name: VIOLA

Code: 202VIOL

Class: OIL

**Spacing Orders**

Order No	Unit Size
533420	640

**Perforated Intervals**

From	To
7340	7418

**Acid Volumes**

4,000 GALLONS HCL
-------------------

**Fracture Treatments**

5,678 BTW, 14,084 POUNDS 100 MESH, 68,010 POUNDS 40/70
--

Formation Name: SYCAMORE-WOODFORD-  
HUNTON-VIOLA

Code:

Class: OIL

Formation	Top
CANEY	6176
SYCAMORE	6436
WOODFORD	6592
HUNTON	7019
VIOLA	7330

Were open hole logs run? Yes

Date last log run: June 13, 2014

Were unusual drilling circumstances encountered? No

Explanation:

#### Other Remarks

IRREGULAR SECTION

#### FOR COMMISSION USE ONLY

1138002

Status: Accepted

RECEIVED

OCT 23 2017

Form 1002A  
Rev. 2009API NO. 095-20634  
OTC PROD. UNIT NO. 095-22224PLEASE TYPE OR USE BLACK INK ONLY  
NOTE:Attach copy of original 1002A  
if recompletion or reentry.OKLAHOMA CORPORATION COMMISSION  
Oil & Gas Conservation Division  
Post Office Box 52000  
Oklahoma City, Oklahoma 73152-2000  
Rule 165:10-3-25OKLAHOMA CORPORATION  
COMMISSION☒ ORIGINAL  
☐ AMENDED (Reason)

## COMPLETION REPORT

## TYPE OF DRILLING OPERATION

☒ STRAIGHT HOLE ☐ DIRECTIONAL HOLE ☐ HORIZONTAL HOLE  
SERVICE WELL

If directional or horizontal, see reverse for bottom hole location.

COUNTY	Marshall	SEC	36	TWP	4S	RGE	5E	SPUD DATE	5/31/2014
LEASE NAME	Logan Beard	WELL NO.	3-36	DATE OF WELL COMPLETION	10/19/2017	1st PROD DATE	10/19/2017	RECOMP DATE	
NE 1/4 SW 1/4 NE 1/4 NE 1/4	FNL OF 1/4 SEC 717	FEL OF 1/4 SEC 722	Longitude (if known)	-96.72585W	Latitude (if known)	34.17402N	OTC/OCC OPERATOR NO.	21003	
ELEVATION N Derrick	Ground	792	ADDRESS						
210 Park Avenue, Suite 2350									
CITY	Oklahoma City	STATE	Oklahoma	ZIP	73102				

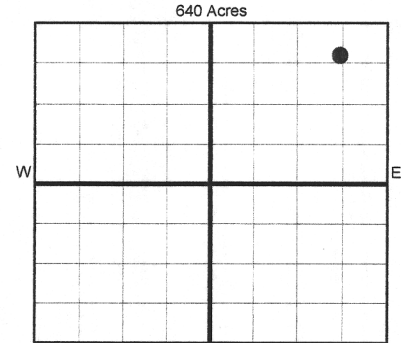

LOCATE WELL

## COMPLETION TYPE

<input type="checkbox"/>	SINGLE ZONE
<input type="checkbox"/>	MULTIPLE ZONE
<input checked="" type="checkbox"/>	Application Date
<input checked="" type="checkbox"/>	COMINGLED
<input checked="" type="checkbox"/>	Application Date
LOCATION	623459
EXCEPTION ORDER	623858
INCREASED DENSITY ORDER NO.	

## CASING &amp; CEMENT (Form 1002C must be attached)

TYPE	SIZE	WEIGHT	GRADE	FEET	PSI	SAX	TOP OF CMT
CONDUCTOR							
SURFACE	9 5/8"	36#	J-55	624'		140	Surface
INTERMEDIATE							
PRODUCTION	5 1/2"	17#	J-55	7,500		400	5710
LINER							
				TOTAL DEPTH	7500'		

PACKER @ \_\_\_\_\_ BRAND & TYPE \_\_\_\_\_ PLUG @ \_\_\_\_\_ TYPE \_\_\_\_\_ PLUG @ \_\_\_\_\_ TYPE \_\_\_\_\_  
 PACKER @ \_\_\_\_\_ BRAND & TYPE \_\_\_\_\_ PLUG @ \_\_\_\_\_ TYPE \_\_\_\_\_ PLUG @ \_\_\_\_\_ TYPE \_\_\_\_\_

COMPLETION & TEST DATA BY PRODUCING FORMATION *3525UMR, 319WDFD, 269HNTN, 202V10L*

FORMATION	Sycamore	Woodford	Hunton	Viola	
SPACING & SPACING ORDER NUMBER	640: 533420	640: 533420	640: 533420	640: 533420	
CLASS: Oil, Gas, Dry, Inj, Disp, Comm Disp, Svc	Oil	Oil	Oil	Oil	
PERFORATED INTERVALS	6455-6529	6621-6926	7024-7046	7340-7418	
ACID/VOLUME	4000 gals HCL	2100 gals HCL	10000 gals HCL	4000 gals HCL	
FRACTURE TREATMENT (Fluids/Prop Amounts)	7406 BTW	7392 BTW	2401 BTW	5678 BTW	
	20,133# 100 Mesh	18110# 100 Mesh	7000# Mesh	14084# 100 Mesh	
	130,153# 40/7	148,486# 40/70	20,000# 40/70	68,010# 40/70	

*Reported to Forc Focus*

## INITIAL TEST DATA

INITIAL TEST DATE	10/20/2017				
OIL-BBL/DAY	55				
OIL-GRAVITY ( API)	39				
GAS-MCF/DAY	450				
GAS-OIL RATIO CU FT/BBL	8182				
WATER-BBL/DAY	150				
PUMPING OR FLOWING	Flowing				
INITIAL SHUT-IN PRESSURE	200				
CHOKE SIZE	40/64				
FLOW TUBING PRESSURE	95				

AS SUBMITTED

A record of the formations drilled through, and pertinent remarks are presented on the reverse. I declare that I have knowledge of the contents of this report and am authorized by my organization to make this report, which was prepared by me or under my supervision and direction, with the data and facts stated herein to be true, correct, and complete to the best of my knowledge and belief.

*Debbie Waggoner*  
SIGNATUREDebbie Waggoner  
NAME (PRINT OR TYPE)10/20/2017 405-319-3243  
DATE PHONE NUMBER210 Park Avenue, Suite 2350  
ADDRESSOklahoma City Ok 73102  
CITY STATE ZIPdebbie\_waggoner@xtoenergy.com  
EMAIL ADDRESS

PLEASE TYPE OR USE BLACK INK ONLY

FORMATION RECORD

Give formation names and tops, if available, or descriptions and thickness of formations drilled through. Show intervals cored or drillstem tested.

NAMES OF FORMATIONS	TOP
CANEY	6,176
SYCAMORE	6,436
WOODFORD	6592
HUNTON	7,019
VIOLA	7,330

LEASE NAME Logan Beard WELL NO. 3-36

FOR COMMISSION USE ONLY	
ITD on file <input type="checkbox"/> YES <input type="checkbox"/> NO	
APPROVED _____ DISAPPROVED _____	2) Reject Codes

Were open hole logs run? X yes    no

Date Last log was run 6-13-2014

Was CO<sub>2</sub> encountered?    yes X no at what depths?   

Was H<sub>2</sub>S encountered?    yes X no at what depths?   

Were unusual drilling circumstances encountered?    yes X no

If yes, briefly explain below

Other remarks: Irregular Section

640 Acres

If more than three drainholes are proposed, attach a separate sheet indicating the necessary information.

Direction must be stated in degrees azimuth. Please note, the horizontal drainhole and its end point must be located within the boundaries of the lease or spacing unit.

Directional surveys are required for all drainholes and directional wells.

640 Acres

BOTTOM HOLE LOCATION FOR DIRECTIONAL HOLE

SEC	TWP	RGE	COUNTY		
Spot Location	1/4	1/4	1/4	1/4	
Measured Total Depth	True Vertical Depth		Feet From 1/4 Sec Lines FSL FWL		
				BHL From Lease, Unit, or Property Line:	

BOTTOM HOLE LOCATION FOR HORIZONTAL HOLE: (LATERALS)

LATERAL #1

SEC	TWP	RGE	COUNTY		
Spot Location	1/4	1/4	1/4	1/4	
Depth of Deviation	Radius of Turn		Direction	Total Length	
Measured Total Depth	True Vertical Depth		Feet From 1/4 Sec Lines FSL FWL		
				BHL From Lease, Unit, or Property Line:	

LATERAL #2

SEC	TWP	RGE	COUNTY		
Spot Location	1/4	1/4	1/4	1/4	
Depth of Deviation	Radius of Turn		Direction	Total Length	
Measured Total Depth	True Vertical Depth		Feet From 1/4 Sec Lines FSL FWL		
				BHL From Lease, Unit, or Property Line:	

LATERAL #3

SEC	TWP	RGE	COUNTY		
Spot Location	1/4	1/4	1/4	1/4	
Depth of Deviation	Radius of Turn		Direction	Total Length	
Measured Total Depth	True Vertical Depth		Feet From 1/4 Sec Lines FSL FWL		
				BHL From Lease, Unit, or Property Line:	