

Oklahoma Corporation Commission
Oil & Gas Conservation Division
Post Office Box 52000
Oklahoma City, Oklahoma 73152-2000
Rule 165: 10-3-25

Form 1002A

API No.: 35111227750001

Completion Report

Spud Date: November 25, 1980

OTC Prod. Unit No.:

Drilling Finished Date: December 03, 1980

Amended

1st Prod Date: December 26, 1980

Amend Reason: CONVERTED TO SALT WATER DISPOSAL

Completion Date: December 26, 1980

Recomplete Date: November 15, 2016

Drill Type: STRAIGHT HOLE

SERVICE WELL

Well Name: MORAN L & D 1

Purchaser/Measurer:

Location: OKMULGEE 1 14N 14E
NE SW SE SE
600 FSL 1890 FWL of 1/4 SEC
Derrick Elevation: 691 Ground Elevation: 686

First Sales Date:

Operator: AOG OPERATING LLC 23059

1803 E 17TH ST
TULSA, OK 74104-5304

Completion Type		Location Exception		Increased Density	
X	Single Zone	Order No		Order No	
	Multiple Zone	There are no Location Exception records to display.		There are no Increased Density records to display.	
	Commingled				

Casing and Cement							
Type	Size	Weight	Grade	Feet	PSI	SAX	Top of CMT
SURFACE	8.625	28		200		150	SURFACE
PRODUCTION	4.5	9		1130		125	740

Liner								
Type	Size	Weight	Grade	Length	PSI	SAX	Top Depth	Bottom Depth
There are no Liner records to display.								

Total Depth: 2430

Packer		Plug	
Depth	Brand & Type	Depth	Plug Type
1001	ARROW TENSION	1130	PLUG BACK

Initial Test Data

Test Date	Formation	Oil BBL/Day	Oil-Gravity (API)	Gas MCF/Day	Gas-Oil Ratio Cu FT/BBL	Water BBL/Day	Pumpin or Flowing	Initial Shut- In Pressure	Choke Size	Flow Tubing Pressure
There are no Initial Data records to display.										

Completion and Test Data by Producing Formation									
Formation Name: BOOCH				Code: 404BOCH			Class: DISP		
Spacing Orders				Perforated Intervals					
Order No		Unit Size		From			To		
There are no Spacing Order records to display.				1042			1065		
Acid Volumes				Fracture Treatments					
There are no Acid Volume records to display.				There are no Fracture Treatments records to display.					

Formation	Top
BARTLESVILLE	637
BOOCH	1043
HARTSHORNE	1246
DUTCHER	1378
UNION VALLEY	1775
CROMWELL SAND	1805
CANEY	1805
MAYES	2070
WOODFORD	2241
MISENER SAND	2272
VIOLA	2281
SIMPSON	2299
WILCOX SAND	2311
2ND WILCOX SAND	2339

Were open hole logs run? No
Date last log run:

Were unusual drilling circumstances encountered? No
Explanation:

Other Remarks
CONVERTED TO SALT WATER DISPOSAL (UIC NUMBER 1702540096)

FOR COMMISSION USE ONLY
<div>Status: Accepted</div> <div>1137972</div>

API NO. 111-22775
OTC PROD
UNIT NO.

PLEASE TYPE OR USE BLACK INK ONLY

NOTE:

Attach copy of original 1002A
if recompletion or reentry.

OKLAHOMA CORPORATION COMMISSION

Oil & Gas Conservation Division
Post Office Box 52000

Oklahoma City, Oklahoma 73152-2000

Rule 165:10-3-25

RECEIVED
OKLAHOMA CORPORATION COMMISSION
Form 1002A
Rev. 2009

OCT 18 2017

☐ ORIGINAL
☒ AMENDED (Reason)

Converted to SWD

COMPLETION REPORT

TYPE OF DRILLING OPERATION

☒ STRAIGHT HOLE ☐ DIRECTIONAL HOLE ☐ HORIZONTAL HOLE
☒ SERVICE WELL

If directional or horizontal, see reverse for bottom hole location.

COUNTY Okmulgee SEC 1 TWP 14N RGE 14E

LEASE NAME Moran L&D

NE 1/4 SW 1/4 SE 1/4 SE 1/4 FSL OF 1/4 SEC 680 FWL OF 1/4 SEC 1890

ELEVATION 691 Ground 686 Latitude (if known)

OPERATOR NAME AOG OPERATING, LLC

ADDRESS 1803 E. 17TH ST.

CITY TULSA STATE OK ZIP 74104

SPUD DATE 11-25-80

DRLG FINISHED DATE 12-3-80

DATE OF WELL COMPLETION 12-26-80

1st PROD DATE 12-26-80

RECOMP DATE 11-15-2016

Longitude (if known)

OTC/OCC OPERATOR NO. 23059

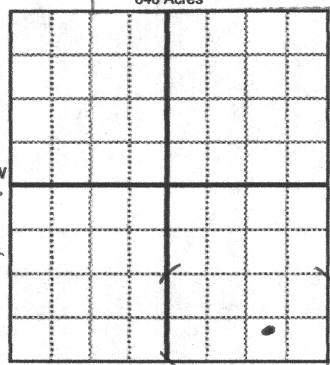

COMPLETION TYPE

☒ SINGLE ZONE
☐ MULTIPLE ZONE
Application Date
COMINGLED
Application Date
LOCATION
EXCEPTION ORDER INCREASED
DENSITY ORDER NO.

CASING & CEMENT (Form 1002C must be attached)

TYPE	SIZE	WEIGHT	GRADE	FEET	PSI	SAX	TOP OF CMT
CONDUCTOR							
SURFACE	8.625"	28		200		150	Surface
INTERMEDIATE							
PRODUCTION	4.5"	9		1130		125	740'
LINER							

PACKER @ 1,001 BRAND & TYPE Arrow Tension PLUG @ 1130 TYPE Plug back PLUG @ TYPE TOTAL DEPTH 2430
PACKER @ BRAND & TYPE PLUG @ TYPE PLUG @ TYPE

COMPLETION & TEST DATA BY PRODUCING FORMATION

FORMATION	Booch						
SPACING & SPACING ORDER NUMBER							
CLASS: Oil, Gas, Dry, Inj, Disp, Comm Disp, Svc	SWD						
PERFORATED INTERVALS	1042-48'						
	1058-65'						
ACID/VOLUME							
FRACTURE TREATMENT (Fluids/Prop Amounts)							

Min Gas Allowable (165:10-17-7)

Gas Purchaser/Measurer

☐

OR

First Sales Date

INITIAL TEST DATA

Oil Allowable (165:10-13-3)

INITIAL TEST DATE	12/29/1980						
OIL-BBL/DAY	16						
OIL-GRAVITY (API)	36						
GAS-MCF/DAY							
GAS-OIL RATIO CU FT/BBL							
WATER-BBL/DAY	5						
PUMPING OR FLOWING	Pumping						
INITIAL SHUT-IN PRESSURE							
CHOKE SIZE							
FLOW TUBING PRESSURE							

AS SUBMITTED

ord of the formations drilled through, and pertinent remarks are presented on the reverse. I declare that I have knowledge of the contents of this report and am authorized by my organization to certify that this report, which was prepared by me or under my supervision and direction, with the data and facts stated herein to be true, correct, and complete to the best of my knowledge and

SIGNATURE Douglas Swift 10/11/17 512-497-6496
1803 E. 17th St. Tulsa OK 74104
ADDRESS CITY STATE ZIP
austin@aspectoil.com
EMAIL ADDRESS

PLEASE TYPE OR USE BLACK INK ONLY
FORMATION RECORD

Give formation names and tops, if available, or descriptions and thickness of formations drilled through. Show intervals cored or drillstem tested.

LEASE NAME _____

WELL NO. _____

NAMES OF FORMATIONS	TOP
Bartlesville	637'
Booch	1043'
Hartshorne	1246'
Dutcher	1378'
Union Valley	1775'
Cromwell Sand	1805'
Caney	1805'
Mayes	2070'
Woodford	2241'
Msener Sand	2272'
Viola	2281'
Simpson	2299'
Wilcox Sand	2311'
2nd Wilcox Sand	2339'

FOR COMMISSION USE ONLY	
ITD on file <input type="checkbox"/> YES <input type="checkbox"/> NO	
APPROVED _____	DISAPPROVED _____
2) Reject Codes	

Were open hole logs run?	_____ yes <input checked="" type="checkbox"/> no
Date Last log was run	_____ N/A
Was CO ₂ encountered?	_____ yes <input checked="" type="checkbox"/> no at what depths? _____
Was H ₂ S encountered?	_____ yes <input checked="" type="checkbox"/> no at what depths? _____
Were unusual drilling circumstances encountered?	_____ yes <input checked="" type="checkbox"/> no
If yes, briefly explain below	

Other remarks:

Converted to SWD (UIC #1702540096)

640 Acres

If more than three drainholes are proposed, attach a separate sheet indicating the necessary information.

Direction must be stated in degrees azimuth.
Please note, the horizontal drainhole and its end point must be located within the boundaries of the lease or spacing unit.

Directional surveys are required for all drainholes and directional wells.

640 Acres

BOTTOM HOLE LOCATION FOR DIRECTIONAL HOLE

SEC	TWP	RGE	COUNTY
Spot Location			
1/4	1/4	1/4	1/4
Measured Total Depth		True Vertical Depth	BHL From Lease, Unit, or Property Line:

BOTTOM HOLE LOCATION FOR HORIZONTAL HOLE: (LATERALS)

LATERAL #1

SEC	TWP	RGE	COUNTY
Spot Location			
1/4	1/4	1/4	1/4
Depth of Deviation		Radius of Turn	Direction
Measured Total Depth		True Vertical Depth	BHL From Lease, Unit, or Property Line:

LATERAL #2

SEC	TWP	RGE	COUNTY
Spot Location			
1/4	1/4	1/4	1/4
Depth of Deviation		Radius of Turn	Direction
Measured Total Depth		True Vertical Depth	BHL From Lease, Unit, or Property Line:

LATERAL #3

SEC	TWP	RGE	COUNTY
Spot Location			
1/4	1/4	1/4	1/4
Depth of Deviation		Radius of Turn	Direction
Measured Total Depth		True Vertical Depth	BHL From Lease, Unit, or Property Line: