

Oklahoma Corporation Commission
Oil & Gas Conservation Division
Post Office Box 52000
Oklahoma City, Oklahoma 73152-2000
Rule 165: 10-3-25

Form 1002A

API No.: 35107235850000

Completion Report

Spud Date: November 30, 2016

OTC Prod. Unit No.: 107-219069

Drilling Finished Date: December 05, 2016

1st Prod Date: June 27, 2017

Completion Date: December 29, 2016

Drill Type: STRAIGHT HOLE

Well Name: LIGONS 1

Purchaser/Measurer:

Location: OKFUSKEE 25 11N 10E
C SW SE
660 FSL 660 FWL of 1/4 SEC
Derrick Elevation: 0 Ground Elevation: 851

First Sales Date:

Operator: OIL CREEK PRODUCTION COMPANY 11804
PO BOX 667
619 S JIM THORPE BLVD
PRAGUE, OK 74864-0667

Completion Type		Location Exception		Increased Density	
X	Single Zone	Order No		Order No	
	Multiple Zone	There are no Location Exception records to display.		There are no Increased Density records to display.	
	Commingled				

Casing and Cement							
Type	Size	Weight	Grade	Feet	PSI	SAX	Top of CMT
SURFACE	8 5/8	24	J-55	252		110	SURFACE
PRODUCTION	5 1/2	17	K-55	3012		125	1800

Liner								
Type	Size	Weight	Grade	Length	PSI	SAX	Top Depth	Bottom Depth
There are no Liner records to display.								

Total Depth: 3065

Packer		Plug	
Depth	Brand & Type	Depth	Plug Type
There are no Packer records to display.		There are no Plug records to display.	

Initial Test Data										
Test Date	Formation	Oil BBL/Day	Oil-Gravity (API)	Gas MCF/Day	Gas-Oil Ratio Cu FT/BBL	Water BBL/Day	Pumpin or Flowing	Initial Shut-In Pressure	Choke Size	Flow Tubing Pressure
Jun 27, 2017	GILCREASE			80			FLOWING	900	11/64	100

Completion and Test Data by Producing Formation			
Formation Name: GILCREASE		Code: 403GLCR	Class: GAS
Spacing Orders		Perforated Intervals	
Order No	Unit Size	From	To
667696	80	2794	2798
Acid Volumes		Fracture Treatments	
500 GALLONS 15%		NONE	

Formation	Top
GILCREASE	2794

Were open hole logs run? Yes
Date last log run: December 03, 2016

Were unusual drilling circumstances encountered? No
Explanation:

Other Remarks
There are no Other Remarks.

FOR COMMISSION USE ONLY	
Status: Accepted	1137957

API NO. 107 23585
OTC PROD. UNIT NO. 107-219069

PLEASE TYPE OR USE BLACK INK ONLY

NOTE:

Attach copy of original 1002A
if recompletion or reentry.

OKLAHOMA CORPORATION COMMISSION
Oil & Gas Conservation Division
Post Office Box 52000
Oklahoma City, Oklahoma 73152-2000
Rule 165:10-3-25

RECEIVED

NOV 15 2017

Form 1002A
Rev. 2009

OKLAHOMA CORPORATION
COMMISSION

☒ ORIGINAL
☐ AMENDED (Reason) _____

COMPLETION REPORT

TYPE OF DRILLING OPERATION

☒ STRAIGHT HOLE ☐ DIRECTIONAL HOLE ☐ HORIZONTAL HOLE
☐ SERVICE WELL

If directional or horizontal, see reverse for bottom hole location.

COUNTY OKfuskee SEC 25 TWP 11N RGE 10E
LEASE NAME Ligons WELL NO. 1
1/4 C 1/4 SW 1/4 SE 1/4 SW FSL OF 1/4 SEC 660' FWL OF 1/4 SEC 660'
ELEVATION Ground 851-ft. Latitude (if known) _____ Longitude (if known) _____
OPERATOR NAME Oil Creek Production Co. OTC/OCC OPERATOR NO. 11804-0
ADDRESS P.O. Box 667
CITY Prague STATE OKLAHOMA ZIP 74864

SPUD DATE 11-30-2016

DRLG FINISHED DATE 12-5-2016

DATE OF WELL COMPLETION 12-29-2016

1st PROD DATE 6-27-2017

RECOMP DATE _____

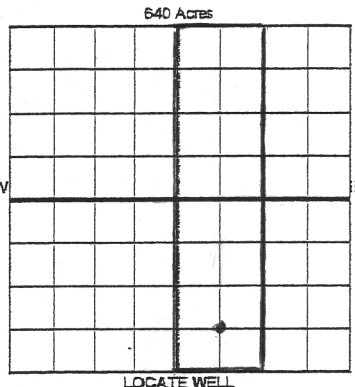

COMPLETION TYPE

☒ SINGLE ZONE
☐ MULTIPLE ZONE
Application Date _____
☐ COMMINGLED
Application Date _____
LOCATION
EXCEPTION ORDER
INCREASED DENSITY
ORDER NO. _____

CASING & CEMENT (Form 1002C must be attached)

TYPE	SIZE	WEIGHT	GRADE	FEET	PSI	SAX	TOP OF CMT
CONDUCTOR							
SURFACE	8 5/8	24 #	J-55	252 Feet		110	Ground L.
INTERMEDIATE							
PRODUCTION	5 1/2	17 #	K-55	3,012 Feet		125	1,800'
LINER							
						TOTAL DEPTH	3065'

PACKER @ _____ BRAND & TYPE _____ PLUG @ _____ TYPE _____ PLUG @ _____ TYPE _____
PACKER @ _____ BRAND & TYPE _____ PLUG @ _____ TYPE _____ PLUG @ _____ TYPE _____

COMPLETION & TEST DATA BY PRODUCING FORMATION 4036 LCR

FORMATION	<u>Gilcrease</u>						<u>No Frac</u>
SPACING & SPACING ORDER NUMBER	<u>667696 (80)</u>						
CLASS: Oil, Gas, Dry, Inj, Disp, Comm Disp, Svc	<u>GAS</u>						
PERFORATED INTERVALS	<u>2794 - To - 2798 = Perforated - 9 Holes Total</u>						
ACID/VOLUME	<u>500 Gal / 15%</u>						
FRACTURE TREATMENT (Fluids/Prop Amounts)	<u>NONE</u>						

Min Gas Allowable (165:10-17-7)

Gas Purchaser/Measurer: _____

OR
Oil Allowable (165:10-13-3)

First Sales Date: _____

INITIAL TEST DATA

INITIAL TEST DATE	<u>80</u>					
OIL-BBL/DAY	<u>Trace</u>					
OIL-GRAVITY (API)						
GAS-MCF/DAY	<u>80</u>					
GAS-OIL RATIO CU FT/BBL						
WATER-BBL/DAY	<u>Trace</u>					
PUMPING OR FLOWING	<u>Flowing</u>					
INITIAL SHUT-IN PRESSURE	<u>900 lbs</u>					
CHOKE SIZE	<u>1 1/2</u>					
FLOW TUBING PRESSURE	<u>100 lbs</u>					

AS SUBMITTED

A record of the formations drilled through, and pertinent remarks are presented on the reverse. I declare that I have knowledge of the contents of this report and am authorized by my organization to make this report, which was prepared by me or under my supervision and direction, with the data and facts stated herein to be true, correct, and complete to the best of my knowledge and belief.

T.J. Simek SIGNATURE NAME (PRINT OR TYPE) 2-21-17 DATE 405-567-4606 PHONE NUMBER
P.O. Box 667 ADDRESS Prague CITY OKLAHOMA STATE 74864 ZIP
EMAIL ADDRESS _____

PLEASE TYPE OR USE BLACK INK ONLY

FORMATION RECORD

Give formation names and tops, if available, or descriptions and thickness of formations drilled through. Show intervals cored or drillstem tested.

LEASE NAME Ligans

WELL NO. 1

NAMES OF FORMATIONS	TOP
Gilcrease	2794'

FOR COMMISSION USE ONLY

ITD on file ☐ YES ☐ NO

APPROVED _____ DISAPPROVED _____

2) Reject Codes

Were open hole logs run? ☒ yes ☐ no

Date Last log was run 12-3-2016

Was CO₂ encountered? ☐ yes ☒ no at what depths? _____

Was H₂S encountered? ☐ yes ☒ no at what depths? _____

Were unusual drilling circumstances encountered? ☐ yes ☒ no

If yes, briefly explain below

Other remarks:

640 Acres

If more than three drainholes are proposed, attach a separate sheet indicating the necessary information.

Direction must be stated in degrees azimuth. Please note, the horizontal drainhole and its end point must be located within the boundaries of the lease or spacing unit.

Directional surveys are required for all drainholes and directional wells.

640 Acres

BOTTOM HOLE LOCATION FOR DIRECTIONAL HOLE

SEC	TWP	RGE	COUNTY
Spot Location			
1/4	1/4	1/4	1/4
Measured Total Depth		True Vertical Depth	BHL From Lease, Unit, or Property Line:

BOTTOM HOLE LOCATION FOR HORIZONTAL HOLE: (LATERALS)

LATERAL #1

SEC	TWP	RGE	COUNTY
Spot Location			
1/4	1/4	1/4	1/4
Depth of Deviation		Radius of Turn	Direction
Measured Total Depth		True Vertical Depth	BHL From Lease, Unit, or Property Line:

LATERAL #2

SEC	TWP	RGE	COUNTY
Spot Location			
1/4	1/4	1/4	1/4
Depth of Deviation		Radius of Turn	Direction
Measured Total Depth		True Vertical Depth	BHL From Lease, Unit, or Property Line:

LATERAL #3

SEC	TWP	RGE	COUNTY
Spot Location			
1/4	1/4	1/4	1/4
Depth of Deviation		Radius of Turn	Direction
Measured Total Depth		True Vertical Depth	BHL From Lease, Unit, or Property Line:

12/1/17
Oklahoma Corporation Commission
Oil & Gas Conservation Division
Post Office Box 52000
Oklahoma City, Oklahoma 73152-2000
Rule 165: 10-3-25

Form 1002A

1016EZ

API No.: 107235850000

Completion Report

Spud Date: November 30, 2016

OTC Prod. Unit No.: 107-219069

Drilling Finished Date: December 05, 2016

1st Prod Date: June 27, 2017

Completion Date: December 29, 2016

A: 219069 I

Drill Type: STRAIGHT HOLE

Well Name: LIGONS 1

Purchaser/Measurer:

Location: OKFUSKEE 25 11N 10E
C SW SE
660 FSL 660 FWL of 1/4 SEC
Derrick Elevation: 0 Ground Elevation: 851

First Sales Date: 6/27/17

Operator: OIL CREEK PRODUCTION COMPANY 11804
PO BOX 667
619 S JIM THORPE BLVD
PRAGUE, OK 74864-0667

Completion Type		Location Exception		Increased Density	
X	Single Zone	Order No		Order No	
	Multiple Zone	There are no Location Exception records to display.		There are no Increased Density records to display.	
	Commingled				

Casing and Cement							
Type	Size	Weight	Grade	Feet	PSI	SAX	Top of CMT
SURFACE	8 5/8	24	J-55	252		110	SURFACE
PRODUCTION	5 1/2	17	K-55	3012		125	1800

Liner								
Type	Size	Weight	Grade	Length	PSI	SAX	Top Depth	Bottom Depth
There are no Liner records to display.								

Total Depth: 3065

Packer		Plug	
Depth	Brand & Type	Depth	Plug Type
There are no Packer records to display.		There are no Plug records to display.	

Initial Test Data										
Test Date	Formation	Oil BBL/Day	Oil-Gravity (API)	Gas MCF/Day	Gas-Oil Ratio Cu FT/BBL	Water BBL/Day	Pumpin or Flowing	Initial Shut-In Pressure	Choke Size	Flow Tubing Pressure
Jun 27, 2017	GILCREASE			80			FLOWING	900	11/64	100

November 27, 2017

1 of 2

OR

PCW