

Oklahoma Corporation Commission
Oil & Gas Conservation Division
Post Office Box 52000
Oklahoma City, Oklahoma 73152-2000
Rule 165: 10-3-25

Form 1002A

API No.: 35003232910000

Completion Report

Spud Date: September 19, 2017

OTC Prod. Unit No.:

Drilling Finished Date: September 30, 2017

1st Prod Date:

Completion Date: September 30, 2017

Drill Type: STRAIGHT HOLE

Well Name: CAROL 1-22

Purchaser/Measurer:

Location: ALFALFA 22 27N 9W
NW NW SW SE
1000 FSL 165 FWL of 1/4 SEC
Derrick Elevation: 1250 Ground Elevation: 1237

First Sales Date:

Operator: UNION VALLEY PETROLEUM CORP 12075

5302 N HIGHWAY 81
ENID, OK 73701-6932

Completion Type		Location Exception		Increased Density	
	Single Zone	Order No		Order No	
	Multiple Zone	There are no Location Exception records to display.		There are no Increased Density records to display.	
	Commingled				

Casing and Cement							
Type	Size	Weight	Grade	Feet	PSI	SAX	Top of CMT
SURFACE	8.625	24	J-55	468		325	SURFACE

Liner								
Type	Size	Weight	Grade	Length	PSI	SAX	Top Depth	Bottom Depth
There are no Liner records to display.								

Total Depth: 6008

Packer		Plug	
Depth	Brand & Type	Depth	Plug Type
There are no Packer records to display.		There are no Plug records to display.	

Initial Test Data										
Test Date	Formation	Oil BBL/Day	Oil-Gravity (API)	Gas MCF/Day	Gas-Oil Ratio Cu FT/BBL	Water BBL/Day	Pumpin or Flowing	Initial Shut-In Pressure	Choke Size	Flow Tubing Pressure
There are no Initial Data records to display.										
Completion and Test Data by Producing Formation										

Formation Name: NONE

Code:

Class: DRY

Formation	Top
TONKAWA	4242
MISSISSIPPI	5342
WOODFORD	5842
CHEROKEE	5988
WILCOX	6002

Were open hole logs run? Yes

Date last log run: September 30, 2017

Were unusual drilling circumstances encountered? No

Explanation:

Other Remarks

There are no Other Remarks.

FOR COMMISSION USE ONLY

1137971

Status: Accepted

API NO. 003-23291
OTC PROD.
UNIT NO.

PLEASE TYPE OR USE BLACK INK ONLY
NOTE:
Attach copy of original 1002A if recompletion or reentry.

OKLAHOMA CORPORATION COMMISSION
Oil & Gas Conservation Division
Post Office Box 52000
Oklahoma City, Oklahoma 73152-2000
Rule 165:10-3-25

RECEIVED

Form 1002A
Rev. 2009

OCT 17 2017

OKLAHOMA CORPORATION
COMMISSION

☒ ORIGINAL
☐ AMENDED (Reason) _____

COMPLETION REPORT

TYPE OF DRILLING OPERATION

☒ STRAIGHT HOLE ☐ DIRECTIONAL HOLE ☐ HORIZONTAL HOLE
☐ SERVICE WELL

If directional or horizontal, see reverse for bottom hole location.

COUNTY	Alfalfa	SEC	22	TWP	27N	RGE	9W
LEASE NAME	Carol	WELL NO.	1-22	DATE OF WELL COMPLETION	9-30-17	1st PROD DATE	
NW 1/4 NW 1/4 SW 1/4 SE 1/4	FSL	1000	FWL OF 1/4 SEC	165	RECOMP DATE		
ELEVATION N Derrick	1250	Ground	1237	Latitude (if known)		Longitude (if known)	
OPERATOR NAME	Union Valley Petroleum Corporation	OTC/OCC OPERATOR NO.	12075				
ADDRESS	5302 N. US Highway 81						
CITY	Enid	STATE	OK	ZIP	73701		

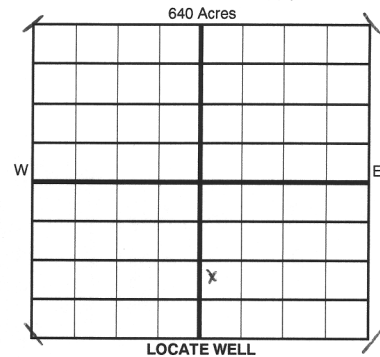

COMPLETION TYPE

SINGLE ZONE
MULTIPLE ZONE
Application Date
COMINGLED
Application Date
LOCATION EXCEPTION ORDER
INCREASED DENSITY ORDER NO.

CASING & CEMENT (Form 1002C must be attached)

TYPE	SIZE	WEIGHT	GRADE	FEET	PSI	SAX	TOP OF CMT
CONDUCTOR							
SURFACE	8.625	24	J-55	468		325	Surface
INTERMEDIATE							
PRODUCTION							
LINER							

PACKER @ _____ BRAND & TYPE _____ PLUG @ _____ TYPE _____ PLUG @ _____ TYPE _____
PACKER @ _____ BRAND & TYPE _____ PLUG @ _____ TYPE _____ PLUG @ _____ TYPE _____

TOTAL DEPTH 6008

COMPLETION & TEST DATA BY PRODUCING FORMATION

FORMATION	DRY HOLE					
SPACING & SPACING ORDER NUMBER						
CLASS: Oil, Gas, Dry, Inj, Disp, Comm Disp, Svc						
PERFORATED INTERVALS						
ACID/VOLUME						
FRACTURE TREATMENT (Fluids/Prop Amounts)						

Min Gas Allowable (165:10-17-7)

Gas Purchaser/Measurer



OR

First Sales Date

INITIAL TEST DATA

Oil Allowable (165:10-13-3)

INITIAL TEST DATE	DRY HOLE				
OIL-BBL/DAY					
OIL-GRAVITY (API)					
GAS-MCF/DAY					
GAS-OIL RATIO CU FT/BBL					
WATER-BBL/DAY					
PUMPING OR FLOWING					
INITIAL SHUT-IN PRESSURE					
CHOKE SIZE					
FLOW TUBING PRESSURE					

AS SUBMITTED

A record of the formations drilled through, and pertinent remarks are presented on the reverse. I declare that I have knowledge of the contents of this report and am authorized by my organization to make this report, which was prepared by me or under my supervision and direction, with the data and facts stated herein to be true, correct, and complete to the best of my knowledge and belief.

SIGNATURE: Dustin Johnson
5302 N US Highway 81
ADDRESS: Enid
CITY: OK
STATE: 73701
ZIP: 10/16/2017
DATE: 580-237-3959
PHONE NUMBER: uvpc@suddenlinkmail.com
EMAIL ADDRESS:

Give formation names and tops, if available, or descriptions and thickness of formations drilled through. Show intervals cored or drillstem tested.

FOR COMMISSION USE ONLY	
ITD on file	<input type="checkbox"/> YES <input type="checkbox"/> NO
APPROVED	DISAPPROVED
2) Reject Codes _____ _____ _____ _____ _____	

Were open hole logs run? X yes ___ no

Date Last log was run 9/30/2017

Was CO₂ encountered? ___ yes X no at what depths? _____

Was H₂S encountered? ___ yes X no at what depths? _____

Were unusual drilling circumstances encountered? ___ yes X no

If yes, briefly explain below

Other remarks:

640 Acres

A 10x10 grid representing 640 acres. The grid is divided into four 5x5 quadrants by a thick black cross. The text '640 Acres' is centered at the top of the grid.

Direction must be stated in degrees azimuth.
Please note, the horizontal drainhole and its end point must be located within the boundaries of the lease or spacing unit.

640 Acres

A 10x10 grid representing 640 acres. The grid is divided into two main sections by a thick vertical line after the first column. The left section consists of 1 column and 10 rows. The right section consists of 9 columns and 10 rows. The total number of small squares is 100, representing 640 acres.

SEC	TWP	RGE	COUNTY			
Spot Location						
1/4	1/4	1/4	1/4	Feet From 1/4 Sec Lines	FSL	FWL
Measured Total Depth		True Vertical Depth		BHL From Lease, Unit, or Property Line:		

LATERAL #1						
SEC	TWP	RGE	COUNTY			
Spot Location						
1/4	1/4	1/4	1/4	Feet From 1/4 Sec Lines	FSL	FWL
Depth of Deviation		Radius of Turn	Direction	Total Length		
Measured Total Depth		True Vertical Depth	BHL From Lease, Unit, or Property Line:			

SEC	TWP	RGE	COUNTY
Spot Location			
1/4	1/4	1/4	1/4
Feet From 1/4 Sec Lines		FSL	FWL
Depth of Deviation	Radius of Turn	Direction	Total Length
Measured Total Depth	True Vertical Depth	BHL From Lease, Unit, or Property Line:	

SEC	TWP	RGE	COUNTY			
Spot Location						
1/4		1/4	1/4	Feet From 1/4 Sec Lines	FSL	FWL
Depth of Deviation		Radius of Turn		Direction	Total Length	
Measured Total Depth		True Vertical Depth		BHL From Lease, Unit, or Property Line:		