

Oklahoma Corporation Commission
Oil & Gas Conservation Division
Post Office Box 52000
Oklahoma City, Oklahoma 73152-2000
Rule 165: 10-3-25

Form 1002A

API No.: 35047250230001

Completion Report

Spud Date: April 16, 2015

OTC Prod. Unit No.: 047-216134

Drilling Finished Date: May 04, 2015

1st Prod Date: June 10, 2015

Amended

Completion Date: June 06, 2015

Amend Reason: CHANGE CLASSIFICATION OF WELL

Drill Type: HORIZONTAL HOLE

Min Gas Allowable: Yes

Well Name: HOLDEN 3-18WH

Purchaser/Measurer: SUPERIOR

Location: GARFIELD 18 24N 4W
SW SW SE SW
165 FSL 1440 FWL of 1/4 SEC
Derrick Elevation: 1121 Ground Elevation: 1106

First Sales Date: 06/10/2015

Operator: SK PLYMOUTH LLC 23485

6100 S YALE AVE STE 500
TULSA, OK 74136-1906

Completion Type		Location Exception		Increased Density	
X	Single Zone	Order No		Order No	
	Multiple Zone	646953		639829	
	Commingled				

Casing and Cement							
Type	Size	Weight	Grade	Feet	PSI	SAX	Top of CMT
SURFACE	9 5/8	36	J-55	531		240	SURFACE
PRODUCTION	7	26	P-110	6370		310	3723

Liner								
Type	Size	Weight	Grade	Length	PSI	SAX	Top Depth	Bottom Depth
LINER	4 1/2	11.6	P-110	4512	0	500	6307	10819

Total Depth: 10830

Packer	
Depth	Brand & Type
There are no Packer records to display.	

Plug	
Depth	Plug Type
There are no Plug records to display.	

Initial Test Data										
Test Date	Formation	Oil BBL/Day	Oil-Gravity (API)	Gas MCF/Day	Gas-Oil Ratio Cu FT/BBL	Water BBL/Day	Pumpin or Flowing	Initial Shut-In Pressure	Choke Size	Flow Tubing Pressure
Sep 20, 2017	WOODFORD	10	40	255	25500	402	PUMPING			

Completion and Test Data by Producing Formation

Formation Name: WOODFORD

Code: 319WDFD

Class: GAS

Spacing Orders

Order No	Unit Size
636337	640

Perforated Intervals

From	To
6400	10752

Acid Volumes

55,860 GALLONS ACID

Fracture Treatments14 STAGES - 1,031,285 POUNDS SAND, 75,204
BARRELS WATER

Formation	Top
WOODFORD	6792

Were open hole logs run? No

Date last log run:

Were unusual drilling circumstances encountered? No

Explanation:

Other Remarks

There are no Other Remarks.

Lateral Holes

Sec: 18 TWP: 24N RGE: 4W County: GARFIELD

NE NW NE NW

165 FNL 1832 FWL of 1/4 SEC

Depth of Deviation: 5485 Radius of Turn: 636 Direction: 4 Total Length: 4038

Measured Total Depth: 10830 True Vertical Depth: 6169 End Pt. Location From Release, Unit or Property Line: 165

FOR COMMISSION USE ONLY

1137933

Status: Accepted

API NO. 047-25023
OTC PROD. UNIT NO. 047-216134

PLEASE TYPE OR USE BLACK INK ONLY
NOTE:

Attach copy of original 1002A
if recompletion or reentry.

OKLAHOMA CORPORATION COMMISSION
Oil & Gas Conservation Division
Post Office Box 52000
Oklahoma City, Oklahoma 73152-2000
Rule 165:10-3-25

RECEIVED
OCT 16 2017
OKLAHOMA CORPORATION
COMMISSION

Form 1002A
Rev. 2009

☐ ORIGINAL
☒ AMENDED (Reason)

Change classification of well

COMPLETION REPORT

TYPE OF DRILLING OPERATION

☐ STRAIGHT HOLE ☐ DIRECTIONAL HOLE ☒ HORIZONTAL HOLE
☐ SERVICE WELL

If directional or horizontal, see reverse for bottom hole location.

COUNTY	Garfield	SEC	18	TWP	24N	RGE	4W
LEASE NAME	Holden			WE NO.	3-18WH		
SW 1/4	SW 1/4	SE 1/4	SW 1/4	FSL OF 1/4 SEC	165	FWL OF 1/4 SEC	1440
ELEVATION N Derrick	1121	Ground	1106	Latitude (if known)		Longitude (if known)	
OPERATOR NAME	SK Plymouth, LLC			OTC/OCC OPERATOR NO.	23485		
ADDRESS	6100 S Yale Ave Suite 500						
CITY	Tulsa		STATE	OK		ZIP	74136

SPUD DATE 4/16/2015
DRLG FINISHED DATE 5/4/2015
DATE OF WELL COMPLETION 6/6/2015
1st PROD DATE 6/10/2015
RECOMP DATE

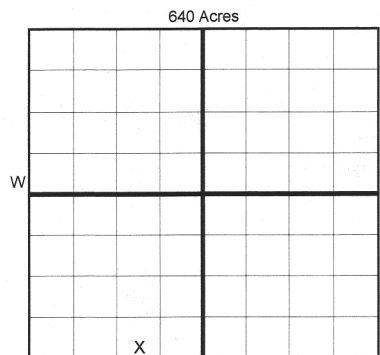

COMPLETION TYPE

<input checked="" type="checkbox"/> SINGLE ZONE
<input type="checkbox"/> MULTIPLE ZONE
Application Date
COMINGLED
Application Date
LOCATION
EXCEPTION ORDER
INCREASED DENSITY
ORDER NO. 639829

CASING & CEMENT (Form 1002C must be attached)

TYPE	SIZE	WEIGHT	GRADE	FEET	PSI	SAX	TOP OF CMT
CONDUCTOR							
SURFACE	9 5/8"	36	J55	531		240	Surface
INTERMEDIATE							
PRODUCTION	7"	26	P110	6370		310	3723
LINER	4 1/2"	11.6	P110	6307-10819		500	

PACKER @ _____ BRAND & TYPE _____ PLUG @ _____ TYPE _____ PLUG @ _____ TYPE _____
PACKER @ _____ BRAND & TYPE _____ PLUG @ _____ TYPE _____ PLUG @ _____ TYPE _____

TOTAL DEPTH 10,830

Top of Liner 6307

COMPLETION & TEST DATA BY PRODUCING FORMATION

FORMATION	Woodford
SPACING & SPACING ORDER NUMBER	636337 (640)
CLASS: Oil, Gas, Dry, Inj, Disp, Comm Disp, Svc	Gas
PERFORATED INTERVALS	6400 - 10752
ACID/VOLUME	55,860 gal Acid
	14 Stages
FRACTURE TREATMENT (Fluids/Prop Amounts)	1,031,285 lbs Sand
	75,204 bbls Water

Min Gas Allowable (165:10-17-7)

Gas Purchaser/Measurer

Superior

☒

OR

First Sales Date

6/10/2015

INITIAL TEST DATA

Oil Allowable (165:10-13-3)

INITIAL TEST DATE	9/20/2017
OIL-BBL/DAY	10
OIL-GRAVITY (API)	40
GAS-MCF/DAY	255
GAS-OIL RATIO CU FT/BBL	25,500
WATER-BBL/DAY	402
PUMPING OR FLOWING	Pumping
INITIAL SHUT-IN PRESSURE	
CHOKE SIZE	
FLOW TUBING PRESSURE	

AS SUBMITTED

A record of the formations drilled through, and pertinent remarks are presented on the reverse. I declare that I have knowledge of the contents of this report and am authorized by my organization to make this report, which was prepared by me or under my supervision and direction, with the data and facts stated herein to be true, correct, and complete to the best of my knowledge and belief.

SIGNATURE	Kathy Baratz	DATE	10/12/2017	PHONE NUMBER	918.599.1866
ADDRESS	6100 S Yale Ave Suite 500	CITY	Tulsa	STATE	OK
		ZIP	74136	EMAIL ADDRESS	kbaratz@skplymouth.com

PLEASE TYPE OR USE BLACK INK ONLY

FORMATION RECORD

Give formation names and tops, if available, or descriptions and thickness of formations drilled through. Show intervals cored or drillstem tested.

LEASE NAME Holden

WELL NO. 3-18WH

NAMES OF FORMATIONS	TOP
Woodford	6792 MD 6191 TVD

FOR COMMISSION USE ONLY	
ITD on file <input type="checkbox"/> YES <input type="checkbox"/> NO	
APPROVED _____	DISAPPROVED _____
2) Reject Codes	

Were open hole logs run?	___ yes <u>X</u> no
Date Last log was run	_____
Was CO ₂ encountered?	___ yes <u>X</u> no at what depths? _____
Was H ₂ S encountered?	___ yes <u>X</u> no at what depths? _____
Were unusual drilling circumstances encountered?	___ yes <u>X</u> no
If yes, briefly explain below	

Other remarks:

640 Acres

X									

If more than three drainholes are proposed, attach a separate sheet indicating the necessary information.

Direction must be stated in degrees azimuth.
Please note, the horizontal drainhole and its end point must be located within the boundaries of the lease or spacing unit.

Directional surveys are required for all drainholes and directional wells.

640 Acres

BOTTOM HOLE LOCATION FOR DIRECTIONAL HOLE

SEC	TWP	RGE	COUNTY	Spot Location	Feet From 1/4 Sec Lines	FSL	FWL
				1/4 1/4 1/4 1/4			
Measured Total Depth		True Vertical Depth		BHL From Lease, Unit, or Property Line:			

BOTTOM HOLE LOCATION FOR HORIZONTAL HOLE: (LATERALS)

LATERAL #1											
SEC	18	TWP	24N	RGE	4W	COUNTY Garfield					
Spot Location						Feet From 1/4 Sec Lines		FNL	165	FWL	1832
NE		1/4 NW		1/4 NE		1/4 NW					
Depth of Deviation				Radius of Turn		Direction		Total Length			
5,485				636		4		4,038			
Measured Total Depth				True Vertical Depth		BHL From Lease, Unit, or Property Line:					
10,830				6,169		165					

LATERAL #2							
SEC	TWP	RGE	COUNTY				
Spot Location							
1/4		1/4	1/4	Feet From 1/4 Sec Lines	FSL	FWL	
Depth of Deviation		Radius of Turn		Direction		Total Length	
Measured Total Depth		True Vertical Depth		BHL From Lease, Unit, or Property Line:			

LATERAL #3							
SEC	TWP	RGE	COUNTY				
Spot Location							
1/4		1/4	1/4	Feet From 1/4 Sec Lines	FSL	FWL	
Depth of Deviation		Radius of Turn		Direction	Total Length		
Measured Total Depth		True Vertical Depth		BHL From Lease, Unit, or Property Line:			

12/1/17
Oklahoma Corporation Commission
Oil & Gas Conservation Division
Post Office Box 52000
Oklahoma City, Oklahoma 73152-2000
Rule 165: 10-3-25

Form 1002A

1016EZ

API No.: 5047250230001

Completion Report

Spud Date: April 16, 2015

OTC Prod. Unit No.: 047-216134

Drilling Finished Date: May 04, 2015

Amended

A: 216134 I

1st Prod Date: June 10, 2015

Amend Reason: CHANGE CLASSIFICATION OF WELL

Completion Date: June 06, 2015

Drill Type: HORIZONTAL HOLE

Min Gas Allowable: Yes

Well Name: HOLDEN 3-18WH

Purchaser/Measurer: SUPERIOR

Location: GARFIELD 18 24N 4W
SW SW SE SW
165 FSL 1440 FWL of 1/4 SEC
Derrick Elevation: 1121 Ground Elevation: 1106

First Sales Date: 06/10/2015

Operator: SK PLYMOUTH LLC 23485

6100 S YALE AVE STE 500
TULSA, OK 74136-1906

Completion Type		Location Exception		Increased Density	
X	Single Zone	Order No		Order No	
	Multiple Zone	646953		639829	
	Commingled				

Casing and Cement							
Type	Size	Weight	Grade	Feet	PSI	SAX	Top of CMT
SURFACE	9 5/8	36	J-55	531		240	SURFACE
PRODUCTION	7	26	P-110	6370		310	3723

Liner								
Type	Size	Weight	Grade	Length	PSI	SAX	Top Depth	Bottom Depth
LINER	4 1/2	11.6	P-110	4512	0	500	6307	10819

Total Depth: 10830

Packer		Plug	
Depth	Brand & Type	Depth	Plug Type
There are no Packer records to display.		There are no Plug records to display.	

Initial Test Data										
Test Date	Formation	Oil BBL/Day	Oil-Gravity (API)	Gas MCF/Day	Gas-Oil Ratio Cu FT/BBL	Water BBL/Day	Pumpin or Flowing	Initial Shut-In Pressure	Choke Size	Flow Tubing Pressure
Sep 20, 2017	319WDFD WOODFORD	10	40	255	25500	402	PUMPING	1		

November 27, 2017

2015: 80,597
2016: 98,303

+MT - shale

of 2

EZ

DR