

OKLAHOMA CORPORATION COMMISSION
OIL & GAS CONSERVATION DIVISION
P.O. BOX 52000
OKLAHOMA CITY, OK 73152-2000
(Rule 165:10-3-1)

API NUMBER: 017 25123

Approval Date: 11/21/2017

Expiration Date: 05/21/2018

Horizontal Hole

Oil & Gas

PERMIT TO DRILL

WELL LOCATION: Sec: 11 Twp: 12N Rge: 6W

County: CANADIAN

SPOT LOCATION:

NE

NE

NW

NW

FEET FROM QUARTER: FROM

NORTH

FROM

WEST

SECTION LINES:

250

1230

Lease Name: GLACIER 11-14-12-6

Well No: 2HX

Well will be 250 feet from nearest unit or lease boundary.

Operator Name: JONES ENERGY LLC

Telephone: 5123282953

OTC/OCC Number: 21043 0

JONES ENERGY LLC
807 LAS CIMAS PKWY STE 350
AUSTIN, TX 78746-6193

MATTHEW CHARLES MACH
13600 NW 10TH STREET
YUKON OK 73099

Formation(s) (Permit Valid for Listed Formations Only):

	Name	Depth	Name	Depth
1	MISSISSIPPIAN	8448	6	
2	WOODFORD	8773	7	
3			8	
4			9	
5			10	

Spacing Orders: 668588

Location Exception Orders:

Increased Density Orders:

Pending CD Numbers: 201702774
201705955
201705956
201705957
201705958

Special Orders:

Total Depth: 18653

Ground Elevation: 1281

Surface Casing: 1500

Depth to base of Treatable Water-Bearing FM: 530

Under Federal Jurisdiction: No

Fresh Water Supply Well Drilled: No

Surface Water used to Drill: Yes

PIT 1 INFORMATION

Approved Method for disposal of Drilling Fluids:

Type of Pit System: CLOSED Closed System Means Steel Pits

Type of Mud System: WATER BASED

Chlorides Max: 5000 Average: 3000

Is depth to top of ground water greater than 10ft below base of pit? Y

Within 1 mile of municipal water well? N

Wellhead Protection Area? N

Pit is located in a Hydrologically Sensitive Area.

Category of Pit: C

Liner not required for Category: C

Pit Location is ALLUVIAL

Pit Location Formation: ALLUVIUM

D. One time land application -- (REQUIRES PERMIT)

PERMIT NO: 17-40004

H. SEE MEMO

This permit does not address the right of entry or settlement of surface damages.

The duration of this permit is SIX MONTHS, except as otherwise provided by Rule 165: 10-3-1.

Rule 165: 10-3-4 (c) (7) (e) - The Operator shall give 24 Hours notice by telephone to the appropriate District Office of the Conservation Division as to when Surface Casing will be run.

PIT 2 INFORMATION

Type of Pit System: CLOSED Closed System Means Steel Pits

Type of Mud System: OIL BASED

Chlorides Max: 300000 Average: 200000

Is depth to top of ground water greater than 10ft below base of pit? Y

Within 1 mile of municipal water well? N

Wellhead Protection Area? N

Pit is located in a Hydrologically Sensitive Area.

Category of Pit: C

Liner not required for Category: C

Pit Location is ALLUVIAL

Pit Location Formation: ALLUVIUM

HORIZONTAL HOLE 1

Sec 14 Twp 12N Rge 6W County CANADIAN

Spot Location of End Point: S2 S2 S2 S2

Feet From: SOUTH 1/4 Section Line: 165

Feet From: WEST 1/4 Section Line: 2640

Depth of Deviation: 8236

Radius of Turn: 477

Direction: 174

Total Length: 9668

Measured Total Depth: 18653

True Vertical Depth: 8773

End Point Location from Lease,
Unit, or Property Line: 165

Notes:

Category

Description

DEEP SURFACE CASING

11/3/2017 - G71 - APPROVED; NOTIFY OCC FIELD INSPECTOR IMMEDIATELY OF ANY LOSS OF CIRCULATION OR FAILURE TO CIRCULATE CEMENT TO SURFACE ON ANY CONDUCTOR OR SURFACE CASING

HYDRAULIC FRACTURING

11/3/2017 - G71 - OCC 165:10-3-10 REQUIRES:

1) PRIOR TO COMMENCEMENT OF HYDRAULIC FRACTURING OPERATIONS FOR HORIZONTAL WELLS, NOTICE GIVEN FIVE BUSINESS DAYS IN ADVANCE TO OFFSET OPERATORS WITH WELLS COMPLETED IN THE SAME COMMON SOURCE OF SUPPLY WITHIN 1/2 MILE;

2) WITH NOTICE ALSO GIVEN 48 HOURS IN ADVANCE OF HYDRAULIC FRACTURING ALL WELLS TO BOTH THE OCC CENTRAL OFFICE AND LOCAL DISTRICT OFFICES, USING THE "FRAC NOTICE FORM" FOUND AT THE FOLLOWING LINK: OCCEWEB.COM/OG/OGFORMS.HTML; AND,

3) THE CHEMICAL DISCLOSURE OF HYDRAULIC FRACTURING INGREDIENTS FOR ALL WELLS TO BE REPORTED TO FRACFOCUS WITHIN 60 DAYS AFTER THE CONCLUSION THE HYDRAULIC FRACTURING OPERATIONS, USING THE FOLLOWING LINK: FRACFOCUS.ORG

MEMO

11/3/2017 - G71 - PITS 1 & 2 - CLOSED SYSTEM=STEEL PITS PER OPERATOR REQUEST, PIT 2 - OBM RETURNED TO VENDOR, CUTTINGS PERMITTED PER DISTRICT

PENDING CD - 201702774

11/21/2017 - G60 - (640)(HOR) 14-12N-6W
EXT 635714 MSSP, WDFD, OTHER
COMPL. INT. (MSSP) NLT 660' FB
COMPL. INT. (WDFD) NLT 165' FNL/FSL, NLT 330' FEL/FWL
REC. 8/8/17 (MINMIER)

This permit does not address the right of entry or settlement of surface damages.

The duration of this permit is SIX MONTHS, except as otherwise provided by Rule 165: 10-3-1.

Rule 165: 10-3-4 (c) (7) (e) - The Operator shall give 24 Hours notice by telephone to the appropriate District Office of the Conservation Division as to when Surface Casing will be run.

017 25123 GLACIER 11-14-12-6 2HX

Category	Description
PENDING CD - 201705955	11/21/2017 - G60 - (I.O.) 11 & 14-12N-6W EST MULTIUNIT HORIZONTAL WELL X668588 (11-12N-6W) MSSP, WDFD X201702774 (14-12N-6W) MSSP, WDFD (WDFD IS AN ADJACENT COMMON SOURCE OF SUPPLY TO MSSP) 50% 11-12N-6W 50% 14-12N-6W NO OP. NAMED REC. 10/3/17 (NORRIS)
PENDING CD - 201705956	11/21/2017 - G60 - (I.O.) 11 & 14-12N-6W X668588 (11-12N-6W) MSSP, WDFD X201702774 (14-12N-6W) MSSP, WDFD COMPL. INT. (11-12N-6W) NCT 165' FNL, NCT 0' FSL, NCT 2000' FWL COMPL. INT. (14-12N-6W) NCT 0' FNL, NCT 165' FSL, NCT 2000' FWL NO OP. NAMED REC. 10/23/17 (MILLER)
PENDING CD - 201705957	11/21/2017 - G60 - 11-12N-6W X668588 MSSP, WDFD 1 WELL NO OP. NAMED REC. 10/3/17 (NORRIS)
PENDING CD - 201705958	11/21/2017 - G60 - 14-12N-6W X201702774 MSSP, WDFD 1 WELL NO OP. NAMED REC. 10/3/17 (NORRIS)
SPACING - 668588	11/21/2017 - G60 - (640)(HOR) 11-12N-6W EXT 629376 MSSP. WDFD. OTHER COMPL. INT. (MSSP) NCT 660' FB COMPL. INT. (WDFD) NCT 165' FNL/FSL, NCT 330' FEL/FWL (COEXIST WITH SP. ORDER 135124/141550 MISS)

This permit does not address the right of entry or settlement of surface damages.

The duration of this permit is SIX MONTHS, except as otherwise provided by Rule 165: 10-3-1.

Rule 165: 10-3-4 (c) (7) (e) - The Operator shall give 24 Hours notice by telephone to the appropriate District Office of the Conservation Division as to when Surface Casing will be run.

JONES Well Location Plat

Operator : JONES ENERGY, LTD.

Lease Name and No. : GLACIER 11-14-12-6 2HX

Footage : 250' FNL - 1230' FWL GR. ELEVATION : 1281'

Section : 11 Township : 12N Range : 6W I.M.

County : Canadian State of Oklahoma

Terrain at Loc. : Location fell in open flat cultivated field.

3501725123

S.H.L. Sec. 11-12N-6W I.M.

B.H.L. Sec. 14-12N-6W I.M.



0 660 1320 1980
1"=1320'

GPS DATUM

NAD 27

OK NORTH ZONE

Surface Hole Loc.:

Lat: 35°32'09.97"N

Lon: 97°48'30.62"W

X: 2056978

Y: 195203

Penetration Point:

Lat: 35°32'10.74"N

Lon: 97°48'13.56"W

X: 2058387

Y: 195284

Bottom Hole Loc.:

Lat: 35°30'29.73"N

Lon: 97°48'13.54"W

X: 2058410

Y: 185070

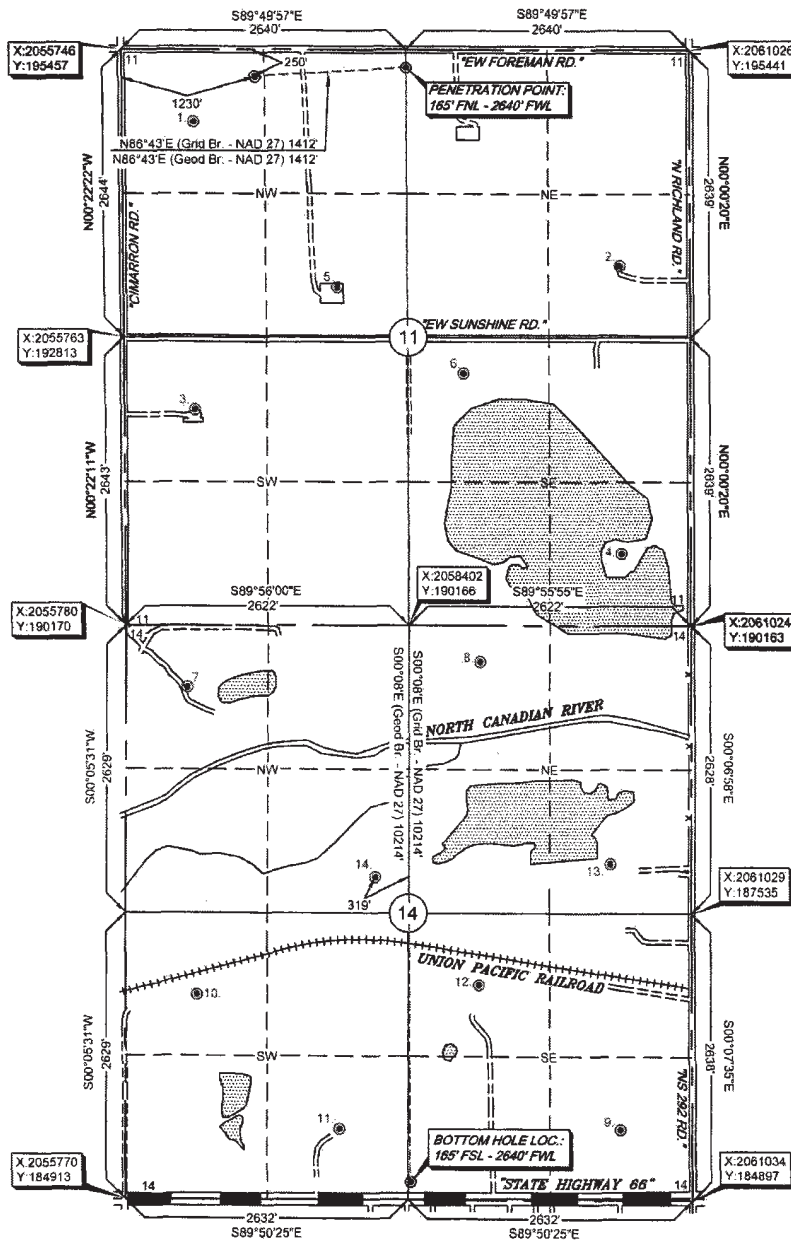

Quarter Section distances may be assumed from a Government Survey Plat or assumed as a proportionate distance from opposing section corners, or occupation thereof, and may not have been measured on-the-ground, and further, does not represent a true boundary survey.

Please note that this location was staked on the ground under the supervision of a Licensed Professional Land Surveyor, but the accuracy of this survey is not guaranteed. Please contact Arkoma Surveying and Mapping promptly if any inconsistency is determined. GPS data is observed from RTK - GPS.

NOTE: X and Y data shown hereon for Section Corners may NOT have been surveyed on-the-ground, and further, does NOT represent a true Boundary Survey, survey and plat by.

Arkoma Surveying and Mapping, PLLC

P.O. Box 238 Wilburton, OK 74578

Ph. 918-465-5711 Fax 918-465-5030

Certificate of Authorization No. 5348

Expires June 30, 2018

Invoice #7001-A-B

Date Staked : 07/06/17 By : C.K.

Date Drawn : 07/10/17 By : K.B.

Added PP & BHL : 08/02/17 By : K.B.

Rev PP & BHL : 08/07/17 By : R.S.

Certification:

This is to certify that this Well Location Plat represents the results of a survey made on the ground performed under the supervision of the undersigned.

Lance G. Mathis
LANCE G. MATHIS

08/08/17

OK LPLS 1664

