

OKLAHOMA CORPORATION COMMISSION  
OIL & GAS CONSERVATION DIVISION  
P.O. BOX 52000  
OKLAHOMA CITY, OK 73152-2000  
(Rule 165:10-3-1)

API NUMBER: 063 24733

Approval Date: 11/21/2017

Expiration Date: 05/21/2018

Horizontal Hole Oil & Gas

PERMIT TO DRILL

WELL LOCATION: Sec: 12 Twp: 7N Rge: 10E County: HUGHES  
SPOT LOCATION: ☐ SW ☐ SE ☐ SE ☐ NW FEET FROM QUARTER: FROM NORTH FROM WEST  
SECTION LINES: 2375 2170

Lease Name: CLARA Well No: 2-12/13/24H Well will be 2170 feet from nearest unit or lease boundary.  
Operator Name: TRINITY OPERATING (USG) LLC Telephone: 7139515351 OTC/OCC Number: 23879 0

TRINITY OPERATING (USG) LLC  
601 TRAVIS ST STE 1900  
HOUSTON, TX 77002-3253

JOHN D. WELCH  
3237 N. 383 RD.  
WETUMKA OK 74883

Formation(s) (Permit Valid for Listed Formations Only):

Name	Depth	Name	Depth
1 WOODFORD	4580	6	
2		7	
3		8	
4		9	
5		10	

Spacing Orders: 634258  
629878

Location Exception Orders:

Increased Density Orders:

Pending CD Numbers: 201707140  
201707142  
201707143  
201706173  
201706172  
201704257

Special Orders:

Total Depth: 14893 Ground Elevation: 831 Surface Casing: 270 Depth to base of Treatable Water-Bearing FM: 220

Under Federal Jurisdiction: No Fresh Water Supply Well Drilled: No Surface Water used to Drill: No

PIT 1 INFORMATION

Approved Method for disposal of Drilling Fluids:

Type of Pit System: ON SITE

A. Evaporation/dewater and backfilling of reserve pit.

Type of Mud System: AIR

Is depth to top of ground water greater than 10ft below base of pit? Y

E. Haul to Commercial pit facility: Sec. 19 Twn. 8N Rng. 5E Cnty. 125 Order No: 274874

Within 1 mile of municipal water well? N

H. SEE MEMO

Wellhead Protection Area? N

Pit is located in a Hydrologically Sensitive Area.

Category of Pit: 4

Liner not required for Category: 4

Pit Location is BED AQUIFER

Pit Location Formation: CALVIN

Mud System Change to Water-Based or Oil-Based Mud Requires an Amended Intent (Form 1000).

This permit does not address the right of entry or settlement of surface damages.  
The duration of this permit is SIX MONTHS, except as otherwise provided by Rule 165: 10-3-1.  
Rule 165: 10-3-4 (c) (7) (e) - The Operator shall give 24 Hours notice by telephone to the appropriate District Office of the Conservation Division as to when Surface Casing will be run.

#### PIT 2 INFORMATION

Type of Pit System: CLOSED Closed System Means Steel Pits

Type of Mud System: WATER BASED

Chlorides Max: 8000 Average: 5000

Is depth to top of ground water greater than 10ft below base of pit? Y

Within 1 mile of municipal water well? N

Wellhead Protection Area? N

Pit is located in a Hydrologically Sensitive Area.

**Category of Pit: C**

**Liner not required for Category: C**

Pit Location is BED AQUIFER

Pit Location Formation: CALVIN

#### PIT 3 INFORMATION

Type of Pit System: CLOSED Closed System Means Steel Pits

Type of Mud System: OIL BASED

Chlorides Max: 300000 Average: 200000

Is depth to top of ground water greater than 10ft below base of pit? Y

Within 1 mile of municipal water well? N

Wellhead Protection Area? N

Pit is located in a Hydrologically Sensitive Area.

**Category of Pit: C**

**Liner not required for Category: C**

Pit Location is BED AQUIFER

Pit Location Formation: CALVIN

#### HORIZONTAL HOLE 1

Sec 24 Twp 7N Rge 10E County HUGHES

Spot Location of End Point: NW SW SE NW

Feet From: NORTH 1/4 Section Line: 2000

Feet From: WEST 1/4 Section Line: 1534

Depth of Deviation: 4276

Radius of Turn: 477

Direction: 185

Total Length: 9868

Measured Total Depth: 14893

True Vertical Depth: 4889

End Point Location from Lease,  
Unit, or Property Line: 1534

Notes:

This permit does not address the right of entry or settlement of surface damages.

The duration of this permit is SIX MONTHS, except as otherwise provided by Rule 165: 10-3-1.

Rule 165: 10-3-4 (c) (7) (e) - The Operator shall give 24 Hours notice by telephone to the appropriate District Office of the Conservation Division as to when Surface Casing will be run.

063 24733 CLARA 2-12/13/24H

Category	Description
HYDRAULIC FRACTURING	<p>11/15/2017 - G71 - OCC 165:10-3-10 REQUIRES:</p> <p>1) PRIOR TO COMMENCEMENT OF HYDRAULIC FRACTURING OPERATIONS FOR HORIZONTAL WELLS, NOTICE GIVEN FIVE BUSINESS DAYS IN ADVANCE TO OFFSET OPERATORS WITH WELLS COMPLETED IN THE SAME COMMON SOURCE OF SUPPLY WITHIN 1/2 MILE;</p> <p>2) WITH NOTICE ALSO GIVEN 48 HOURS IN ADVANCE OF HYDRAULIC FRACTURING ALL WELLS TO BOTH THE OCC CENTRAL OFFICE AND LOCAL DISTRICT OFFICES, USING THE "FRAC NOTICE FORM" FOUND AT THE FOLLOWING LINK: <a href="http://OCCWEB.COM/OG/OGFORMS.HTML">OCCWEB.COM/OG/OGFORMS.HTML</a>; AND,</p> <p>3) THE CHEMICAL DISCLOSURE OF HYDRAULIC FRACTURING INGREDIENTS FOR ALL WELLS TO BE REPORTED TO FRACFOCUS WITHIN 60 DAYS AFTER THE CONCLUSION THE HYDRAULIC FRACTURING OPERATIONS, USING THE FOLLOWING LINK: <a href="http://FRACFOCUS.ORG">FRACFOCUS.ORG</a></p>
MEMO	<p>11/15/2017 - G71 - PIT 2 &amp; 3 - CLOSED SYSTEM=STEEL PITS PER OPERATOR REQUEST, WBM &amp; OBM CUTTINGS CAPTURED IN CONCRETE-LINED PIT, SOLIDIFIED AND HELD UNTIL DISPOSAL APPROVED BY OCC; PIT 3 - OBM TO VENDOR</p>
PENDING CD - 201704257	<p>11/21/2017 - G75 - (640)(HOR) 12-7N-10E EXT OTHERS EXT 656817 WDFD, OTHER COMPL. INT. NLT 165' FNL &amp; FSL, NLT 330' FEL &amp; FWL REC 10-4-2017 (MCKEOWN)</p>
PENDING CD - 201706172	<p>11/21/2017 - G75 - (I.O.) 12-7N-10E X201704257 WDFD 4 WELLS NO OP. NAMED REC 10-17-2017 (JOHNSON)</p>
PENDING CD - 201706173	<p>11/21/2017 - G75 - (I.O.) 13-7N-10E X634258 WDFD 4 WELLS NO OP. NAMED REC 10-17-2017 (JOHNSON)</p>
PENDING CD - 201707140	<p>11/21/2017 - G75 - (I.O.) 12, 13 &amp; 24-7N-10E X201704257 WDFD, OTHERS 12-7N-10E X634258 WDFD, OTHERS 13-7N-10E X629878 WDFD, OTHERS 24-7N-10E COMPL. INT. (12-7N-10E) NCT 2640' FNL, NCT 0' FSL, NCT 1400' FWL COMPL. INT. (13-7N-10E) NCT 0' FNL, NCT 0' FSL, NCT 1400' FWL COMPL. INT. (24-7N-10E) NCT 0' FNL, NCT 2050' FNL, NCT 1400' FWL NO OP. NAMED REC 11-13-2017 (JOHNSON)</p>
PENDING CD - 201707142	<p>11/21/2017 - G75 - (I.O.) 24-7N-10E X629878 WDFD 2 WELLS NO OP. NAMED REC 11-13-2017 (JOHNSON)</p>
PENDING CD - 201707143	<p>11/21/2017 - G75 - (I.O.) 12, 13 &amp; 24-7N-10E EST MULTIUNIT HORIZONTAL WELL X201704257 WDFD, OTHERS 12-7N-10E X634258 WDFD, OTHERS 13-7N-10E X629878 WDFD, OTHERS 24-7N-10E 27% 12-7N-10E 53% 13-7N-10E 20% 24-7N-10E NO OP. NAMED REC 11-13-2017 (JOHNSON)</p>
SPACING - 629878	<p>11/21/2017 - G75 - (640)(HOR) 24-7N-10E EXT 626170 WDFD, OTHERS COMPL. INT. NLT 165' FNL &amp; FSL, NLT 330' FEL &amp; FWL</p>
SPACING - 634258	<p>11/21/2017 - G75 - (640)(HOR) 13-7N-10E EXT 629878 WDFD, OTHERS COMPL. INT. NLT 165' FNL &amp; FSL, NLT 330' FEL &amp; FWL</p>

This permit does not address the right of entry or settlement of surface damages.

The duration of this permit is SIX MONTHS, except as otherwise provided by Rule 165: 10-3-1.

Rule 165: 10-3-4 (c) (7) (e) - The Operator shall give 24 Hours notice by telephone to the appropriate District Office of the Conservation Division as to when Surface Casing will be run.



B.H.L. Sec. 24-7N-10E I.M.

Terrain at Loc.: Location fell in scattered timber, East side of pad is 205' West of stake pipeline.

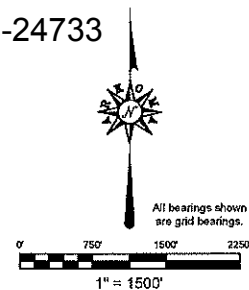

Bottom Hole Loc.:  
Lat: 35°03'59.93"N  
Lon: 96°12'24.92"W  
X: 2536562  
Y: 635549

Please note that this location was sketched on the ground under the supervision of a Licensed Professional Land Surveyor, and the accuracy of this survey is not guaranteed. Please contact Johnson, Sturtevant and Mapping promptly if any inaccuracy is determined. GPS data is obtained from RTK - GPS.

NOTE: X and Y data shown herein for Section Corners may NOT have been surveyed on-the-ground, and further, does NOT represent a true Boundary Survey. Quarter Section divisions may be assumed from a Government Survey plat or assumed to approximate distances from operating section corners, or occupation thereof, and may not have been measured on-the-ground, and further, does not represent a true boundary survey.

OK LPLS 1664

