

Oklahoma Corporation Commission
Oil & Gas Conservation Division
Post Office Box 52000
Oklahoma City, Oklahoma 73152-2000
Rule 165: 10-3-25

Form 1002A

API No.: 35071248750001

Completion Report

Spud Date: May 24, 2017

OTC Prod. Unit No.:

Drilling Finished Date: May 29, 2017

1st Prod Date: June 16, 2017

Completion Date: June 12, 2017

Recomplete Date: August 11, 2017

Drill Type: STRAIGHT HOLE

Well Name: BROCKMANN 18-1A

Purchaser/Measurer:

Location: KAY 18 27N 2E
C W2 NW SW
1980 FSL 330 FWL of 1/4 SEC
Derrick Elevation: 1092 Ground Elevation: 1080

First Sales Date:

Operator: LIBERTY OPERATING INC 15227

1827 ATCHISON DR
NORMAN, OK 73069-8225

Completion Type	
	Single Zone
	Multiple Zone
X	Commingled

Location Exception
Order No
666444

Increased Density
Order No
There are no Increased Density records to display.

Casing and Cement							
Type	Size	Weight	Grade	Feet	PSI	SAX	Top of CMT
SURFACE	8 5/8	24	J-55	225		165	SURFACE
PRODUCTION	5 1/2	17	J-55	3661	400	160	2661

Liner								
Type	Size	Weight	Grade	Length	PSI	SAX	Top Depth	Bottom Depth
There are no Liner records to display.								

Total Depth: 3661

Packer	
Depth	Brand & Type
There are no Packer records to display.	

Plug	
Depth	Plug Type
There are no Plug records to display.	

Initial Test Data

Test Date	Formation	Oil BBL/Day	Oil-Gravity (API)	Gas MCF/Day	Gas-Oil Ratio Cu FT/BBL	Water BBL/Day	Pumpin or Flowing	Initial Shut-In Pressure	Choke Size	Flow Tubing Pressure
Jun 14, 2017	BURBANK	5	38			30	PUMPING	380	3/4	
Aug 15, 2017	SKINNER	2	38			5	PUMPING	158		

Completion and Test Data by Producing Formation

Formation Name: BURBANK

Code: 404BRBK

Class: OIL

Spacing Orders

Order No	Unit Size
21712	20

Perforated Intervals

From	To
3610	3630

Acid Volumes

1,000 GALLONS 15% HCL

Fracture Treatments

359,945 SCF N2, 27,000 GALLONS FOAM, 20,000 POUNDS 20/40 SAND

Formation Name: SKINNER

Code: 404SKNR

Class: OIL

Spacing Orders

Order No	Unit Size
21586	160

Perforated Intervals

From	To
3538	3552

Acid Volumes

1,250 GALLONS 15% HCL ACID, 5,040 GALLONS 2% KCL

Fracture Treatments

NONE

Formation	Top
LAYTON	2814
CHECKERBOARD	3134
BIG LIME	3256
OSWEGO	3275
SKINNER	3497
BURBANK	3582

Were open hole logs run? Yes

Date last log run: May 29, 2017

Were unusual drilling circumstances encountered? No

Explanation:

Other Remarks

There are no Other Remarks.

FOR COMMISSION USE ONLY

1137614

Status: Accepted

RECEIVED

Form 1002A
Rev. 2009

SEP 13 2017

OKLAHOMA CORPORATION COMMISSION

API NO. **071-24875**
OTC PROD.
UNIT NO.

PLEASE TYPE OR USE BLACK INK ONLY
NOTE:
Attach copy of original 1002A
if recompletion or reentry.

OKLAHOMA CORPORATION COMMISSION
Oil & Gas Conservation Division
Post Office Box 52000
Oklahoma City, Oklahoma 73152-2000
Rule 165:10-3-25

☒ ORIGINAL
☐ AMENDED (Reason)

COMPLETION REPORT

TYPE OF DRILLING OPERATION
☒ STRAIGHT HOLE ☐ DIRECTIONAL HOLE ☐ HORIZONTAL HOLE
SERVICE WELL
If directional or horizontal, see reverse for bottom hole location.

SPUD DATE **5-24-2017**
DRLG FINISHED DATE **5-29-2017**
DATE OF WELL COMPLETION **6-12-2017**
1st PROD DATE **6-16-2017**
RECOMP DATE **8-11-2017**
Longitude (if known)

COUNTY **Kay** SEC **18** TWP **27N** RGE **2E**
LEASE NAME **Brockmann** WELL NO. **18-1A**
C **1/4 W/2 1/4 NW 1/4 SW 1/4** FSL OF 1/4 SEC **1980** FWL OF 1/4 SEC **330**
ELEVATION Derrick FL **1092** Ground **1080** Latitude (if known)
OPERATOR NAME **Liberty Operating, Inc.** OTC/OCC OPERATOR NO. **15227**
ADDRESS **1827 Atchison Dr.**
CITY **Norman** STATE **OK** ZIP **73069**

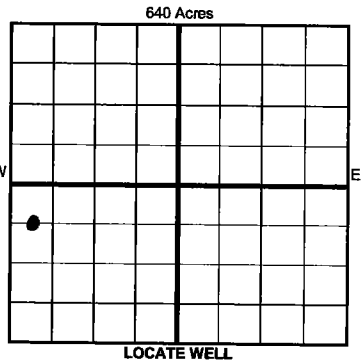

COMPLETION TYPE

☐ SINGLE ZONE
☐ MULTIPLE ZONE
☒ COMMINGLED
LOCATION **666444**
EXCEPTION ORDER
INCREASED DENSITY ORDER NO.

CASING & CEMENT (Form 1002C must be attached)

TYPE	SIZE	WEIGHT	GRADE	FEET	PSI	SAX	TOP OF CMT
CONDUCTOR							
SURFACE	8 5/8	24#	J-55	225		165	Surface
INTERMEDIATE							
PRODUCTION	5 1/2	17#	J-55	3661	400	160	2661 calc.
LINER							
				TOTAL DEPTH		3661	

PACKER @ _____ BRAND & TYPE _____ PLUG @ _____ TYPE _____ PLUG @ _____ TYPE _____
PACKER @ _____ BRAND & TYPE _____ PLUG @ _____ TYPE _____ PLUG @ _____ TYPE _____

COMPLETION & TEST DATA BY PRODUCING FORMATION **404 BRBRK 404 SKNR**

FORMATION	Burbank	Skinner				Monitor
SPACING & SPACING ORDER NUMBER	21712-20	21586 (160)				Report to FracFocus
CLASS: Oil, Gas, Dry, Inj, Disp, Comm Disp, Svc	Oil	Oil				
PERFORATED INTERVALS	3610-3630 45PF	3538-3552 45PF				
ACID/VOLUME	1000 gal 15% HCL	1250 gal 15% HCL	Acid			
FRACTURE TREATMENT (Fluids/Prop Amounts)	359,945 SCF N2	5040 gal 2% KCL				
	27,000 gal Foam	None				
	20,000# 20/40 Sand					

☐ Min Gas Allowable (165:10-17-7) OR ☐ Oil Allowable (165:10-13-3) Gas Purchaser/Measurer _____ First Sales Date _____

INITIAL TEST DATA

INITIAL TEST DATE	6-14-2017	8-15-2017			
OIL-BBL/DAY	5	2			
OIL-GRAVITY (API)	38	38			
GAS-MCF/DAY	TSTM	TSTM			
GAS-OIL RATIO CU FT/BBL	NA	NA			
WATER-BBL/DAY	30	5			
PUMPING OR FLOWING	Pumping	Pumping			
INITIAL SHUT-IN PRESSURE	380#	150#			
CHOKE SIZE	3/4"	NA			
FLOW TUBING PRESSURE	NA	NA			

AS SUBMITTED

A record of the formations drilled through, and pertinent remarks are presented on the reverse. I declare that I have knowledge of the contents of this report and am authorized by my organization to make this report, which was prepared by me or under my supervision and direction, with the data and facts stated herein to be true, correct, and complete to the best of my knowledge and belief.
SIGNATURE **Wayne McPherson** NAME (PRINT OR TYPE) **Wayne McPherson** DATE **405-990-5643**
ADDRESS **1827 Atchison Dr.** CITY **Norman** STATE **OK** ZIP **73069** EMAIL ADDRESS **waynemcpherson@coxinet.net**

PLEASE TYPE OR USE BLACK INK ONLY
FORMATION RECORD

Give formation names and tops, if available, or descriptions and thickness of formations drilled through. Show intervals cored or drillstem tested.

NAMES OF FORMATIONS	TOP
Layton	2814
Checkerboard	3134
Big Lime	3256
Oswego	3275
Skinner	3497
Burbank	3582

LEASE NAME Brockmann

WELL NO. 18-1A

FOR COMMISSION USE ONLY	
ITD on file <input type="checkbox"/> YES <input type="checkbox"/> NO	
APPROVED _____	DISAPPROVED _____
2) Reject Codes	

Were open hole logs run?	<u>X</u> yes <u> </u> no
Date Last log was run	<u>5-29-2017</u>
Was CO ₂ encountered?	<u> </u> yes <u>X</u> no at what depths? _____
Was H ₂ S encountered?	<u> </u> yes <u>X</u> no at what depths? _____
Were unusual drilling circumstances encountered?	<u> </u> yes <u>X</u> no
If yes, briefly explain below	

Other remarks:

640 Acres

If more than three drainholes are proposed, attach a separate sheet indicating the necessary information.

Direction must be stated in degrees azimuth.
Please note, the horizontal drainhole and its end point must be located within the boundaries of the lease or spacing unit.

Directional surveys are required for all drainholes and directional wells.

640 Acres

BOTTOM HOLE LOCATION FOR DIRECTIONAL HOLE

SEC	TWP	RGE	COUNTY
Spot Location			
1/4	1/4	1/4	1/4
Measured Total Depth		True Vertical Depth	Feet From 1/4 Sec Lines FSL FWL
BHL From Lease, Unit, or Property Line:			

BOTTOM HOLE LOCATION FOR HORIZONTAL HOLE: (LATERALS)

LATERAL #1			
SEC	TWP	RGE	COUNTY
Spot Location			
1/4	1/4	1/4	1/4
Depth of Deviation		Radius of Turn	Direction
Measured Total Depth		True Vertical Depth	Total Length
BHL From Lease, Unit, or Property Line:			

LATERAL #2			
SEC	TWP	RGE	COUNTY
Spot Location			
1/4	1/4	1/4	1/4
Depth of Deviation		Radius of Turn	Direction
Measured Total Depth		True Vertical Depth	Total Length
BHL From Lease, Unit, or Property Line:			

LATERAL #3			
SEC	TWP	RGE	COUNTY
Spot Location			
1/4	1/4	1/4	1/4
Depth of Deviation		Radius of Turn	Direction
Measured Total Depth		True Vertical Depth	Total Length
BHL From Lease, Unit, or Property Line:			