

Oklahoma Corporation Commission
Oil & Gas Conservation Division
Post Office Box 52000
Oklahoma City, Oklahoma 73152-2000
Rule 165: 10-3-25

Form 1002A

API No.: 35103246490001

Completion Report

Spud Date: April 22, 2014

OTC Prod. Unit No.: 103-213572

Drilling Finished Date: April 26, 2014

1st Prod Date: July 18, 2014

Amended

Completion Date: June 20, 2014

Amend Reason: RECOMPLETE

Recomplete Date: January 31, 2017

Drill Type: STRAIGHT HOLE

Well Name: GRACE 42

Purchaser/Measurer:

Location: NOBLE 31 24N 1W
SW NW SE NE
950 FSL 1600 FWL of 1/4 SEC
Derrick Elevation: 963 Ground Elevation: 950

First Sales Date:

Operator: DONRAY PETROLEUM LLC 21690

2525 NW EXPRESSWAY STE 640
OKLAHOMA CITY, OK 73112-7230

Completion Type	
X	Single Zone
	Multiple Zone
	Commingled

Location Exception	
Order No	
623627	

Increased Density	
Order No	
There are no Increased Density records to display.	

Casing and Cement							
Type	Size	Weight	Grade	Feet	PSI	SAX	Top of CMT
SURFACE	8 5/8	24		256		165	SURFACE
PRODUCTION	5.5	17		3646		225	1400

Liner								
Type	Size	Weight	Grade	Length	PSI	SAX	Top Depth	Bottom Depth
There are no Liner records to display.								

Total Depth: 3670

Packer	
Depth	Brand & Type
There are no Packer records to display.	

Plug	
Depth	Plug Type
3250	CIBP
3646	CIBP

Initial Test Data

Test Date	Formation	Oil BBL/Day	Oil-Gravity (API)	Gas MCF/Day	Gas-Oil Ratio Cu FT/BBL	Water BBL/Day	Pumpin or Flowing	Initial Shut-In Pressure	Choke Size	Flow Tubing Pressure
Jan 31, 2017	TONKAWA	20	40	110	5500	400	PUMPING	70		

Completion and Test Data by Producing Formation									
Formation Name: TONKAWA			Code: 406TNKW			Class: OIL			
Spacing Orders					Perforated Intervals				
Order No		Unit Size			From		To		
40039		40			2630		2644		
590355		40							
Acid Volumes					Fracture Treatments				
600 GALLONS 12.5% HCL					500 BSW, 15,000 POUNDS SAND				

Formation	Top
TONKAWA	2450

Were open hole logs run? No
Date last log run: April 26, 2014

Were unusual drilling circumstances encountered? No
Explanation:

Other Remarks
There are no Other Remarks.

FOR COMMISSION USE ONLY	
Status: Accepted	1137763

API NO. 10324649
OTC PROD. 103213572
UNIT NO.

PLEASE TYPE OR USE BLACK INK ONLY
NOTE:

Attach copy of original 1002A
if recompletion or reentry.

OKLAHOMA CORPORATION COMMISSION
Oil & Gas Conservation Division
Post Office Box 52000
Oklahoma City, Oklahoma 73152-2000
Rule 165-10-3-25

RECEIVED

OCT 02 2017

OKLAHOMA CORPORATION
COMMISSION

Form 1002A
Rev. 2009

☐ ORIGINAL
☒ AMENDED (Reason)

recomplete

COMPLETION REPORT

TYPE OF DRILLING OPERATION

☒ STRAIGHT HOLE ☐ DIRECTIONAL HOLE ☐ HORIZONTAL HOLE
☐ SERVICE WELL

If directional or horizontal, see reverse for bottom hole location.

COUNTY	noble	SEC	31	TWP	24n	RGE	1w	SPUD DATE	4-22-14	
LEASE NAME	grace	WELL NO.	42	DRLG FINISHED DATE	4-26-14	DATE OF WELL COMPLETION	6-20-14	1st PROD DATE	7-18-14	
GN 1/4 NW 1/4 SE 1/4 NE 1/4	FSL OF 1/4 SEC	950	FWL OF 1/4 SEC	1600	RECOMP DATE	1-31-17	Longitude (if known)			
ELEVATION Derrick FL	963	Ground	950	Latitude (if known)		Operator Name				
OPERATOR NAME						donray petroleum llc.				
ADDRESS						2525 nw expressway #640				
CITY						okc	STATE	ok	ZIP	73112

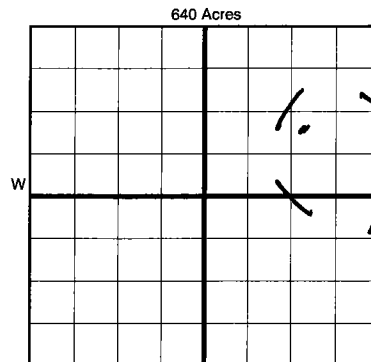

COMPLETION TYPE

<input checked="" type="checkbox"/> SINGLE ZONE
<input type="checkbox"/> MULTIPLE ZONE
<input type="checkbox"/> COMMINGLED
LOCATION EXCEPTION ORDER INCREASED DENSITY ORDER NO. 623627

CASING & CEMENT (Form 1002C must be attached)

TYPE	SIZE	WEIGHT	GRADE	FEET	PSI	SAX	TOP OF CMT
CONDUCTOR							
SURFACE	8.58	24#		256		165	surf.
INTERMEDIATE							
PRODUCTION	5.5	17#		3646		225	1400
LINER							
TOTAL DEPTH						3,670	

PACKER @ BRAND & TYPE PLUG @ 3646 TYPE cibp PLUG @ TYPE
PACKER @ BRAND & TYPE PLUG @ 3250 TYPE cibp PLUG @ TYPE

COMPLETION & TEST DATA BY PRODUCING FORMATION 406 TNKW

FORMATION	tonkawa								
SPACING & SPACING ORDER NUMBER	40039 (40) / 590355 (40)								
CLASS: Oil, Gas, Dry, Inj, Disp, Comm Disp, Svc	oil								
PERFORATED INTERVALS	2630-44								
ACID/VOLUME	600 gal 12.5% hcl								
FRACTURE TREATMENT (Fluids/Prop Amounts)	500bsw								
	15000# snd								

Monitor
Report to Proc Focus

Min Gas Allowable (165-10-17-7)

Gas Purchaser/Measurer

OR

First Sales Date

INITIAL TEST DATA

Oil Allowable (165-10-13-3)

INITIAL TEST DATE	1/31/2017								
OIL-BBL/DAY	20bpd								
OIL-GRAVITY (API)	40								
GAS-MCF/DAY	110mcfpd								
GAS-OIL RATIO CU FT/BBL	5500								
WATER-BBL/DAY	400bpd								
PUMPING OR FLOWING	pump								
INITIAL SHUT-IN PRESSURE	70#								
CHOKE SIZE									
FLOW TUBING PRESSURE									

AS SUBMITTED

A record of the formations drilled through, and pertinent remarks are presented on the reverse. I declare that I have knowledge of the contents of this report and am authorized by my organization to make this report, which was prepared by me or under my supervision and direction, with the data and facts stated herein to be true, correct, and complete to the best of my knowledge and belief.

SIGNATURE	ray corbitt jr	DATE	9/26/2017	PHONE NUMBER	(405) 418-4348
ADDRESS	2525 nw expressway #640	CITY	okc	STATE	ok
		ZIP	73112	EMAIL ADDRESS	ray@donraypetroleum.com

PLEASE TYPE OR USE BLACK INK ONLY

FORMATION RECORD

Give formation names and tops, if available, or descriptions and thickness of formations drilled through. Show intervals cored or drillstem tested.

LEASE NAME grace WELL NO. 42

NAMES OF FORMATIONS	TOP
tonkawa	2,450

FOR COMMISSION USE ONLY

ITD on file ☐ YES ☐ NO

APPROVED _____ DISAPPROVED _____

2) Reject Codes _____

Were open hole logs run? _____ yes ☒ no

Date Last log was run 4/26/2014

Was CO₂ encountered? _____ yes ☒ no at what depths? _____

Was H₂S encountered? _____ yes ☒ no at what depths? _____

Were unusual drilling circumstances encountered? _____ yes ☒ no
If yes, briefly explain below

Other remarks:

640 Acres

If more than three drainholes are proposed, attach a separate sheet indicating the necessary information.

Direction must be stated in degrees azimuth.
Please note, the horizontal drainhole and its end point must be located within the boundaries of the lease or spacing unit.

Directional surveys are required for all drainholes and directional wells.

640 Acres

BOTTOM HOLE LOCATION FOR DIRECTIONAL HOLE

SEC	TWP	RGE	COUNTY
Spot Location			
1/4	1/4	1/4	1/4
Measured Total Depth		True Vertical Depth	BHL From Lease, Unit, or Property Line:

BOTTOM HOLE LOCATION FOR HORIZONTAL HOLE: (LATERALS)

LATERAL #1

SEC	TWP	RGE	COUNTY
Spot Location			
1/4	1/4	1/4	1/4
Depth of Deviation		Radius of Turn	Direction
Measured Total Depth		True Vertical Depth	BHL From Lease, Unit, or Property Line:

LATERAL #2

SEC	TWP	RGE	COUNTY
Spot Location			
1/4	1/4	1/4	1/4
Depth of Deviation		Radius of Turn	Direction
Measured Total Depth		True Vertical Depth	BHL From Lease, Unit, or Property Line:

LATERAL #3

SEC	TWP	RGE	COUNTY
Spot Location			
1/4	1/4	1/4	1/4
Depth of Deviation		Radius of Turn	Direction
Measured Total Depth		True Vertical Depth	BHL From Lease, Unit, or Property Line: