

Oklahoma Corporation Commission  
Oil & Gas Conservation Division  
Post Office Box 52000  
Oklahoma City, Oklahoma 73152-2000  
Rule 165: 10-3-25

Form 1002A

API No.: 35085212050001

**Completion Report**

Spud Date: February 02, 2014

OTC Prod. Unit No.:

Drilling Finished Date: March 10, 2014

**Amended**

1st Prod Date: July 19, 2014

Amend Reason: CORRECT PRODUCTION CASING TOP OF CEMENT

Completion Date: July 17, 2014

**Drill Type: STRAIGHT HOLE**

Well Name: BSDSU-C BANKS 3-18

Purchaser/Measurer:

Location: LOVE 18 6S 1W  
NE SW SE NE  
2100 FNL 690 FEL of 1/4 SEC  
Derrick Elevation: 0 Ground Elevation: 0

First Sales Date:

Operator: MID-CON ENERGY OPERATING LLC 23271

2431 E 61ST ST STE 850  
TULSA, OK 74136-1236

Completion Type		Location Exception		Increased Density	
X	Single Zone	Order No		Order No	
	Multiple Zone	There are no Location Exception records to display.		There are no Increased Density records to display.	
	Commingled				

Casing and Cement							
Type	Size	Weight	Grade	Feet	PSI	SAX	Top of CMT
SURFACE	8 5/8	24	J-55	971		460	SURFACE
PRODUCTION	5 1/2	17	J-55	9128		500	4240

Liner								
Type	Size	Weight	Grade	Length	PSI	SAX	Top Depth	Bottom Depth
There are no Liner records to display.								

**Total Depth: 9185**

Packer		Plug	
Depth	Brand & Type	Depth	Plug Type
There are no Packer records to display.		There are no Plug records to display.	

Initial Test Data										
Test Date	Formation	Oil BBL/Day	Oil-Gravity (API)	Gas MCF/Day	Gas-Oil Ratio Cu FT/BBL	Water BBL/Day	Pumpin or Flowing	Initial Shut-In Pressure	Choke Size	Flow Tubing Pressure
Jul 19, 2014	DEESE	8				76	PUMPING			

Completion and Test Data by Producing Formation			
Formation Name: DEESE		Code: 404DEESS	Class: OIL
<b>Spacing Orders</b>		<b>Perforated Intervals</b>	
<b>Order No</b>	<b>Unit Size</b>	<b>From</b>	<b>To</b>
524732	UNIT	8884	9004
<b>Acid Volumes</b>		<b>Fracture Treatments</b>	
534 GALLONS 7 1/2 NEFE		19,110 GALLONS GEL WATER, 12,100 POUNDS 20/40	

Formation	Top
BASE OF PONTOTOC	2676
ZUCKERMAN LIMESTONE	3341
DAUBE LIMESTONE	3858
CRINERVILLE LIMESTONE	4880
BAYOU	5397
CHUBBEE	5667
LONE GROVE	6710
LOWER FUSULINID SAND	8506
STACY SAND	8660
TUSSY LIMESTONE	8856
DORNICK HILLS	9038

Were open hole logs run? Yes  
Date last log run: April 07, 2017

Were unusual drilling circumstances encountered? No  
Explanation:

Other Remarks
There are no Other Remarks.

FOR COMMISSION USE ONLY	
Status: Accepted	1137802

API NO. 085-21205  
OTC PROD.  
UNIT NO.

PLEASE TYPE OR USE BLACK INK ONLY

NOTE:  
Attach copy of original 1002A if recompletion or ree

OKLAHOMA CORPORATION COMMISSION

Oil & Gas Conservation Division

Post Office Box 52000

Oklahoma City, Oklahoma 73152-2000

Rule 165:10-3-25

COMPLETION REPORT

RECEIVED

Form 1002A  
Rev. 2009

OCT 10 2017

OKLAHOMA CORPORATION  
COMMISSION

☐ ORIGINAL  
☒ AMENDED (Reason)

CORRECT PRODUCTION

*casing  
Top of Cement*

TYPE OF DRILLING OPERATION

☒ STRAIGHT HOLE ☐ DIRECTIONAL HOLE ☐ HORIZONTAL HOLE  
☐ SERVICE WELL

If directional or horizontal, see reverse for bottom hole location.

COUNTY Love SEC 18 TWP 6S RGE 1W

LEASE NAME *BSDSU* C. Banks WELL NO. 3-18

NE 1/4 SW 1/4 SE 1/4 NE 1/4 *FNL2100* *FEL690*

ELEVATION Ground Latitude (if known) Longitude (if known)

OPERATOR NAME Mid-Con Energy Operating, LLC. OTC/OCC OPERATOR N 23271

ADDRESS 2431 E 61st St., Ste. 850

CITY Tulsa STATE OK ZIP 74136

SPUD DATE 02/2/2014

DRLG FINISHED DATE 3/10/2014

DATE OF WELL COMPLETION 7/17/2014

1st PROD DATE 7/19/2014

RECOMP DATE

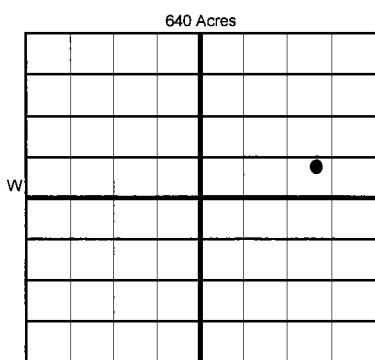

COMPLETION TYPE

☒ SINGLE ZONE  
☐ MULTIPLE ZONE  
Application Date  
☐ COMMINGLED  
Application Date  
LOCATION  
EXCEPTION ORDER  
INCREASED DENSITY  
ORDER NO.

CASING & CEMENT (Form 1002C must be attached)

TYPE	SIZE	WEIGHT	GRADE	FEET	PSI	SAX	TOP OF CMT
CONDUCTOR							
SURFACE	8 5/8	24#	J55	971		460	surface
INTERMEDIATE							
PRODUCTION	5 1/2	17#	J55	9,128		500	4240
LINER							
TOTAL DEPTH							9,185'

PACKER @ \_\_\_\_\_ BRAND & TYPE \_\_\_\_\_ PLUG @ \_\_\_\_\_ TYPE \_\_\_\_\_ PLUG @ \_\_\_\_\_ TYPE \_\_\_\_\_  
PACKER @ \_\_\_\_\_ BRAND & TYPE \_\_\_\_\_ PLUG @ \_\_\_\_\_ TYPE \_\_\_\_\_ PLUG @ \_\_\_\_\_ TYPE \_\_\_\_\_

COMPLETION & TEST DATA BY PRODUCING FORMATION

FORMATION	Deese						
SPACING & SPACING ORDER NUMBER	524732 (unit)						
CLASS: Oil, Gas, Dry, Inj, Disp, Comm Disp, Svc	oil						
PERFORATED INTERVALS	8996'-9004', 8928'-8937', 8884'-8900'						
ACID/VOLUME	4 spf						
FRACTURE TREATMENT (Fluids/Prop Amounts)	534 gal 7 1/2 NE- FE						
	19,110 gal gel water						
	12,100# 20/40						

*Reported  
to FracFocus*

Min Gas Allowable (165:10-17-7)

OR

Gas Purchaser/Measurer

First Sales Date

INITIAL TEST DATA

Oil Allowable (165:10-13-3)

INITIAL TEST DATE	7/19/2014						
OIL-BBL/DAY	8						
OIL-GRAVITY ( API)							
GAS-MCF/DAY							
GAS-OIL RATIO CU FT/BBL							
WATER-BBL/DAY	76						
PUMPING OR FLOWING	pumping						
INITIAL SHUT-IN PRESSURE							
CHOKE SIZE							
FLOW TUBING PRESSURE							

AS SUBMITTED

A record of the formations drilled through, and pertinent remarks are presented on the reverse. I declare that I have knowledge of the contents of this report and am authorized by my organization to make this report, which was prepared by me or under my supervision and direction, with the data and facts stated herein to be true, correct, and complete to the best of my knowledge and belief.

*Annie Houchin*  
SIGNATURE  
2431 E 61st St. Suite 850  
ADDRESS  
Tulsa  
CITY  
Ok  
STA  
74136  
ZIP  
10/6/17  
DATE  
918-748-3343  
PHONE NUMBER  
ahouchin@midcon-energy.com  
EMAIL ADDRESS

Give formation names and tops, if available, or descriptions and thickness of formations drilled through. Show intervals cored or drillstem tested.

FOR COMMISSION USE ONLY		
ITD on file	<input type="checkbox"/> YES	<input type="checkbox"/> NO
APPROVED	DISAPPROVED	2) Reject Codes

Were open hole logs run?      X yes    \_\_\_ no

Date Last log was run                  4/7/2017

Was CO<sub>2</sub> encountered?      \_\_\_ yes    X no    at what depths? \_\_\_\_\_

Was H<sub>2</sub>S encountered?      \_\_\_ yes    X no    at what depths? \_\_\_\_\_

Were unusual drilling circumstances encountered?      \_\_\_ yes    X no

If yes, briefly explain below

Other remarks:

A blank 4x4 grid with a bold cross dividing it into four 2x2 quadrants.

SEC	TWP	RGE	COUNTY
Spot Location			
1/4	1/4	1/4	1/4
Measured Total Depth		True Vertical Depth	Feet From 1/4 Sec Lines FSL FWL
			BHL From Lease, Unit, or Property Line:

LATERAL #1						
SEC	TWP	RGE	COUNTY			
Spot Location						
1/4		1/4		1/4		
Feet From 1/4 Sec Lines		FSL		FWL		
Depth of Deviation		Radius of Turn		Direction		Total Length
Measured Total Depth		True Vertical Depth		BHL From Lease, Unit, or Property Line:		

SEC	TWP	RGE	COUNTY			
Spot Location				Feet From 1/4 Sec Lines	FSL	FWL
1/4	1/4	1/4	1/4			
Depth of Deviation		Radius of Turn	Direction	Total Length		
Measured Total Depth		True Vertical Depth	BHL From Lease, Unit, or Property Line:			

SEC	TWP	RGE	COUNTY			
Spot Location				Feet From 1/4 Sec Lines	FSL	FWL
1/4	1/4	1/4	1/4			
Depth of Deviation		Radius of Turn	Direction	Total Length		
Measured Total Depth		True Vertical Depth	BHL From Lease, Unit, or Property Line:			