

Oklahoma Corporation Commission
Oil & Gas Conservation Division
Post Office Box 52000
Oklahoma City, Oklahoma 73152-2000
Rule 165: 10-3-25

Form 1002A

API No.: 35047251030000

Completion Report

Spud Date: June 07, 2017

OTC Prod. Unit No.:

Drilling Finished Date: June 22, 2017

1st Prod Date: September 05, 2017

Completion Date: September 08, 2017

Drill Type: STRAIGHT HOLE

Min Gas Allowable: Yes

Well Name: LLOYD 1-11

Purchaser/Measurer: TARGA PIPELINE

Location: GARFIELD 11 24N 8W
W2 W2 SE NE
660 FSL 1456 FWL of 1/4 SEC
Latitude: 36.57406 Longitude: -98.01885
Derrick Elevation: 0 Ground Elevation: 1191

First Sales Date: 09/05/2017

Operator: HERITAGE EXPLORATION LLC 23893

3209 PINE RIDGE RD
OKLAHOMA CITY, OK 73120-5622

Completion Type		Location Exception		Increased Density	
X	Single Zone	Order No		Order No	
	Multiple Zone	667918		There are no Increased Density records to display.	
	Commingled				

Casing and Cement							
Type	Size	Weight	Grade	Feet	PSI	SAX	Top of CMT
SURFACE	8 5/8	24	J-55	294		175	SURFACE
PRODUCTION	5 1/2	17	N-80	6900		250	5194

Liner								
Type	Size	Weight	Grade	Length	PSI	SAX	Top Depth	Bottom Depth
There are no Liner records to display.								

Total Depth: 6900

Packer		Plug	
Depth	Brand & Type	Depth	Plug Type
There are no Packer records to display.		6718	CIBP

Initial Test Data

Test Date	Formation	Oil BBL/Day	Oil-Gravity (API)	Gas MCF/Day	Gas-Oil Ratio Cu FT/BBL	Water BBL/Day	Pumpin or Flowing	Initial Shut-In Pressure	Choke Size	Flow Tubing Pressure
Sep 14, 2017	2ND WILCOX	6.67	55	207	31034	5	FLOWING	2300	10/64	600

Completion and Test Data by Producing Formation

Formation Name: 2ND WILCOX

Code: 202WLCX2

Class: GAS

Spacing Orders

Order No

Unit Size

664003

640

Perforated Intervals

From

To

6633

6734

Acid Volumes

1,000 GALLONS 7.5%

Fracture Treatments

There are no Fracture Treatments records to display.

Formation	Top
MISSISSIPPI LIME	5822
WOODFORD	6403
2ND WILCOX	6632

Were open hole logs run? Yes

Date last log run: June 23, 2017

Were unusual drilling circumstances encountered? No

Explanation:

Other Remarks

There are no Other Remarks.

FOR COMMISSION USE ONLY

Status: Accepted

1137804

API NO.	047-25103
OTC PROD.	
UNIT NO.	

PLEASE TYPE OR USE BLACK INK ONLY

NOTE:

Attach copy of original 1002A
if recompletion or reentry.

OKLAHOMA CORPORATION COMMISSION

Oil & Gas Conservation Division

Post Office Box 52000

Oklahoma City, Oklahoma 73152-2000

Rule 165:10-3-25

COMPLETION REPORT

X	ORIGINAL
	AMENDED (Reason)

TYPE OF DRILLING OPERATION

☒ STRAIGHT HOLE ☐ DIRECTIONAL HOLE ☐ HORIZONTAL HOLE
☐ SERVICE WELL

If directional or horizontal, see reverse for bottom hole location.

COUNTY	GARFIELD	SEC	11	TWP	24N	RGE	8W	DATE OF WELL COMPLETION	9/8/2017				
LEASE NAME	LLOYD					WELL NO.	1-11	1st PROD DATE	9/5/2017				
W2	1/4	W2	1/4	SE	1/4	NE	1/4	FSL OF 1/4 SEC	660	FWL OF 1/4 SEC	1456	RECOMP DATE	
ELEVATION	Derrick FL		Ground	1191	Latitude (if known)			36.57406°	Longitude (if known)		-98.01885°		
OPERATOR NAME	HERITAGE EXPLORATION LLC							OTC/OCC OPERATOR NO.	23893				
ADDRESS	3209 PINE RIDGE ROAD												
CITY	OKLAHOMA CITY					STATE	OK	ZIP	73120				

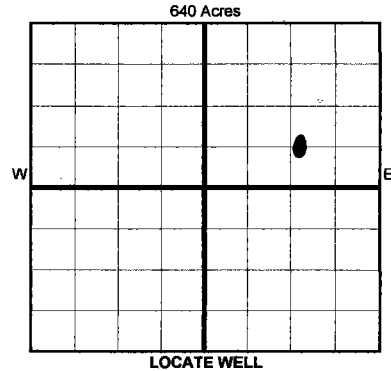

COMPLETION TYPE

X	SINGLE ZONE	
	MULTIPLE ZONE	
	Application Date	
	COMMINGLED	
	Application Date	
LOCATION		667918 <i>F.O.</i>
EXCEPTION ORDER		
INCREASED DENSITY		
ORDER NO.		

CASING & CEMENT (Form 1002C must be attached)

TYPE	SIZE	WEIGHT	GRADE	FEET	PSI	SAX	TOP OF CMT
CONDUCTOR							
SURFACE	8 5/8	24	J-55	294		175	SURFACE
INTERMEDIATE							
PRODUCTION	5 1/2	17	N-80	6900		250	5194
LINER							
PLUG @	6718	TYPE	CIBP	PLUG @	TYPE	TOTAL DEPTH	6,900

PACKER @ _____ BRAND & TYPE _____ PLUG @ 6718 TYPE CIBP PLUG @ _____ TYPE _____
 PACKER @ _____ BRAND & TYPE _____ PLUG @ _____ TYPE _____ PLUG @ _____ TYPE _____

COMPLETION & TEST DATA BY PRODUCING FORMATION

FORMATION	2ND WILCOX						No Frac
SPACING & SPACING ORDER NUMBER	664003/640						
CLASS: Oil, Gas, Dry, Inj, Disp, Comm Disp, Svc	GAS						
PERFORATED INTERVALS	6725-6734						
	6633-6656						
ACID/VOLUME	7.5%, 1000 gal						
FRACTURE TREATMENT (Fluids/Prop Amounts)							

Min Gas Allowable (165:10-17-7)

Gas Purchaser/Measurer

TARGA PIPELINE

OR
Oil Allowable (165:10-13-3)

First Sales Date

9/5/2017

INITIAL TEST DATA

INITIAL TEST DATE	9/14/2017					
OIL-BBL/DAY	6.67					
OIL-GRAVITY (API)	55					
GAS-MCF/DAY	207					
GAS-OIL RATIO CU FT/BBL	31,034					
WATER-BBL/DAY	5					
PUMPING OR FLOWING	Flowing					
INITIAL SHUT-IN PRESSURE	2300					
CHOKE SIZE	10/64					
FLOW TUBING PRESSURE	600					

A record of the formations drilled through, and pertinent remarks are presented on the reverse. I declare that I have knowledge of the contents of this report and am authorized by my organization to make this report, which was prepared by me or under my supervision and direction, with the data and facts stated herein to be true, correct, and complete to the best of my knowledge and belief.

SEAN STRICKLAND

10/6/2017 405-496-6756

SIGNATURE

NAME (PRINT OR TYPE)

DATE	PHONE NUMBER
------	--------------

3209 PINE RIDGE ROAD

OKLAHOMA CITY OK 73120

seanstrickland@heritageexpl.com

ADDRESS

CITY	STATE	ZIP
------	-------	-----

EMAIL ADDRESS

PLEASE TYPE OR USE BLACK INK ONLY

FORMATION RECORD

Give formation names and tops, if available, or descriptions and thickness of formations drilled through. Show intervals cored or drillstem tested.

NAMES OF FORMATIONS	TOP
MISSISSIPPI LIME	5,822
WOODFORD	6,403
2ND WILCOX	6,632

LEASE NAME LLOYD

WELL NO. 1-11

FOR COMMISSION USE ONLY	
ITD on file <input type="checkbox"/> YES <input type="checkbox"/> NO	
APPROVED _____	DISAPPROVED _____
2) Reject Codes	

Were open hole logs run?	<input checked="" type="checkbox"/> yes <input type="checkbox"/> no
Date Last log was run	<u>6/23/2017</u>
Was CO ₂ encountered?	<input type="checkbox"/> yes <input checked="" type="checkbox"/> no at what depths? _____
Was H ₂ S encountered?	<input type="checkbox"/> yes <input checked="" type="checkbox"/> no at what depths? _____
Were unusual drilling circumstances encountered?	<input type="checkbox"/> yes <input checked="" type="checkbox"/> no
If yes, briefly explain below	

Other remarks:

640 Acres

If more than three drainholes are proposed, attach a separate sheet indicating the necessary information.

Direction must be stated in degrees azimuth.
Please note, the horizontal drainhole and its end point must be located within the boundaries of the lease or spacing unit.

Directional surveys are required for all drainholes and directional wells.

640 Acres

BOTTOM HOLE LOCATION FOR DIRECTIONAL HOLE

SEC	TWP	RGE	COUNTY
Spot Location	1/4	1/4	1/4
Measured Total Depth	True Vertical Depth		Feet From 1/4 Sec Lines
		FSL	FWL
BHL From Lease, Unit, or Property Line:			

BOTTOM HOLE LOCATION FOR HORIZONTAL HOLE: (LATERALS)

LATERAL #1

SEC	TWP	RGE	COUNTY
Spot Location	1/4	1/4	1/4
Depth of Deviation	Radius of Turn		Direction
Measured Total Depth	True Vertical Depth		Total Length
		FSL	FWL
BHL From Lease, Unit, or Property Line:			

LATERAL #2

SEC	TWP	RGE	COUNTY
Spot Location	1/4	1/4	1/4
Depth of Deviation	Radius of Turn		Direction
Measured Total Depth	True Vertical Depth		Total Length
		FSL	FWL
BHL From Lease, Unit, or Property Line:			

LATERAL #3

SEC	TWP	RGE	COUNTY
Spot Location	1/4	1/4	1/4
Depth of Deviation	Radius of Turn		Direction
Measured Total Depth	True Vertical Depth		Total Length
		FSL	FWL
BHL From Lease, Unit, or Property Line:			

9/5/17

RECEIVED

Form 1002A
Rev. 2009

OCT 10 2017

OKLAHOMA CORPORATION COMMISSION

1016EZ

API NO. 047-25103
OTC PROD. UNIT NO. 047-219247
☒ ORIGINAL
☐ AMENDED (Reason)

PLEASE TYPE OR USE BLACK INK ONLY
NOTE:
Attach copy of original 1002A if recompletion or reentry.
A: 219247 I

OKLAHOMA CORPORATION COMMISSION
Oil & Gas Conservation Division
Post Office Box 52000
Oklahoma City, Oklahoma 73152-2000
Rule 165:10-3-25
COMPLETION REPORT

TYPE OF DRILLING OPERATION
☒ STRAIGHT HOLE ☐ DIRECTIONAL HOLE ☐ HORIZONTAL HOLE
☐ SERVICE WELL
If directional or horizontal, see reverse for bottom hole location.

COUNTY GARFIELD SEC 11 TWP 24N RGE 8W
LEASE NAME LLOYD
W2 1/4 W2 1/4 SE 1/4 NE 1/4 FSL OF 1/4 SEC 660 FWL OF 1/4 SEC 1456
ELEVATION Ground 1191 Latitude (if known) 36.57406° Longitude (if known) -98.01885°
OPERATOR NAME HERITAGE EXPLORATION LLC OTC/OCC OPERATOR NO. 23893
ADDRESS 3209 PINE RIDGE ROAD
CITY OKLAHOMA CITY STATE OK ZIP 73120

SPUD DATE 6/7/2017
DRLG FINISHED DATE 6/22/17
DATE OF WELL COMPLETION 9/8/2017
1st PROD DATE 9/5/2017
RECOMP DATE
OTC/OCC OPERATOR NO. 23893

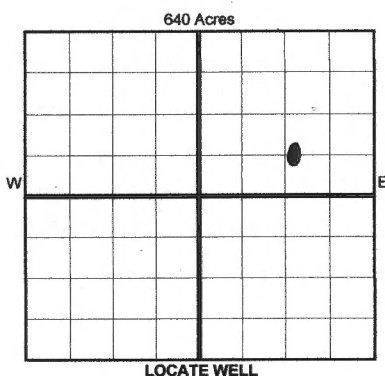

COMPLETION TYPE
☒ SINGLE ZONE
☐ MULTIPLE ZONE
Application Date
COMINGLED
Application Date
LOCATION 667918 F.O.
EXCEPTION ORDER
INCREASED DENSITY
ORDER NO.

TYPE	SIZE	WEIGHT	GRADE	FEET	PSI	SAX	TOP OF CMT
CONDUCTOR							
SURFACE	8 5/8	24	J-55	294		175	SURFACE
INTERMEDIATE							
PRODUCTION	5 1/2	17	N-80	6900		250	5194
LINER							

PACKER @ _____ BRAND & TYPE _____ PLUG @ 6718 TYPE CIBP PLUG @ _____ TYPE _____
PACKER @ _____ BRAND & TYPE _____ PLUG @ _____ TYPE _____ PLUG @ _____ TYPE _____

TOTAL DEPTH 6,900

FORMATION	2ND WILCOX						No Frac
SPACING & SPACING ORDER NUMBER	664003/640						
CLASS: Oil, Gas, Dry, Inj, Disp, Comm Disp, Svc	GAS						
PERFORATED INTERVALS	6725-6734						
	6633-6656						
ACID/VOLUME	7.5%, 1000 gal						
FRACTURE TREATMENT (Fluids/Prop Amounts)							

Min Gas Allowable (165:10-17-7) ☒ OR Oil Allowable (165:10-13-3)
Gas Purchaser/Measurer TARGA PIPELINE
First Sales Date 9/5/2017

INITIAL TEST DATA							
INITIAL TEST DATE	9/14/2017						
OIL-BBL/DAY	6.67						
OIL-GRAVITY (API)	55						
GAS-MCF/DAY	207						
GAS-OIL RATIO CU FT/BBL	31,034						
WATER-BBL/DAY	5						
PUMPING OR FLOWING	Flowing						
INITIAL SHUT-IN PRESSURE	2300						
CHOKE SIZE	10/64						
FLOW TUBING PRESSURE	600						

AS SUBMITTED

A record of the formations drilled through, and pertinent remarks are presented on the reverse. I declare that I have knowledge of the contents of this report and am authorized by my organization to make this report, which was prepared by me or under my supervision and direction, with the data and facts stated herein to be true, correct, and complete to the best of my knowledge and belief.
SIGNATURE SEAN STRICKLAND NAME (PRINT OR TYPE) 10/6/2017 405-496-6756
3209 PINE RIDGE ROAD OKLAHOMA CITY OK 73120 DATE PHONE NUMBER
ADDRESS CITY STATE ZIP EMAIL ADDRESS seanstrickland@heritageexpl.com

SCANNED

Handwritten initials and signature.

E2