

Oklahoma Corporation Commission
Oil & Gas Conservation Division
Post Office Box 52000
Oklahoma City, Oklahoma 73152-2000
Rule 165: 10-3-25

Form 1002A

API No.: 35133252410000

Completion Report

Spud Date: May 06, 2017

OTC Prod. Unit No.: 133-218716

Drilling Finished Date: May 18, 2017

1st Prod Date: June 06, 2017

Completion Date: June 02, 2017

Drill Type: STRAIGHT HOLE

Min Gas Allowable: Yes

Well Name: AMBER BROOKE 1-30

Purchaser/Measurer: ENERFIN

Location: SEMINOLE 30 8N 8E
SW NE SW NW
1948 FNL 916 FWL of 1/4 SEC
Latitude: 35.1397738 Longitude: -96.508179
Derrick Elevation: 0 Ground Elevation: 850

First Sales Date: 06/03/2017

Operator: RUFFEL LANCE OIL & GAS LLC 15459

210 PARK AVE STE 2150
OKLAHOMA CITY, OK 73102-5632

Completion Type		Location Exception		Increased Density	
X	Single Zone	Order No		Order No	
	Multiple Zone	662988		There are no Increased Density records to display.	
	Commingled				

Casing and Cement							
Type	Size	Weight	Grade	Feet	PSI	SAX	Top of CMT
SURFACE	8 5/8	32	J-55	421		230	SURFACE
PRODUCTION	5 1/2	17	J-55	3982		200	2680

Liner								
Type	Size	Weight	Grade	Length	PSI	SAX	Top Depth	Bottom Depth
There are no Liner records to display.								

Total Depth: 3987

Packer	
Depth	Brand & Type
There are no Packer records to display.	

Plug	
Depth	Plug Type
There are no Plug records to display.	

Initial Test Data

Test Date	Formation	Oil BBL/Day	Oil-Gravity (API)	Gas MCF/Day	Gas-Oil Ratio Cu FT/BBL	Water BBL/Day	Pumpin or Flowing	Initial Shut-In Pressure	Choke Size	Flow Tubing Pressure
Jun 06, 2017	MISENER-HUNTON	80	42	20	250	135	PUMPING	780	14/64	110

Completion and Test Data by Producing Formation

Formation Name: MISENER-HUNTON

Code: 319MSRH

Class: OIL

Spacing Orders

Order No	Unit Size
654075	40

Perforated Intervals

From	To
3810	3884

Acid Volumes

2,000 GALLONS 20%, 8,000 BARRELS, 9,688 BARRELS WATER

Fracture Treatments

There are no Fracture Treatments records to display.

Formation	Top
SAND AND SHALE	0
CROMWELL	3073
WOODFORD	3674
HUNTON	3735
SYLVAN	3892
VIOLA	3970

Were open hole logs run? Yes

Date last log run: May 17, 2017

Were unusual drilling circumstances encountered? No

Explanation:

Other Remarks

FAULT AT 3,540'

FOR COMMISSION USE ONLY

1137776

Status: Accepted

API NO. 133-25241
OTC PROD. 133-218716
UNIT NO.

PLEASE TYPE OR USE BLACK INK ONLY
NOTE:
Attach copy of original 1002A if recompletion or reentry.

OKLAHOMA CORPORATION COMMISSION
Oil & Gas Conservation Division
Post Office Box 52000
Oklahoma City, Oklahoma 73152-2000
Rule 165:10-3-25

RECEIVED

Form 1002A
Rev. 2009

OCT 02 2017

OKLAHOMA CORPORATION
COMMISSION

☒ ORIGINAL
☐ AMENDED (Reason)

TYPE OF DRILLING OPERATION

☒ STRAIGHT HOLE ☐ DIRECTIONAL HOLE ☐ HORIZONTAL HOLE
☐ SERVICE WELL

If directional or horizontal, see reverse for bottom hole location.

COUNTY	Seminole	SEC	30	TWP	8N	RGE	8E
LEASE NAME	Amber Brooke	WELL NO.	1-30	DATE OF WELL COMPLETION	6/2/2017	1st PROD DATE	6/6/2017
SW 1/4 NE 1/4 SW 1/4 NW 1/4	FNL 1948	FWL OF 1/4 SEC	916	RECOMP DATE			
ELEVATION N Derrick	Ground	850	Latitude (if known)	35.1397738	Longitude (if known)	-96.508179	
OPERATOR NAME	LANCE RUFFEL OIL & GAS LLC	OTC/OCC OPERATOR NO.	15459-0				
ADDRESS	210 PARK AVENUE, SUITE 2150						
CITY	OKLAHOMA CITY	STATE	OK	ZIP	73102		

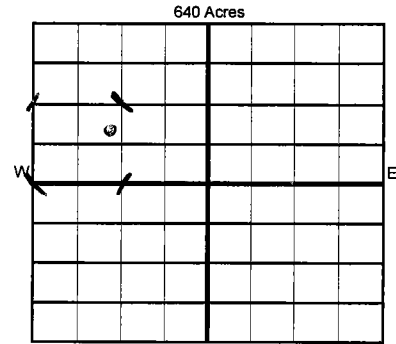

COMPLETION TYPE

<input checked="" type="checkbox"/> SINGLE ZONE
<input type="checkbox"/> MULTIPLE ZONE
Application Date
COMINGLED
Application Date
LOCATION
EXCEPTION ORDER
INCREASED DENSITY
ORDER NO.

CASING & CEMENT (Form 1002C must be attached)

TYPE	SIZE	WEIGHT	GRADE	FEET	PSI	SAX	TOP OF CMT
CONDUCTOR							
SURFACE	8-5/8"	32#	J-55	421'		230	Surface
INTERMEDIATE							
PRODUCTION	5-1/2"	17#	J-55	3,982.23'		200	2680
LINER							
				TOTAL DEPTH		3,987'	

PACKER @ _____ BRAND & TYPE _____ PLUG @ _____ TYPE _____ PLUG @ _____ TYPE _____
PACKER @ _____ BRAND & TYPE _____ PLUG @ _____ TYPE _____ PLUG @ _____ TYPE _____

COMPLETION & TEST DATA BY PRODUCING FORMATION

FORMATION	Misner-Hunton					No frac
SPACING & SPACING ORDER NUMBER	40 acre-654075					
CLASS: Oil, Gas, Dry, Inj, Disp, Comm Disp, Svc	Oil					
PERFORATED INTERVALS	3,810'-3,830'					
	3,848'-3,884'					
ACID/VOLUME	2,000 gals 20% 8,000BBLS 9,688 BBLS WTR					
FRACTURE TREATMENT (Fluids/Prop Amounts)						

Min Gas Allowable (165:10-17-7)

Gas Purchaser/Measurer

Enerfin

☒

OR

First Sales Date

6/3/2017

INITIAL TEST DATA

Oil Allowable (165:10-13-3)

INITIAL TEST DATE	6/6/2017
OIL-BBL/DAY	80
OIL-GRAVITY (API)	42
GAS-MCF/DAY	20
GAS-OIL RATIO CU FT/BBL	250:1
WATER-BBL/DAY	135
PUMPING OR FLOWING	Pumping
INITIAL SHUT-IN PRESSURE	780
CHOKE SIZE	14/64"
FLOW TUBING PRESSURE	110

AS SUBMITTED

A record of the formations drilled through, and pertinent remarks are presented on the reverse. I declare that I have knowledge of the contents of this report and am authorized by my organization to make this report, which was prepared by me or under my supervision and direction, with the data and facts stated herein to be true, correct, and complete to the best of my knowledge and belief.

SIGNATURE

LANCE RUFFEL

9.14.17

405/239-7036

210 PARK AVENUE, SUITE 2150

OKLAHOMA CITY

NAME (PRINT OR TYPE)

DATE

PHONE NUMBER

ADDRESS

CITY

STATE

ZIP

EMAIL ADDRESS

PLEASE TYPE OR USE BLACK INK ONLY

FORMATION RECORD

Give formation names and tops, if available, or descriptions and thickness of formations drilled through. Show intervals cored or drillstem tested.

NAMES OF FORMATIONS	TOP
Sand and Shale	Surf
Cromwell	3,073
Woodford	3674
Hunton	3,735
Sylvan	3,892
Viola	3,970
TD	3,987

LEASE NAME _____ WELL NO. _____

FOR COMMISSION USE ONLY	
ITD on file <input type="checkbox"/> YES <input type="checkbox"/> NO	
APPROVED _____ DISAPPROVED _____	2) Reject Codes

Were open hole logs run?	<input checked="" type="checkbox"/> yes <input type="checkbox"/> no
Date Last log was run	5/17/2017
Was CO ₂ encountered?	<input type="checkbox"/> yes <input checked="" type="checkbox"/> no at what depths? _____
Was H ₂ S encountered?	<input type="checkbox"/> yes <input checked="" type="checkbox"/> no at what depths? _____
Were unusual drilling circumstances encountered?	<input type="checkbox"/> yes <input checked="" type="checkbox"/> no
If yes, briefly explain below	

Other remarks: Fault at 3540

640 Acres

If more than three drainholes are proposed, attach a separate sheet indicating the necessary information.

Direction must be stated in degrees azimuth. Please note, the horizontal drainhole and its end point must be located within the boundaries of the lease or spacing unit.

Directional surveys are required for all drainholes and directional wells.

640 Acres

BOTTOM HOLE LOCATION FOR DIRECTIONAL HOLE

SEC	TWP	RGE	COUNTY
Spot Location	1/4	1/4	1/4
Measured Total Depth	True Vertical Depth		BHL From Lease, Unit, or Property Line:
Feet From 1/4 Sec Lines	FSL	FWL	

BOTTOM HOLE LOCATION FOR HORIZONTAL HOLE: (LATERALS)

LATERAL #1

SEC	TWP	RGE	COUNTY
Spot Location	1/4	1/4	1/4
Depth of Deviation	Radius of Turn		Direction
Measured Total Depth	True Vertical Depth		BHL From Lease, Unit, or Property Line:
Feet From 1/4 Sec Lines	FSL	FWL	
Total Length			

LATERAL #2

SEC	TWP	RGE	COUNTY
Spot Location	1/4	1/4	1/4
Depth of Deviation	Radius of Turn		Direction
Measured Total Depth	True Vertical Depth		BHL From Lease, Unit, or Property Line:
Feet From 1/4 Sec Lines	FSL	FWL	
Total Length			

LATERAL #3

SEC	TWP	RGE	COUNTY
Spot Location	1/4	1/4	1/4
Depth of Deviation	Radius of Turn		Direction
Measured Total Depth	True Vertical Depth		BHL From Lease, Unit, or Property Line:
Feet From 1/4 Sec Lines	FSL	FWL	
Total Length			