

Oklahoma Corporation Commission
Oil & Gas Conservation Division
Post Office Box 52000
Oklahoma City, Oklahoma 73152-2000
Rule 165: 10-3-25

Form 1002A

API No.: 35151232640001

Completion Report

Spud Date: October 11, 2008

OTC Prod. Unit No.: 151-125721

Drilling Finished Date: October 17, 2008

1st Prod Date: January 19, 2009

Amended

Completion Date: February 03, 2009

Amend Reason: RECLASSIFY AS TEMPORARILY ABANDONED

Drill Type: STRAIGHT HOLE

Well Name: RALEIGH 1-34

Purchaser/Measurer:

Location: WOODS 34 28N 13W
C SW SW
660 FSL 660 FWL of 1/4 SEC
Derrick Elevation: 1313 Ground Elevation: 1304

First Sales Date:

Operator: CHESAPEAKE OPERATING LLC 17441
PO BOX 18496
6100 N WESTERN AVE
OKLAHOMA CITY, OK 73154-0496

Completion Type		Location Exception		Increased Density	
X	Single Zone	Order No		Order No	
	Multiple Zone	557865		There are no Increased Density records to display.	
	Commingled				

Casing and Cement								
Type		Size	Weight	Grade	Feet	PSI	SAX	Top of CMT
SURFACE		8 5/8	24	J-55	770		360	SURFACE
PRODUCTION		5 1/2	17	J-55	5600		205	3524

Liner								
Type	Size	Weight	Grade	Length	PSI	SAX	Top Depth	Bottom Depth
There are no Liner records to display.								

Total Depth: 5600

Packer		Plug	
Depth	Brand & Type	Depth	Plug Type
There are no Packer records to display.		5530	PBTD

Initial Test Data										
Test Date	Formation	Oil BBL/Day	Oil-Gravity (API)	Gas MCF/Day	Gas-Oil Ratio Cu FT/BBL	Water BBL/Day	Pumpin or Flowing	Initial Shut-In Pressure	Choke Size	Flow Tubing Pressure
Apr 22, 2016	MISSISSIPPI			21						

Completion and Test Data by Producing Formation			
Formation Name: MISSISSIPPI		Code: 351MISS	Class: TA
Spacing Orders		Perforated Intervals	
Order No	Unit Size	From	To
557694	640	5240	5312
Acid Volumes		Fracture Treatments	
There are no Acid Volume records to display.		There are no Fracture Treatments records to display.	

Formation	Top
BASE OF HEEBNER	4020
LANSING	4345
TONKAWA	4350
KANSAS CITY	4800
OSWEGO	4970
MISSISSIPPI SOLID	5240
KINDERHOOK	5555
WOODFORD	5580
SYLVAN	5675

Were open hole logs run? Yes
Date last log run: October 16, 2008

Were unusual drilling circumstances encountered? No
Explanation:

Other Remarks
ADD PBSD FOOTAGE NOT REPORTED ON ORIGINAL 1002A

FOR COMMISSION USE ONLY	
Status: Accepted	1137879

API NO. 151-23264
OTC PROD.
UNIT NO. 151-125721

PLEASE TYPE OR USE BLACK INK ONLY
NOTE:
Attach copy of original 1002A if recompletion or reentry.

OKLAHOMA CORPORATION COMMISSION
Oil & Gas Conservation Division
Post Office Box 52000
Oklahoma City, Oklahoma 73152-2000
Rule 165:10-3-25

RECEIVED
Form 1002A
Rev. 2/2009

OCT 12 2017

OKLAHOMA CORPORATION
COMMISSION

☐ ORIGINAL
☒ AMENDED
Reason Amended *Reclassify as Temporarily Abandoned*

TYPE OF DRILLING OPERATION
☒ STRAIGHT HOLE ☐ DIRECTIONAL HOLE ☐ HORIZONTAL HOLE
☐ SERVICE WELL

If directional or horizontal, see reverse for bottom hole location.

COUNTY	WOODS	SEC	34	TWP	28N	RGE	13W
LEASE NAME	RALEIGH			WELL NO	1-34		
SHL	1/4 C 1/4 SW 1/4 SW 1/4	FSL	660	FWL OF 1/4 SEC	660		
ELEVATION	Derrick Ft 1,313 Ground 1,304			Latitude (if Known)	Longitude (if Known)		
OPERATOR NAME	CHESAPEAKE OPERATING, L.L.C.			OTC/OCC OPERATOR NO.	17441		
ADDRESS	P.O. BOX 18496						
CITY	OKLAHOMA CITY			STATE	OK	ZIP	73154

COMPLETION REPORT
SPUD DATE 10/11/2008
DRLG FINISHED DATE 10/17/2008
DATE OF WELL COMPLETION 2/3/2009
1ST PROD DATE 1/19/2009
RECOMP DATE

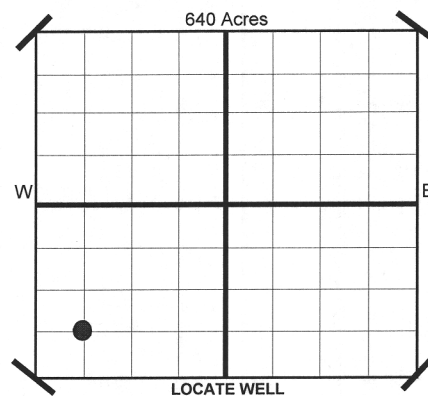

COMPLETION TYPE

<input checked="" type="checkbox"/> SINGLE ZONE	
<input type="checkbox"/> MULTIPLE ZONE	
Application Date	
COMMINGLED	
Application Date	
LOCATION EXCEPTION ORDER NO.	557865
INCREASED DENSITY ORDER NO.	N/A

CASING & CEMENT (Form 1002C must be attached)

TYPE	SIZE	WEIGHT	GRADE	FEET	PSI	SAX	TOP
CONDUCTOR							
SURFACE	8 5/8"	24#	J-55	770		360	SURFACE
INTERMEDIATE							
PRODUCTION	5 1/2"	17#	J-55	5,600		205	3,524
LINER							
							5,600

PACKER @ _____ BRAND & TYPE _____ PLUG @ _____ TYPE _____ PLUG @ 5530 TYPE *PBTD
PACKER @ _____ BRAND & TYPE _____ PLUG @ _____ TYPE _____ PLUG @ _____ TYPE _____

TOTAL DEPTH

COMPLETION & TEST DATA BY PRODUCING FORMATION

351 MISS

FORMATION	MISSISSIPPI				
SPACING & SPACING ORDER NUMBER	640 557694				
CLASS: Oil, Gas, Dry, Inj. Disp, Comm Disp, Svc	Temporarily Abandoned				
PERFORATED INTERVALS	5240-5312				
ACID/VOLUME					
FRACTURE TREATMENT (Fluids/Prop Amounts)					

Minimum Gas Allowable (165:10-17-7)

Gas Purchaser/Measurer

☐

OR

1st Sales Date

INITIAL TEST DATA

Oil Allowable (165:10-13-3)

INITIAL TEST DATE	4/22/2016				
OIL-BBL/DAY	0				
OIL-GRAVITY (API)					
GAS-MCF/DAY	21				
GAS-OIL RATIO CU FT/BBL					
WATER-BBL/DAY	0				
PUMPING OR FLOWING					
INITIAL SHUT-IN PRESSURE					
CHOKE SIZE					
FLOW TUBING PRESSURE					

AS SUBMITTED

A record of the formations drilled through, and pertinent remarks are presented on the reverse. I declare that I have knowledge of the contents of this report and am authorized by my organization to make this report, which was prepared by me or under my supervision and direction, with the data and facts stated herein to be true, correct, and complete to the best of my knowledge and belief.

	JP Powell, Regulatory Specialist	10/11/2017	405-848-8000
SIGNATURE	NAME (PRINT OR TYPE)	DATE	PHONE NUMBER
P.O. BOX 18496	OKLAHOMA CITY	OK	73154
ADDRESS	CITY	STATE	ZIP
			jp.powell@chk.com
			EMAIL ADDRESS

PLEASE TYPE OR USE BLACK INK ONLY
FORMATION RECORD

Give formation names and tops, if available, or descriptions and thickness of formations drilled through. Show intervals cored or drillstem tested.

LEASE NAME RALEIGH

WELL NO. 1-34

NAMES OF FORMATIONS	TOP
BASE OF HEEBNER	4,020
TONKAWA	4,350
LANSING	4,345
KANSAS CITY	4,800
OSWEGO	4,970
MISSISSIPPI SOLID	5,240
KINDERHOOK	5,555
WOODFORD	5,580
SYLVAN	5,675

FOR COMMISSION USE ONLY	
ITD on file <input type="checkbox"/> YES <input type="checkbox"/> NO	
APPROVED _____	DISAPPROVED _____
2) Reject Codes	

Were open hole logs run?	<u>X</u> yes <u> </u> no
Date Last log was run	<u>10/16/2008</u>
Was CO ₂ encountered?	<u> </u> yes <u>X</u> no at what depths?
Was H ₂ S encountered?	<u> </u> yes <u>X</u> no at what depths?
Were unusual drilling circumstances encountered?	<u> </u> yes <u>X</u> no
If yes, briefly explain.	

Other remarks: *ADD PBDT FOOTAGE NOT REPORTED ON ORIGINAL 1002A

640 Acres

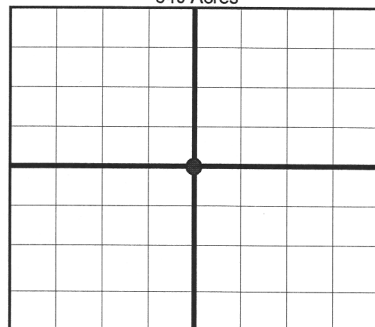

If more than three drainholes are proposed, attach a separate sheet indicating the necessary information.

Direction must be stated in degrees azimuth. Please note, the horizontal drainhole and its end point must be located within the boundaries of the lease or spacing unit.

Directional surveys are required for all drainholes and directional wells.

640 Acres

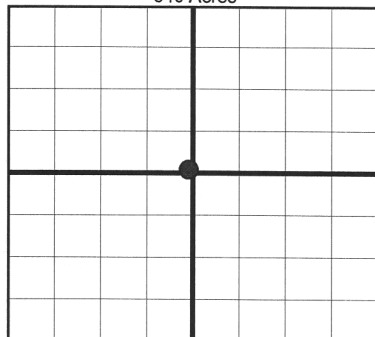

BOTTOM HOLE LOCATION FOR DIRECTIONAL HOLE

SEC	TWP	RGE	COUNTY
Spot Location	1/4	1/4	1/4
Measured Total Depth	True Vertical Depth		Feet From 1/4 Sec Lines
		FSL	FWL
BHL From Lease, Unit, or Property Line:			

BOTTOM HOLE LOCATION FOR HORIZONTAL HOLE: (LATERALS)

SEC	TWP	RGE	COUNTY
Spot Location	1/4	1/4	1/4
Depth of Deviation	Radius of Turn		Direction
Measured Total Depth	True Vertical Depth		Total Length
		FSL	FWL
BHL From Lease, Unit, or Property Line:			

LATERAL #2

SEC	TWP	RGE	COUNTY
Spot Location	1/4	1/4	1/4
Depth of Deviation	Radius of Turn		Direction
Measured Total Depth	True Vertical Depth		Total Length
		FSL	FWL
BHL From Lease, Unit, or Property Line:			

LATERAL #3

SEC	TWP	RGE	COUNTY
Spot Location	1/4	1/4	1/4
Depth of Deviation	Radius of Turn		Direction
Measured Total Depth	True Vertical Depth		Total Length
		FSL	FWL
BHL From Lease, Unit, or Property Line:			