

Oklahoma Corporation Commission
Oil & Gas Conservation Division
Post Office Box 52000
Oklahoma City, Oklahoma 73152-2000
Rule 165: 10-3-25

Form 1002A

API No.: 35141205110000

Completion Report

Spud Date: June 13, 2017

OTC Prod. Unit No.:

Drilling Finished Date: June 19, 2017

1st Prod Date: July 12, 2017

Completion Date: July 11, 2017

Drill Type: STRAIGHT HOLE

Well Name: NE TRIMUE UNIT T 2

Purchaser/Measurer:

Location: TILLMAN 4 3S 18W
NW NE SE NW
1211 FSL 2300 FWL of 1/4 SEC
Derrick Elevation: 1285 Ground Elevation: 1280

First Sales Date:

Operator: NEWKUMET EXPLORATION INC 19935
PO BOX 11330
500 W TEXAS STE 1410
MIDLAND, TX 79702-1330

Completion Type		Location Exception		Increased Density	
X	Single Zone	Order No		Order No	
	Multiple Zone	There are no Location Exception records to display.		There are no Increased Density records to display.	
	Commingled				

Casing and Cement							
Type	Size	Weight	Grade	Feet	PSI	SAX	Top of CMT
SURFACE	8 5/8			253		200	SURFACE
PRODUCTION	5 1/2			5200		225	3872

Liner								
Type	Size	Weight	Grade	Length	PSI	SAX	Top Depth	Bottom Depth
There are no Liner records to display.								

Total Depth: 5330

Packer		Plug	
Depth	Brand & Type	Depth	Plug Type
4996	MODEL R	There are no Plug records to display.	

Initial Test Data										
Test Date	Formation	Oil BBL/Day	Oil-Gravity (API)	Gas MCF/Day	Gas-Oil Ratio Cu FT/BBL	Water BBL/Day	Pumpin or Flowing	Initial Shut-In Pressure	Choke Size	Flow Tubing Pressure
Jul 12, 2017	STRAWN C	1	42			30	PUMPING			

Completion and Test Data by Producing Formation			
Formation Name: STRAWN C		Code: 404STRNC	Class: OIL
Spacing Orders		Perforated Intervals	
Order No	Unit Size	From	To
586347	UNIT	5054	5074
Acid Volumes		Fracture Treatments	
2,000 GALLONS 15% HCL		NO FRAC	

Formation	Top
STRAWN "A"	4768
STRAWN "B"	4877
STRAWN "C"	5049

Were open hole logs run? Yes
Date last log run: June 20, 2017

Were unusual drilling circumstances encountered? No
Explanation:

Other Remarks
There are no Other Remarks.

FOR COMMISSION USE ONLY	
Status: Accepted	1137848

RECEIVED

OCT 12 2017

Form 1002A
Rev. 2009

API NO. 5141205110000

PLEASE TYPE OR USE BLACK INK ONLY

NOTE:

OKLAHOMA CORPORATION COMMISSION

Oil & Gas Conservation Division

Post Office Box 52000

Oklahoma City, Oklahoma 73152-2000

Rule 165:10-3-25

OKLAHOMA CORPORATION
COMMISSION

OTC PROD.
UNIT NO.

Attach copy of original 1002A
if recompletion or reentry.

☒ ORIGINAL
☐ AMENDED (Reason)

COMPLETION REPORT

TYPE OF DRILLING OPERATION

☒ STRAIGHT HOLE ☐ DIRECTIONAL HOLE ☐ HORIZONTAL HOLE
☐ SERVICE WELL

If directional or horizontal, see reverse for bottom hole location.

COUNTY TILLMAN SEC 4 TWP 3S RGE 18W

LEASE NAME NE Trimue Unit

MW 1/4 NE 1/4 SE 1/4 NW 1/4

ELEVATION 1285 Ground 1280

OPERATOR NAME Newkomet Exploration, Inc.

ADDRESS P.O. Box 11330

CITY MIDLAND

STATE TX

ZIP 79702

SPUD DATE 6-13-17

DRLG FINISHED DATE 6-19-17

DATE OF WELL COMPLETION 7-11-17

1st PROD DATE 7-12-17

RECOMP DATE -

Longitude (if known) -

OTC/OCC OPERATOR NO. 19935

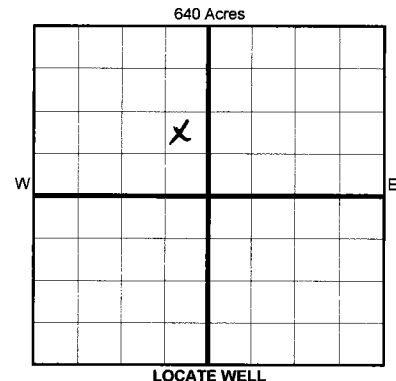

COMPLETION TYPE

☒ SINGLE ZONE
☐ MULTIPLE ZONE
Application Date
COMINGLED
Application Date
LOCATION
EXCEPTION ORDER
INCREASED DENSITY
ORDER NO.

CASING & CEMENT (Form 1002C must be attached)

TYPE	SIZE	WEIGHT	GRADE	FEET	PSI	SAX	TOP OF CMT
CONDUCTOR							
SURFACE	8 5/8			253		200	SURFACE
INTERMEDIATE							
PRODUCTION	5 1/2			5200		225	3872
LINER							

PACKER @ 4996 BRAND & TYPE Model R

PLUG @ _____ TYPE _____ PLUG @ _____ TYPE _____

TOTAL DEPTH 5330

COMPLETION & TEST DATA BY PRODUCING FORMATION

FORMATION	<u>STRAWN C</u>						<u>No Frac</u>
SPACING & SPACING ORDER NUMBER	<u>586347 (UNIT)</u>						
CLASS: Oil, Gas, Dry, Inj, Disp, Comm Disp, Svc	<u>Oil</u>						
PERFORATED INTERVALS	<u>5054-66</u>	<u>5071-74</u>					
ACID/VOLUME	<u>2000 gal</u>	<u>15% HCL</u>					
FRACTURE TREATMENT (Fluids/Prop Amounts)	<u>NO FRAC</u>						

Min Gas Allowable (165:10-17-7)

Gas Purchaser/Measurer

☐ OR

First Sales Date

INITIAL TEST DATA

INITIAL TEST DATE	<u>7-12-17</u>						
OIL-BBL/DAY	<u>1</u>						
OIL-GRAVITY (API)	<u>42°</u>						
GAS-MCF/DAY	<u>TSTM</u>						
GAS-OIL RATIO CU FT/BBL							
WATER-BBL/DAY	<u>30 bbls</u>						
PUMPING OR FLOWING	<u>Pumping</u>						
INITIAL SHUT-IN PRESSURE	<u>-</u>						
CHOKE SIZE	<u>-</u>						
FLOW TUBING PRESSURE	<u>-</u>						

AS SUBMITTED

A record of the formations drilled through, and pertinent remarks are presented on the reverse. I declare that I have knowledge of the contents of this report and am authorized by my organization to make this report, which was prepared by me or under my supervision and direction, with the data and facts stated herein to be true, correct, and complete to the best of my knowledge and belief.

SIGNATURE Wayne Newkomet NAME (PRINT OR TYPE) Wayne Newkomet DATE (432) 687-1101
ADDRESS P.O. Box 11330 CITY MIDLAND STATE TX ZIP 79702 EMAIL ADDRESS janiejo.nej@gmail.com

Give formation names and tops, if available, or descriptions and thickness of formations drilled through. Show intervals cored or drillstem tested.

NAMES OF FORMATIONS	TOP
STRAWN "A"	4,768
STRAWN "B"	4,877
STRAWN "C"	5,049

FOR COMMISSION USE ONLY	
ITD on file	<input type="checkbox"/> YES <input type="checkbox"/> NO
APPROVED	DISAPPROVED
	2) Reject Codes <hr/> <hr/> <hr/> <hr/> <hr/>

Were open hole logs run? X yes ___ no

Date Last log was run 6-20-17

Was CO₂ encountered? ___ yes X no at what depths? _____

Was H₂S encountered? ___ yes X no at what depths? _____

Were unusual drilling circumstances encountered? ___ yes X no

If yes, briefly explain below

Other remarks:

640 Acres

A blank 10x10 grid of squares, intended for drawing a picture.

If more than three drainholes are proposed, attach a separate sheet indicating the necessary information.

Direction must be stated in degrees azimuth.
Please note, the horizontal drainhole and its end point must be located within the boundaries of the lease or spacing unit.

Directional surveys are required for all drainholes and directional wells.

640 Acres

A blank 10x10 grid for graphing. The grid is composed of 10 columns and 10 rows of squares. The top-left square is shaded gray. The grid is used for plotting the graph of the function $y = \frac{1}{2}x^2$ for x from -10 to 10.

BOTTOM HOLE LOCATION FOR DIRECTIONAL HOLE

SEC	TWP	RGE	COUNTY
Spot Location			
1/4	1/4	1/4	1/4
Measured Total Depth	True Vertical Depth	Feet From 1/4 Sec Lines	
		FSL	FWL
BHL From Lease, Unit, or Property Line:			

BOTTOM HOLE LOCATION FOR HORIZONTAL HOLE: (LATERALS)

LATERAL #1

SEC	TWP	RGE	COUNTY			
Spot Location				Feet From 1/4 Sec Lines	FSL	FWL
1/4	1/4	1/4	1/4			
Depth of Deviation	Radius of Turn		Direction	Total Length		
Measured Total Depth		True Vertical Depth	BHL From Lease, Unit, or Property Line:			

LATERAL #2

SEC	TWP	RGE	COUNTY			
Spot Location						
1/4	1/4	1/4	1/4	Feet From 1/4 Sec Lines	FSL	FWL
Depth of Deviation		Radius of Turn		Direction	Total Length	
Measured Total Depth		True Vertical Depth		BHL From Lease, Unit, or Property Line:		

LATERAL #3

SEC	TWP	RGE	COUNTY			
Spot Location				Feet From 1/4 Sec Lines	FSL	FWL
1/4	1/4	1/4	1/4			
Depth of Deviation	Radius of Turn		Direction	Total Length		
Measured Total Depth		True Vertical Depth	BHL From Lease, Unit, or Property Line:			