

Oklahoma Corporation Commission  
Oil & Gas Conservation Division  
Post Office Box 52000  
Oklahoma City, Oklahoma 73152-2000  
Rule 165: 10-3-25

Form 1002A

API No.: 35107235880000

**Completion Report**

Spud Date: February 28, 2017

OTC Prod. Unit No.:

Drilling Finished Date: March 02, 2017

1st Prod Date:

Completion Date: April 25, 2017

**Drill Type: STRAIGHT HOLE**

Well Name: WILLIAMSON 5-25

Purchaser/Measurer:

Location: OKFUSKEE 25 10N 11E  
NE NW SE SW  
1020 FSL 1680 FWL of 1/4 SEC  
Derrick Elevation: 861 Ground Elevation: 861

First Sales Date:

Operator: INLAND OPERATING COMPANY 23009  
PO BOX 701588  
2702 E 72 ST  
TULSA, OK 74170-1588

Completion Type		Location Exception		Increased Density	
X	Single Zone	Order No		Order No	
	Multiple Zone	There are no Location Exception records to display.		There are no Increased Density records to display.	
	Commingled				

Casing and Cement							
Type	Size	Weight	Grade	Feet	PSI	SAX	Top of CMT
SURFACE	8.625	23	LS	225	500	100	SURFACE
PRODUCTION	5.5	15.5	J-55	2162	500	60	1720

Liner								
Type	Size	Weight	Grade	Length	PSI	SAX	Top Depth	Bottom Depth
There are no Liner records to display.								

**Total Depth: 2181**

Packer		Plug	
Depth	Brand & Type	Depth	Plug Type
There are no Packer records to display.		There are no Plug records to display.	

Initial Test Data										
Test Date	Formation	Oil BBL/Day	Oil-Gravity (API)	Gas MCF/Day	Gas-Oil Ratio Cu FT/BBL	Water BBL/Day	Pumpin or Flowing	Initial Shut-In Pressure	Choke Size	Flow Tubing Pressure
Sep 15, 2017	BOOCH					40	PUMPING			

Completion and Test Data by Producing Formation			
Formation Name: BOOCH		Code: 404BOCH	Class: DRY
<b>Spacing Orders</b>		<b>Perforated Intervals</b>	
<b>Order No</b>	<b>Unit Size</b>	<b>From</b>	<b>To</b>
657095	20	There are no Perf. Intervals records to display.	
<b>Acid Volumes</b>		<b>Fracture Treatments</b>	
NO ACID		NO FRAC	

Formation	Top
CALVIN SST	1198
BARTLESVILLE SST	1632
BOOCH SST	2164

Were open hole logs run? No  
Date last log run:  
  
Were unusual drilling circumstances encountered? No  
Explanation:

Other Remarks
OCC - THIS WELL IS AN OPEN HOLE COMPLETION FROM BOTTOM OF 5 1/2" CASING AT 2,162' TO TOTAL DEPTH AT 2,181'.

FOR COMMISSION USE ONLY	
Status: Accepted	1137849

API NO. 107-23588  
OTC PROD.  
UNIT NO.

PLEASE TYPE OR USE BLACK INK ONLY

NOTE:

Attach copy of original 1002A  
if recompletion or reentry.

OKLAHOMA CORPORATION COMMISSION  
Oil & Gas Conservation Division  
Post Office Box 52000  
Oklahoma City, Oklahoma 73152-2000  
Rule 165:10-3-25

RECEIVED

OCT 12 2017

OKLAHOMA CORPORATION  
COMMISSION

Form 1002A  
Rev. 2009

☒ ORIGINAL  
☐ AMENDED (Reason)

COMPLETION REPORT

TYPE OF DRILLING OPERATION

☒ STRAIGHT HOLE ☐ DIRECTIONAL HOLE ☐ HORIZONTAL HOLE  
☐ SERVICE WELL

If directional or horizontal, see reverse for bottom hole location.

COUNTY	Okfuskee	SEC	25	TWP	10N	RGE	11E
LEASE NAME	Williamson			WELL NO.	5-25		
NE 1/4 NW 1/4 SE 1/4 SW 1/4	FSL OF 1/4 SEC 1020'			FWL OF 1/4 SEC 1680'			
ELEVATION N Derrick	861'	Ground	861'	Latitude (if known)			
OPERATOR NAME	Inland Operating Company			OTC/OCC OPERATOR NO.	23009		
ADDRESS	P.O. Box 701588						
CITY	Tulsa	STATE	OK	ZIP	74170		

SPUD DATE 2/28/2017  
DRLG FINISHED DATE 03/02/2017  
DATE OF WELL COMPLETION 04/25/2017  
1st PROD DATE  
RECOMP DATE  
Longitude (if known)

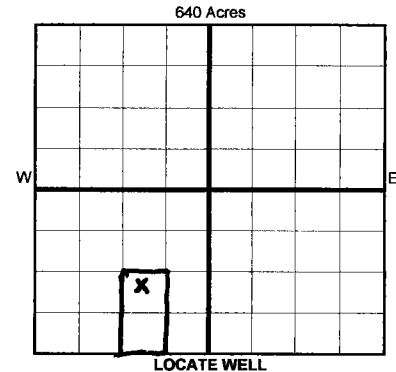

COMPLETION TYPE

☒ SINGLE ZONE  
☐ MULTIPLE ZONE  
Application Date  
COMINGLED  
Application Date  
LOCATION  
EXCEPTION ORDER  
INCREASED DENSITY  
ORDER NO.

CASING & CEMENT (Form 1002C must be attached)

TYPE	SIZE	WEIGHT	GRADE	FEET	PSI	SAX	TOP OF CMT
CONDUCTOR							
SURFACE	8.625"	23#	LS	225'	500	100	Surface
INTERMEDIATE							
PRODUCTION	5.5"	15.5#	J-55	2,162'	500	60	1,720'
LINER							

PACKER @ \_\_\_\_\_ BRAND & TYPE \_\_\_\_\_ PLUG @ \_\_\_\_\_ TYPE \_\_\_\_\_ PLUG @ \_\_\_\_\_ TYPE \_\_\_\_\_  
PACKER @ \_\_\_\_\_ BRAND & TYPE \_\_\_\_\_ PLUG @ \_\_\_\_\_ TYPE \_\_\_\_\_ PLUG @ \_\_\_\_\_ TYPE \_\_\_\_\_

TOTAL DEPTH

2,162' 2 1/8"  
see perforated interval

COMPLETION & TEST DATA BY PRODUCING FORMATION

404 BOCH

FORMATION	Booch
SPACING & SPACING ORDER NUMBER	657095 (20)
CLASS: Oil, Gas, Dry, Inj, Disp, Comm Disp, Svc	Dry
PERFORATED INTERVALS	2164-2181' Open Hole
ACID/VOLUME	No Acid
FRACTURE TREATMENT (Fluids/Prop Amounts)	No Frac

Min Gas Allowable

(165:10-17-7)

Gas Purchaser/Measurer

First Sales Date

INITIAL TEST DATA

Oil Allowable

(165:10-13-3)

INITIAL TEST DATE	9/15/2017
OIL-BBL/DAY	0
OIL-GRAVITY ( API)	
GAS-MCF/DAY	0
GAS-OIL RATIO CU FT/BBL	
WATER-BBL/DAY	40
PUMPING OR FLOWING	Pumping
INITIAL SHUT-IN PRESSURE	
CHOKE SIZE	
FLOW TUBING PRESSURE	

AS SUBMITTED

A record of the formations drilled through, and pertinent remarks are presented on the reverse. I declare that I have knowledge of the contents of this report and am authorized by my organization to make this report, which was prepared by me or under my supervision and direction, with the data and facts stated herein to be true, correct, and complete to the best of my knowledge and belief.

Jeff Leenerts

10/10/2017

918-779-7585

SIGNATURE

NAME (PRINT OR TYPE)

DATE

PHONE NUMBER

P.O. Box 701588

Tulsa

OK

74170

jeff@inlandoilgas.com

ADDRESS

CITY

STATE

ZIP

EMAIL ADDRESS

PLEASE TYPE OR USE BLACK INK ONLY

FORMATION RECORD

Give formation names and tops, if available, or descriptions and thickness of formations drilled through. Show intervals cored or drillstem tested.

LEASE NAME Williamson WELL NO. 5-25

NAMES OF FORMATIONS	TOP
Calvin Sst.	1,198
Bartlesville Sst.	1,632
Booch Sst.	2,164
TD	2,181

FOR COMMISSION USE ONLY

ITD on file ☐ YES ☐ NO

APPROVED \_\_\_\_\_ DISAPPROVED \_\_\_\_\_

2) Reject Codes

\_\_\_\_\_

\_\_\_\_\_

\_\_\_\_\_

\_\_\_\_\_

Were open hole logs run? \_\_\_\_ yes X no

Date Last log was run \_\_\_\_\_

Was CO<sub>2</sub> encountered? \_\_\_\_ yes X no at what depths? \_\_\_\_\_

Was H<sub>2</sub>S encountered? \_\_\_\_ yes X no at what depths? \_\_\_\_\_

Were unusual drilling circumstances encountered? \_\_\_\_ yes X no

If yes, briefly explain below \_\_\_\_\_

Other remarks: OC C- This well is an open hole completion from bottom of 5 1/2" casing at 2162' to total depth at 2181'

640 Acres

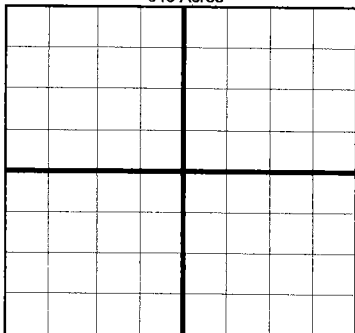

If more than three drainholes are proposed, attach a separate sheet indicating the necessary information.

Direction must be stated in degrees azimuth. Please note, the horizontal drainhole and its end point must be located within the boundaries of the lease or spacing unit.

Directional surveys are required for all drainholes and directional wells.

640 Acres

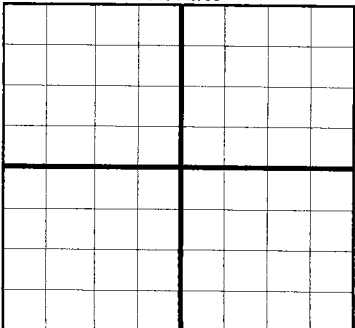

BOTTOM HOLE LOCATION FOR DIRECTIONAL HOLE

SEC	TWP	RGE	COUNTY
Spot Location			
1/4	1/4	1/4	1/4
Measured Total Depth		True Vertical Depth	BHL From Lease, Unit, or Property Line:

BOTTOM HOLE LOCATION FOR HORIZONTAL HOLE: (LATERALS)

LATERAL #1

SEC	TWP	RGE	COUNTY
Spot Location			
1/4	1/4	1/4	1/4
Depth of Deviation	Radius of Turn	Direction	Total Length
Measured Total Depth	True Vertical Depth	BHL From Lease, Unit, or Property Line:	

LATERAL #2

SEC	TWP	RGE	COUNTY
Spot Location			
1/4	1/4	1/4	1/4
Depth of Deviation	Radius of Turn	Direction	Total Length
Measured Total Depth	True Vertical Depth	BHL From Lease, Unit, or Property Line:	

LATERAL #3

SEC	TWP	RGE	COUNTY
Spot Location			
1/4	1/4	1/4	1/4
Depth of Deviation	Radius of Turn	Direction	Total Length
Measured Total Depth	True Vertical Depth	BHL From Lease, Unit, or Property Line:	