

Oklahoma Corporation Commission
Oil & Gas Conservation Division
Post Office Box 52000
Oklahoma City, Oklahoma 73152-2000
Rule 165: 10-3-25

Form 1002A

API No.: 35125237640003

Completion Report

Spud Date: April 25, 2012

OTC Prod. Unit No.: 125-209910

Drilling Finished Date: May 03, 2012

Amended

1st Prod Date:

Amend Reason: TEMPORARILY ABANDONED; 1003A

Completion Date: February 26, 2013

Recomplete Date: October 04, 2016

Drill Type: STRAIGHT HOLE

Well Name: NORRIS 1-15

Purchaser/Measurer: SUNOCO

Location: POTTAWATOMIE 15 6N 3E
NE SW NE SE
1755 FSL 750 FEL of 1/4 SEC
Derrick Elevation: 0 Ground Elevation: 0

First Sales Date: 02/27/2013

Operator: EAGLE ROAD OIL LLC 23778

321 S BOSTON AVE STE 301
TULSA, OK 74103-3302

Completion Type	
X	Single Zone
	Multiple Zone
	Commingle

Location Exception	
Order No	
There are no Location Exception records to display.	

Increased Density	
Order No	
There are no Increased Density records to display.	

Casing and Cement							
Type	Size	Weight	Grade	Feet	PSI	SAX	Top of CMT
CONDUCTOR	16			47		7	SURFACE
SURFACE	8.625	24	J-55	586		375	SURFACE
PRODUCTION	5.5	17	N-80	4410		300	2450

Liner								
Type	Size	Weight	Grade	Length	PSI	SAX	Top Depth	Bottom Depth
There are no Liner records to display.								

Total Depth: 4410

Packer	
Depth	Brand & Type
There are no Packer records to display.	

Plug	
Depth	Plug Type
4136	CIBP

Initial Test Data

Test Date	Formation	Oil BBL/Day	Oil-Gravity (API)	Gas MCF/Day	Gas-Oil Ratio Cu FT/BBL	Water BBL/Day	Pumpin or Flowing	Initial Shut- In Pressure	Choke Size	Flow Tubing Pressure
-----------	-----------	----------------	----------------------	----------------	----------------------------	------------------	----------------------	---------------------------------	---------------	-------------------------

There are no Initial Data records to display.

Completion and Test Data by Producing Formation

Formation Name: VIOLA

Code: 202VIOL

Class: DRY

Spacing Orders		Perforated Intervals	
Order No	Unit Size	From	To
584062	80	4152	4215

Acid Volumes	Fracture Treatments
There are no Acid Volume records to display.	There are no Fracture Treatments records to display.

Formation Name: WOODFORD

Code: 319WDFD

Class: TA

Spacing Orders		Perforated Intervals	
Order No	Unit Size	From	To
584062	640	4004	4038

Acid Volumes	Fracture Treatments
There are no Acid Volume records to display.	6,401 BARRELS, 349,980 POUNDS SAND

Formation	Top
SEE ORIGINAL 1002A	0

Were open hole logs run? No

Date last log run:

Were unusual drilling circumstances encountered? No

Explanation:

Other Remarks

ACQUIRED WELL AS TEMPORARILY ABANDONED. SUBMITTING 1002A TO ACCOMPANY 1003A. OCC - RESTORING 1002A AFTER NETWORK GOING DOWN NO CHANGE FROM ORIGINAL APPROVAL 10/20/2017

FOR COMMISSION USE ONLY

Status: Accepted

1137828

R
125-2376403

RECEIVED

Form 1002A
Rev. 2009

SEP 25 2017

OKLAHOMA CORPORATION COMMISSION

API NO. 125-37640
OTC PROD. UNIT NO. 125-209910

PLEASE TYPE OR USE BLACK INK ONLY
NOTE:

Attach copy of original 1002A
if recompletion or reentry.

OKLAHOMA CORPORATION COMMISSION
Oil & Gas Conservation Division
Post Office Box 52000
Oklahoma City, Oklahoma 73152-2000
Rule 165:10-3-25

☐ ORIGINAL
☒ AMENDED (Reason)

temporarily abandoned; 1003A

COMPLETION REPORT

TYPE OF DRILLING OPERATION

☒ STRAIGHT HOLE ☐ DIRECTIONAL HOLE ☐ HORIZONTAL HOLE
☐ SERVICE WELL

If directional or horizontal, see reverse for bottom hole location.

COUNTY POTTAWATOMIE SEC 15 TWP 06N RGE 03E
LEASE NAME NORRIS
NE 1/4 SW 1/4 NE 1/4 SE 1/4 FSL OF 1/4 SEC 1755
ELEVATION Ground
OPERATOR Eagle Road Oil LLC
ADDRESS 321 S Boston Ave, Ste 300
CITY TULSA STATE OK ZIP 74103

SPUD DATE 4/25/12
DRLG FINISHED DATE 5/03/12
DATE OF WELL COMPLETION 2/26/13
1st PROD DATE
RECOMP DATE 10-4-2016
Longitude (if known)
OTC/OCC OPERATOR NO. 23778

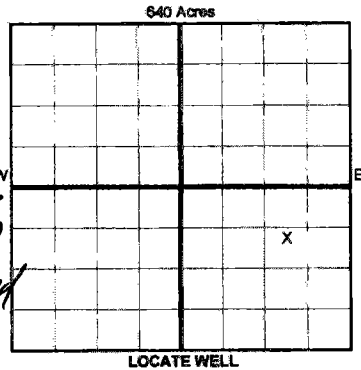

COMPLETION TYPE

☒ SINGLE ZONE
☐ MULTIPLE ZONE
☐ COMMINGLED
LOCATION
EXCEPTION ORDER
INCREASED DENSITY
ORDER NO.

CASING & CEMENT (Form 1002C must be attached)

TYPE	SIZE	WEIGHT	GRADE	FEET	PSI	SAX	TOP OF CMT
CONDUCTOR	16			47		7	surface
SURFACE	8.625	24	J55	586		375	surface
INTERMEDIATE							
PRODUCTION	5.5	17	N80	4410		300	2450
LINER							
						TOTAL DEPTH	4,410

PACKER @ BRAND & TYPE PLUG @ CIBP TYPE 4136 PLUG @ TYPE
PACKER @ BRAND & TYPE PLUG @ TYPE PLUG @ TYPE

COMPLETION & TEST DATA BY PRODUCING FORMATION

FORMATION	VIOLA	Woodford
SPACING & SPACING ORDER NUMBER	80 (584062)	584062 (640)
CLASS: Oil, Gas, Dry, Inj, Disp, Comm Disp, Svc	Dry	TA
PERFORATED INTERVALS	4152-4215	4004-4038
ACID/VOLUME		
FRACTURE TREATMENT (Fluids/Prop Amounts)	6401 BBLS 349,980 # SAND	6401 BBLS 349,980 lbs Sand

☐ Min Gas Allowable (165:10-17-7)
OR
☐ Oil Allowable (165:10-13-3)
Gas Purchaser/Measurer SUNOCO
First Sales Date 2/27/2013

INITIAL TEST DATA

INITIAL TEST DATE	
OIL-BBL/DAY	
OIL-GRAVITY (API)	
GAS-MCF/DAY	
GAS-OIL RATIO CU FT/BBL	
WATER-BBL/DAY	
PUMPING OR FLOWING	
INITIAL SHUT-IN PRESSURE	
CHOKE SIZE	
FLOW TUBING PRESSURE	

AS SUBMITTED

A record of the formations drilled through, and pertinent remarks are presented on the reverse. I declare that I have knowledge of the contents of this report and am authorized by my organization to make this report, which was prepared by me or under my supervision and direction, with the data and facts stated herein to be true, correct, and complete to the best of my knowledge and belief.

SIGNATURE 321 S BOSTON AVE, STE 301 TULSA OK 74103 ADDRESS
BRIAN WILLIAMSON NAME (PRINT OR TYPE) 9/10/2016 DATE 918-986-7612 PHONE NUMBER
R.LITTLE@JERICHOOIL.COM EMAIL ADDRESS

Give formation names and tops, if available, or descriptions and thickness of formations drilled through. Show intervals cored or drillstem tested.

WELL NO. _____

NAMES OF FORMATIONS	TOP
<i>see original 1002A</i>	

FOR COMMISSION USE ONLY	
ITD on file <input type="checkbox"/> YES <input type="checkbox"/> NO	
APPROVED	DISAPPROVED
2) Reject Codes _____ _____ _____ _____ _____	

Were open hole logs run? ☐ yes ☐ no

Date Last log was run _____

Was CO₂ encountered? ☐ yes ☐ no at what depths? _____

Was H₂S encountered? ☐ yes ☐ no at what depths? _____

Were unusual drilling circumstances encountered? ☐ yes ☐ no

If yes, briefly explain below _____

Other remarks: ACQUIRED WELL AS TEMPORARILY ABONDONED. SUBMITTING 1002A TO ACCOMPANY 1003A

840 Acres

If more than three drainholes are proposed, attach a separate sheet indicating the necessary information.

Direction must be stated in degrees azimuth.
Please note, the horizontal drainhole and its end
point must be located within the boundaries of the
lease or spacing unit.

Directional surveys are required for all drainholes and directional wells.

640 Acres

SEC	TWP	RGE	COUNTY
Spot Location			
1/4	1/4	1/4	1/4
Measured Total Depth	True Vertical Depth	Feet From 1/4 Sec Lines FSL FWL	
BHL From Lease, Unit, or Property Line:			

LATERAL #1						
SEC	TWP	RGE	COUNTY			
Spot Location						
1/4	1/4	1/4	Feet From 1/4 Sec Lines		FSL	FWL
Depth of Deviation		Radius of Turn		Direction		Total Length
Measured Total Depth		True Vertical Depth		BHL From Lease, Unit, or Property Line:		

SEC	TWP	RGE	COUNTY
Spot Location			
1/4	1/4	1/4	1/4
Depth of	Radius of Turn	Direction	FSL
Deviation			Total Length
Measured Total Depth	True Vertical Depth	BHL From Lease, Unit, or Property Line:	

SEC	TWP	RGE	COUNTY
Spot Location			
1/4	1/4	1/4	1/4
Feet From 1/4 Sec Lines	FSL	FWL	
Depth of Deviation	Radius of Turn	Direction	Total Length
Measured Total Depth	True Vertical Depth	BHL From Lease, Unit, or Property Line:	