

API NUMBER: 003 23295

OKLAHOMA CORPORATION COMMISSION
OIL & GAS CONSERVATION DIVISION
P.O. BOX 52000
OKLAHOMA CITY, OK 73152-2000
(Rule 165:10-3-1)

Approval Date: 11/02/2017
Expiration Date: 05/02/2018

Horizontal Hole Oil & Gas

PERMIT TO DRILL

WELL LOCATION: Sec: 05 Twp: 24N Rge: 12W County: ALFALFA
SPOT LOCATION: ☐ NE ☐ NW ☐ NW ☐ NE FEET FROM QUARTER: FROM NORTH FROM EAST
SECTION LINES: 275 2250

Lease Name: MOSER 2412

Well No: 1H-05 C

Well will be 275 feet from nearest unit or lease boundary.

Operator Name: MIDSTATES PETROLEUM CO LLC

Telephone: 9189478550

OTC/OCC Number: 23079 0

MIDSTATES PETROLEUM CO LLC
321 S BOSTON AVE STE 1000
TULSA, OK 74103-3322

EARLENE MOSER
P.O. BOX 264
CARMEN OK 73726

Formation(s) (Permit Valid for Listed Formations Only):

Name	Depth	Name	Depth
1 MISSISSIPPIAN	6310	6	
2		7	
3		8	
4		9	
5		10	

Spacing Orders: No Spacing

Location Exception Orders:

Increased Density Orders:

Pending CD Numbers: 201705950
201705951

Special Orders:

Total Depth: 11200

Ground Elevation: 1338

Surface Casing: 480

Depth to base of Treatable Water-Bearing FM: 430

Under Federal Jurisdiction: No

Fresh Water Supply Well Drilled: No

Surface Water used to Drill: Yes

PIT 1 INFORMATION

Approved Method for disposal of Drilling Fluids:

Type of Pit System: CLOSED Closed System Means Steel Pits

Type of Mud System: WATER BASED

Chlorides Max: 25000 Average: 5000

E. Haul to Commercial pit facility: Sec. 10 Twn. 26N Rng. 15W Cnty. 151 Order No: 563714

Is depth to top of ground water greater than 10ft below base of pit? Y

H. CLOSED SYSTEM=STEEL PITS PER OPERATOR REQUEST

Within 1 mile of municipal water well? N

Wellhead Protection Area? N

Pit is not located in a Hydrologically Sensitive Area.

Category of Pit: C

Liner not required for Category: C

Pit Location is NON HSA

Pit Location Formation: FLOWERPOT

This permit does not address the right of entry or settlement of surface damages.

The duration of this permit is SIX MONTHS, except as otherwise provided by Rule 165: 10-3-1.

Rule 165: 10-3-4 (c) (7) (e) - The Operator shall give 24 Hours notice by telephone to the appropriate District Office of the Conservation Division as to when Surface Casing will be run.

HORIZONTAL HOLE 1

Sec 05 Twp 24N Rge 12W County ALFALFA

Spot Location of End Point: S2 S2 SW SE

Feet From: SOUTH 1/4 Section Line: 165

Feet From: EAST 1/4 Section Line: 1980

Depth of Deviation: 5276

Radius of Turn: 477

Direction: 175

Total Length: 5175

Measured Total Depth: 11200

True Vertical Depth: 6310

End Point Location from Lease,
Unit, or Property Line: 165

Notes:

Category

Description

HYDRAULIC FRACTURING

10/17/2017 - G57 - OCC 165:10-3-10 REQUIRES:

1) PRIOR TO COMMENCEMENT OF HYDRAULIC FRACTURING OPERATIONS FOR HORIZONTAL WELLS, NOTICE GIVEN FIVE BUSINESS DAYS IN ADVANCE TO OFFSET OPERATORS WITH WELLS COMPLETED IN THE SAME COMMON SOURCE OF SUPPLY WITHIN 1/2 MILE;

2) WITH NOTICE ALSO GIVEN 48 HOURS IN ADVANCE OF HYDRAULIC FRACTURING ALL WELLS TO BOTH THE OCC CENTRAL OFFICE AND LOCAL DISTRICT OFFICES, USING THE "FRAC NOTICE FORM" FOUND AT THE FOLLOWING LINK: OCCEWEB.COM/OG/OGFORMS.HTML; AND,

3) THE CHEMICAL DISCLOSURE OF HYDRAULIC FRACTURING INGREDIENTS FOR ALL WELLS TO BE REPORTED TO FRACFOCUS WITHIN 60 DAYS AFTER THE CONCLUSION THE HYDRAULIC FRACTURING OPERATIONS, USING THE FOLLOWING LINK: FRACFOCUS.ORG

PENDING CD - 201705950

11/1/2017 - G75 - (640)(HOR) 5-24N-12W
VAC 114464 MNNG, MSSLM
EXT 590928 MSSP
POE TO BHL NCT 660' FB
REC 10-3-2017 (MCKEOWN)

PENDING CD - 201705951

11/1/2017 - G75 - (I.O.) 5-24N-12W
X201705950 MSSP
COMPL. INT. NCT 165' TO NL, NCT 165' TO SL, NCT 600' TO EL
NO OP. NAMED
REC 10-3-2017 (MCKEOWN)

This permit does not address the right of entry or settlement of surface damages.

The duration of this permit is SIX MONTHS, except as otherwise provided by Rule 165: 10-3-1.

Rule 165: 10-3-4 (c) (7) (e) - The Operator shall give 24 Hours notice by telephone to the appropriate District Office of the Conservation Division as to when Surface Casing will be run.

003 23295 MOSER 2412 1H-05 C

TOPOGRAPHIC LAND SURVEYORS OF OKLAHOMA

6709 NORTH CLASSEN BLVD., OKLA. CITY, OKLA. 73116 * LOCAL (405) 843-4847 * OUT OF STATE (800) 654-3219

Certificate of Authorization No. 1293 LS

ALFALFA

County, Oklahoma

API 003-23295

275'FNL-2250'FEL

5

Township

24N

Range

12W I.M.

X= 1848516
Y= 580698

X= 1849344
Y= 580692

Township Line
T25N-R12W

X= 1851175
Y= 580674

X= 1851983
Y= 580666

X= 1853833
Y= 580655

6th Standard Parallel North

T24N-R12W

LOT 4

LOT 3

LOT 2

LOT 1

S/2-NW/4

S/2-NE/4

5

X= 1848509
Y= 577809

X= 1853822
Y= 577789

BOTTOM HOLE
165'FSL-1980'FEL
NAD-27 (US Feet)
36°34'46.0"N
98°30'16.6"W
36.579443536°N
98.504613448°W
X= 1851831
Y= 575328

X= 1848502
Y= 575177

X= 1851156
Y= 575165

X= 1853810
Y= 575154

LANDING POINT, BOTTOM HOLE, AND DRILL PATH INFORMATION
PROVIDED BY OPERATOR LISTED, NOT SURVEYED.

Operator: MIDSTATES PETROLEUM COMPANY, LLC

Lease Name: MOSER 2412

Well No.: 1H-05C

ELEVATION:

1338' Gr. at Stake

Topography & Vegetation Loc. fell in plowed field, ±218' S of flagged E-W gas pipeline.

Good Drill Site? Yes

Reference Stakes or Alternate Location
Stakes Set None.

Best Accessibility to Location From North off county road.

Distance & Direction

from Hwy Jct or Town From Carmen, OK, go West ±2 miles, then North ±1 mile to the

NE Cor. of Sec. 5-T24N-R12W.

Date of Drawing: Sept. 19, 2017

Invoice # 281076

Date Staked: Sept. 18, 2017

TR

DATUM: NAD-27

LAT: 36°35'36.1"N

LONG: 98°30'20.0"W

LAT: 36.593359781°N

LONG: 98.505550995°W

STATE PLANE

COORDINATES: (US Feet)

ZONE: OK NORTH

X: 1851582

Y: 580395

CERTIFICATE:

I, Thomas L. Howell, an Oklahoma Licensed Land Surveyor and an authorized agent of Topographic Land Surveyors of Oklahoma, do hereby certify to the information shown herein

Thomas L. Howell
Oklahoma Lic. No. 1433

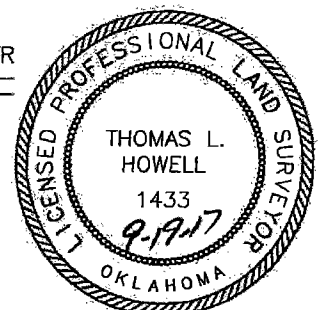

This information was gathered with a GPS receiver with ±1 foot Horiz./Vert. accuracy.