

OKLAHOMA CORPORATION COMMISSION
OIL & GAS CONSERVATION DIVISION
P.O. BOX 52000
OKLAHOMA CITY, OK 73152-2000
(Rule 165:10-3-1)

API NUMBER: 051 24431

Approval Date: 08/07/2018

Expiration Date: 02/07/2019

Horizontal Hole Oil & Gas

PERMIT TO DRILL

WELL LOCATION: Sec: 16 Twp: 9N Rge: 6W

County: GRADY

SPOT LOCATION: ☐ NE ☐ NW ☐ NE ☐ NE

FEET FROM QUARTER: FROM NORTH FROM EAST

SECTION LINES: 265 780

Lease Name: WATERMELON 0906

Well No: 16-1WH

Well will be 265 feet from nearest unit or lease boundary.

Operator Name: CAMINO NATURAL RESOURCES LLC

Telephone: 7204052706

OTC/OCC Number: 24097 0

CAMINO NATURAL RESOURCES LLC
1401 17TH ST STE 1000
DENVER, CO 80202-1247

JERRY CAMPBELL
1539 CR 1212
TUTTLE OK 73089

Formation(s) (Permit Valid for Listed Formations Only):

Name	Depth	Name	Depth
1 WOODFORD	10885	6	
2		7	
3		8	
4		9	
5		10	

Spacing Orders: 366115

Location Exception Orders: 201803506

Increased Density Orders:

Pending CD Numbers:

Special Orders:

Total Depth: 16500

Ground Elevation: 1349

Surface Casing: 1500

Depth to base of Treatable Water-Bearing FM: 350

Under Federal Jurisdiction: No

Fresh Water Supply Well Drilled: No

Surface Water used to Drill: No

PIT 1 INFORMATION

Approved Method for disposal of Drilling Fluids:

Type of Pit System: CLOSED Closed System Means Steel Pits

Type of Mud System: WATER BASED

Chlorides Max: 5000 Average: 3000

Is depth to top of ground water greater than 10ft below base of pit? Y

Within 1 mile of municipal water well? N

Wellhead Protection Area? N

Pit is located in a Hydrologically Sensitive Area.

Category of Pit: C

Liner not required for Category: C

Pit Location is AP/TE DEPOSIT

Pit Location Formation: TERRACE

D. One time land application -- (REQUIRES PERMIT)

PERMIT NO: 18-34918

H. SEE MEMO

This permit does not address the right of entry or settlement of surface damages.

The duration of this permit is SIX MONTHS, except as otherwise provided by Rule 165: 10-3-1.

Rule 165: 10-3-4 (c) (7) (e) - The Operator shall give 24 Hours notice by telephone to the appropriate District Office of the Conservation Division as to when Surface Casing will be run.

PIT 2 INFORMATION

Type of Pit System: CLOSED Closed System Means Steel Pits

Type of Mud System: OIL BASED

Chlorides Max: 300000 Average: 200000

Is depth to top of ground water greater than 10ft below base of pit? Y

Within 1 mile of municipal water well? N

Wellhead Protection Area? N

Pit is located in a Hydrologically Sensitive Area.

Category of Pit: C

Liner not required for Category: C

Pit Location is AP/TE DEPOSIT

Pit Location Formation: TERRACE

HORIZONTAL HOLE 1

Sec 16 Twp 9N Rge 6W County GRADY

Spot Location of End Point: SW SE SE SE

Feet From: SOUTH 1/4 Section Line: 100

Feet From: EAST 1/4 Section Line: 380

Depth of Deviation: 10224

Radius of Turn: 800

Direction: 178

Total Length: 5019

Measured Total Depth: 16500

True Vertical Depth: 11026

End Point Location from Lease,
Unit, or Property Line: 100

Notes:

Category

Description

DEEP SURFACE CASING

7/19/2018 - G71 - APPROVED; NOTIFY OCC FIELD INSPECTOR IMMEDIATELY OF ANY LOSS OF CIRCULATION OR FAILURE TO CIRCULATE CEMENT TO SURFACE ON ANY CONDUCTOR OR SURFACE CASING

HYDRAULIC FRACTURING

7/19/2018 - G71 - OCC 165:10-3-10 REQUIRES:

1) PRIOR TO COMMENCEMENT OF HYDRAULIC FRACTURING OPERATIONS FOR HORIZONTAL WELLS, NOTICE GIVEN FIVE BUSINESS DAYS IN ADVANCE TO OFFSET OPERATORS WITH WELLS COMPLETED IN THE SAME COMMON SOURCE OF SUPPLY WITHIN 1/2 MILE;

2) WITH NOTICE ALSO GIVEN 48 HOURS IN ADVANCE OF HYDRAULIC FRACTURING ALL WELLS TO BOTH THE OCC CENTRAL OFFICE AND LOCAL DISTRICT OFFICES, USING THE "FRAC NOTICE FORM" FOUND AT THE FOLLOWING LINK: OCCEWEB.COM/OG/OGFORMS.HTML; AND,

3) THE CHEMICAL DISCLOSURE OF HYDRAULIC FRACTURING INGREDIENTS FOR ALL WELLS TO BE REPORTED TO FRACFOCUS WITHIN 60 DAYS AFTER THE CONCLUSION THE HYDRAULIC FRACTURING OPERATIONS, USING THE FOLLOWING LINK: FRACFOCUS.ORG

LOCATION EXCEPTION - 201803506

7/27/2018 - G57 - (I.O.) 16-9N-6W
X366115 WDFD
COMPL. INT. NCT 165' FNL, NCT 165' FSL, NCT 330' FEL
CAMINO NATURAL RESOURCES, LLC.
REC 5-21-2018 (NORRIS)

MEMO

7/19/2018 - G71 - PITS 1 & 2 - CLOSED SYSTEM=STEEL PITS PER OPERATOR REQUEST, PIT 2 - OBM RETURNED TO VENDOR, CUTTINGS PERMITTED PER DISTRICT

This permit does not address the right of entry or settlement of surface damages.

The duration of this permit is SIX MONTHS, except as otherwise provided by Rule 165: 10-3-1.

Rule 165: 10-3-4 (c) (7) (e) - The Operator shall give 24 Hours notice by telephone to the appropriate District Office of the Conservation Division as to when Surface Casing will be run.

051 24431 WATERMELON 0906 16-1WH

Category

SPACING - 366115

Description

7/27/2018 - G57 - (640) 16-9N-6W
EXT 338339 WDFD

This permit does not address the right of entry or settlement of surface damages.

The duration of this permit is SIX MONTHS, except as otherwise provided by Rule 165: 10-3-1.

Rule 165: 10-3-4 (c) (7) (e) - The Operator shall give 24 Hours notice by telephone to the appropriate District Office of the Conservation Division as to when Surface Casing will be run.

TOPOGRAPHIC LAND SURVEYORS OF OKLAHOMA

13800 Wireless Way, Okla. City, OK. 73134 (405) 843-4847 * OUT OF STATE (800) 654-3219
Certificate of Authorization No. 1293 LS

API:051 24431

GRADY

County, Oklahoma

265'FNL-780'FEL

Section 16

Township 9N

Range 6W

I.M.

X 2050857
Y 701810

FIRST PERF
165'FNL-380'FEL
NAD-27 (US Feet)
35°15'40.4"N
97°49'51.3"W
35.261214197N
97.830924697W
X= 2050478
Y= 701644

X 2050867
Y 699168

LAST PERF
165'FSL-380'FEL
NAD-27 (US Feet)
35°14'51.4"N
97°49'51.2"W
35.247603986N
97.830893412W
X= 2050495
Y= 696690

BOTTOM HOLE
100'FSL-380'FEL
NAD-27 (US Feet)
35°14'50.7"N
97°49'51.2"W
35.247425406N
97.830893002W
X= 2050496
Y= 696625

X 2050876
Y 696526

FIRST PERF, LAST PERF, BOTTOM HOLE, AND DRILL PATH
INFORMATION PROVIDED BY OPERATOR LISTED, NOT SURVEYED.

Operator: CAMINO NATURAL RESOURCES, LLC

Lease Name: WATERMELON 0906

Well No.: 16-1WH

ELEVATION:

1349' Gr. at Stake

Topography & Vegetation Loc. fell in level plowed field

Good Drill Site? Yes

Reference Stakes or Alternate Location
Stakes Set None

Best Accessibility to Location From North off county road

Distance & Direction

from Hwy Jct or Town From Tuttle, OK, go ± 0.2 mi. East, then ±2.0 mi. South, then ±1.0 mi. West
to the NE Cor. of Sec. 16-T9N-R6W.

DATUM: NAD-27
LAT: 35°15'39.4"N
LONG: 97°49'56.2"W
LAT: 35.260938695N
LONG: 97.832263922W
STATE PLANE
COORDINATES: (US Feet)
ZONE: OK SOUTH
X: 2050078
Y: 701543

Invoice # 297993 Date of Drawing: July 18, 2018
Date Staked: July 16, 2018 AC/TR

CERTIFICATE:

I, Thomas L. Howell an Oklahoma Licensed Land
Surveyor and an authorized agent of Topographic Land
Surveyors of Oklahoma, do hereby certify to the
information shown herein

Thomas L. Howell
Oklahoma Lic. No. 1433

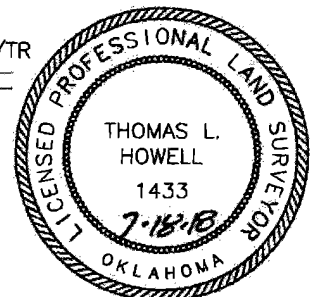

NOTE:
The information shown herein is for
construction purposes ONLY

