

Oklahoma Corporation Commission
Oil & Gas Conservation Division
Post Office Box 52000
Oklahoma City, Oklahoma 73152-2000
Rule 165: 10-3-25

Form 1002A

API No.: 35103242920003

Completion Report

Spud Date: October 03, 2011

OTC Prod. Unit No.: 103-208022

Drilling Finished Date: October 11, 2011

Amended

1st Prod Date: August 11, 2012

Amend Reason: RECOMPLETE

Completion Date: July 10, 2012

Recomplete Date: September 11, 2017

Drill Type: STRAIGHT HOLE

Well Name: GRACE 33

Purchaser/Measurer:

Location: NOBLE 30 24N 1W
S2 SW NW SW
1550 FSL 330 FWL of 1/4 SEC
Derrick Elevation: 977 Ground Elevation: 964

First Sales Date:

Operator: DONRAY PETROLEUM LLC 21690

2525 NW EXPRESSWAY STE 640
OKLAHOMA CITY, OK 73112-7230

Completion Type		Location Exception		Increased Density	
X	Single Zone	Order No		Order No	
	Multiple Zone	There are no Location Exception records to display.		There are no Increased Density records to display.	
	Commingled				

Casing and Cement							
Type	Size	Weight	Grade	Feet	PSI	SAX	Top of CMT
SURFACE	8 5/8	32		240		150	SURFACE
PRODUCTION	5.5	17		4691		400	1950

Liner								
Type	Size	Weight	Grade	Length	PSI	SAX	Top Depth	Bottom Depth
There are no Liner records to display.								

Total Depth: 4700

Packer	
Depth	Brand & Type
There are no Packer records to display.	

Plug	
Depth	Plug Type
3300	CIBP
4250	CIBP
4691	CIBP

Initial Test Data

Test Date	Formation	Oil BBL/Day	Oil-Gravity (API)	Gas MCF/Day	Gas-Oil Ratio Cu FT/BBL	Water BBL/Day	Pumpin or Flowing	Initial Shut-In Pressure	Choke Size	Flow Tubing Pressure
Sep 11, 2017	HOOVER	30	40	80	2666	600	PUMPING	70		

Completion and Test Data by Producing Formation			
Formation Name: HOOVER		Code: 406HOVR	
		Class: OIL	
Spacing Orders		Perforated Intervals	
Order No	Unit Size	From	To
582662	40	2074	2080
Acid Volumes		Fracture Treatments	
750 GALLONS 12% HCL		500 BSW, 25,000 POUNDS SAND	

Formation	Top
HOOVER	0

Were open hole logs run? Yes

Date last log run: October 11, 2011

Were unusual drilling circumstances encountered? No

Explanation:

Other Remarks
There are no Other Remarks.

FOR COMMISSION USE ONLY	
<div>Status: Accepted</div>	1138191

API NO. 10324292d
OTC PROD. UNIT NO. 103208022

PLEASE TYPE OR USE BLACK INK ONLY

NOTE:

Attach copy of original 1002A if recompletion or reentry.

OKLAHOMA CORPORATION COMMISSION

Oil & Gas Conservation Division

Post Office Box 52000

Oklahoma City, Oklahoma 73152-2000

Rule 165:10-3-25

RECEIVED

NOV 20 2017

OKLAHOMA CORPORATION COMMISSION

Form 1002A
Rev. 2009

☐ ORIGINAL
☒ AMENDED (Reason)

recomplete

COMPLETION REPORT

TYPE OF DRILLING OPERATION

☒ STRAIGHT HOLE ☐ DIRECTIONAL HOLE ☐ HORIZONTAL HOLE
☐ SERVICE WELL

If directional or horizontal, see reverse for bottom hole location.

COUNTY	noble	SEC	30	TWP	24n	RGE	1w	SPUD DATE	10-3-11
LEASE NAME	grace	WELL NO.	33	DRLG FINISHED DATE	10-11-11	DATE OF WELL COMPLETION	7-10-12	1st PROD DATE	8-11-12
s2 1/4 SW 1/4 NW 1/4 SW 1/4	FSL OF 1/4 SEC 1550	FWL OF 1/4 SEC 330	RECOMP DATE	9-11-2017					
ELEVATION Derrick FL 977	Ground 964	Latitude (if known)	Longitude (if known)						
OPERATOR NAME	donray petroleum llc.	OTC/OCC OPERATOR NO.	21690						
ADDRESS	2525 nw expressway # 640								
CITY	okc	STATE	ok	ZIP	73112				

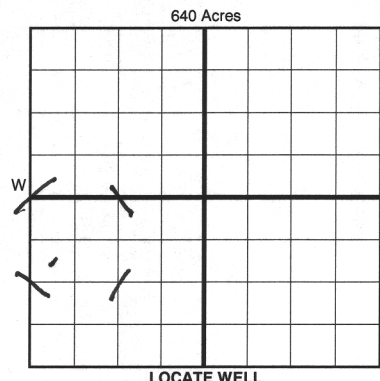

COMPLETION TYPE

<input checked="" type="checkbox"/> SINGLE ZONE
<input type="checkbox"/> MULTIPLE ZONE
Application Date
<input type="checkbox"/> COMMINGLED
Application Date
LOCATION
EXCEPTION ORDER
INCREASED DENSITY
ORDER NO.

CASING & CEMENT (Form 1002C must be attached)

TYPE	SIZE	WEIGHT	GRADE	FEET	PSI	SAX	TOP OF CMT
CONDUCTOR							
SURFACE	8 5/8	32		240		150	surface
INTERMEDIATE							
PRODUCTION	5.5	17		4691		400	1950
LINER							
				TOTAL DEPTH	4,700		

PACKER @ _____ BRAND & TYPE _____ PLUG @ 4691 TYPE cibp PLUG @ 3300 TYPE cibp
PACKER @ _____ BRAND & TYPE _____ PLUG @ 4250 TYPE cibp PLUG @ _____ TYPE _____

COMPLETION & TEST DATA BY PRODUCING FORMATION

FORMATION	hoover					
SPACING & SPACING ORDER NUMBER	582662 (40)					
CLASS: Oil, Gas, Dry, Inj, Disp, Comm Disp, Svc	oil					
PERFORATED INTERVALS	2074-80					
ACID/VOLUME	750 gal 12% hcl					
FRACTURE TREATMENT (Fluids/Prop Amounts)	500 bsw					
	25,000 # snd					

Monitor Report to Frac Focus

Min Gas Allowable (165:10-17-7)

Gas Purchaser/Measurer



OR

First Sales Date

INITIAL TEST DATA

Oil Allowable (165:10-13-3)

INITIAL TEST DATE	9/11/2017					
OIL-BBL/DAY	30 bpd					
OIL-GRAVITY (API)	40					
GAS-MCF/DAY	80 mcfpd					
GAS-OIL RATIO CU FT/BBL	2666					
WATER-BBL/DAY	600 bpd					
PUMPING OR FLOWING	pump					
INITIAL SHUT-IN PRESSURE	70#					
CHOKE SIZE						
FLOW TUBING PRESSURE						

A record of the formations drilled through, and pertinent remarks are presented on the reverse. I declare that I have knowledge of the contents of this report and am authorized by my organization to make this report, which was prepared by me or under my supervision and direction, with the data and facts stated herein to be true, correct, and complete to the best of my knowledge and belief.

ray corbitt jr.

11/16/2017 (405) 418-4348

SIGNATURE

NAME (PRINT OR TYPE)

DATE

PHONE NUMBER

2525 nw expressway # 640

okc

ok

73112

ray@donraypetroleum.com

ADDRESS

CITY

STATE

ZIP

EMAIL ADDRESS

Give formation names and tops, if available, or descriptions and thickness of formations drilled through. Show intervals cored or drillstem tested.

NAMES OF FORMATIONS	TOP
hoover	X

Were unusual drilling circumstances encountered? yes X no
If yes, briefly explain below

LATERAL #3						
SEC	TWP	RGE	COUNTY			
Spot Location						
1/4	1/4	1/4	1/4	Feet From 1/4 Sec Lines	FSL	FWL
Depth of Deviation		Radius of Turn		Direction	Total Length	
Measured Total Depth		True Vertical Depth		BHL From Lease, Unit, or Property Line:		