

Oklahoma Corporation Commission
Oil & Gas Conservation Division
Post Office Box 52000
Oklahoma City, Oklahoma 73152-2000
Rule 165: 10-3-25

Form 1002A

API No.: 35033028020001

Completion Report

Spud Date: April 06, 1959

OTC Prod. Unit No.: 23362-0444

Drilling Finished Date: April 10, 1959

Amended

1st Prod Date:

Amend Reason: TEMPORARILY ABANDONED AND CORRECT SPOT CALL

Completion Date: April 22, 1959

Recomplete Date: January 12, 2018

Drill Type: STRAIGHT HOLE

SERVICE WELL

Well Name: G G PRIDY 16

Purchaser/Measurer:

Location: COTTON 3 2S 10W
SE SW NE SW
1540 FSL 1740 FWL of 1/4 SEC
Derrick Elevation: 0 Ground Elevation: 0

First Sales Date:

Operator: SABCO OPERATING COMPANY LLC 23927

34 S WYNDEN DR STE 300
HOUSTON, TX 77056-2531

Completion Type		Location Exception		Increased Density	
X	Single Zone	Order No		Order No	
	Multiple Zone	There are no Location Exception records to display.		There are no Increased Density records to display.	
	Commingled				

Casing and Cement							
Type	Size	Weight	Grade	Feet	PSI	SAX	Top of CMT
SURFACE	8 5/8			125			
PRODUCTION	4 1/2			2285			

Liner								
Type	Size	Weight	Grade	Length	PSI	SAX	Top Depth	Bottom Depth
There are no Liner records to display.								

Total Depth: 2350

Packer		Plug	
Depth	Brand & Type	Depth	Plug Type
There are no Packer records to display.		2250	PBTD

Initial Test Data

Test Date	Formation	Oil BBL/Day	Oil-Gravity (API)	Gas MCF/Day	Gas-Oil Ratio Cu FT/BBL	Water BBL/Day	Pumpin or Flowing	Initial Shut- In Pressure	Choke Size	Flow Tubing Pressure
-----------	-----------	----------------	----------------------	----------------	----------------------------	------------------	----------------------	---------------------------------	---------------	-------------------------

There are no Initial Data records to display.

Completion and Test Data by Producing Formation

Formation Name: PRIDDY

Code: 406PRDD

Class: TA

Spacing Orders	
Order No	Unit Size
There are no Spacing Order records to display.	

Perforated Intervals	
From	To
2184	2196

Acid Volumes	
There are no Acid Volume records to display.	

Fracture Treatments	
There are no Fracture Treatments records to display.	

Formation	Top
PRIDDY	2184

Were open hole logs run? No

Date last log run:

Were unusual drilling circumstances encountered? No

Explanation:

Other Remarks
There are no Other Remarks.

FOR COMMISSION USE ONLY

1138575

Status: Accepted

API NO. 033-02802
OTC PROD. 23362-0444
UNIT NO.

PLEASE TYPE OR USE BLACK INK ONLY
NOTE:

Attach copy of original 1002A
if recompletion or reentry.

OKLAHOMA CORPORATION COMMISSION
Oil & Gas Conservation Division
Post Office Box 52000
Oklahoma City, Oklahoma 73152-2000
Rule 165:10-3-25

Form 1002A
Rev. 2009

☐ ORIGINAL
☒ AMENDED (Reason)

*Temporary Abandon
+ correct spot call*

TYPE OF DRILLING OPERATION

☒ STRAIGHT HOLE ☐ DIRECTIONAL HOLE ☐ HORIZONTAL HOLE
☒ SERVICE WELL

If directional or horizontal, see reverse for bottom hole location.

COUNTY Cotton SEC 3 TWP 2S RGE 10W

LEASE NAME G G Priddy

WELL NO. 16

SPUD DATE 4/6/59

ORLG FINISHED DATE 4/10/59

DATE OF WELL COMPLETION 4/22/59

1st PROD DATE

SE 1/4 SW 1/4 NE 1/4 SW 1/4

FSL OF 1/4 SEC 1540

FWL OF 1/4 SEC 1740

RECOMP DATE 1-12-2018

ELEVATION Ground

Latitude (if known)

Longitude (if known)

OPERATOR NAME Sabco Operating Company, LLC

OTC/OCC OPERATOR NO. 23927

ADDRESS 34 S Wynden Dr. Suite 100

CITY Houston

STATE Texas

ZIP 77056

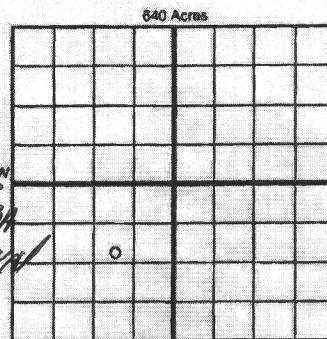

COMPLETION TYPE

☒ SINGLE ZONE
☐ MULTIPLE ZONE
Application Date
☐ COMINGLED
Application Date
LOCATION
EXCEPTION ORDER
INCREASED DENSITY
ORDER NO.

CASING & CEMENT (Form 1002C must be attached)

TYPE	SIZE	WEIGHT	GRADE	FEET	PSI	SAX	TOP OF CMT
CONDUCTOR							
SURFACE	8 5/8			125			
INTERMEDIATE							
PRODUCTION	4 1/2			2285			
LINER							

PACKER @ BRAND & TYPE

PLUG @

2250 TYPE PBD

PLUG @

TYPE

TOTAL DEPTH

2350

PACKER @ BRAND & TYPE

PLUG @

TYPE

PLUG @

TYPE

COMPLETION & TEST DATA BY PRODUCING FORMATION

406 PRDD

FORMATION	Priddy						
SPACING & SPACING ORDER NUMBER							
CLASS: Oil, Gas, Dry, Inj, Disp, Comm Disp, Svc	TA						
	2184-2196						
PERFORATED INTERVALS							
ACID/VOLUME							
FRACTURE TREATMENT (Fluids/Prop Amounts)							

RECEIVED

JAN 12 2018

OKLAHOMA CORPORATION COMMISSION
DUNCAN OFFICE

Min Gas Allowable (165:10-17-7)

☐

OR

Oil Allowable (165:10-13-3)

Gas Purchaser/Measurer

First Sales Date

INITIAL TEST DATA

INITIAL TEST DATE	4/22/1959						
OIL-BBL/DAY	6						
OIL-GRAVITY (API)							
GAS-MCF/DAY							
GAS-OIL RATIO CU FT/BBL							
WATER-BBL/DAY							
PUMPING OR FLOWING							
INITIAL SHUT-IN PRESSURE							
CHOKE SIZE							
FLOW TUBING PRESSURE							

AS SUBMITTED

A record of the formations drilled through, and pertinent remarks are presented on the reverse. I declare that I have knowledge of the contents of this report and am authorized by my organization to make this report, which was prepared by me or under my supervision and direction, with the data and facts stated herein to be true, correct, and complete to the best of my knowledge and belief.

Ali Saberioon

1/10/2018

713-840-1980

SIGNATURE

NAME (PRINT OR TYPE)

DATE

PHONE NUMBER

34 s Wynden Dr., Suite 100

Houston

TX

77056

ali.saberioon@sabcolc.com

ADDRESS

CITY

STATE

ZIP

EMAIL ADDRESS

Give formation names and tops, if available, or descriptions and thickness of formations drilled through. Show intervals cored or drillstem tested.

NAMES OF FORMATIONS	TOP
Priddy	2,184

FOR COMMISSION USE ONLY	
ITD on file	<input type="checkbox"/> YES <input type="checkbox"/> NO
APPROVED	DISAPPROVED
2) Reject Codes	

Were open hole logs run? _____ yes _____ no

Date Last log was run _____

Was CO₂ encountered? _____ yes _____ no at what depths? _____

Was H₂S encountered? _____ yes _____ no at what depths? _____

Were unusual drilling circumstances encountered? _____ yes _____ no
If yes, briefly explain below

Other remarks:

640 Acres

If more than three drainholes are proposed, attach a separate sheet indicating the necessary information.

Direction must be stated in degrees azimuth.
Please note, the horizontal drainhole and its end
point must be located within the boundaries of the
lease or spacing unit.

Directional surveys are required for all drainholes and directional wells.

640 Acres

A blank 10x10 grid for graphing. The grid is composed of 10 columns and 10 rows of squares. A vertical line runs down the center, separating the grid into two 5-column halves. A horizontal line runs across the middle, separating the grid into two 5-row halves. The intersection of these lines is at the center of the grid.

BOTTOM HOLE LOCATION FOR DIRECTIONAL HOLE

SEC	TWP	RGE	COUNTY
Spot Location			
1/4	1/4	1/4	1/4
Measured Total Depth		Feet From 1/4 Sec Lines	FSL
True Vertical Depth		FWL	
BHL From Lease, Unit, or Property Line:			

BOTTOM HOLE LOCATION FOR HORIZONTAL HOLE: (LATERALS)

LATERAL #1

SEC	TWP	RGE	COUNTY
Spot Location			
1/4	1/4	1/4	1/4
Depth of Deviation		Radius of Turn	Direction
Measured Total Depth		True Vertical Depth	Total Length
		BHL From Lease, Unit, or Property Line:	

LATERAL #2

SEC	TWP	RGE	COUNTY		
Spot Location			Feet From 1/4 Sec Lines	FSL	FWL
1/4	1/4	1/4	1/4		
Depth of Deviation	Radius of Turn	Direction	Total Length		
Measured Total Depth	True Vertical Depth	BHL From Lease, Unit, or Property Line:			

LATERAL #3

SEC	TWP	RGE	COUNTY		
Spot Location			Feet From 1/4 Sec Lines	FSL	FWL
1/4	1/4	1/4	1/4		
Depth of Deviation	Radius of Turn	Direction	Total Length		
Measured Total Depth	True Vertical Depth	BHL From Lease, Unit, or Property Line:			