

Oklahoma Corporation Commission  
Oil & Gas Conservation Division  
Post Office Box 52000  
Oklahoma City, Oklahoma 73152-2000  
Rule 165: 10-3-25

Form 1002A

API No.: 35073257780000

**Completion Report**

Spud Date: September 17, 2017

OTC Prod. Unit No.: 073-22278100000

Drilling Finished Date: October 04, 2017

1st Prod Date: December 29, 2017

Completion Date: December 29, 2017

**Drill Type:** HORIZONTAL HOLE

Min Gas Allowable: Yes

Well Name: WILD JACK WILEY 25-O 1H

Purchaser/Measurer: MUSTANG GAS PRODUCTS  
LLC

Location: KINGFISHER 25 19N 6W  
SE SE SE SW  
225 FSL 2320 FWL of 1/4 SEC  
Derrick Elevation: 1130 Ground Elevation: 1116

First Sales Date: 01/10/2018

Operator: STONE CREEK OPERATING LLC 24022

6301 WATERFORD BLVD STE 115  
OKLAHOMA CITY, OK 73118-1130

Completion Type		Location Exception		Increased Density	
X	Single Zone	Order No		Order No	
	Multiple Zone	671381		There are no Increased Density records to display.	
	Commingled				

Casing and Cement							
Type	Size	Weight	Grade	Feet	PSI	SAX	Top of CMT
CONDUCTOR	20			43		4	SURFACE
SURFACE	9 5/8	36	J-55	400	1500	215	SURFACE
PRODUCTION	7	29 & 26	P-110	6601	1800	350	3527

Liner								
Type	Size	Weight	Grade	Length	PSI	SAX	Top Depth	Bottom Depth
LINER	4 1/2	13.5	P-110	4599	4100	435	6486	11085

**Total Depth: 11121**

Packer	
Depth	Brand & Type
There are no Packer records to display.	

Plug	
Depth	Plug Type
There are no Plug records to display.	

Initial Test Data
-------------------

Test Date	Formation	Oil BBL/Day	Oil-Gravity (API)	Gas MCF/Day	Gas-Oil Ratio Cu FT/BBL	Water BBL/Day	Pumpin or Flowing	Initial Shut-In Pressure	Choke Size	Flow Tubing Pressure
Jan 13, 2018	OSWEGO	210	35	598	2848	496	PUMING	75	48/64	471

<b>Completion and Test Data by Producing Formation</b>	
Formation Name: OSWEGO	Code: 404OSWG
Class: OIL	

Spacing Orders	
Order No	Unit Size
662651	640

Perforated Intervals	
From	To
6698	11015

Acid Volumes	
422,632 GALLONS 20% HCL, 47,883 BARRELS WATER	

Fracture Treatments	
There are no Fracture Treatments records to display.	

Formation	Top
OSWEGO	6151

Were open hole logs run? No

Date last log run:

Were unusual drilling circumstances encountered? No

Explanation:

<b>Other Remarks</b>
OCC - THIS DOCUMENT IS ACCEPTED BASED ON THE DATA SUBMITTED THE FINAL LOCATION EXCEPTION HAS NOT BEEN ISSUED.

<b>Lateral Holes</b>
Sec: 25 TWP: 19N RGE: 6W County: KINGFISHER  SW   NW   NW   NE  403 FNL   2624 FEL of 1/4 SEC  Depth of Deviation: 5600 Radius of Turn: 540 Direction: 1 Total Length: 4518  Measured Total Depth: 11121 True Vertical Depth: 6135 End Pt. Location From Release, Unit or Property Line: 403

<b>FOR COMMISSION USE ONLY</b>	
Status: Accepted	1138605

API NO. 073-25778  
OTC PROD. UNIT NO. 07322278100000

PLEASE TYPE OR USE BLACK INK ONLY  
NOTE:

Attach copy of original 1002A  
if recompletion or reentry.

OKLAHOMA CORPORATION COMMISSION  
Oil & Gas Conservation Division  
Post Office Box 52000  
Oklahoma City, Oklahoma 73152-2000  
Rule 165:10-3-25

RECEIVED

JAN 17 2018

OKLAHOMA CORPORATION  
COMMISSION

Form 1002A  
Rev. 2009

☒ ORIGINAL  
☐ AMENDED (Reason)

TYPE OF DRILLING OPERATION

☐ STRAIGHT HOLE ☐ DIRECTIONAL HOLE ☒ HORIZONTAL HOLE  
☐ SERVICE WELL

If directional or horizontal, see reverse for bottom hole location.

COUNTY Kingfisher SEC 25 TWP 19N RGE 06WIM  
LEASE NAME Wild Jack Wiley 25 - O  
SE 1/4 SE 1/4 SE 1/4 SW 1/4 FSL OF 225 FWL OF 2320  
ELEVATION 1130' Ground 1116' Latitude (if known) 36.087700245N Longitude (if known) 97.791962970W  
Derrick FL  
OPERATOR NAME Stone Creek Operating LLC OTC/OCC OPERATOR NO. 24022  
ADDRESS 6301 Waterford Blvd, Ste 115  
CITY Oklahoma City STATE OK ZIP 73118

SPUD DATE 09-17-2017  
DRLG FINISHED DATE 10-04-2017  
DATE OF WELL COMPLETION 12-29-2017  
1st PROD DATE 12-29-2017  
RECOMP DATE

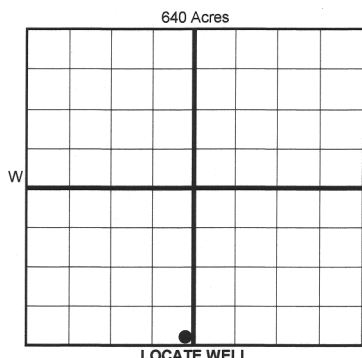

COMPLETION TYPE

☒ SINGLE ZONE  
☐ MULTIPLE ZONE  
Application Date  
☐ COMMINGLED  
Application Date  
LOCATION 671381 I.O.  
EXCEPTION ORDER  
INCREASED DENSITY  
ORDER NO

CASING & CEMENT (Form 1002C must be attached)

TYPE	SIZE	WEIGHT	GRADE	FEET	PSI	SAX	TOP OF CMT
CONDUCTOR	20"			43'		4.5 yds	surface
SURFACE	9 5/8"	36#	J55	400'	1500	215	surface
INTERMEDIATE	7"	29 & 26	P110	6601'	1800	350	3527'
PRODUCTION							
LINER	4 1/2"	13.5#	P110	4599' (6486-11085)	4100	435	6486'
TOTAL DEPTH							11,121

PACKER @ \_\_\_\_\_ BRAND & TYPE \_\_\_\_\_ PLUG @ \_\_\_\_\_ TYPE \_\_\_\_\_ PLUG @ \_\_\_\_\_ TYPE \_\_\_\_\_  
PACKER @ \_\_\_\_\_ BRAND & TYPE \_\_\_\_\_ PLUG @ \_\_\_\_\_ TYPE \_\_\_\_\_ PLUG @ \_\_\_\_\_ TYPE \_\_\_\_\_

COMPLETION & TEST DATA BY PRODUCING FORMATION

FORMATION	Oswego						
SPACING & SPACING ORDER NUMBER	662651 (640)						Reported to Pac Focus
CLASS: Oil, Gas, Dry, Inj, Disp, Comm Disp, Svc	Oil						
	6698' - 11,015'						
PERFORATED INTERVALS							
ACID/VOLUME	20% HCl/422,632 gals						
	47,883 bbls water						
FRACTURE TREATMENT (Fluids/Prop Amounts)	10,000 bbls acid						

☒ Min Gas Allowable (165:10-17-7)  
OR  
☐ Oil Allowable (165:10-13-3)

Gas Purchaser/Measurer  
First Sales Date

Mustang Gas Products LLC  
01/10/2018

INITIAL TEST DATA

INITIAL TEST DATE	01/13/2018					
OIL-BBL/DAY	210					
OIL-GRAVITY ( API)	35					
GAS-MCF/DAY	598					
GAS-OIL RATIO CU FT/BBL	2848					
WATER-BBL/DAY	496					
PUMPING OR FLOWING	Pumping					
INITIAL SHUT-IN PRESSURE	75 psi					
CHOKE SIZE	48/64"					
FLOW TUBING PRESSURE	471 psi					

AS SUBMITTED

A record of the formations drilled through, and pertinent remarks are presented on the reverse. I declare that I have knowledge of the contents of this report and am authorized by my organization to make this report, which was prepared by me or under my supervision and direction, with the data and facts stated herein to be true, correct, and complete to the best of my knowledge and belief.

SIGNATURE Jeff Dinsmore NAME (PRINT OR TYPE) 1/15/18 (405) 683-0385  
6301 Waterford Blvd, Ste 115 Oklahoma City OK 73118 jeff@stonecreekenergyservices.com  
ADDRESS CITY STATE ZIP EMAIL ADDRESS

PLEASE TYPE OR USE BLACK INK ONLY  
FORMATION RECORD

Give formation names and tops, if available, or descriptions and thickness of formations drilled through. Show intervals cored or drillstem tested.

LEASE NAME Wild Jack Wiley 25

WELL NO. O1H

NAMES OF FORMATIONS	TOP
Oswego	6151'

FOR COMMISSION USE ONLY	
ITD on file <input type="checkbox"/> YES <input type="checkbox"/> NO	
APPROVED _____	DISAPPROVED _____
2) Reject Codes	
_____	
_____	
_____	
_____	

Were open hole logs run?	_____ yes <input checked="" type="checkbox"/> no
Date Last log was run	_____
Was CO <sub>2</sub> encountered?	_____ yes <input checked="" type="checkbox"/> no at what depths? _____
Was H <sub>2</sub> S encountered?	_____ yes <input checked="" type="checkbox"/> no at what depths? _____
Were unusual drilling circumstances encountered?	_____ yes <input checked="" type="checkbox"/> no
If yes, briefly explain below	

Other remarks:

640 Acres

If more than three drainholes are proposed, attach a separate sheet indicating the necessary information.

Direction must be stated in degrees azimuth. Please note, the horizontal drainhole and its end point must be located within the boundaries of the lease or spacing unit.

Directional surveys are required for all drainholes and directional wells.

640 Acres

BOTTOM HOLE LOCATION FOR DIRECTIONAL HOLE

SEC	TWP	RGE	COUNTY
25	19N	6W	WIM
Spot Location	1/4	1/4	1/4
Measured Total Depth	True Vertical Depth		BHL From Lease, Unit, or Property Line:

BOTTOM HOLE LOCATION FOR HORIZONTAL HOLE: (LATERALS)

*Per exhibit in LE*

SEC	TWP	RGE	COUNTY
25	19N	6W	WIM
Spot Location	1/4	1/4	1/4
Measured Total Depth	True Vertical Depth		BHL From Lease, Unit, or Property Line:

*SW NW NE*  
*1/4 1/4 1/4*  
*5600 540' 403'*  
*403'*

**LATERAL #2**

SEC	TWP	RGE	COUNTY
25	19N	6W	WIM
Spot Location	1/4	1/4	1/4
Depth of Deviation	Radius of Turn		Direction
Measured Total Depth	True Vertical Depth		BHL From Lease, Unit, or Property Line:

**LATERAL #3**

SEC	TWP	RGE	COUNTY
25	19N	6W	WIM
Spot Location	1/4	1/4	1/4
Depth of Deviation	Radius of Turn		Direction
Measured Total Depth	True Vertical Depth		BHL From Lease, Unit, or Property Line: