

Oklahoma Corporation Commission
Oil & Gas Conservation Division
Post Office Box 52000
Oklahoma City, Oklahoma 73152-2000
Rule 165: 10-3-25

Form 1002A

API No.: 35153236060000

Completion Report

Spud Date: July 02, 2017

OTC Prod. Unit No.: 153-222334

Drilling Finished Date: August 14, 2017

1st Prod Date: September 09, 2017

Completion Date: August 17, 2017

Drill Type: HORIZONTAL HOLE

Well Name: ELDENA 7 1H

Purchaser/Measurer: RED CLIFF MIDSTREAM

Location: WOODWARD 6 20N 17W
S2 SW SE SE
250 FSL 990 FEL of 1/4 SEC
Latitude: 36.21718 Longitude: -99.04805
Derrick Elevation: 1755 Ground Elevation: 1737

First Sales Date: 09/09/2017

Operator: CORLENA OIL COMPANY 23706

619 S TYLER ST STE 210
AMARILLO, TX 79101-2303

Completion Type	
X	Single Zone
	Multiple Zone
	Commingled

Location Exception	
Order No	
666768	

Increased Density	
Order No	
There are no Increased Density records to display.	

Casing and Cement							
Type	Size	Weight	Grade	Feet	PSI	SAX	Top of CMT
CONDUCTOR	20	94	H-40	100			SURFACE
SURFACE	9 5/8	36	J-55	1474	520	600	SURFACE
INTERMEDIATE	7	26	P-110	9487	1400	445	3325
PRODUCTION	4 1/2 / 5	13.5 / 20.0	P-110	14595	1200	445	8876

Liner								
Type	Size	Weight	Grade	Length	PSI	SAX	Top Depth	Bottom Depth
There are no Liner records to display.								

Total Depth: 14600

Packer	
Depth	Brand & Type
8876	BAKER S3 HYD

Plug	
Depth	Plug Type
There are no Plug records to display.	

Initial Test Data

Test Date	Formation	Oil BBL/Day	Oil-Gravity (API)	Gas MCF/Day	Gas-Oil Ratio Cu FT/BBL	Water BBL/Day	Pumpin or Flowing	Initial Shut-In Pressure	Choke Size	Flow Tubing Pressure
Oct 09, 2017	MISSISSIPPIAN	271	49	4873	17981	3000	FLOWING		42	1450

Completion and Test Data by Producing Formation															
Formation Name: MISSISSIPPIAN		Code: 359MSSP	Class: GAS												
<table border="1" style="width:100%; border-collapse: collapse;"> <tr><th colspan="2">Spacing Orders</th></tr> <tr> <th>Order No</th> <th>Unit Size</th> </tr> <tr> <td>665730</td> <td>640</td> </tr> </table>		Spacing Orders		Order No	Unit Size	665730	640	<table border="1" style="width:100%; border-collapse: collapse;"> <tr><th colspan="2">Perforated Intervals</th></tr> <tr> <th>From</th> <th>To</th> </tr> <tr> <td>9671</td> <td>14505</td> </tr> </table>		Perforated Intervals		From	To	9671	14505
Spacing Orders															
Order No	Unit Size														
665730	640														
Perforated Intervals															
From	To														
9671	14505														
<table border="1" style="width:100%; border-collapse: collapse;"> <tr><th colspan="2">Acid Volumes</th></tr> <tr> <td colspan="2">93,000 GALLONS 15% HCL</td> </tr> </table>		Acid Volumes		93,000 GALLONS 15% HCL		<table border="1" style="width:100%; border-collapse: collapse;"> <tr><th colspan="2">Fracture Treatments</th></tr> <tr> <td colspan="2">65MM POUNDS SAND, 297,000 BARRELS SLICKWATER AND GEL</td> </tr> </table>		Fracture Treatments		65MM POUNDS SAND, 297,000 BARRELS SLICKWATER AND GEL					
Acid Volumes															
93,000 GALLONS 15% HCL															
Fracture Treatments															
65MM POUNDS SAND, 297,000 BARRELS SLICKWATER AND GEL															

Formation	Top
MISSISSIPPIAN	8240
ST GENEVIEVE	9312

Were open hole logs run? Yes
 Date last log run: August 13, 2017

 Were unusual drilling circumstances encountered? No
 Explanation:

Other Remarks
THE 5 1/2" CASING IS A TIE-BACK STRING INTO THE 4 1/2" LINER. OCC - THIS DOCUMENT IS ACCEPTED BASED ON THE DATA SUBMITTED THE FINAL LOCATION EXCEPTION HAS NOT BEEN SUBMITTED.

Lateral Holes
Sec: 7 TWP: 20N RGE: 17W County: WOODWARD SE SW SE SE 196 FSL 950 FEL of 1/4 SEC Depth of Deviation: 8800 Radius of Turn: 573 Direction: 179 Total Length: 5342 Measured Total Depth: 14600 True Vertical Depth: 9612 End Pt. Location From Release, Unit or Property Line: 196

FOR COMMISSION USE ONLY	
Status: Accepted	1138576

RECEIVED

Form 1002A
Rev. 2009

JAN 16 2018

OKLAHOMA CORPORATION
COMMISSION

API NO. **153-23606**
OTC PROD. UNIT NO. **153-2234**

PLEASE TYPE OR USE BLACK INK ONLY
NOTE:

Attach copy of original 1002A
if recompletion or reentry.

OKLAHOMA CORPORATION COMMISSION
Oil & Gas Conservation Division
Post Office Box 52000
Oklahoma City, Oklahoma 73152-2000
Rule 165:10-3-25

☒ ORIGINAL
☐ AMENDED (Reason)

COMPLETION REPORT

TYPE OF DRILLING OPERATION
☐ STRAIGHT HOLE ☐ DIRECTIONAL HOLE ☒ HORIZONTAL HOLE
☐ SERVICE WELL

If directional or horizontal, see reverse for bottom hole location.

COUNTY **WOODWARD** SEC **6** TWP **20N** RGE **17W**
LEASE NAME **ELDEN 7** WELL NO. **14**
S2 1/4 SW 1/4 SE 1/4 SE 1/4 FSL OF 250 FWL OF 105 1/4 SEC 105
ELEVATION 1735 Ground 1737 Latitude (if known) 36.21718 Longitude (if known) -99.04805
OPERATOR NAME **CORLENA OIL COMPANY** OTC/OCC OPERATOR NO. **23706**
ADDRESS **619 S TYLER STE 210**
CITY **AMARILLO** STATE **TX** ZIP **79101**

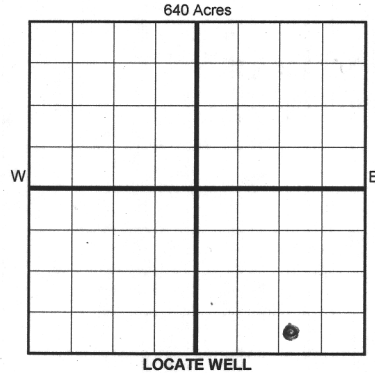

COMPLETION TYPE

☒ SINGLE ZONE
☐ MULTIPLE ZONE
Application Date
☐ COMMINGLED
Application Date
LOCATION
EXCEPTION ORDER
INCREASED DENSITY
ORDER NO. **666768 E.O.**

CASING & CEMENT (Form 1002C must be attached)

TYPE	SIZE	WEIGHT	GRADE	FEET	PSI	SAX	TOP OF CMT
CONDUCTOR	26	94	H-40	100			SURFACE
SURFACE	9 5/8"	36	J55	1474	520	600	SURFACE
INTERMEDIATE	7"	26	P110	9487	1100	445	3325'
PRODUCTION	5 1/2"	20	P110	8876			NONE
LINER	4 1/2"	13.5	P110	14595	1200	445	8876
						TOTAL DEPTH	14600'

PACKER @ **8876** BRAND & TYPE **BALERS 3 HYP** PLUG @ TYPE PLUG @
PACKER @ BRAND & TYPE PLUG @ TYPE PLUG @ TYPE

COMPLETION & TEST DATA BY PRODUCING FORMATION

FORMATION **MISSISSIPPIAN**
SPACING & SPACING ORDER NUMBER **(640) 665730**
CLASS: Oil, Gas, Dry, Inj, Disp, Comm Disp, Svc **Gas per GOR**
PERFORATED INTERVALS **9671'-14505'**
ACID/VOLUME **HCL 15% - 93 GAL**
FRACTURE TREATMENT (Fluids/Prop Amounts) **65MM* SAND 297K BBL SLICKWATER 1/2 GEL**

Min Gas Allowable (165:10-17-7)



OR

Oil Allowable (165:10-13-3)

Gas Purchaser/Measurer
First Sales Date

RED CLIFF MIDSTREAM
9-9-2017

INITIAL TEST DATA

INITIAL TEST DATE	10/9/2017
OIL-BBL/DAY	271
OIL-GRAVITY (API)	49
GAS-MCF/DAY	4873
GAS-OIL RATIO CU FT/BBL	17981
WATER-BBL/DAY	3000
PUMPING OR FLOWING	FLOWING
INITIAL SHUT-IN PRESSURE	-
CHOKE SIZE	42
FLOW TUBING PRESSURE	1450

AS SUBMITTED

A record of the formations drilled through, and pertinent remarks are presented on the reverse. I declare that I have knowledge of the contents of this report and am authorized by my organization to make this report, which was prepared by me or under my supervision and direction, with the data and facts stated herein to be true, correct, and complete to the best of my knowledge and belief.

SIGNATURE **J. Frederick** NAME (PRINT OR TYPE) **J. FREDERICK** DATE **1/10/2018** PHONE NUMBER **806 323 9811**
ADDRESS **PO BOX 188** CITY **CANADIAN, TX** STATE **TX** ZIP **79014** EMAIL ADDRESS **frederick@hadeng.com**

Per Jonathan Frederick

PLEASE TYPE OR USE BLACK INK ONLY
FORMATION RECORD

Give formation names and tops, if available, or descriptions and thickness of formations drilled through. Show intervals cored or drillstem tested.

NAMES OF FORMATIONS	TOP
MISSISSIPPIAN	8240' TD
ST. GENEVIEVE	9312' TD & 9412' MD

LEASE NAME ELDEN A 7 WELL NO. 14

FOR COMMISSION USE ONLY	
ITD on file <input type="checkbox"/> YES <input type="checkbox"/> NO	
APPROVED _____	DISAPPROVED _____
2) Reject Codes	

Were open hole logs run? X yes ☐ no

Date Last log was run 8/13/2017

Was CO₂ encountered? ☐ yes ☒ no at what depths? _____

Was H₂S encountered? ☐ yes ☒ no at what depths? _____

Were unusual drilling circumstances encountered? ☐ yes ☒ no

If yes, briefly explain below _____

Other remarks: THE 5-1/2" CASING IS A TIEBACK STRING INTO THE 4-1/2" LINER.

640 Acres

If more than three drainholes are proposed, attach a separate sheet indicating the necessary information.

Direction must be stated in degrees azimuth. Please note, the horizontal drainhole and its end point must be located within the boundaries of the lease or spacing unit.

Directional surveys are required for all drainholes and directional wells.

640 Acres

BOTTOM HOLE LOCATION FOR DIRECTIONAL HOLE

SEC	TWP	RGE	COUNTY	Spot Location	Feet From 1/4 Sec Lines	FSL	FWL
				1/4 1/4 1/4 1/4			
				Measured Total Depth	True Vertical Depth	BHL From Lease, Unit, or Property Line:	

BOTTOM HOLE LOCATION FOR HORIZONTAL HOLE: (LATERALS)

LATERAL #1	SEC	TWP	RGE	COUNTY	Spot Location	Feet From 1/4 Sec Lines	FSL	FWL
	7	20N	17W	WOODWARD	SE 1/4 SW 1/4 SE 1/4 SE 1/4		196'	FEL 9'50"
					Depth of Deviation 8800'	Radius of Turn 573'	Direction 179	Total Length 5342' VSEC
					Measured Total Depth 14600'	True Vertical Depth 9612'	BHL From Lease, Unit, or Property Line: 196' FSL	

LATERAL #2	SEC	TWP	RGE	COUNTY	Spot Location	Feet From 1/4 Sec Lines	FSL	FWL
					1/4 1/4 1/4 1/4			
					Depth of Deviation	Radius of Turn	Direction	Total Length
					Measured Total Depth	True Vertical Depth	BHL From Lease, Unit, or Property Line:	

LATERAL #3	SEC	TWP	RGE	COUNTY	Spot Location	Feet From 1/4 Sec Lines	FSL	FWL
					1/4 1/4 1/4 1/4			
					Depth of Deviation	Radius of Turn	Direction	Total Length
					Measured Total Depth	True Vertical Depth	BHL From Lease, Unit, or Property Line:	

4/1/18
Oklahoma Corporation Commission
Oil & Gas Conservation Division
Post Office Box 52000
Oklahoma City, Oklahoma 73152-2000
Rule 165: 10-3-25

Form 1002A

1016EZ

API No.: 153236060000

Completion Report

Spud Date: July 02, 2017

OTC Prod. Unit No.: 153-222334

Drilling Finished Date: August 14, 2017

1st Prod Date: September 09, 2017

Completion Date: August 17, 2017

A: 222334 I

Drill Type: HORIZONTAL HOLE

Well Name: ELDENA 7 1H

BHCL: 07-20N-17W

Purchaser/Measurer: RED CLIFF MIDSTREAM

First Sales Date: 09/09/2017

Location: WOODWARD 6 20N 17W
S2 SW SE SE
250 FSL 990 FEL of 1/4 SEC
Latitude: 36.21718 Longitude: -99.04805
Derrick Elevation: 1755 Ground Elevation: 1737

Operator: CORLENA OIL COMPANY 23706

619 S TYLER ST STE 210
AMARILLO, TX 79101-2303

Completion Type	
X	Single Zone
	Multiple Zone
	Commingled

Location Exception
Order No
666768

Increased Density
Order No
There are no Increased Density records to display.

Casing and Cement							
Type	Size	Weight	Grade	Feet	PSI	SAX	Top of CMT
CONDUCTOR	20	94	H-40	100			SURFACE
SURFACE	9 5/8	36	J-55	1474	520	600	SURFACE
INTERMEDIATE	7	26	P-110	9487	1400	445	3325
PRODUCTION	4 1/2 / 5	13.5 / 20.0	P-110	14595	1200	445	8876

Liner								
Type	Size	Weight	Grade	Length	PSI	SAX	Top Depth	Bottom Depth
There are no Liner records to display.								

Total Depth: 14600

Packer	
Depth	Brand & Type
8876	BAKER S3 HYD

Plug	
Depth	Plug Type
There are no Plug records to display.	

2017: 782,384

Initial Test Data

March 15, 2018

10/9/17

359 MSSP

2209

1 of 2

E2