

Oklahoma Corporation Commission
Oil & Gas Conservation Division
Post Office Box 52000
Oklahoma City, Oklahoma 73152-2000
Rule 165: 10-3-25

Form 1002A

API No.: 35071246560001

Completion Report

Spud Date: June 16, 2013

OTC Prod. Unit No.:

Drilling Finished Date: June 30, 2013

Amended

1st Prod Date:

Amend Reason: OCC REQUIRED PLUGBACK

Completion Date: July 29, 2013

Recomplete Date: August 21, 2015

Drill Type: STRAIGHT HOLE

SERVICE WELL

Well Name: TONKAWA SWD 1

Purchaser/Measurer:

Location: KAY 34 26N 1W
NE NE SE NW
1440 FNL 325 FEL of 1/4 SEC
Latitude: 36.6914368 Longitude: -97.2925987
Derrick Elevation: 0 Ground Elevation: 0

First Sales Date:

Operator: TONKAWA SALTWATER DISPOSAL LLC 23200
PO BOX 97
13600 W HIGHWAY 60
TONKAWA, OK 74633-0097

Completion Type		Location Exception		Increased Density	
X	Single Zone	Order No		Order No	
	Multiple Zone	There are no Location Exception records to display.		There are no Increased Density records to display.	
	Commingled				

Casing and Cement							
Type	Size	Weight	Grade	Feet	PSI	SAX	Top of CMT
CONDUCTOR	20	68	N/A	42	200	100	SURFACE
SURFACE	13 3/8	54.5	J-55	420	425	400	SURFACE
PRODUCTION	9 5/8	36	J-55	4877		1150	SURFACE

Liner								
Type	Size	Weight	Grade	Length	PSI	SAX	Top Depth	Bottom Depth
There are no Liner records to display.								

Total Depth: 5975

Packer		Plug	
Depth	Brand & Type	Depth	Plug Type
4840	MODEL R	5851	CEMENT

Initial Test Data

Test Date	Formation	Oil BBL/Day	Oil-Gravity (API)	Gas MCF/Day	Gas-Oil Ratio Cu FT/BBL	Water BBL/Day	Pumpin or Flowing	Initial Shut- In Pressure	Choke Size	Flow Tubing Pressure
-----------	-----------	----------------	----------------------	----------------	----------------------------	------------------	----------------------	---------------------------------	---------------	-------------------------

There are no Initial Data records to display.

Completion and Test Data by Producing Formation

Formation Name: ARBUCKLE Code: 169ABCK Class: COMM DISP

Spacing Orders		Perforated Intervals	
Order No	Unit Size	From	To
There are no Spacing Order records to display.		There are no Perf. Intervals records to display.	
Acid Volumes		Fracture Treatments	
8,000 GALLONS 20% HCL		There are no Fracture Treatments records to display.	

Formation	Top
ARBUCKLE	4330

Were open hole logs run? Yes

Date last log run: July 15, 2013

Were unusual drilling circumstances encountered? No

Explanation:

Other Remarks

AUGUST 21, 2015 - 9 SACKS OF CEMENT WERE DUMPED AND BAILED INTO THE WELL SPOTTING A 37' CEMENT PLUG FROM 5,851' TO 5,888'. THE ABOVE TOTAL OF 124' PLUGBACK MEETS OCC CURRENT RULE FOR ARBUCKLE INJECTION WELLS. UIC PERMIT NUMBER 1305650002. OCC - THIS WELL IS AN OPEN HOLE COMPLETION FROM BOTTOM OF 9 5/8" CASING AT 4,877' TO TOP OF CEMENT PLUG AT 5,851'.

FOR COMMISSION USE ONLY

1138800

Status: Accepted

API NO. **071-24656**
OTC PROD. UNIT NO. **23200**

PLEASE TYPE OR USE BLACK INK ONLY

NOTE:

Attach copy of original 1002A if recompletion or reentry.

OKLAHOMA CORPORATION COMMISSION

Oil & Gas Conservation Division
Post Office Box 52000
Oklahoma City, Oklahoma 73152-2000

Rule 165:10-3-25

COMPLETION REPORT

☐ ORIGINAL
☒ AMENDED (Reason) **OCC Reg'd Plugback**

TYPE OF DRILLING OPERATION

☒ STRAIGHT HOLE ☐ DIRECTIONAL HOLE ☐ HORIZONTAL HOLE
☐ SERVICE WELL

If directional or horizontal, see reverse for bottom hole location.

COUNTY KAY	SEC 34	TWP 26N	RGE 1W	SPUD DATE 6/16/2013
LEASE NAME Tonkawa SWD	WELL NO. 1	DATE OF WELL COMPLETION 7/29/2013	DRLG FINISHED DATE 6/30/2013	
NE 1/4 NE 1/4 SE 1/4 NW 1/4	F8C OF 1/4 SEC 140	F8C OF 1/4 SEC 325	1st PROD DATE	
ELEVATION 0	Ground 0	Latitude (if known) 36.6914368	RECOMP DATE 8/21/2015	
Derrick FL 0		Longitude (if known) 97.2925987		
OPERATOR NAME TONKAWA SALTWATER DISPOSAL, LLC		OTC/OCC OPERATOR NO. 23200		
ADDRESS PO BOX 97 13600 E. US HWY 60				
CITY TONKAWA		STATE OK	ZIP 74653	

RECEIVED

FEB 07 2018

OKLAHOMA CORPORATION COMMISSION

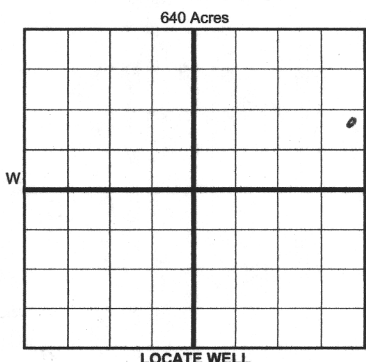

COMPLETION TYPE

<input checked="" type="checkbox"/> SINGLE ZONE
<input type="checkbox"/> MULTIPLE ZONE
Application Date
<input type="checkbox"/> COMMINGLED
Application Date
LOCATION
EXCEPTION ORDER
INCREASED DENSITY
ORDER NO.

CASING & CEMENT (Form 1002C must be attached)

TYPE	SIZE	WEIGHT	GRADE	FEET	PSI	SAX	TOP OF CMT
CONDUCTOR	20"	68#	N/A	85'42"	200	100	Surface
SURFACE	13 7/8"	545	J-55	420'	425	200/200 400	Surface
INTERMEDIATE							
PRODUCTION	9 5/8"	36#	J-55	4877		250/250 1150	Surface
LINER Tubing	2 3/4"	26#	L-80	0-4834			4834

PACKER @ **4840** BRAND & TYPE **Model R**

PLUG @ **5851** TYPE **Cement**

PLUG @ TYPE

TOTAL DEPTH **5888**

PACKER @ BRAND & TYPE

PLUG @ TYPE

PLUG @ TYPE

5975

COMPLETION & TEST DATA BY PRODUCING FORMATION **169A BCK**

FORMATION	Arbuckle
SPACING & SPACING ORDER NUMBER	
CLASS: Oil, Gas, Dry, Inj, Disp, Comm Disp, Svc	Commercial Disposal
PERFORATED INTERVALS	Open hole Completed
ACID/VOLUME	3000gal 20% HCL
FRACTURE TREATMENT (Fluids/Prop Amounts)	

Min Gas Allowable (165:10-17-7)

OR

Oil Allowable (165:10-13-3)

Gas Purchaser/Measurer

First Sales Date

INITIAL TEST DATA

INITIAL TEST DATE	
OIL-BBL/DAY	
OIL-GRAVITY (API)	
GAS-MCF/DAY	
GAS-OIL RATIO CU FT/BBL	
WATER-BBL/DAY	
PUMPING OR FLOWING	
INITIAL SHUT-IN PRESSURE	
CHOKE SIZE	
FLOW TUBING PRESSURE	

AS SUBMITTED

A record of the formations drilled through, and pertinent remarks are presented on the reverse. I declare that I have knowledge of the contents of this report and am authorized by my organization to make this report, which was prepared by me or under my supervision and direction, with the data and facts stated herein to be true, correct, and complete to the best of my knowledge and belief.

Jeffrey D. Andrews

SIGNATURE

Jeffrey D. Andrews

NAME (PRINT OR TYPE)

2/7/2018 405.623.9749

DATE

PHONE NUMBER

P.O. BOX 97 Tonkawa, OK

ADDRESS

74653

CITY

STATE

ZIP

wpcdlco@yahoo.com

EMAIL ADDRESS

PLEASE TYPE OR USE BLACK INK ONLY
FORMATION RECORD

Give formation names and tops, if available, or descriptions and thickness of formations drilled through. Show intervals cored or drillstem tested.

LEASE NAME _____ WELL NO. _____

NAMES OF FORMATIONS	TOP
Arbuckle	4330

FOR COMMISSION USE ONLY	
ITD on file <input type="checkbox"/> YES <input type="checkbox"/> NO	
APPROVED _____	DISAPPROVED _____
2) Reject Codes	

Were open hole logs run?	<input checked="" type="checkbox"/> yes <input type="checkbox"/> no
Date Last log was run	7-15-2013
Was CO ₂ encountered?	<input type="checkbox"/> yes <input checked="" type="checkbox"/> no at what depths? _____
Was H ₂ S encountered?	<input type="checkbox"/> yes <input checked="" type="checkbox"/> no at what depths? _____
Were unusual drilling circumstances encountered?	<input type="checkbox"/> yes <input type="checkbox"/> no
If yes, briefly explain below	

Other remarks: 8-21-2015 9 sacks of Cement were dumped and bailed into the well spotting a 37' cement plug from 5851 to 5888. The above total of 124' plug back meets OCC current rule for Arbuckle Injection wells UIC Permit
1306650002
OCC-This well is an open hole completion from bottom of 9 5/8" casing at 4877' to top of cement plug at 5851'

640 Acres

If more than three drainholes are proposed, attach a separate sheet indicating the necessary information.

Direction must be stated in degrees azimuth.
Please note, the horizontal drainhole and its end point must be located within the boundaries of the lease or spacing unit.

Directional surveys are required for all drainholes and directional wells.

640 Acres

BOTTOM HOLE LOCATION FOR DIRECTIONAL HOLE

SEC	TWP	RGE	COUNTY
Spot Location	1/4	1/4	1/4
Measured Total Depth	True Vertical Depth		BHL From Lease, Unit, or Property Line:
Feet From 1/4 Sec Lines	FSL	FWL	

BOTTOM HOLE LOCATION FOR HORIZONTAL HOLE: (LATERALS)

LATERAL #1			
SEC	TWP	RGE	COUNTY
Spot Location	1/4	1/4	1/4
Depth of Deviation	Radius of Turn		Direction
Measured Total Depth	True Vertical Depth		BHL From Lease, Unit, or Property Line:
Feet From 1/4 Sec Lines	FSL	FWL	
Total Length			

LATERAL #2			
SEC	TWP	RGE	COUNTY
Spot Location	1/4	1/4	1/4
Depth of Deviation	Radius of Turn		Direction
Measured Total Depth	True Vertical Depth		BHL From Lease, Unit, or Property Line:
Feet From 1/4 Sec Lines	FSL	FWL	
Total Length			

LATERAL #3			
SEC	TWP	RGE	COUNTY
Spot Location	1/4	1/4	1/4
Depth of Deviation	Radius of Turn		Direction
Measured Total Depth	True Vertical Depth		BHL From Lease, Unit, or Property Line:
Feet From 1/4 Sec Lines	FSL	FWL	
Total Length			