

Oklahoma Corporation Commission
Oil & Gas Conservation Division
Post Office Box 52000
Oklahoma City, Oklahoma 73152-2000
Rule 165: 10-3-25

Form 1002A

API No.: 35049218350001

Completion Report

Spud Date: November 25, 1981

OTC Prod. Unit No.:

Drilling Finished Date: December 03, 1981

Amended

1st Prod Date: December 22, 1981

Amend Reason: TEMPORARILY ABANDONED WELL

Completion Date: December 22, 1981

Recomplete Date: February 02, 2018

Drill Type: STRAIGHT HOLE

Well Name: THOMPSON 4

Purchaser/Measurer:

Location: GARVIN 16 3N 1W
C SW SE
660 FSL 660 FWL of 1/4 SEC
Derrick Elevation: 917 Ground Elevation: 907

First Sales Date:

Operator: LARIO OIL AND GAS COMPANY 1259

301 S MARKET ST
WICHITA, KS 67202-3805

Completion Type		Location Exception		Increased Density	
X	Single Zone	Order No		Order No	
	Multiple Zone	There are no Location Exception records to display.		There are no Increased Density records to display.	
	Commingled				

Casing and Cement							
Type	Size	Weight	Grade	Feet	PSI	SAX	Top of CMT
SURFACE	8 5/8	24	J-55	322		300	SURFACE
PRODUCTION	4 1/2	9.5	J-55	4720		350	3496

Liner								
Type	Size	Weight	Grade	Length	PSI	SAX	Top Depth	Bottom Depth
There are no Liner records to display.								

Total Depth: 4770

Packer	
Depth	Brand & Type
There are no Packer records to display.	

Plug	
Depth	Plug Type
There are no Plug records to display.	

Initial Test Data										
Test Date	Formation	Oil BBL/Day	Oil-Gravity (API)	Gas MCF/Day	Gas-Oil Ratio Cu FT/BBL	Water BBL/Day	Pumpin or Flowing	Initial Shut-In Pressure	Choke Size	Flow Tubing Pressure
There are no Initial Data records to display.										

Completion and Test Data by Producing Formation			
Formation Name: VIOLA		Code: 202VIOL	Class: TA
Spacing Orders		Perforated Intervals	
Order No	Unit Size	From	To
208444	40	4552	4610
Acid Volumes		Fracture Treatments	
There are no Acid Volume records to display.		There are no Fracture Treatments records to display.	

Formation	Top
B / PENN - TOP VIOLA	4564

Were open hole logs run? No
Date last log run:

Were unusual drilling circumstances encountered? No
Explanation:

Other Remarks
There are no Other Remarks.

FOR COMMISSION USE ONLY	
Status: Accepted	1138844

API NO. 049-21835
OTC PROD.
UNIT NO.

PLEASE TYPE OR USE BLACK INK ONLY

NOTE:

Attach copy of original 1002A
if recompletion or reentry.

OKLAHOMA CORPORATION COMMISSION
Oil & Gas Conservation Division
Post Office Box 52000
Oklahoma City, Oklahoma 73152-2000
Rule 165:10-3-25

FEB 04 2018

Form 1002A
Rev. 2009

☐ ORIGINAL
☒ AMENDED (Reason)

T.A. well

COMPLETION REPORT

TYPE OF DRILLING OPERATION

☒ STRAIGHT HOLE ☐ DIRECTIONAL HOLE ☐ HORIZONTAL HOLE
☐ SERVICE WELL

If directional or horizontal, see reverse for bottom hole location.

COUNTY	Garvin	SEC	16	TWP	3N	RGE	1W	SPUD DATE	11/25/1981
LEASE NAME	Thompson	WELL NO.	4	DATE OF WELL COMPLETION	12/22/1981	1st PROD DATE			12/22/1981
1/4	1/4 SW 1/4 SE 1/4	FSL OF 1/4 SEC	660	FSL OF 1/4 SEC	660	RECOMP DATE			2-2-2018
ELEVATION	917	Ground	907	Latitude (if known)		Longitude (if known)			
OPERATOR NAME	Lario Oil & Gas Company				OTC/OCC OPERATOR NO.	1259			
ADDRESS	301 South Market								
CITY	Wichita	STATE	KS	ZIP	67202				

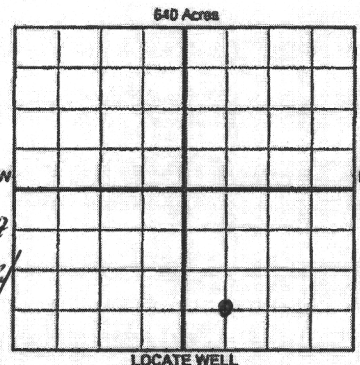

COMPLETION TYPE

<input checked="" type="checkbox"/> SINGLE ZONE
<input type="checkbox"/> MULTIPLE ZONE
Application Date
<input type="checkbox"/> COMINGLED
Application Date
LOCATION EXCEPTION
ORDER NO.
INCREASED DENSITY
ORDER NO.

CASING & CEMENT (Form 1002C must be attached)

TYPE	SIZE	WEIGHT	GRADE	FEET	PSI	SAX	TOP OF CMT
CONDUCTOR							
SURFACE	8 5/8"	24	J-55	322		300	SURFACE
INTERMEDIATE							
PRODUCTION	4 1/2"	9.5	J-55	4,720'		350	3,496'
LINER							
						TOTAL DEPTH	4770

PACKER @ _____ BRAND & TYPE _____ PLUG @ _____ TYPE _____ PLUG @ _____ TYPE _____
PACKER @ _____ BRAND & TYPE _____ PLUG @ _____ TYPE _____ PLUG @ _____ TYPE _____

COMPLETION & TEST DATA BY PRODUCING FORMATION 202 VIOL

FORMATION	Viola					
SPACING & SPACING ORDER NUMBER	40/208444					
CLASS: Oil, Gas, Dry, Inj, Disp, Comm Disp, Svc	Oil & Gas TA					
PERFORATED INTERVALS	4,552' - 4,610'					
ACID VOLUME						
FRACTURE TREATMENT (Fluids/Prop Amounts)						

Min Gas Allowable

(165:10-17-7)

Gas Purchaser/Measurer

First Sales Date

INITIAL TEST DATA

INITIAL TEST DATE	12/22/1981					
OIL-BBL/DAY	90					
OIL-GRAVITY (API)	38					
GAS-MCF/DAY	270,000					
GAS-OIL RATIO CU FT/BBL						
WATER-BBL/DAY	76					
PUMPING OR FLOWING	Flowing					
INITIAL SHUT-IN PRESSURE						
CHOKE SIZE	17/64					
FLOW TUBING PRESSURE	270					

AS SUBMITTED

RECEIVED

FEB 09 2018

OKLAHOMA CORPORATION COMMISSION
DUNCAN OFFICE

A record of the formations drilled through, and pertinent remarks are presented on the reverse. I declare that I have knowledge of the contents of this report and am authorized by my organization to make this report, which was prepared by me or under my supervision and direction, with the data and facts stated herein to be true, correct, and complete to the best of my knowledge and belief.

SIGNATURE: David Munro NAME (PRINT OR TYPE): DAVID MUNRO DATE: 2/7/2018 PHONE NUMBER: 314 265 5611
ADDRESS: 301 S. Market CITY: Wichita STATE: KS ZIP: 67202 EMAIL ADDRESS: dmunro@lariooil.com

Give formation names and tops, if available, or descriptions and thickness of formations drilled through. Show intervals cored or drillstem tested.

WELL NO. _____

NAMES OF FORMATIONS	TOP
B/Penn-Top Viola	4,564'

FOR COMMISSION USE ONLY	
ITD on file	<input type="checkbox"/> YES <input type="checkbox"/> NO
APPROVED	DISAPPROVED
2) Reject Codes	

Were open hole logs run? ☐ yes ☒ no

Date Last log was run _____

Was CO₂ encountered? ☐ yes ☒ no at what depths? _____

Was H₂S encountered? ☐ yes ☒ no at what depths? _____

Were unusual drilling circumstances encountered? ☐ yes ☒ no

If yes, briefly explain below _____

Other remarks:

A blank 10x10 grid for graphing, consisting of 10 columns and 10 rows of squares.

Direction must be stated in degrees azimuth.
Please note, the horizontal drainhole and its end
point must be located within the boundaries of the
lease or spacing unit.

SEC	TWP	RGE	COUNTY		
Spot Location			Feet From 1/4 Sec Lines		FSL
1/4	1/4	1/4	1/4	FWL	
Measured Total Depth		True Vertical Depth		BHL From Lease, Unit, or Property Line:	

LATERAL #1						
SEC	TWP	RGE	COUNTY			
Spot Location						
1/4	1/4	1/4	Feet From 1/4 Sec Lines	FSL	FWL	
Depth of Deviation	Radius of Turn		Direction		Total Length	
Measured Total Depth	True Vertical Depth		BHL From Lease, Unit, or Property Line:			

SEC	TWP	RGE	COUNTY
Spot Location			
1/4	1/4	1/4	1/4
Depth of Deviation		Radius of Turn	Direction
Measured Total Depth		True Vertical Depth	Total Length
		BRL From Lease, Unit, or Property Line:	

RECEIVED

SEC	TWP	RGE	COUNTY	FEB 09 2018	
Spot Location			Feet From 1/4 Sec Lines	FSL	FWL
1/4	1/4	1/4	1/4	OKLAHOMA CORPORATION COMMISSION DUNCAN OFFICE	
Depth of Deviation		Radius of Turn	Direction	Length	
Measured Total Depth		True Vertical Depth	BHL From Lease, Unit, or Property Line:		

RECEIVED

FEB 09 2018

OKLAHOMA
CORPORATION COMMISSION
DUNCAN OFFICE