

Oklahoma Corporation Commission
Oil & Gas Conservation Division
Post Office Box 52000
Oklahoma City, Oklahoma 73152-2000
Rule 165: 10-3-25

Form 1002A

API No.: 35125239160001

Completion Report

Spud Date: November 13, 2016

OTC Prod. Unit No.:

Drilling Finished Date: November 24, 2016

1st Prod Date: November 01, 2017

Completion Date: November 01, 2017

Drill Type: HORIZONTAL HOLE

Well Name: SOUTH HOTULKE UNIT 27-2

Purchaser/Measurer:

Location: POTTAWATOMIE 19 9N 5E
SE SW SW SW
225 FSL 540 FWL of 1/4 SEC
Derrick Elevation: 926 Ground Elevation: 910

First Sales Date:

Operator: TCINA INC 11432
PO BOX 470
201 N 2ND ST
SEMINOLE, OK 74818-0470

Completion Type		Location Exception		Increased Density	
X	Single Zone	Order No		Order No	
	Multiple Zone	There are no Location Exception records to display.		There are no Increased Density records to display.	
	Commingled				

Casing and Cement							
Type	Size	Weight	Grade	Feet	PSI	SAX	Top of CMT
CONDUCTOR	16			40			SURFACE
SURFACE	9 5/8	36	J-55	740	1000	311	SURFACE
PRODUCTION	7	26	USED	4522	1000	210	3222

Liner								
Type	Size	Weight	Grade	Length	PSI	SAX	Top Depth	Bottom Depth
There are no Liner records to display.								

Total Depth: 6410

Packer		Plug	
Depth	Brand & Type	Depth	Plug Type
There are no Packer records to display.		There are no Plug records to display.	

Initial Test Data

Test Date	Formation	Oil BBL/Day	Oil-Gravity (API)	Gas MCF/Day	Gas-Oil Ratio Cu FT/BBL	Water BBL/Day	Pumpin or Flowing	Initial Shut-In Pressure	Choke Size	Flow Tubing Pressure
Nov 01, 2017	HUNTON	95	40	38	400	46	PUMPING			

Completion and Test Data by Producing Formation	
Formation Name: HUNTON	Code: 269HNTN
Class: OIL	

Spacing Orders	
Order No	Unit Size
313834	UNIT

Perforated Intervals	
From	To
There are no Perf. Intervals records to display.	

Acid Volumes	
25,000 GALLONS	

Fracture Treatments	
NONE	

Formation	Top
HENRIETTA COAL	3451
EARLSBORO	3646
WOODFORD	3998
HUNTON	4124

Were open hole logs run? No

Date last log run:

Were unusual drilling circumstances encountered? No

Explanation:

Other Remarks
OCC - THIS WELL IS AN OPEN HOLE COMPLETION FROM BOTTOM OF THE 7" CASING AT 4,522' TO TERMINUS AT 6,410'. THIS WELL'S COMPLETION INTERVAL IS AT A LEGAL LOCATION TO THE UNIT.

Lateral Holes
Sec: 30 TWP: 9N RGE: 5E County: POTTAWATOMIE SE SW SW NW 188 FSL 595 FWL of 1/4 SEC Depth of Deviation: 3180 Radius of Turn: 900 Direction: 180 Total Length: 1888 Measured Total Depth: 6410 True Vertical Depth: 4188 End Pt. Location From Release, Unit or Property Line: 188

FOR COMMISSION USE ONLY	
Status: Accepted	1138811

API NO. 125-23916
OTC PROD.
UNIT NO.

PLEASE TYPE OR USE BLACK INK ONLY

NOTE:

Attach copy of original 1002A
if recompletion or reentry.

OKLAHOMA CORPORATION COMMISSION

Oil & Gas Conservation Division

Post Office Box 52000

Oklahoma City, Oklahoma 73152-2000

Rule 165:10-3-25

RECEIVED

JAN 31 2018

OKLAHOMA CORPORATION
COMMISSION

Form 1002A
Rev. 2009

☒ ORIGINAL
☐ AMENDED (Reason)

COMPLETION REPORT

TYPE OF DRILLING OPERATION

☐ STRAIGHT HOLE ☐ DIRECTIONAL HOLE ☒ HORIZONTAL HOLE
☐ SERVICE WELL

If directional or horizontal, see reverse for bottom hole location.

COUNTY	Pottawatomie	SEC	19	TWP	9N	RGE	5E	SPUD DATE	11-13-2016
LEASE NAME	South Hotulke Unit				WELL NO.	27-2	1st PROD DATE	11-1-2017	
SE 1/4 SW 1/4 SW 1/4 SW 1/4	FSL OF 1/4 SEC	225	FWL OF 1/4 SEC	540	DATE OF WELL COMPLETION	11-1-2017			
ELEVATION Derrick FL	926	Ground	910	Latitude (if known)	35 13'56.3705		Longitude (if known)	96 49' 22.8216	
OPERATOR NAME	Tcina, Inc				OTC/OCC OPERATOR NO.	11432			
ADDRESS	PO Box 470								
CITY	Seminole			STATE	OK	ZIP	74818		

640 Acres

W										E
X										

LOCATE WELL

COMPLETION TYPE

<input checked="" type="checkbox"/> SINGLE ZONE	Unit 313834
<input type="checkbox"/> MULTIPLE ZONE	
<input type="checkbox"/> COMMINGLED	
<input type="checkbox"/> LOCATION EXCEPTION	
<input type="checkbox"/> ORDER NO.	
<input type="checkbox"/> INCREASED DENSITY	
<input type="checkbox"/> ORDER NO.	

CASING & CEMENT (Form 1002C must be attached)

TYPE	SIZE	WEIGHT	GRADE	FEET	PSI	SAX	TOP OF CMT
CONDUCTOR	16			40			Surf
SURFACE	9 5/8	36	J55	740	1000	311	Surf
INTERMEDIATE							
PRODUCTION	7	26	Used	4522	1000	210	3222
LINER							
TOTAL DEPTH							6,410

PACKER @ _____ BRAND & TYPE _____ PLUG @ _____ TYPE _____ PLUG @ _____ TYPE _____
PACKER @ _____ BRAND & TYPE _____ PLUG @ _____ TYPE _____ PLUG @ _____ TYPE _____

COMPLETION & TEST DATA BY PRODUCING FORMATION

FORMATION	Hunton								
SPACING & SPACING ORDER NUMBER	(Unit) 313834								
CLASS: Oil, Gas, Dry, Inj, Disp, Comm Disp, Svc	Oil								
PERFORATED INTERVALS	Open Hole								
	4522-6410								
ACID/VOLUME	25000 Gal								
FRACTURE TREATMENT (Fluids/Prop Amounts)	None								

Min Gas Allowable (165:10-17-7)

Gas Purchaser/Measurer

☐

OR

First Sales Date

INITIAL TEST DATA

Oil Allowable (165:10-13-3)

INITIAL TEST DATE	11/1/2017								
OIL-BBL/DAY	95								
OIL-GRAVITY (API)	40								
GAS-MCF/DAY	38								
GAS-OIL RATIO CU FT/BBL	400								
WATER-BBL/DAY	46								
PUMPING OR FLOWING	pumping								
INITIAL SHUT-IN PRESSURE									
CHOKE SIZE									
FLOW TUBING PRESSURE									

AS SUBMITTED

A record of the formations drilled through, and pertinent remarks are presented on the reverse. I declare that I have knowledge of the contents of this report and am authorized by my organization to make this report, which was prepared by me or under my supervision and direction, with the data and facts stated herein to be true, correct, and complete to the best of my knowledge and belief.

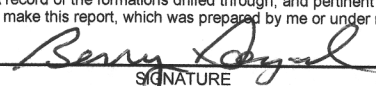
	Berry Doyal	1/30/2017	405-382-0399
SIGNATURE	NAME (PRINT OR TYPE)	DATE	PHONE NUMBER
PO Box 470	Seminole OK 74818		tcina@sbcglobal.net
ADDRESS	CITY STATE ZIP		EMAIL ADDRESS

PLEASE TYPE OR USE BLACK INK ONLY

FORMATION RECORD

Give formation names and tops, if available, or descriptions and thickness of formations drilled through. Show intervals cored or drillstem tested.

NAMES OF FORMATIONS		TOP
Henrieta Coal	3456	3,451
Earlsboro	3670	3,646
Woodford	4156	3998
Hunton	4479	4,124
	MD	TVD

LEASE NAME South Hotulke UnitWELL NO. 27-2

FOR COMMISSION USE ONLY		
ITD on file	<input type="checkbox"/> YES	<input type="checkbox"/> NO
APPROVED	DISAPPROVED	
2) Reject Codes		

Were open hole logs run?	<input type="checkbox"/> yes	<input checked="" type="checkbox"/> no
Date Last log was run		
Was CO ₂ encountered?	<input type="checkbox"/> yes	<input checked="" type="checkbox"/> no at what depths? <u> </u>
Was H ₂ S encountered?	<input type="checkbox"/> yes	<input checked="" type="checkbox"/> no at what depths? <u> </u>
Were unusual drilling circumstances encountered?	<input type="checkbox"/> yes	<input checked="" type="checkbox"/> no
If yes, briefly explain below: <u> </u>		

Other remarks:

OCC - This well is an open hole completion from bottom of the 7" casing at 4522' to terminus at 6410'

640 Acres

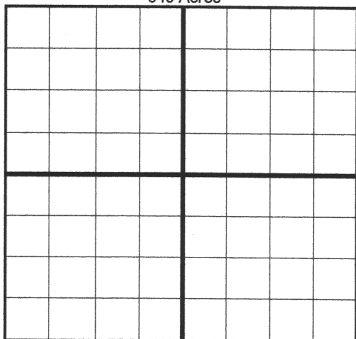

If more than three drainholes are proposed, attach a separate sheet indicating the necessary information.

Direction must be stated in degrees azimuth.
Please note, the horizontal drainhole and its end point must be located within the boundaries of the lease or spacing unit.

Directional surveys are required for all drainholes and directional wells.

640 Acres

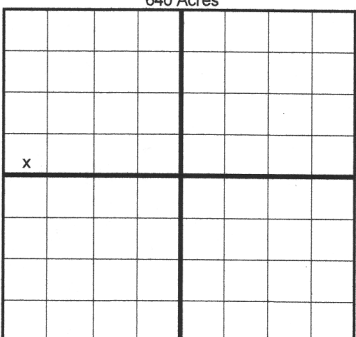

BOTTOM HOLE LOCATION FOR DIRECTIONAL HOLE

SEC	TWP	RGE	COUNTY
Spot Location			
1/4	1/4	1/4	1/4
Measured Total Depth		True Vertical Depth	BHL From Lease, Unit, or Property Line:

BOTTOM HOLE LOCATION FOR HORIZONTAL HOLE: (LATERALS)

LATERAL #1			
SEC	TWP	RGE	COUNTY
30	9N	5E	Pottawatomie
Spot Location			
SE 1/4	SW 1/4	SW 1/4	NW 1/4
Depth of Deviation		Radius of Turn	Direction
3,180		900	180
Measured Total Depth		True Vertical Depth	BHL From Lease, Unit, or Property Line:
6,410		4,188	188

LATERAL #2

SEC	TWP	RGE	COUNTY
Spot Location			
1/4	1/4	1/4	1/4
Depth of Deviation		Radius of Turn	Direction
Measured Total Depth		True Vertical Depth	BHL From Lease, Unit, or Property Line:

LATERAL #3

SEC	TWP	RGE	COUNTY
Spot Location			
1/4	1/4	1/4	1/4
Depth of Deviation		Radius of Turn	Direction
Measured Total Depth		True Vertical Depth	BHL From Lease, Unit, or Property Line: