

Oklahoma Corporation Commission
Oil & Gas Conservation Division
Post Office Box 52000
Oklahoma City, Oklahoma 73152-2000
Rule 165: 10-3-25

Form 1002A

API No.: 35081242970000

Completion Report

Spud Date: September 20, 2017

OTC Prod. Unit No.: 081-222905

Drilling Finished Date: September 24, 2017

1st Prod Date: October 20, 2017

Completion Date: October 16, 2017

Drill Type: STRAIGHT HOLE

Well Name: STAFFORD 1-11

Purchaser/Measurer:

Location: LINCOLN 11 15N 6E
C NW NE NW
2310 FSL 1650 FWL of 1/4 SEC
Latitude: 35.796204075 Longitude: -96.63962795
Derrick Elevation: 0 Ground Elevation: 916

First Sales Date:

Operator: BLUE DOLPHIN PRODUCTION LLC 20881

13120 N MACARTHUR BLVD
OKLAHOMA CITY, OK 73142-3017

Completion Type	
X	Single Zone
	Multiple Zone
	Commingled

Location Exception
Order No
There are no Location Exception records to display.

Increased Density
Order No
There are no Increased Density records to display.

Casing and Cement							
Type	Size	Weight	Grade	Feet	PSI	SAX	Top of CMT
SURFACE	8 5/8	26	J-55	792		375	SURFACE
PRODUCTION	5 1/2	17	J-55	3696		200	1660

Liner								
Type	Size	Weight	Grade	Length	PSI	SAX	Top Depth	Bottom Depth
There are no Liner records to display.								

Total Depth: 3800

Packer	
Depth	Brand & Type
2065	MODEL R

Plug	
Depth	Plug Type
3520	CIBP

Initial Test Data

Test Date	Formation	Oil BBL/Day	Oil-Gravity (API)	Gas MCF/Day	Gas-Oil Ratio Cu FT/BBL	Water BBL/Day	Pumpin or Flowing	Initial Shut-In Pressure	Choke Size	Flow Tubing Pressure
Oct 16, 2017	BURGESS	2	42			2	PUMPING			
Dec 14, 2017	CLEVELAND	8	44.7			60	PUMPING			

Completion and Test Data by Producing Formation									
Formation Name: CLEVELAND				Code: 405CLVD			Class: OIL		
Spacing Orders				Perforated Intervals					
Order No		Unit Size		From			To		
669179		40		2140			2144		
Acid Volumes				Fracture Treatments					
1,500 GALLONS				There are no Fracture Treatments records to display.					

Formation Name: BURGESS		Code: 404BRGS		Class: DRY	
Spacing Orders		Perforated Intervals			
Order No	Unit Size	From	To		
669179	40	3571	3574		
Acid Volumes		Fracture Treatments			
N/A		633 BARRELS FLUID, 19,000 POUNDS SAND			

Formation	Top
HOGSHOOTER	1762
CHECKERBOARD	2108
CLEVELAND	2136
OSWEGO	2870
BURGESS	3570
MISSISSIPPIAN	3576
WOODFORD	3738

Were open hole logs run? Yes
Date last log run: September 24, 2017

Were unusual drilling circumstances encountered? No
Explanation:

Other Remarks
OCC - OPERATOR SET A PORT COLLAR IN 5 1/2" CASING AT 2,270', USED 100 SACKS CEMENT, LIFTED CEMENT TO 1,660' (SEE 1002C).

FOR COMMISSION USE ONLY
<div>Status: Accepted</div> <div>1138859</div>

API NO. 081-24297
OTC PROD. 081-222905
UNIT NO.

PLEASE TYPE OR USE BLACK INK ONLY

NOTE:

Attach copy of original 1002A
if recompletion or reentry.

OKLAHOMA CORPORATION COMMISSION

Oil & Gas Conservation Division

Post Office Box 52000

Oklahoma City, Oklahoma 73152-2000

Rule 165:10-3-25

COMPLETION REPORT

RECEIVED

FEB 12 2018

OKLAHOMA CORPORATION
COMMISSION

Form 1002A
Rev. 2009

☒ ORIGINAL
☐ AMENDED (Reason)

TYPE OF DRILLING OPERATION

☒ STRAIGHT HOLE ☐ DIRECTIONAL HOLE ☐ HORIZONTAL HOLE
SERVICE WELL

If directional or horizontal, see reverse for bottom hole location.

COUNTY	Lincoln	SEC	11	TWP	15N	RGE	6E	SPUD DATE	9/20/2017
LEASE NAME	Stafford	WELL NO.	1-11	DRLG FINISHED DATE	9/24/2017	DATE OF WELL COMPLETION	10/16/2017	1st PROD DATE	10/20/2017
NW 1/4 NE 1/4 NW 1/4 1/4	FSL OF 1/4 SEC	2310	FWL OF 1/4 SEC	1650	RECOMP DATE				
ELEVATION Derrick FL	Ground	916'	Latitude (if known)	35.796204075	Longitude (if known)	-96.63962795			
OPERATOR NAME	Blue Dolphin Production	OTC/OCC OPERATOR NO.	20881						
ADDRESS	13120 N. MacArthur Blvd.								
CITY	Oklahoma City	STATE	OK	ZIP	73142				

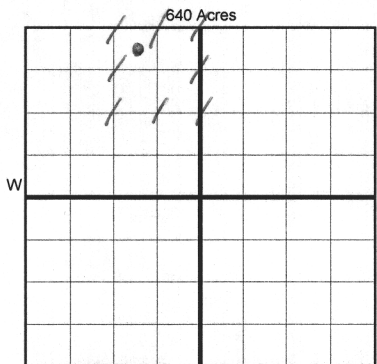

COMPLETION TYPE

<input checked="" type="checkbox"/> SINGLE ZONE
<input type="checkbox"/> MULTIPLE ZONE
Application Date
COMINGLED
Application Date
LOCATION
EXCEPTION ORDER
INCREASED DENSITY
ORDER NO.

CASING & CEMENT (Form 1002C must be attached)

TYPE	SIZE	WEIGHT	GRADE	FEET	PSI	SAX	TOP OF CMT
CONDUCTOR							
SURFACE	8 5/8	26#	J-55	792'		375	Surface
INTERMEDIATE							
PRODUCTION	5 1/2	17#	J-55	3,696'		200 100	1660 3,400
LINER				Port Collar 2,270'			1,660'
							3,800'

PACKER @ 2,065' BRAND & TYPE Model R PLUG @ 3,520' TYPE CIBP PLUG @ TYPE
PACKER @ BRAND & TYPE PLUG @ TYPE PLUG @ TYPE

TOTAL DEPTH

COMPLETION & TEST DATA BY PRODUCING FORMATION 405CLVD / 404BRGS

FORMATION	Cleveland	Burgess	
SPACING & SPACING ORDER NUMBER	669179/40 ac	669179/40 ac	
CLASS: Oil, Gas, Dry, Inj, Disp, Comm Disp, Svc	Oil	Or Dry below Plug	
PERFORATED INTERVALS	2,140' - 2,144'	3,571' - 3,574'	
ACID/VOLUME	1500 Gal	N/A	
FRACTURE TREATMENT (Fluids/Prop Amounts)		633 BBLs Fluid 19,000# Sand	

Reported to Frac Focus

see remarks

☐ Min Gas Allowable (165:10-17-7)
OR
☐ Oil Allowable (165:10-13-3)

Gas Purchaser/Measurer
First Sales Date

INITIAL TEST DATA

INITIAL TEST DATE	12/14/2017	10/16/2017
OIL-BBL/DAY	8	2
OIL-GRAVITY (API)	44.7	42
GAS-MCF/DAY	TSTM	TSTM
GAS-OIL RATIO CU FT/BBL		
WATER-BBL/DAY	60	2
PUMPING OR FLOWING	Pumping	Pumping
INITIAL SHUT-IN PRESSURE		
CHOKE SIZE		
FLOW TUBING PRESSURE		

AS SUBMITTED

A record of the formations drilled through, and pertinent remarks are presented on the reverse. I declare that I have knowledge of the contents of this report and am authorized by my organization to make this report, which was prepared by me or under my supervision and direction, with the data and facts stated herein to be true, correct, and complete to the best of my knowledge and belief.

John S. Clark
SIGNATURE NAME (PRINT OR TYPE) DATE 2/8/2018 PHONE NUMBER (405) 285-5388
13120 N. MacArthur Blvd. OK OK 73142
ADDRESS CITY STATE ZIP EMAIL ADDRESS Jclark@bdebdp.com

Give formation names and tops, if available, or descriptions and thickness of formations drilled through. Show intervals cored or drillstem tested.

FOR COMMISSION USE ONLY	
ITD on file	<input type="checkbox"/> YES <input type="checkbox"/> NO
APPROVED	DISAPPROVED
2) Reject Codes	
<hr/>	
<hr/>	
<hr/>	
<hr/>	
<hr/>	

Were open hole logs run? X yes no

Date Last log was run 9/24/2017

Was CO₂ encountered? yes X no at what depths?

Was H₂S encountered? yes X no at what depths?

Were unusual drilling circumstances encountered? yes X no

If yes, briefly explain below

Other remarks: OCC- operator set a port collar in 5 1/2" casing at 2270' used 100 sacks cement lifted cement to 1660' (see 1002C)

A blank 10x10 grid with a bold cross dividing it into four 5x5 quadrants.

A blank 10x10 grid with a bold cross dividing it into four 5x5 quadrants.

SEC	TWP	RGE	COUNTY
Spot Location			
1/4	1/4	1/4	1/4
Measured Total Depth		True Vertical Depth	BHL From Lease, Unit, or Property Line:

LATERAL #1						
SEC	TWP	RGE	COUNTY			
Spot Location				Feet From 1/4 Sec Lines	FSL	FWL
1/4	1/4	1/4	1/4			
Depth of Deviation		Radius of Turn		Direction	Total Length	
Measured Total Depth		True Vertical Depth		BHL From Lease, Unit, or Property Line:		

SEC	TWP	RGE	COUNTY			
Spot Location				Feet From 1/4 Sec Lines	FSL	FWL
1/4	1/4	1/4	1/4			
Depth of Deviation		Radius of Turn	Direction	Total Length		
Measured Total Depth		True Vertical Depth	BHL From Lease, Unit, or Property Line:			

SEC	TWP	RGE	COUNTY			
Spot Location			Feet From 1/4 Sec Lines		FSL	FWL
1/4	1/4	1/4	1/4			
Depth of Deviation		Radius of Turn	Direction	Total Length		
Measured Total Depth		True Vertical Depth	BHL From Lease, Unit, or Property Line:			