

Oklahoma Corporation Commission
Oil & Gas Conservation Division
Post Office Box 52000
Oklahoma City, Oklahoma 73152-2000
Rule 165: 10-3-25

Form 1002A

API No.: 35037293520000

Completion Report

Spud Date: October 18, 2016

OTC Prod. Unit No.: 037-214780

Drilling Finished Date: November 01, 2016

1st Prod Date: October 03, 2017

Completion Date: December 07, 2016

Drill Type: STRAIGHT HOLE

Min Gas Allowable: Yes

Well Name: BEAR LEASE GRIZZLY 1

Purchaser/Measurer: SCISSORTAIL

Location: CREEK 2 17N 8E
NE SW SW NE
653 FSL 343 FWL of 1/4 SEC
Derrick Elevation: 865 Ground Elevation: 857

First Sales Date: 10/03/2017

Operator: TIDEWATER OPERATING CO INC 19333

7107 S YALE AVE STE 301
TULSA, OK 74136-6308

| Completion Type | | Location Exception | | Increased Density | |
|-----------------|---------------|---|--|--|--|
| X | Single Zone | Order No | | Order No | |
| | Multiple Zone | There are no Location Exception records to display. | | There are no Increased Density records to display. | |
| | Commingled | | | | |

| Casing and Cement | | | | | | | |
|-------------------|-------|--------|-------|------|-----|-----|------------|
| Type | Size | Weight | Grade | Feet | PSI | SAX | Top of CMT |
| SURFACE | 8 5/8 | 23 | J-55 | 744 | | 400 | SURFACE |
| PRODUCTION | 5 1/2 | 15.5 | J-55 | 3598 | | 230 | 2098 |

| Liner | | | | | | | | |
|--|------|--------|-------|--------|-----|-----|-----------|--------------|
| Type | Size | Weight | Grade | Length | PSI | SAX | Top Depth | Bottom Depth |
| There are no Liner records to display. | | | | | | | | |

Total Depth: 3920

| Packer | | Plug | |
|---|--------------|-------|-----------|
| Depth | Brand & Type | Depth | Plug Type |
| There are no Packer records to display. | | 2880 | CIBP |

| Initial Test Data | | | | | | | | | | |
|-------------------|--------------|-------------|-------------------|-------------|-------------------------|---------------|-------------------|--------------------------|------------|----------------------|
| Test Date | Formation | Oil BBL/Day | Oil-Gravity (API) | Gas MCF/Day | Gas-Oil Ratio Cu FT/BBL | Water BBL/Day | Pumpin or Flowing | Initial Shut-In Pressure | Choke Size | Flow Tubing Pressure |
| Dec 12, 2016 | BARTLESVILLE | 12 | 39 | 40 | 3333 | 120 | PUMPING | 360 | | 60 |

Completion and Test Data by Producing Formation

Formation Name: BARTLESVILLE

Code: 404BRVL

Class: OIL

Spacing Orders

| Order No | Unit Size |
|----------|-----------|
| N/A | |

Perforated Intervals

| From | To |
|------|------|
| 2731 | 2739 |

Acid Volumes

| |
|------------------------------|
| 500 GALLONS 7 1/2% HCL / MCA |
|------------------------------|

Fracture Treatments

30 POUNDS 2% KCL, 250 GALLONS 7 1/2% SME, 4,000 GALLONS KCL WITH 6,000 POUNDS 100 MESH SAND, 4,220 GALLONS KCL WITH 9,160 POUNDS 12/20 SAND, 750 GALLONS KCL FLUSH WITH 18 GALLONS 7 1/2% SME, 30 POUNDS 2% KCL

| Formation | Top |
|-------------------|------|
| HOGSHOOTER LIME | 1178 |
| CLEVELAND SAND | 1595 |
| OSWEGO LIME | 2128 |
| PRUE SAND | 2212 |
| VERDIGRIS LIME | 2298 |
| UPPER SKINNER | 2334 |
| MIDDLE SKINNER | 2380 |
| PINK LIME | 2534 |
| RED FORK | 2584 |
| BARTLESVILLE SAND | 2724 |
| MISSISSIPPI | 3108 |
| 1ST WILCOX | 3390 |
| 2ND WILCOX | 3400 |
| ARBUCKLE | 3490 |

Were open hole logs run? Yes

Date last log run: September 01, 2017

Were unusual drilling circumstances encountered? No

Explanation:

Other Remarks

There are no Other Remarks.

FOR COMMISSION USE ONLY

1138846

Status: Accepted

RECEIVED

FEB 12 2018

Form 1002A
Rev. 2009

API
NO. 037-29352
OTC PROD.
UNIT NO. 037-214780

PLEASE TYPE OR USE BLACK INK ONLY

NOTE:

Attach copy of original 1002A
if recompletion or reentry.

OKLAHOMA CORPORATION COMMISSION

Oil & Gas Conservation Division

Post Office Box 52000

Oklahoma City, Oklahoma 73152-2000

Rule 165:10-3-25

OKLAHOMA CORPORATION
COMMISSION

☒ ORIGINAL
☐ AMENDED (Reason)

COMPLETION REPORT

TYPE OF DRILLING OPERATION

☒ STRAIGHT HOLE ☐ DIRECTIONAL HOLE ☐ HORIZONTAL HOLE
☐ SERVICE WELL

If directional or horizontal, see reverse for bottom hole location.

| | | | | | | |
|----------------------|---------------------------------|----------------------|---------|-------------------------|------------|------------|
| COUNTY | Creek | SEC 02 | TWP 17N | RGE 8E | SPUD DATE | 10-18-2016 |
| LEASE NAME | Bear Lease Grizzly | WELL NO. | #1 | DATE OF WELL COMPLETION | 12-07-2016 | |
| NE 1/4 SW 1/4 NE 1/4 | 1/4 SEC 653' | FWL OF 1/4 SEC | 343' | 1st PROD DATE | 10-03-2017 | |
| ELEVATION | 865' Ground 857' | Latitude (if known) | | RECOMP DATE | | |
| Operator NAME | Tidewater Operating, Inc | Longitude (if known) | | | | |
| ADDRESS | 7107 South Yale Ave. Suite #301 | OTC/OCC OPERATOR NO. | 19333 | | | |
| CITY | Tulsa | STATE | OK | ZIP | 74136 | |

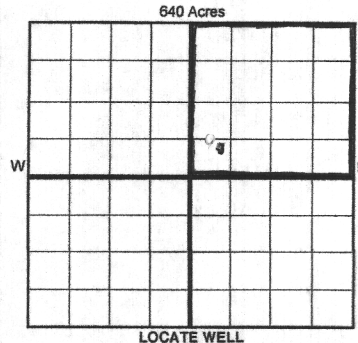

COMPLETION TYPE

| |
|---|
| <input checked="" type="checkbox"/> SINGLE ZONE |
| <input type="checkbox"/> MULTIPLE ZONE |
| Application Date |
| <input type="checkbox"/> COMMINGLED |
| Application Date |
| LOCATION |
| EXCEPTION ORDER |
| INCREASED DENSITY |
| ORDER NO. |

CASING & CEMENT (Form 1002C must be attached)

| TYPE | SIZE | WEIGHT | GRADE | FEET | PSI | SAX | TOP OF CMT |
|--------------|-------|--------|-------|-------|-----|-------------|------------|
| CONDUCTOR | | | | | | | |
| SURFACE | 8 5/8 | 23 # | J55 | 744' | | 400 | Surface |
| INTERMEDIATE | | | | | | | |
| PRODUCTION | 5 1/2 | 15.5 # | J55 | 3598' | | 230 | 2098' |
| LINER | | | | | | | |
| | | | | | | TOTAL DEPTH | 3920' |

PACKER @ _____ BRAND & TYPE GIBB PLUG @ 2880' TYPE CIBP PLUG @ _____ TYPE _____
PACKER @ _____ BRAND & TYPE _____ PLUG @ _____ TYPE _____ PLUG @ _____ TYPE _____

COMPLETION & TEST DATA BY PRODUCING FORMATION

| | | | | | | | | | |
|---|--|--|--|--|--|--|--|--|--|
| FORMATION | Bartlesville | | | | | | | | |
| SPACING & SPACING ORDER NUMBER | N/A | | | | | | | | |
| CLASS: Oil, Gas, Dry, Inj, Disp, Comm Disp, Svc | Oil | | | | | | | | |
| PERFORATED INTERVALS | 2731'-2739' | | | | | | | | |
| ACID/VOLUME | 500 Gal 7 1/2% HCL/MCA | | | | | | | | |
| FRACTURE TREATMENT (Fluids/Prop Amounts) | 30# 2% KCL, 250 Gal 7 1/2% SME 4,000 Gal. KCL w/ 6,000 lb. 100 Mesh SD / 4,220 Gal. KCL w/ 9,600 lb 12/20 SD. 750 Gal. KCL Flush w/ 18 Gal. 7 1/2% SME, 30# 2% KCL | | | | | | | | |

☒ Min Gas Allowable (165:10-17-7) OR Gas Purchaser/Measurer
Oil Allowable (165:10-13-3) First Sales Date Scissor tail
10-03-2017

INITIAL TEST DATA

| | | | | | | | |
|--------------------------|-------------|--|--|--|--|--|--|
| INITIAL TEST DATE | 12-12-2016 | | | | | | |
| OIL-BBL/DAY | 12 BBL/day | | | | | | |
| OIL-GRAVITY (API) | 39° | | | | | | |
| GAS-MCF/DAY | 40 MCF | | | | | | |
| GAS-OIL RATIO CU FT/BBL | 40:12 3333 | | | | | | |
| WATER-BBL/DAY | 120 BBL/day | | | | | | |
| PUMPING OR FLOWING | Pumping | | | | | | |
| INITIAL SHUT-IN PRESSURE | 360 psi | | | | | | |
| CHOKE SIZE | 8 | | | | | | |
| FLOW TUBING PRESSURE | 60 psi | | | | | | |

AS SUBMITTED

A record of the formations drilled through, and pertinent remarks are presented on the reverse. I declare that I have knowledge of the contents of this report and am authorized by my organization to make this report which was prepared by me or under my supervision and direction, with the data and facts stated herein to be true, correct, and complete to the best of my knowledge and belief.

SIGNATURE Carlos B. Langston NAME (PRINT OR TYPE)
DATE 1-08-2018 PHONE NUMBER 918-499-1989
ADDRESS 7107 S. Yale Ave. Suite #301 CITY Tulsa STATE OK ZIP 74136 EMAIL ADDRESS Carlos.langston@cox.net

PLEASE TYPE OR USE BLACK INK ONLY

FORMATION RECORD

Give formation names and tops, if available, or descriptions and thickness of formations drilled through. Show intervals cored or drillstem tested.

| NAMES OF FORMATIONS | TOP |
|---------------------|-------|
| Hogshooter Lime | 1178' |
| Cleveland Sand | 1595' |
| Oswego Lime | 2128' |
| Prue Sand | 2212' |
| Verdigris Lime | 2298' |
| Upper Skinner | 2334' |
| Middle Skinner | 2380' |
| Pink Lime | 2534' |
| Red Fork | 2584' |
| Bartlesville Sand | 2724' |
| Mississippi | 3108' |
| 1st Wilcox | 3390' |
| 2nd Wilcox | 3400' |
| Arbuckle | 3490' |

LEASE NAME Bear lease

WELL NO. Grizzly #1

| FOR COMMISSION USE ONLY | | |
|---|------------------------------|-----------------------------|
| ITD on file | <input type="checkbox"/> YES | <input type="checkbox"/> NO |
| APPROVED | DISAPPROVED | 2) Reject Codes |
| <div style="border-bottom: 1px solid black; height: 15px; width: 100%;"></div> <div style="border-bottom: 1px solid black; height: 15px; width: 100%;"></div> <div style="border-bottom: 1px solid black; height: 15px; width: 100%;"></div> <div style="border-bottom: 1px solid black; height: 15px; width: 100%;"></div> | | |

| | | |
|--|---|--|
| Were open hole logs run? | <input checked="" type="checkbox"/> yes | <input type="checkbox"/> no |
| Date Last log was run | <u>9-01-2017</u> | |
| Was CO ₂ encountered? | <input type="checkbox"/> yes | <input checked="" type="checkbox"/> no at what depths? _____ |
| Was H ₂ S encountered? | <input type="checkbox"/> yes | <input checked="" type="checkbox"/> no at what depths? _____ |
| Were unusual drilling circumstances encountered? | <input type="checkbox"/> yes <input checked="" type="checkbox"/> no | |
| If yes, briefly explain below | | |

Other remarks:

| |
|--|
| |
| |
| |
| |
| |
| |
| |
| |

640 Acres

| | | | | | | | |
|--|--|--|--|--|--|--|--|
| | | | | | | | |
| | | | | | | | |
| | | | | | | | |
| | | | | | | | |
| | | | | | | | |
| | | | | | | | |
| | | | | | | | |
| | | | | | | | |

If more than three drainholes are proposed, attach a separate sheet indicating the necessary information.

Direction must be stated in degrees azimuth. Please note, the horizontal drainhole and its end point must be located within the boundaries of the lease or spacing unit.

Directional surveys are required for all drainholes and directional wells.

640 Acres

| | | | | | | | |
|--|--|--|--|--|--|--|--|
| | | | | | | | |
| | | | | | | | |
| | | | | | | | |
| | | | | | | | |
| | | | | | | | |
| | | | | | | | |
| | | | | | | | |
| | | | | | | | |

BOTTOM HOLE LOCATION FOR DIRECTIONAL HOLE

| SEC | TWP | RGE | COUNTY |
|----------------------|-----|-------------------------|---|
| Spot Location | | Feet From 1/4 Sec Lines | |
| 1/4 | 1/4 | 1/4 | 1/4 |
| Measured Total Depth | | True Vertical Depth | BHL From Lease, Unit, or Property Line: |
| | | | |

BOTTOM HOLE LOCATION FOR HORIZONTAL HOLE: (LATERALS)

| LATERAL #1 | | | |
|----------------------|---------------------|---|--------------|
| SEC | TWP | RGE | COUNTY |
| Spot Location | | Feet From 1/4 Sec Lines | |
| 1/4 | 1/4 | 1/4 | 1/4 |
| Depth of Deviation | Radius of Turn | Direction | Total Length |
| Measured Total Depth | True Vertical Depth | BHL From Lease, Unit, or Property Line: | |
| | | | |

| LATERAL #2 | | | |
|----------------------|---------------------|---|--------------|
| SEC | TWP | RGE | COUNTY |
| Spot Location | | Feet From 1/4 Sec Lines | |
| 1/4 | 1/4 | 1/4 | 1/4 |
| Depth of Deviation | Radius of Turn | Direction | Total Length |
| Measured Total Depth | True Vertical Depth | BHL From Lease, Unit, or Property Line: | |
| | | | |

| LATERAL #3 | | | |
|----------------------|---------------------|---|--------------|
| SEC | TWP | RGE | COUNTY |
| Spot Location | | Feet From 1/4 Sec Lines | |
| 1/4 | 1/4 | 1/4 | 1/4 |
| Depth of Deviation | Radius of Turn | Direction | Total Length |
| Measured Total Depth | True Vertical Depth | BHL From Lease, Unit, or Property Line: | |
| | | | |