

Oklahoma Corporation Commission  
Oil & Gas Conservation Division  
Post Office Box 52000  
Oklahoma City, Oklahoma 73152-2000  
Rule 165: 10-3-25

Form 1002A

API No.: 35015202590002

**Completion Report**

Spud Date: May 21, 1971

OTC Prod. Unit No.:

Drilling Finished Date: June 26, 1971

**Amended**

1st Prod Date: July 02, 1971

Amend Reason: RECOMPLETE TO INJECTION

Completion Date: July 10, 1971

Recomplete Date: November 20, 2017

**Drill Type: STRAIGHT HOLE**

**SERVICE WELL**

Well Name: SCHOOLLAND "A" 7

Purchaser/Measurer:

Location: CADD0 13 5N 9W  
SW SE NE NW  
1437 FSL 2232 FWL of 1/4 SEC  
Derrick Elevation: 1303 Ground Elevation: 1293

First Sales Date:

Operator: HARMON C E OIL INC 10266

5555 E 71ST ST STE 9300  
TULSA, OK 74136-6559

Completion Type		Location Exception		Increased Density	
X	Single Zone	Order No		Order No	
	Multiple Zone	There are no Location Exception records to display.		There are no Increased Density records to display.	
	Commingled				

Casing and Cement							
Type	Size	Weight	Grade	Feet	PSI	SAX	Top of CMT
CONDUCTOR	16			63			SURFACE
SURFACE	8 5/8	24	K-55	857	700	475	SURFACE
PRODUCTION	5 1/2	14	J-55	5899	3000	250	5100

Liner								
Type	Size	Weight	Grade	Length	PSI	SAX	Top Depth	Bottom Depth
LINER	4 1/2	13.04	K-55	0	100	135	SURFACE	5856

**Total Depth: 5900**

Packer		Plug	
Depth	Brand & Type	Depth	Plug Type
5706	AS1X IPC	There are no Plug records to display.	

Initial Test Data
-------------------

Test Date	Formation	Oil BBL/Day	Oil-Gravity (API)	Gas MCF/Day	Gas-Oil Ratio Cu FT/BBL	Water BBL/Day	Pumpin or Flowing	Initial Shut- In Pressure	Choke Size	Flow Tubing Pressure
There are no Initial Data records to display.										

Completion and Test Data by Producing Formation									
Formation Name: SCHOOL LAND				Code: 405SCLD			Class: INJ		
Spacing Orders				Perforated Intervals					
Order No		Unit Size		From			To		
There are no Spacing Order records to display.				5728			5816		
Acid Volumes				Fracture Treatments					
There are no Acid Volume records to display.				There are no Fracture Treatments records to display.					

Formation	Top
SCHOOOLLAND	5726

Were open hole logs run? No

Date last log run:

Were unusual drilling circumstances encountered? No

Explanation:

Other Remarks
UIC PERMIT NUMBER 1805360012. MIT WAS DONE ON JANUARY 24, 2018.

FOR COMMISSION USE ONLY
<div>Status: Accepted</div> <div>1138806</div>

API NO. 01520259  
OTC PROD.  
UNIT NO.

PLEASE TYPE OR USE BLACK INK ONLY

NOTE:

Attach copy of original 1002A  
if recompletion or reentry.

OKLAHOMA CORPORATION COMMISSION

Oil & Gas Conservation Division  
Post Office Box 52000

Oklahoma City, Oklahoma 73152-2000

Rule 165:10-3-25

RECEIVED

JAN 31 2018

OKLAHOMA CORPORATION  
COMMISSION

Form 1002A  
Rev. 2009

☐ ORIGINAL  
☒ AMENDED (Reason)

Recomplete to Injection

COMPLETION REPORT

TYPE OF DRILLING OPERATION

☒ STRAIGHT HOLE ☐ DIRECTIONAL HOLE ☐ HORIZONTAL HOLE  
☒ SERVICE WELL

If directional or horizontal, see reverse for bottom hole location.

COUNTY	Caddo	SEC	13	TWP	5N	RGE	9W	SPUD DATE	5/21/71
LEASE NAME	Schoolland "A"	WELL NO.	7	DRLG FINISHED DATE	6/26/71	DATE OF WELL COMPLETION	7/10/71	1st PROD DATE	7/2/71
SW 1/4 SE 1/4 NE 1/4 NW 1/4	FSL OF 1/4 SEC 1437.97	FWL OF 1/4 SEC 2232.4	RECOMP DATE	11/20/17					
ELEVATION Derrick FL 1303	Ground 1293	Latitude (if known)	Longitude (if known)						
OPERATOR NAME	C. E. Harmon Oil, Inc.	OTC/OCC OPERATOR NO.	10266						
ADDRESS	5555 E. 71st St., Ste 9300								
CITY	Tulsa	STATE	OK	ZIP	74136				

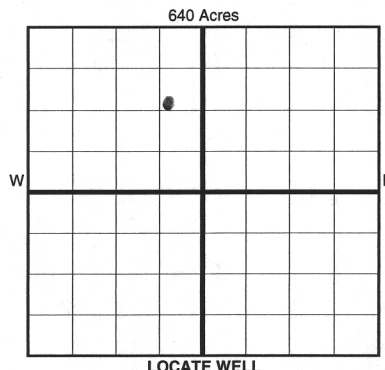

COMPLETION TYPE

<input checked="" type="checkbox"/> SINGLE ZONE
<input type="checkbox"/> MULTIPLE ZONE
<input type="checkbox"/> COMMINGLED
<input type="checkbox"/> LOCATION EXCEPTION ORDER INCREASED DENSITY ORDER NO.

CASING & CEMENT (Form 1002C must be attached)

TYPE	SIZE	WEIGHT	GRADE	FEET	PSI	SAX	TOP OF CMT
CONDUCTOR	16"			63			surface
SURFACE	8 5/8"	24#	K-55	857	700	475	surface
INTERMEDIATE							
PRODUCTION	5 1/2"	14#	J-55	5899	3000	250	5,100
LINER	4 1/2"	13.04#	K-55	5856	100	135	1,500
						TOTAL DEPTH	5,900

PACKER @ 5,706 BRAND & TYPE AS1X IPC PLUG @ TYPE PLUG @ TYPE  
PACKER @ BRAND & TYPE PLUG @ TYPE PLUG @ TYPE

COMPLETION & TEST DATA BY PRODUCING FORMATION 405 SCLD

FORMATION	Schoolland				
SPACING & SPACING ORDER NUMBER					
CLASS: Oil, Gas, Dry, Inj, Disp, Comm Disp, Svc	Inj				
PERFORATED INTERVALS	5728-60, 5764-71				
	5774-98, 5802-16				
ACID/VOLUME					
FRACTURE TREATMENT (Fluids/Prop Amounts)					

Min Gas Allowable (165:10-17-7)

Gas Purchaser/Measurer

☐

OR

First Sales Date

INITIAL TEST DATA

Oil Allowable (165:10-13-3)

INITIAL TEST DATE	1/26/2018				
OIL-BBL/DAY	N/A				
OIL-GRAVITY ( API)	N/A				
GAS-MCF/DAY	N/A				
GAS-OIL RATIO CU FT/BBL	N/A				
WATER-BBL/DAY	N/A				
PUMPING OR FLOWING	N/A				
INITIAL SHUT-IN PRESSURE	N/A				
CHOKE SIZE	N/A				
FLOW TUBING PRESSURE	N/A				

AS SUBMITTED

A record of the formations drilled through, and pertinent remarks are presented on the reverse. I declare that I have knowledge of the contents of this report and am authorized by my organization to make this report, which was prepared by me or under my supervision and direction, with the data and facts stated herein to be true, correct, and complete to the best of my knowledge and belief.

	Robert E. Harmon	1/29/2018	918-663-8515
SIGNATURE	NAME (PRINT OR TYPE)	DATE	PHONE NUMBER
5555 E. 71st St., Ste 9300	Tulsa OK 74136		
ADDRESS	CITY STATE ZIP		
		rehoil@sbcglobal.net	
		EMAIL ADDRESS	

Give formation names and tops, if available, or descriptions and thickness of formations drilled through. Show intervals cored or drillstem tested.

FOR COMMISSION USE ONLY		
ITD on file	<input type="checkbox"/> YES	<input type="checkbox"/> NO
APPROVED <hr/>	DISAPPROVED <hr/>	2) Reject Codes  <hr/> <hr/> <hr/> <hr/> <hr/>

Were open hole logs run?           yes    X no

Date Last log was run      \_\_\_\_\_

Was CO<sub>2</sub> encountered?           yes    X no    at what depths? \_\_\_\_\_

Was H<sub>2</sub>S encountered?           yes    X no    at what depths? \_\_\_\_\_

Were unusual drilling circumstances encountered?           yes    X no

If yes, briefly explain below

Other remarks:	UIC PERMIT NUMBER 1805360012	MIT was done on 1/24/18.

A blank 10x10 grid with a bold cross dividing it into four 5x5 quadrants.

SEC	TWP	RGE	COUNTY		
Spot Location			Feet From 1/4 Sec Lines	FSL	FWL
1/4	1/4	1/4	1/4		
Measured Total Depth		True Vertical Depth	BHL From Lease, Unit, or Property Line:		

LATERAL #1						
SEC	TWP	RGE	COUNTY			
Spot Location						
1/4		1/4		1/4		FWL
Depth of Deviation		Radius of Turn		Feet From 1/4 Sec Lines		FSL
Measured Total Depth		True Vertical Depth		BHL From Lease, Unit, or Property Line:		

SEC	TWP	RGE	COUNTY			
Spot Location						
1/4	1/4	1/4	1/4	Feet From 1/4 Sec Lines	FSL	FWL
Depth of Deviation		Radius of Turn		Direction	Total Length	
Measured Total Depth		True Vertical Depth		BHL From Lease, Unit, or Property Line:		

SEC	TWP	RGE	COUNTY			
Spot Location						
1/4	1/4	1/4	1/4	Feet From 1/4 Sec Lines	FSL	FWL
Depth of Deviation		Radius of Turn		Direction	Total Length	
Measured Total Depth		True Vertical Depth		BHL From Lease, Unit, or Property Line:		