

OKLAHOMA CORPORATION COMMISSION  
OIL & GAS CONSERVATION DIVISION  
P.O. BOX 52000  
OKLAHOMA CITY, OK 73152-2000  
(Rule 165:10-3-1)

API NUMBER: 073 26109

Approval Date: 06/14/2018

Expiration Date: 12/14/2018

Horizontal Hole Oil & Gas

PERMIT TO DRILL

WELL LOCATION: Sec: 12 Twp: 17N Rge: 7W

County: KINGFISHER

SPOT LOCATION: ☐ NE ☐ NE ☐ NW ☐ NW

FEET FROM QUARTER: FROM NORTH FROM WEST

SECTION LINES: 255 1075

Lease Name: HARRIS 12-17-7

Well No: 4HC

Well will be 255 feet from nearest unit or lease boundary.

Operator Name: CHESAPEAKE OPERATING LLC

Telephone: 4059353425; 4059358

OTC/OCC Number: 17441 0

CHESAPEAKE OPERATING LLC  
PO BOX 18496  
OKLAHOMA CITY, OK 73154-0496

EUGENE A. AND BETTY J. HARRIS TRUST  
1205 REGENCY COURT  
KINGFISHER OK 73750

Formation(s) (Permit Valid for Listed Formations Only):

Name	Depth	Name	Depth
1 OSWEGO	6492	6	
2		7	
3		8	
4		9	
5		10	

Spacing Orders: 666142  
634514  
675282  
675894

Location Exception Orders: 674729  
675173  
676156  
676595  
674826

Increased Density Orders: 671101  
671238

Pending CD Numbers:

Special Orders:

Total Depth: 20500

Ground Elevation: 1041

**Surface Casing: 530**

Depth to base of Treatable Water-Bearing FM: 280

Under Federal Jurisdiction: No

Fresh Water Supply Well Drilled: No

Surface Water used to Drill: No

**PIT 1 INFORMATION**

Approved Method for disposal of Drilling Fluids:

Type of Pit System: CLOSED Closed System Means Steel Pits

Type of Mud System: WATER BASED

Chlorides Max: 5000 Average: 3000

Is depth to top of ground water greater than 10ft below base of pit? Y

Within 1 mile of municipal water well? Y

Wellhead Protection Area? Y

Pit is located in a Hydrologically Sensitive Area.

Category of Pit: C

Liner not required for Category: C

Pit Location is AP/TE DEPOSIT

Pit Location Formation: TERRACE

D. One time land application -- (REQUIRES PERMIT) PERMIT NO: 18-34604  
H. CLOSED SYSTEM=STEEL PITS PER OPERATOR REQUEST

This permit does not address the right of entry or settlement of surface damages.

The duration of this permit is SIX MONTHS, except as otherwise provided by Rule 165: 10-3-1.

Rule 165: 10-3-4 (c) (7) (e) - The Operator shall give 24 Hours notice by telephone to the appropriate District Office of the Conservation Division as to when Surface Casing will be run.

# HORIZONTAL HOLE 1

Sec 25 Twp 18N Rge 7W County KINGFISHER

Spot Location of End Point: NW NW NE SW

Feet From: SOUTH 1/4 Section Line: 2311

Feet From: WEST 1/4 Section Line: 1500

Depth of Deviation: 6400

Radius of Turn: 956

Direction: 4

Total Length: 12598

Measured Total Depth: 20500

True Vertical Depth: 6651

End Point Location from Lease,  
Unit, or Property Line: 1500

## Notes:

### Category

### Description

EXCEPTION TO RULE - 674826

6/14/2018 - G58 - (I.O.) 1-17N-7W  
X165:10-3-28(C)(2)(B) OSWG (HARRIS 1-17-7 4HC)  
MAY BE CLOSER THAN 600' TO THE MAYES 2 WELL  
MAY BE CLOSER THAN 600' TO THE GRISHOW 1-1 WELL  
3/19/2018

EXCEPTION TO RULE - 676595

6/14/2018 - G58 - (I.O.) 25-18N-7W  
X165:10-3-28(C)(2)(B) OSWG (HARRIS 1-17-7 4HC)  
MAY BE CLOSER THAN 600' TO THE IRENE CLINE 1 WELL  
4/20/2018

HYDRAULIC FRACTURING

6/7/2018 - G71 - OCC 165:10-3-10 REQUIRES:

1) PRIOR TO COMMENCEMENT OF HYDRAULIC FRACTURING OPERATIONS FOR HORIZONTAL WELLS, NOTICE GIVEN FIVE BUSINESS DAYS IN ADVANCE TO OFFSET OPERATORS WITH WELLS COMPLETED IN THE SAME COMMON SOURCE OF SUPPLY WITHIN 1/2 MILE;

2) WITH NOTICE ALSO GIVEN 48 HOURS IN ADVANCE OF HYDRAULIC FRACTURING ALL WELLS TO BOTH THE OCC CENTRAL OFFICE AND LOCAL DISTRICT OFFICES, USING THE "FRAC NOTICE FORM" FOUND AT THE FOLLOWING LINK: [OCCWEB.COM/OG/OGFORMS.HTML](http://OCCWEB.COM/OG/OGFORMS.HTML); AND,

3) THE CHEMICAL DISCLOSURE OF HYDRAULIC FRACTURING INGREDIENTS FOR ALL WELLS TO BE REPORTED TO FRACFOCUS WITHIN 60 DAYS AFTER THE CONCLUSION THE HYDRAULIC FRACTURING OPERATIONS, USING THE FOLLOWING LINK: [FRACFOCUS.ORG](http://FRACFOCUS.ORG)

INCREASED DENSITY - 671101

6/14/2018 - G58 - 36-18N-7W  
X634514 OSWG  
4 WELLS  
CHESAPEAKE EXPLORATION, L.L.C.  
12/12/2018

INCREASED DENSITY - 671238

6/14/2018 - G58 - 1-17N-7W  
X666142 OSWG  
4 WELLS  
CHESAPEAKE EXPLORATION, L.L.C.  
12/14/2017

LOCATION EXCEPTION - 674729

6/14/2018 - G58 - (I.O.) 1-17N-7W  
X666142 OSWG  
COMPL. INT. NCT 0' FNL, NCT 330' FSL, NCT NCT 660' FWL  
CHESAPEAKE EXPLORATION, L.L.C.  
3/15/2018

LOCATION EXCEPTION - 675173

6/14/2018 - G58 - (I.O.) 36-18N-7W  
X634514 OSWG  
COMPL. INT. NCT 0' FNL, NCT 0' FSL, NCT 660' FWL  
CHESAPEAKE EXPLORATION, L.L.C.  
3/26/2018

This permit does not address the right of entry or settlement of surface damages.

The duration of this permit is SIX MONTHS, except as otherwise provided by Rule 165: 10-3-1.

Rule 165: 10-3-4 (c) (7) (e) - The Operator shall give 24 Hours notice by telephone to the appropriate District Office of the Conservation Division as to when Surface Casing will be run.

073 26109 HARRIS 12-17-7 4HC

Category	Description
LOCATION EXCEPTION - 676156	6/14/2018 - G58 - (I.O.) SW4 25-18N-7W X675282 OSWG COMPL. INT. NCT 330' FNL, NCT 0' FSL, NCT 330' FWL CHESAPEAKE EXPLORATION, L.L.C. 4/11/2018
PUBLIC WATER SUPPLY WELLS	6/7/2018 - G71 - KINGFISHER - 2 PWS/WPA, NE/4 11-17N-7W & 3 PWS/WPA, SW/4 12-17N-7W
SPACING - 634514	6/14/2018 - G58 - (640)(HOR) 36-18N-7W VAC 62850 OSWG S2 & NW4 EST OSWG POE TO BHL NCT 660' FB (COEXIST WITH SP. ORDER 62850 OSWG NE4)
SPACING - 666142	6/14/2018 - G58 - (640)(HOR) 1-17N-7W EXT 649484 OSWG, OTHER POE TO BHL NCT 660' FB (COEXIST WITH SP. ORDER 40411/42259 S2; SP. ORDER 82948 NW4; SP. ORDER 514716 NE4)
SPACING - 675894	6/14/2018 - G58 - (I.O.) 1-17N-7W & 36-18N-7W & SW4 25-18N-7W EST MULTIUNIT HORIZONTAL WELL X666142 OSWG 1-17N-7W X634514 OSWG 36-18N-7W X675282 OSWG SW4 25-18N-7W 40% 1-17N-7W 40% 36-18N-7W 20% SW4 25-18N-7W CHESAPEAKE OPERATING, L.L.C. 5/6/2018
SPACING – 675282	6/14/2018 - G58 - (160)(HOR) SW4 25-18N-7W EST OSWG, OTHER COMPL. INT. NCT 330' FB (COEXIST SP. ORDER 41975 OSWG; SP. ORDER 64150 OTHER)

This permit does not address the right of entry or settlement of surface damages.

The duration of this permit is SIX MONTHS, except as otherwise provided by Rule 165: 10-3-1.

Rule 165: 10-3-4 (c) (7) (e) - The Operator shall give 24 Hours notice by telephone to the appropriate District Office of the Conservation Division as to when Surface Casing will be run.

# CHESAPEAKE ENERGY

OPERATOR: CHESAPEAKE OPERATING, LLC

LEASE NAME: HARRIS 12-17-7

WELL NO. 4HC

STAKED DATE: 2/27/2018

GROUND ELEVATION: 1040.70 GR. AT STAKE

SURFACE HOLE FOOTAGE: 255' FNL - 1075' FWL

SECTION: 12 TOWNSHIP: T17N RANGE: R7W

KINGFISHER COUNTY, STATE: OK

BOTTOM HOLE: 25-T18N-R7W-L.M.

BOTTOM HOLE FOOTAGE: 2311' FSL - 1500' FWL

LANDING POINT FOOTAGE: 500' FSL - 1500' FWL

ACCESSIBILITY TO LOCATION: FROM WEST LINE

TOPOGRAPHY & VEGETATION: LOCATION FELL ON THE NORTH EDGE OF A FIELD.

DISTANCE & DIRECTION FROM HWY JCT OR TOWN:  
FROM THE TOWN OF DOVER HEAD SOUTH ON US-81  
±0.2MI TO E BOUNDARY ST AKA E0715RD, HEAD EAST  
±0.2MI TO N2860RD, HEAD SOUTH ±0.6MI TO AN  
EXISTING LEASE RD TO THE EAST, HEAD EAST ON LEASE  
RD ±0.2MI, PAD SITE IS TO THE NORTH.

## GRAPHIC SCALE IN FEET

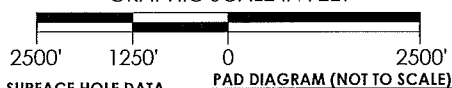

## SURFACE HOLE DATA

STATE PLANE COORDINATES:

ZONE: OK-NORTH NAD27

X: 2028417.2

Y: 353239.4

GPS DATUM: NAD27

LAT: 35.97037997

LONG: -97.90396835

STATE PLANE COORDINATES:

ZONE: OK-NORTH NAD83

X: 1996818.0

Y: 353263.4

GPS DATUM: NAD83

LAT: 35.97042046

LONG: -97.90430119

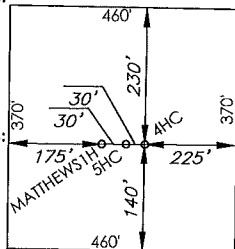

## BOTTOM HOLE DATA

STATE PLANE COORDINATES:

ZONE: OK-NORTH NAD27

X: 2028847.8

Y: 366594.5

GPS DATUM: NAD27

LAT: 36.00706747

LONG: -97.90246800

STATE PLANE COORDINATES:

ZONE: OK-NORTH NAD83

X: 1997248.5

Y: 366618.4

GPS DATUM: NAD83

LAT: 36.00710709

LONG: -97.90280143

## LANDING POINT DATA

STATE PLANE COORDINATES:

ZONE: OK-NORTH NAD27

X: 2028846.8

Y: 353996.6

GPS DATUM: NAD27

LAT: 35.97245882

LONG: -97.90251418

STATE PLANE COORDINATES:

ZONE: OK-NORTH NAD83

X: 1997247.6

Y: 354020.5

GPS DATUM: NAD83

LAT: 35.97249926

LONG: -97.90284702

PLEASE NOTE THAT THIS LOCATION WAS STAKED ON THE GROUND UNDER THE SUPERVISION OF A LICENSED PROFESSIONAL LAND SURVEYOR, BUT ACCURACY OF THIS EXHIBIT IS NOT GUARANTEED. PLEASE CONTACT CRAFTON TULL PROMPTLY IF ANY INCONSISTENCY IS DETERMINED. GPS DATA IS OBSERVED FROM RTK-GPS. NOTE: X AND Y DATA SHOWN HEREON FOR SECTION CORNERS MAY NOT HAVE BEEN SURVEYED ON THE GROUND, AND FURTHER, DOES NOT REPRESENT A TRUE BOUNDARY SURVEY. LANDING POINT, BOTTOM HOLE, AND DRILL PATH INFORMATION PROVIDED BY OPERATOR LISTED.

## CERTIFICATION:

THIS IS TO CERTIFY THAT THIS WELL LOCATION EXHIBIT WAS COMPILED AND PREPARED UNDER MY SUPERVISION.  
2018.04.17 09:58:07-05'00'

*Denver Winchester*  
DENVER WINCHESTER PLS 1952

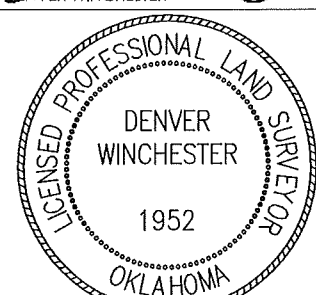

## HARRIS 12-17-7 4HC

REVISION DATE:

R1 4/13/18

PART OF THE NW/4 OF  
SECTION 12, T17N, R7W  
WELL LOCATION EXHIBIT  
KINGFISHER COUNTY, OKLAHOMA

SCALE: 1" = 2500'

PLOT DATE: 04-13-2018

DRAWING: 17601113-WELL-P

DRAWN BY: SQ

SHEET NO.: 3 OF 3



300 Pointe Parkway Blvd  
Yukon, OK 73099  
405.787.6270 t 405.787.6276 f  
www.craftontull.com

**Crafton Tull**  
SURVEYING  
CERTIFICATE OF AUTHORIZATION:  
CA 973 (PE/LS) EXPIRES 6/30/2018