

Oklahoma Corporation Commission  
Oil & Gas Conservation Division  
Post Office Box 52000  
Oklahoma City, Oklahoma 73152-2000  
Rule 165: 10-3-25

Form 1002A

API No.: 35151239660002

**Completion Report**

Spud Date: October 23, 2013

OTC Prod. Unit No.:

Drilling Finished Date: November 10, 2013

**Amended**

1st Prod Date:

Amend Reason: SHOW FORMATIONS AND TOPS PENETRATED

Completion Date: November 15, 2013

**Drill Type: STRAIGHT HOLE**

**SERVICE WELL**

Well Name: OL' FAITHFUL SWD 13

Purchaser/Measurer:

Location: WOODS 13 27N 16W  
E2 SE SE SE  
330 FSL 250 FEL of 1/4 SEC  
Derrick Elevation: 0 Ground Elevation: 0

First Sales Date:

Operator: CHAPARRAL ENERGY LLC 16896

701 CEDAR LAKE BLVD  
OKLAHOMA CITY, OK 73114-7800

Completion Type	
X	Single Zone
	Multiple Zone
	Commingled

Location Exception
Order No
There are no Location Exception records to display.

Increased Density
Order No
There are no Increased Density records to display.

Casing and Cement							
Type	Size	Weight	Grade	Feet	PSI	SAX	Top of CMT
SURFACE	13 3/8	48	J-55	630		640	SURFACE
SURFACE	9 5/8	36	J-55	1503		510	SURFACE
INTERMEDIATE	7	26	J-55	6770		230	4403

Liner								
Type	Size	Weight	Grade	Length	PSI	SAX	Top Depth	Bottom Depth
There are no Liner records to display.								

**Total Depth: 8017**

Packer	
Depth	Brand & Type
6720	T440

Plug	
Depth	Plug Type
There are no Plug records to display.	

Initial Test Data
-------------------

Test Date	Formation	Oil BBL/Day	Oil-Gravity (API)	Gas MCF/Day	Gas-Oil Ratio Cu FT/BBL	Water BBL/Day	Pumpin or Flowing	Initial Shut- In Pressure	Choke Size	Flow Tubing Pressure
-----------	-----------	----------------	----------------------	----------------	----------------------------	------------------	----------------------	---------------------------------	---------------	-------------------------

There are no Initial Data records to display.

Completion and Test Data by Producing Formation

Formation Name: ARBUCKLE                      Code: 169ABCK                      Class: DISP

Spacing Orders		Perforated Intervals	
Order No	Unit Size	From	To
There are no Spacing Order records to display.		There are no Perf. Intervals records to display.	
Acid Volumes		Fracture Treatments	
10,000 GALLONS 15% HCL		There are no Fracture Treatments records to display.	

Formation	Top
HUNTON	6322
ARBUCKLE	6714

Were open hole logs run? Yes  
Date last log run: October 04, 2013  
  
Were unusual drilling circumstances encountered? No  
Explanation:

Other Remarks
UIC PERMIT NUMBER 1401810013. THIS WELL IS AN OPEN HOLE COMPLETION FROM THE BOTTOM OF THE 7" CASING SET AT 6,770' TO TOTAL DEPTH AT 8,017'.

FOR COMMISSION USE ONLY	
Status: Accepted	1138018

API NO.  
**35-151-23966**  
OTC PROD. UNIT NO.

PLEASE TYPE OR USE BLACK INK ONLY  
NOTE:  
Attach copy of original 1002A if recompletion or reentry.

OKLAHOMA CORPORATION COMMISSION  
Oil & Gas Conservation Division  
Post Office Box 52000  
Oklahoma City, Oklahoma 73152-2000  
Rule 165:10-3-25

**RECEIVED**

Form 1002A  
Rev. 2007

OCT 23 2017

OKLAHOMA CORPORATION  
COMMISSION

640 Acres

LOCATE WELL

ORIGINAL  
x AMENDED  
Reason Amended **Adding formations**  
TYPE OF DRILLING OPERATION  
x STRAIGHT HOLE DIRECTIONAL HOLE HORIZONTAL HOLE  
x SERVICE WELL  
If directional or horizontal, see reverse for bottom hole location.

COUNTY **Woods** SEC **13** TWP **27N** RGE **16W**  
LEASE NAME **Oi' Faithful SWD** WELL NO. **13**  
SHL **E2** 1/4 SE 1/4 SE 1/4 SE 1/4 FSL **330** FEL OF 1/4 SEC **250**  
ELEVATION **Ground** Latitude if Known Longitude if Known  
Derrick Fl  
OPERATOR NAME **CHAPARRAL ENERGY, L.L.C.** OTC/OCC OPERATOR NO. **16896**  
ADDRESS **701 CEDAR LAKE BLVD.**  
CITY **OKLAHOMA CITY** STATE **OK** ZIP **73114**

COMPLETION TYPE  
x SINGLE ZONE  
MULTIPLE ZONE  
Application Date  
COMINGLED  
Application Date  
LOCATION EXCEPTION ORDER NO.  
INCREASED DENSITY ORDER NO.

CASING & CEMENT (Form 1002C must be attached)

TYPE	SIZE	WEIGHT	GRADE	FEET	PSI	SAX	TOP
Conductor							
Surface	13 3/8	48	J-55	630		640	Surface
Surface	9 5/8	36	J-55	1503		510	Surface
Intermediate	7	26	J-55	6770		230	4403
Liner							

PACKER @ **6720** BRAND & TYPE **T440** PLUG @ TYPE PLUG @ TYPE TOTAL DEPTH **8017**  
PACKER @ BRAND & TYPE PLUG @ TYPE PLUG @ TYPE

COMPLETION & TEST DATA BY PRODUCING FORMATION

**4697 ABLL**

FORMATION	<b>Aurbuckle</b>
SPACING & SPACING	<b>no spacing</b>
ORDER NUMBER	
CLASS: Oil, Gas, Dry, Inj, Disp, Comm Disp, Svc	<b>Disp</b>
PERFORATED INTERVALS	<b>open hole</b>
ACID/VOLUME	<b>10,000 gal 15% HCL</b>
Fracture Treatment (Fluids/Prop Amounts)	

Request minimum gas allowable (165:10-17-7)	Gas Purchaser/Measurer	1st Sales Date
INITIAL TEST DATA		
INITIAL TEST DATE		
OIL-BBL/DAY		
OIL-GRAVITY ( API)		
GAS-MCF/DAY		
GAS-OIL RATIO CU FT/BBL		
WATER-BBL/DAY		
PUMPING OR FLOWING		
INITIAL SHUT-IN PRESSURE		
CHOKE SIZE		
FLOW TUBING PRESSURE		

**AS SUBMITTED**

A record of the formations drilled through, and pertinent remarks are presented on the reverse. I declare that I have knowledge of the contents of this report and am authorized by my organization to make this report, which was prepared by me or under my supervision and direction, with the data and facts stated herein to be true, correct, and complete to the best of my knowledge and belief.

**Chacie Norton** Chacie Norton - Engineer Tech **10-17-17** 405.478.8770  
SIGNATURE NAME (PRINT OR TYPE) DATE PHONE NUMBER  
701 CEDAR LAKE BLVD., OKLAHOMA CITY OK 73114 **chacie.norton@chaparralenergy.com**  
ADDRESS CITY STATE ZIP EMAIL ADDRESS

PLEASE TYPE OR USE BLACK INK ONLY  
FORMATION RECORD

Give formation names and tops, if available, or descriptions and thickness of formations drilled through. Show intervals cored or drillstem tested.

LEASE NAME

Ol' Faithful SWD

WELL NO. 13

NAMES OF FORMATIONS	TOP
Hunton	6322
Arbuckle	6714

FOR COMMISSION USE ONLY	
ITD on file	<input type="checkbox"/> YES <input type="checkbox"/> NO
APPROVED	DISAPPROVED
2) Reject Codes	

Were open hole logs run?	<input checked="" type="checkbox"/> yes	<input type="checkbox"/> no
Date Last log was	10/4/2013	
Was CO <sub>2</sub> encountered?	<input type="checkbox"/> yes	<input checked="" type="checkbox"/> no at what deptns?
Was H <sub>2</sub> S encountered?	<input type="checkbox"/> yes	<input checked="" type="checkbox"/> no at what deptns?
Were unusual drilling circumstances encountered?	<input type="checkbox"/> yes	<input checked="" type="checkbox"/> no
If yes, briefly explain.		

UIC permit number 1401810013. This well is an open hole completion from the bottom of the 7" casing set at 6770' to TD at 8017'.

640 Acres

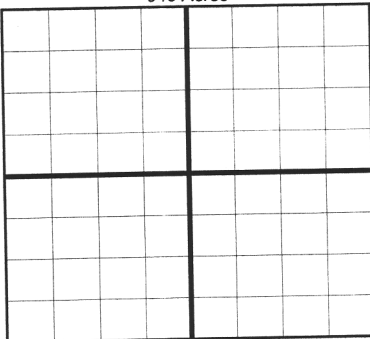

If more than three drainholes are proposed, attach a separate sheet indicating the necessary information.

Direction must be stated in degrees azimuth. Please note, the horizontal drainhole and its end point must be located within the boundaries of the lease or spacing unit.

Directional surveys are required for all drainholes and directional wells.

640 Acres

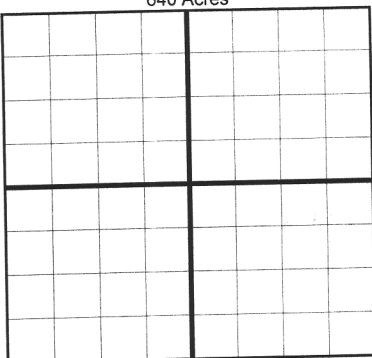

BOTTOM HOLE LOCATION FOR DIRECTIONAL HOLE

SEC	TWP	RGE	COUNTY
Spot Location	1/4	1/4	1/4
Measured Total Depth	True Vertical Depth		Feet From 1/4 Sec Lines FSL FWL
BHL From Lease, Unit, or Property Line:			

BOTTOM HOLE LOCATION FOR HORIZONTAL HOLE: (LATERALS)

LATERAL #1			
SEC	TWP	RGE	COUNTY
Spot Location	1/4	1/4	1/4
Depth of Deviation	Radius of Turn		Feet From 1/4 Sec Lines FNL FWL
Measured Total Depth	True Vertical Depth		Direction Total Length
End Pt Location From Lease, Unit or Property Line:			

LATERAL #2

SEC	TWP	RGE	COUNTY
Spot Location	1/4	1/4	1/4
Depth of Deviation	Radius of Turn		Feet From 1/4 Sec Lines FSL FWL
Measured Total Depth	True Vertical Depth		Direction Total Length
End Pt Location From Lease, Unit or Property Line:			

LATERAL #3

SEC	TWP	RGE	COUNTY
Spot Location	1/4	1/4	1/4
Depth of Deviation	Radius of Turn		Feet From 1/4 Sec Lines FSL FWL
Measured Total Depth	True Vertical Depth		Direction Total Length
End Pt Location From Lease, Unit or Property Line:			