

Oklahoma Corporation Commission
Oil & Gas Conservation Division
Post Office Box 52000
Oklahoma City, Oklahoma 73152-2000
Rule 165: 10-3-25

Form 1002A

API No.: 35019248110001

Completion Report

Spud Date: May 03, 2003

OTC Prod. Unit No.: 019-111328

Drilling Finished Date: May 12, 2003

Amended

1st Prod Date: June 21, 2003

Amend Reason: PLUGGED AND ABANDONED

Completion Date: June 21, 2003

Recomplete Date: October 20, 2017

Drill Type: STRAIGHT HOLE

Well Name: FAMILY TRUST 1-1

Purchaser/Measurer:

Location: CARTER 1 3S 1E
S2 N2 SE NE
746 FSL 1980 FWL of 1/4 SEC
Derrick Elevation: 0 Ground Elevation: 902

First Sales Date:

Operator: XTO ENERGY INC 21003

810 HOUSTON ST
FORT WORTH, TX 76102-6203

| Completion Type | | Location Exception | | Increased Density | |
|-----------------|---------------|---|--|--|--|
| X | Single Zone | Order No | | Order No | |
| | Multiple Zone | There are no Location Exception records to display. | | There are no Increased Density records to display. | |
| | Commingled | | | | |

| Casing and Cement | | | | | | | |
|-------------------|-------|--------|-------|------|-----|-----|------------|
| Type | Size | Weight | Grade | Feet | PSI | SAX | Top of CMT |
| SURFACE | 9 5/8 | 36 | J-55 | 347 | | 200 | SURFACE |
| PRODUCTION | 5 1/2 | 17 | J-55 | 3799 | | 145 | 2536 |

| Liner | | | | | | | | |
|--|------|--------|-------|--------|-----|-----|-----------|--------------|
| Type | Size | Weight | Grade | Length | PSI | SAX | Top Depth | Bottom Depth |
| There are no Liner records to display. | | | | | | | | |

Total Depth: 4300

| Packer | |
|---|--------------|
| Depth | Brand & Type |
| There are no Packer records to display. | |

| Plug | |
|---------------------------------------|-----------|
| Depth | Plug Type |
| There are no Plug records to display. | |

| Initial Test Data | | | | | | | | | | |
|-------------------|-----------|-------------|-------------------|-------------|-------------------------|---------------|-------------------|--------------------------|------------|----------------------|
| Test Date | Formation | Oil BBL/Day | Oil-Gravity (API) | Gas MCF/Day | Gas-Oil Ratio Cu FT/BBL | Water BBL/Day | Pumpin or Flowing | Initial Shut-In Pressure | Choke Size | Flow Tubing Pressure |
| Oct 20, 2017 | SPRINGER | | | | | | | | | |

| Completion and Test Data by Producing Formation | | | |
|---|------------------|---|-------------------------|
| Formation Name: SPRINGER | | Code: 401SPRG | Class: PLUG AND ABANDON |
| Spacing Orders | | Perforated Intervals | |
| Order No | Unit Size | From | To |
| 189704 | 160 | 3606 | 3616 |
| Acid Volumes | | Fracture Treatments | |
| There are no Acid Volume records to display. | | 1,256 BARRELS GEL, 120,000 POUNDS 20/40 | |

| | |
|------------------|------------|
| Formation | Top |
|------------------|------------|

Were open hole logs run? No
Date last log run:

Were unusual drilling circumstances encountered? No
Explanation:

| |
|----------------------|
| Other Remarks |
| IRREGULAR SECTION |

| FOR COMMISSION USE ONLY | |
|-------------------------|---------|
| Status: Accepted | 1138052 |

RECEIVED

OCT 27 2017

Form 1002A
Rev. 2009

API NO. 019-24811
OTC PROD. UNIT NO. 019-111328

PLEASE TYPE OR USE BLACK INK ONLY
NOTE:

Attach copy of original 1002A
if recompletion or reentry.

OKLAHOMA CORPORATION COMMISSION
Oil & Gas Conservation Division
Post Office Box 52000
Oklahoma City, Oklahoma 73152-2000
Rule 165:10-3-25

OKLAHOMA CORPORATION
COMMISSION

☐ ORIGINAL
☒ AMENDED (Reason)

Plugged and Abandoned

COMPLETION REPORT

TYPE OF DRILLING OPERATION
☒ STRAIGHT HOLE ☐ DIRECTIONAL HOLE ☐ HORIZONTAL HOLE
☐ SERVICE WELL
If directional or horizontal, see reverse for bottom hole location.

COUNTY Carter SEC 1 TWP 3S RGE 1E
LEASE NAME Family Trust
S2 1/4 NE 1/4 SE 1/4 NE 1/4 FSL OF 1/4 SEC 746 FWL OF 1/4 SEC 1980
ELEVATION N Derrick Ground 902 Latitude (if known)
OPERATOR NAME XTO Energy Inc. OTC/OCC OPERATOR NO. 21003
ADDRESS 210 Park Avenue, Suite 2350
CITY Oklahoma City STATE Oklahoma ZIP 73102

SPUD DATE 5/3/03
DRLG FINISHED DATE 5/12/03
DATE OF WELL COMPLETION 6/21/03
1st PROD DATE 6/21/03
RECOMP DATE 10-20-2017
Longitude (if known)
OTC/OCC OPERATOR NO. 21003

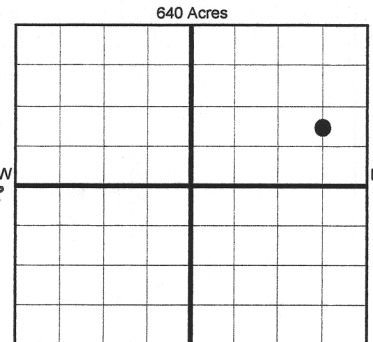

COMPLETION TYPE

☒ SINGLE ZONE
☐ MULTIPLE ZONE
Application Date
COMINGLED
Application Date
LOCATION
EXCEPTION ORDER
INCREASED DENSITY
ORDER NO.

CASING & CEMENT (Form 1002C must be attached)

| TYPE | SIZE | WEIGHT | GRADE | FEET | PSI | SAX | TOP OF CMT |
|--------------|--------|--------|-------|-------|-----|-------------|------------|
| CONDUCTOR | | | | | | | |
| SURFACE | 9 5/8" | 36# | J-55 | 347 | | 200 | Surface |
| INTERMEDIATE | | | | | | | |
| PRODUCTION | 5 1/2" | 17# | J-55 | 3,799 | | 145 | 2536 |
| LINER | | | | | | | |
| | | | | | | TOTAL DEPTH | 4300' |

PACKER @ _____ BRAND & TYPE _____ PLUG @ _____ TYPE _____ PLUG @ _____ TYPE _____
PACKER @ _____ BRAND & TYPE _____ PLUG @ _____ TYPE _____ PLUG @ _____ TYPE _____

COMPLETION & TEST DATA BY PRODUCING FORMATION

| | | | | | | | |
|---|---------------------------------|--|--|--|--|--|--|
| FORMATION | Springer | | | | | | |
| SPACING & SPACING ORDER NUMBER | 160: 189704 | | | | | | |
| CLASS: Oil, Gas, Dry, Inj, Disp, Comm Disp, Svc | Gas P&A | | | | | | |
| PERFORATED INTERVALS | 3606-3616 | | | | | | |
| ACID/VOLUME | | | | | | | |
| FRACTURE TREATMENT (Fluids/Prop Amounts) | 1256 bbls gel 120,000# 20/40 | | | | | | |

Min Gas Allowable (165:10-17-7)

Gas Purchaser/Measurer
First Sales Date

Oil Allowable (165:10-13-3)

INITIAL TEST DATA

| | | | | | | | |
|--------------------------|------------------|--|--|--|--|--|--|
| INITIAL TEST DATE | P&A'd 10/20/2017 | | | | | | |
| OIL-BBL/DAY | | | | | | | |
| OIL-GRAVITY (API) | | | | | | | |
| GAS-MCF/DAY | | | | | | | |
| GAS-OIL RATIO CU FT/BBL | | | | | | | |
| WATER-BBL/DAY | | | | | | | |
| PUMPING OR FLOWING | | | | | | | |
| INITIAL SHUT-IN PRESSURE | | | | | | | |
| CHOKE SIZE | | | | | | | |
| FLOW TUBING PRESSURE | | | | | | | |

AS SUBMITTED

A record of the formations drilled through, and pertinent remarks are presented on the reverse. I declare that I have knowledge of the contents of this report and am authorized by my organization to make this report, which was prepared by me or under my supervision and direction, with the data and facts stated herein to be true, correct, and complete to the best of my knowledge and belief.

Signature: Debbie Waggoner NAME (PRINT OR TYPE) Debbie Waggoner DATE 10/25/2017 PHONE NUMBER 405-319-3243
ADDRESS 210 Park Avenue, Suite 2350 CITY Oklahoma City STATE Ok ZIP 73102 EMAIL ADDRESS debbie_waggoner@xtoenergy.com

Give formation names and tops, if available, or descriptions and thickness of formations drilled through. Show intervals cored or drillstem tested.

Give formation names and tops, if available, or descriptions and thickness of formations drilled through. Show intervals cored or drillstem tested.

LEASE NAME Family Trust WELL NO. 1-1

| FOR COMMISSION USE ONLY | |
|---|--|
| ITD on file | <input type="checkbox"/> YES <input type="checkbox"/> NO |
| APPROVED | DISAPPROVED |
| <div>2) Reject Codes</div> <div> <div></div> <div></div> <div></div> <div></div> <div></div> </div> | |

Were open hole logs run? ___ yes X no
Date Last log was run _____
Was CO₂ encountered? ___ yes X no at what depths? _____
Was H₂S encountered? ___ yes X no at what depths? _____
Were unusual drilling circumstances encountered? ___ yes X no
If yes, briefly explain below _____

| | |
|----------------|-------------------|
| Other remarks: | Irregular Section |
| | |
| | |
| | |
| | |

640 Acres

A 10x10 grid representing 640 acres. The grid is divided into four 5x5 quadrants by a thick black cross. The text '640 Acres' is centered at the top of the grid.

If more than three drainholes are proposed, attach a separate sheet indicating the necessary information

Direction must be stated in degrees azimuth.
Please note, the horizontal drainhole and its end
point must be located within the boundaries of the
lease or spacing unit.

Directional surveys are required for all drainholes and directional wells.

640 Acres

| | | | | | |
|----------------------|-----|---------------------|---|-----|-----|
| SEC | TWP | RGE | COUNTY | | |
| Spot Location | | | Feet From 1/4 Sec Lines | FSL | FWL |
| 1/4 | 1/4 | 1/4 | 1/4 | | |
| Measured Total Depth | | True Vertical Depth | BHL From Lease, Unit, or Property Line: | | |
| | | | | | |

| LATERAL #1 | | | | | |
|----------------------|-----|---------------------|---|--------------|-----|
| SEC | TWP | RGE | COUNTY | | |
| Spot Location | | | | | |
| 1/4 | 1/4 | 1/4 | Feet From 1/4 Sec Lines | FSL | FWL |
| Depth of Deviation | | Radius of Turn | Direction | Total Length | |
| Measured Total Depth | | True Vertical Depth | BHL From Lease, Unit, or Property Line: | | |

| | | | | | | |
|----------------------|-----|---------------------|---|-------------------------|-----|-----|
| SEC | TWP | RGE | COUNTY | | | |
| Spot Location | | | | Feet From 1/4 Sec Lines | FSL | FWL |
| 1/4 | 1/4 | 1/4 | 1/4 | | | |
| Depth of Deviation | | Radius of Turn | Direction | Total Length | | |
| Measured Total Depth | | True Vertical Depth | BHL From Lease, Unit, or Property Line: | | | |

| LATERAL #3 | | | | | | |
|----------------------|-----|---------------------|---|-------------------------|-----|-----|
| SEC | TWP | RGE | COUNTY | | | |
| Spot Location | | | | | | |
| 1/4 | 1/4 | 1/4 | 1/4 | Feet From 1/4 Sec Lines | FSL | FWL |
| Depth of Deviation | | Radius of Turn | Direction | Total Length | | |
| Measured Total Depth | | True Vertical Depth | BHL From Lease, Unit, or Property Line: | | | |