

Oklahoma Corporation Commission
Oil & Gas Conservation Division
Post Office Box 52000
Oklahoma City, Oklahoma 73152-2000
Rule 165: 10-3-25

Form 1002A

API No.: 35073200220003

Completion Report

Spud Date: January 09, 1995

OTC Prod. Unit No.:

Drilling Finished Date: February 07, 1995

Amended

1st Prod Date: March 11, 1995

Amend Reason: RECOMPLETE AS AN INJECTOR FOR LINCOLN NORTH UNIT / RUN 4 1/2" LINER

Completion Date: June 27, 1995

Recomplete Date: December 02, 2016

Drill Type: HORIZONTAL HOLE

SERVICE WELL

Well Name: LINCOLN NORTH UNIT (BRENT WILLIAMS 1) 46-1HZ

Purchaser/Measurer:

Location: KINGFISHER 34 18N 5W
C SW NW
660 FSL 660 FWL of 1/4 SEC
Latitude: 35.994307 Longitude: -97.72671
Derrick Elevation: 1128 Ground Elevation: 1116

First Sales Date:

Operator: HINKLE OIL & GAS INC 21639

5600 N MAY AVE STE 295
OKLAHOMA CITY, OK 73112-4275

Completion Type		Location Exception		Increased Density	
	Single Zone	Order No		Order No	
	Multiple Zone	There are no Location Exception records to display.		There are no Increased Density records to display.	
	Commingled				

Casing and Cement								
Type		Size	Weight	Grade	Feet	PSI	SAX	Top of CMT
SURFACE		8 5/8	24	J-55	325		275	SURFACE
PRODUCTION		5 1/2	17	K-55	6650		320	4510

Liner								
Type	Size	Weight	Grade	Length	PSI	SAX	Top Depth	Bottom Depth
LINER	4 1/2	11.6	FL-4S	0	0	125	SURFACE	6130
LINER	3 1/2	9.3	J-55	2329	0	0	6581	8910

Total Depth: 9298

Packer		Plug	
Depth	Brand & Type	Depth	Plug Type
6115	AS-1X	There are no Plug records to display.	

Initial Test Data

Test Date	Formation	Oil BBL/Day	Oil-Gravity (API)	Gas MCF/Day	Gas-Oil Ratio Cu FT/BBL	Water BBL/Day	Pumpin or Flowing	Initial Shut- In Pressure	Choke Size	Flow Tubing Pressure
-----------	-----------	----------------	----------------------	----------------	----------------------------	------------------	----------------------	---------------------------------	---------------	-------------------------

There are no Initial Data records to display.

Completion and Test Data by Producing Formation

Formation Name: BIG LIME-OSWEGO

Code: 404BGLO

Class: INJ

Spacing Orders

Order No	Unit Size
119248	UNIT
128371	UNIT

Perforated Intervals

From	To
6143	6244
6307	6344
6433	6443

Acid Volumes

3,000 GALLONS 15% NEFE HCL

Fracture Treatments

30,000 GALLONS 20% GELLED ACID, 550 BARRELS SLICK 2% KCL WATER

Formation Name: BIG LIME-OSWEGO

Code: 404BGLO

Class: INJ

Spacing Orders

Order No	Unit Size
119248	UNIT
128371	UNIT

Perforated Intervals

From	To
There are no Perf. Intervals records to display.	

Acid Volumes

2,500 GALLONS 15% NEFE HCL

Fracture Treatments

60,000 GALLONS 20% GELLED ACID, 3,680 BARRELS SLICK WATER
--

Formation	Top
-----------	-----

Were open hole logs run? No

Date last log run:

Were unusual drilling circumstances encountered? No

Explanation:

Other Remarks

THIS WELL WAS RECOMPLETED AS AN INJECTOR FOR THE LINCOLN NORTH UNIT - 119269. INJECTION ORDER NUMBER 1701740064. OCC - (SEE 1002C NOVEMBER 29, 2016) OPERATOR SQUEEZED CEMENT ON 4 1/2" CASING FROM 6,130' TO SURFACE, USING 125 SACKS OF CEMENT. THIS WELL IS AN OPEN HOLE COMPLETION FROM BOTTOM OF THE 5 1/2" CASING AT 6,650' TO TERMINUS AT 9,298'. THE 3 1/2" LINER IS NOT CEMENTED.

Lateral Holes

Sec: 28 TWP: 18N RGE: 5W County: KINGFISHER

SE SW SE

620 FSL 1120 FWL of 1/4 SEC

Depth of Deviation: 5757 Radius of Turn: 198 Direction: 0 Total Length: 3343

Measured Total Depth: 9298 True Vertical Depth: 6175 End Pt. Location From Release, Unit or Property Line: 4620

FOR COMMISSION USE ONLY

1138043

Status: Accepted

API NO. 073-20022
OTC PROD.
UNIT NO.

PLEASE TYPE OR USE BLACK INK ONLY
NOTE:

Attach copy of original 1002A
if recompletion or reentry.

OKLAHOMA CORPORATION COMMISSION
Oil & Gas Conservation Division
Post Office Box 52000
Oklahoma City, Oklahoma 73152-2000
Rule 165:10-3-25

RECEIVED

OCT 27 2017

OKLAHOMA CORPORATION
COMMISSION

Form 1002A
Rev. 2009

☐ ORIGINAL
☒ AMENDED (Reason)

Recomplete as an Injector for LNU / Run 4 1/2 Lines

COMPLETION REPORT

TYPE OF DRILLING OPERATION

☐ STRAIGHT HOLE ☐ DIRECTIONAL HOLE ☒ HORIZONTAL HOLE
☒ SERVICE WELL

If directional or horizontal, see reverse for bottom hole location.

COUNTY	Kingfisher	SEC	34	TWP	18N	RGE	05W
LEASE NAME	Lincoln North Unit			WELL NO.	46-1HZ		
C	1/4 SW	1/4 NW	1/4	FSL OF 1/4 SEC	660'	FWL OF 1/4 SEC	660'
ELEVATION Derrick	1128'	Ground	1116'	Latitude (if known)	35.994307		
OPERATOR NAME	Hinkle Oil & Gas, Inc.			OTC/OCC OPERATOR NO.	21639		
ADDRESS	5600 N. May Avenue, Suite 295						
CITY	Oklahoma City	STATE	OK	ZIP	73112		

SPUD DATE	1/9/95
DRLG FINISHED DATE	2/7/95
DATE OF WELL COMPLETION	6/27/95
1st PROD DATE	3/11/95
RECOMP DATE	12/2/2016
Longitude (if known)	- 97.72671

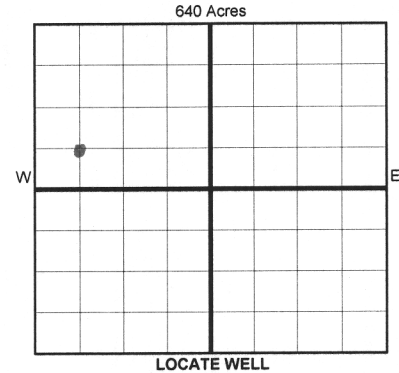

COMPLETION TYPE

<input type="checkbox"/> SINGLE ZONE
<input type="checkbox"/> MULTIPLE ZONE
<input type="checkbox"/> Application Date
<input type="checkbox"/> COMMINGLED
<input type="checkbox"/> Application Date
LOCATION
EXCEPTION ORDER
INCREASED DENSITY
ORDER NO.

CASING & CEMENT (Form 1002C must be attached)

TYPE	SIZE	WEIGHT	GRADE	FEET	PSI	SAX	TOP OF CMT
CONDUCTOR							
SURFACE	8 5/8"	24#	J-55	325'		275	Surface
INTERMEDIATE LINES	3 1/2"	9.3	J-55	6581-8910		FS	
PRODUCTION	5 1/2"	17#	K-55	6650'		320	4510'
LINER	4 1/2"	11.6#	FL4S	SURFACE 6130'		125	
TOTAL DEPTH						9298' (MTD)	

PACKER @ 6115' BRAND & TYPE AS-1X PLUG @ TYPE PLUG @ TYPE
PACKER @ BRAND & TYPE PLUG @ TYPE PLUG @ TYPE

COMPLETION & TEST DATA BY PRODUCING FORMATION

FORMATION	Big Lime/Oswego	Big Lime/Oswego	2nd Oswego	3rd Oswego	4th Oswego	Old Fracs
SPACING & SPACING ORDER NUMBER	1701740004	119248, 128371	119248, 128371	119248, 128371	119248, 128371	(unit) all
CLASS: Oil, Gas, Dry, Inj, Disp, Comm Disp, Svc	Injection	Oil	Oil	Oil	Oil	
PERFORATED INTERVALS	(See Across)	6143' - 6244'	6307' - 6344'	6433-6443	6650-8910	
ACID/VOLUME						
FRACTURE TREATMENT (Fluids/Prop Amounts)	(See Information)	3000 G. 15%	NE-Fe-HCL	2500 G. 15%	NE-Fe-HCL	
		30000 G. 20%	Gelled Acid	60000 G. 20%	Gelled Acid	
	Across)	550 Bbl. Slick	2% KCL Wtr	3680 Bbl. Slick	Water	

Min Gas Allowable (165:10-17-7) Gas Purchaser/Measurer
OR
Oil Allowable (165:10-13-3) First Sales Date

INITIAL TEST DATA

INITIAL TEST DATE	N/A
OIL-BBL/DAY	
OIL-GRAVITY (API)	
GAS-MCF/DAY	
GAS-OIL RATIO CU FT/BBL	
WATER-BBL/DAY	
PUMPING OR FLOWING	
INITIAL SHUT-IN PRESSURE	
CHOKE SIZE	
FLOW TUBING PRESSURE	

AS SUBMITTED

A record of the formations drilled through, and pertinent remarks are presented on the reverse. I declare that I have knowledge of the contents of this report and am authorized by my organization to make this report, which was prepared by me or under my supervision and direction, with the data and facts stated herein to be true, correct, and complete to the best of my knowledge and belief.

SIGNATURE	Laura A. Hinkle	DATE	10/26/2017	PHONE NUMBER	405-848-0924
ADDRESS	5600 N. May Avenue, Suite 295	CITY	Oklahoma City	STATE	OK
		ZIP	73112	EMAIL ADDRESS	Laurahinkle@hoagi.com

LATERAL #3						
SEC	TWP	RGE	COUNTY			
Spot Location				Feet From 1/4 Sec Lines	FSL	FWL
1/4	1/4	1/4	1/4			
Depth of Deviation		Radius of Turn	Direction	Total Length		
Measured Total Depth		True Vertical Depth	BHL From Lease, Unit, or Property Line:			