

OKLAHOMA CORPORATION COMMISSION
OIL & GAS CONSERVATION DIVISION
P.O. BOX 52000
OKLAHOMA CITY, OK 73152-2000
(Rule 165:10-3-1)

API NUMBER: 093 25177

Approval Date: 11/16/2018

Expiration Date: 05/16/2020

Horizontal Hole Oil & Gas

PERMIT TO DRILL

WELL LOCATION: Sec: 29 Twp: 20N Rge: 10W

County: MAJOR

SPOT LOCATION: ☐ SW ☐ SE ☐ SW ☐ SE

FEET FROM QUARTER: FROM SOUTH FROM EAST

SECTION LINES: 223 1737

Lease Name: DRAKE

Well No: 2-29H

Well will be 223 feet from nearest unit or lease boundary.

Operator Name: HUSKY VENTURES INC

Telephone: 4056009393

OTC/OCC Number: 20434 0

HUSKY VENTURES INC
5800 NW 135TH ST
OKLAHOMA CITY, OK 73142-5938

REEVES REVOCABLE LIVING TRUST
51 FORTUNA EAST
IRVINE CA 92620

Formation(s) (Permit Valid for Listed Formations Only):

	Name	Depth	Name	Depth
1	WOODFORD	8320	6	
2	HUNTON	8360	7	
3			8	
4			9	
5			10	

Spacing Orders: 651456

Location Exception Orders: 686380

Increased Density Orders: 684123

Pending CD Numbers: 201809736

Special Orders:

Total Depth: 13670

Ground Elevation: 1213

Surface Casing: 420

Depth to base of Treatable Water-Bearing FM: 370

Under Federal Jurisdiction: No

Fresh Water Supply Well Drilled: No

Surface Water used to Drill: No

PIT 1 INFORMATION

Approved Method for disposal of Drilling Fluids:

Type of Pit System: CLOSED Closed System Means Steel Pits

Type of Mud System: WATER BASED

Chlorides Max: 8000 Average: 5000

Is depth to top of ground water greater than 10ft below base of pit? Y

Within 1 mile of municipal water well? N

Wellhead Protection Area? N

Pit is located in a Hydrologically Sensitive Area.

Category of Pit: C

Liner not required for Category: C

Pit Location is BED AQUIFER

Pit Location Formation: CEDAR HILLS

D. One time land application -- (REQUIRES PERMIT)

PERMIT NO: 18-35389

H. CLOSED SYSTEM=STEEL PITS PER OPERATOR REQUEST

This permit does not address the right of entry or settlement of surface damages.

The duration of this permit is SIX MONTHS, except as otherwise provided by Rule 165: 10-3-1.

Rule 165: 10-3-4 (c) (7) (e) - The Operator shall give 24 Hours notice by telephone to the appropriate District Office of the Conservation Division as to when Surface Casing will be run.

HORIZONTAL HOLE 1

Sec 29 Twp 20N Rge 10W County MAJOR

Spot Location of End Point: NW NE NW NE

Feet From: NORTH 1/4 Section Line: 100

Feet From: EAST 1/4 Section Line: 1980

Depth of Deviation: 7820

Radius of Turn: 489

Direction: 355

Total Length: 4950

Measured Total Depth: 13670

True Vertical Depth: 8715

End Point Location from Lease,
Unit, or Property Line: 200

Notes:

Category

Description

HYDRAULIC FRACTURING

11/15/2018 - G71 - OCC 165:10-3-10 REQUIRES:

1) PRIOR TO COMMENCEMENT OF HYDRAULIC FRACTURING OPERATIONS FOR HORIZONTAL WELLS, NOTICE GIVEN FIVE BUSINESS DAYS IN ADVANCE TO OFFSET OPERATORS WITH WELLS COMPLETED IN THE SAME COMMON SOURCE OF SUPPLY WITHIN 1/2 MILE;

2) WITH NOTICE ALSO GIVEN 48 HOURS IN ADVANCE OF HYDRAULIC FRACTURING ALL WELLS TO BOTH THE OCC CENTRAL OFFICE AND LOCAL DISTRICT OFFICES, USING THE "FRAC NOTICE FORM" FOUND AT THE FOLLOWING LINK: OCCWEB.COM/OG/OGFORMS.HTML; AND,

3) THE CHEMICAL DISCLOSURE OF HYDRAULIC FRACTURING INGREDIENTS FOR ALL WELLS TO BE REPORTED TO FRACFOCUS WITHIN 60 DAYS AFTER THE CONCLUSION THE HYDRAULIC FRACTURING OPERATIONS, USING THE FOLLOWING LINK: FRACFOCUS.ORG

INCREASED DENSITY - 684123

11/15/2018 - G58 - E2 29-20N-10W
X651456 HNTN
1 WELL
HUSKY VENTURES, INC.
10/1/2018

LOCATION EXCEPTION - 686380

11/15/2018 - G58 - (I.O.) E2 29-20N-10W
X651456 HNTN
COMPL. INT. NCT 165' FSL, NCT 165' FNL, NCT 660' FEL
HUSKY VENTURES, INC.
11/8/2018

PENDING CD - 201809736

11/16/2018 - G58 - (E.O.) E2 29-20N-10W
X165:10-3-28(C)(2)(B) HNTN (DRAKE 2-29H)
MAY BE CLOSER THAN 600' TO THE DRAKE 1-29H WELL OPERATED BY HUSKY VENTURES, INC.
HEARING 11/26/2018 (OK PER VIRGINIA HULLINGER)

SPACING - 651456

11/15/2018 - G58 - (320) E2 29-20N-10W SU
EST WDFD, HNTN, OTHERS
COMPL. INT. (WDFD) NLT 165' FNL & FSL, NLT 330' FEL & FWL
COMPL. INT. (HNTN) NLT 660' FB
(COEXIST SP. ORDER 87189/93339 HNTN)

This permit does not address the right of entry or settlement of surface damages.

The duration of this permit is SIX MONTHS, except as otherwise provided by Rule 165: 10-3-1.

Rule 165: 10-3-4 (c) (7) (e) - The Operator shall give 24 Hours notice by telephone to the appropriate District Office of the Conservation Division as to when Surface Casing will be run.

093 25177 DRAKE 2-29H

13800 WIRELESS WAY, OKLA. CITY, OKLA. 73134 * LOCAL (405) 843-4847 * OUT OF STATE (800) 654-3219
Certificate of Authorization No. 1293 LS

County, Oklahoma

223'FSL-1737'FEL Section 29 Township 20N Range 10W I.M.

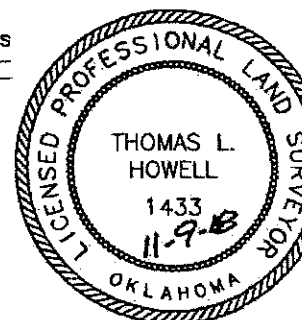

This information was gathered with a GPS receiver with ± 1 foot Horiz./Vert. accuracy.

Y: 427661