

OKLAHOMA CORPORATION COMMISSION  
OIL & GAS CONSERVATION DIVISION  
P.O. BOX 52000  
OKLAHOMA CITY, OK 73152-2000  
(Rule 165:10-3-1)

API NUMBER: 121 24827

Approval Date: 09/19/2018  
Expiration Date: 03/19/2020

Horizontal Hole Oil & Gas

PERMIT TO DRILL

WELL LOCATION: Sec: 17 Twp: 7N Rge: 18E County: PITTSBURG  
SPOT LOCATION: ☐ SE ☐ NE ☐ NW ☐ NE FEET FROM QUARTER: FROM NORTH FROM EAST  
SECTION LINES: 580 1530

Lease Name: CARNEY Well No: 2-8/5H Well will be 580 feet from nearest unit or lease boundary.  
Operator Name: TRINITY OPERATING (USG) LLC Telephone: 9185615600 OTC/OCC Number: 23879 0

TRINITY OPERATING (USG) LLC  
1717 S BOULDER AVE STE 201  
TULSA, OK 74119-4842

ISSAC EDWARD & ALICE PRYOR  
P.O. BOX 708  
QUINTON OK 74561

Formation(s) (Permit Valid for Listed Formations Only):

	Name	Depth	Name	Depth
1	WOODFORD	7705	6	
2			7	
3			8	
4			9	
5			10	

Spacing Orders: 665456  
673857

Location Exception Orders: 673858

Increased Density Orders:

Pending CD Numbers:

Special Orders:

Total Depth: 18555

Ground Elevation: 612

**Surface Casing: 160**

Depth to base of Treatable Water-Bearing FM: 110

Under Federal Jurisdiction: No

Fresh Water Supply Well Drilled: No

Surface Water used to Drill: No

PIT 1 INFORMATION

Type of Pit System: ON SITE

Type of Mud System: AIR

Is depth to top of ground water greater than 10ft below base of pit? Y

Within 1 mile of municipal water well? N

Wellhead Protection Area? N

Pit is located in a Hydrologically Sensitive Area.

Category of Pit: 4

Liner not required for Category: 4

Pit Location is ALLUVIAL

Pit Location Formation: ALLUVIUM

Mud System Change to Water-Based or Oil-Based Mud Requires an Amended Intent (Form 1000).

Approved Method for disposal of Drilling Fluids:

A. Evaporation/dewater and backfilling of reserve pit.

B. Solidification of pit contents.

E. Haul to Commercial pit facility: Sec. 19 Twn. 8N Rng. 5E Cnty. 125 Order No: 274874

H. SEE MEMO

This permit does not address the right of entry or settlement of surface damages.

The duration of this permit is SIX MONTHS, except as otherwise provided by Rule 165: 10-3-1.

Rule 165: 10-3-4 (c) (7) (e) - The Operator shall give 24 Hours notice by telephone to the appropriate District Office of the Conservation Division as to when Surface Casing will be run.

#### PIT 2 INFORMATION

Type of Pit System: CLOSED Closed System Means Steel Pits

Type of Mud System: WATER BASED

Chlorides Max: 8000 Average: 5000

Is depth to top of ground water greater than 10ft below base of pit? Y

Within 1 mile of municipal water well? N

Wellhead Protection Area? N

Pit is located in a Hydrologically Sensitive Area.

**Category of Pit: C**

**Liner not required for Category: C**

Pit Location is ALLUVIAL

Pit Location Formation: ALLUVIUM

#### PIT 3 INFORMATION

Type of Pit System: CLOSED Closed System Means Steel Pits

Type of Mud System: OIL BASED

Chlorides Max: 300000 Average: 200000

Is depth to top of ground water greater than 10ft below base of pit? Y

Within 1 mile of municipal water well? N

Wellhead Protection Area? N

Pit is located in a Hydrologically Sensitive Area.

**Category of Pit: C**

**Liner not required for Category: C**

Pit Location is ALLUVIAL

Pit Location Formation: ALLUVIUM

#### HORIZONTAL HOLE 1

Sec 05 Twp 7N Rge 18E County PITTSBURG

Spot Location of End Point: NW NW NW NE

Feet From: NORTH 1/4 Section Line: 1

Feet From: EAST 1/4 Section Line: 2590

Depth of Deviation: 7274

Radius of Turn: 573

Direction: 350

Total Length: 10381

Measured Total Depth: 18555

True Vertical Depth: 7705

End Point Location from Lease,  
Unit, or Property Line: 1

Notes:

This permit does not address the right of entry or settlement of surface damages.

The duration of this permit is SIX MONTHS, except as otherwise provided by Rule 165: 10-3-1.

Rule 165: 10-3-4 (c) (7) (e) - The Operator shall give 24 Hours notice by telephone to the appropriate District Office of the Conservation Division as to when Surface Casing will be run.

121 24827 CARNEY 2-8/5H

Category	Description
HYDRAULIC FRACTURING	<p>9/18/2018 - G71 - OCC 165:10-3-10 REQUIRES:</p> <p>1) PRIOR TO COMMENCEMENT OF HYDRAULIC FRACTURING OPERATIONS FOR HORIZONTAL WELLS, NOTICE GIVEN FIVE BUSINESS DAYS IN ADVANCE TO OFFSET OPERATORS WITH WELLS COMPLETED IN THE SAME COMMON SOURCE OF SUPPLY WITHIN 1/2 MILE;</p> <p>2) WITH NOTICE ALSO GIVEN 48 HOURS IN ADVANCE OF HYDRAULIC FRACTURING ALL WELLS TO BOTH THE OCC CENTRAL OFFICE AND LOCAL DISTRICT OFFICES, USING THE "FRAC NOTICE FORM" FOUND AT THE FOLLOWING LINK: <a href="http://OCCEWEB.COM/OG/OGFORMS.HTML">OCCEWEB.COM/OG/OGFORMS.HTML</a>; AND,</p> <p>3) THE CHEMICAL DISCLOSURE OF HYDRAULIC FRACTURING INGREDIENTS FOR ALL WELLS TO BE REPORTED TO FRACFOCUS WITHIN 60 DAYS AFTER THE CONCLUSION THE HYDRAULIC FRACTURING OPERATIONS, USING THE FOLLOWING LINK: <a href="http://FRACFOCUS.ORG">FRACFOCUS.ORG</a></p>
LOCATION EXCEPTION - 673858	<p>9/18/2018 - G75 - (I.O.) 8 &amp; 5-7N-18E  X665456 WDFD, OTHERS  COMPL. INT. (8-7N-18E) NCT 165' FSL, NCT 0' FNL, NCT 2400' FEL  COMPL. INT. (5-7N-18E) NCT 0' FSL, NCT 165' FNL, NCT 2400' FEL  TRINITY OP. (USG), LLC  2-23-2018</p>
MEMO	<p>9/18/2018 - G71 - PIT 2 &amp; 3 - CLOSED SYSTEM=STEEL PITS (REQUIRED - SAN BOIS CREEK); WBM &amp; OBM CUTTINGS CAPTURED IN CONCRETE-LINED PIT, SOLIDIFIED AND HELD UNTIL DISPOSAL APPROVED BY OCC; PIT 3 - OBM TO VENDOR</p>
SPACING - 665456	<p>9/18/2018 - G75 - (640)(HOR) 8 &amp; 5-7N-18E  EST WDFD, OTHERS  COMPL. INT. NLT 165' FNL &amp; FSL, NLT 330' FEL &amp; FWL</p>
SPACING - 673857	<p>9/18/2018 - G75 - (I.O.) 8 &amp; 5-7N-18E  EST MULTIUNIT HORIZONTAL WELL  X665456 WDFD, OTHERS  50% 8-7N-18E  50% 5-7N-18E  TRINITY OP. (USG), LLC  2-23-2018</p>

This permit does not address the right of entry or settlement of surface damages.

The duration of this permit is SIX MONTHS, except as otherwise provided by Rule 165: 10-3-1.

Rule 165: 10-3-4 (c) (7) (e) - The Operator shall give 24 Hours notice by telephone to the appropriate District Office of the Conservation Division as to when Surface Casing will be run.



Operator: TRINITY OPERATING  
Lease Name and No.: CARNEY 2-8/5H  
Footage: 580' FNL - 1530' FEL Gr. Elevation: 612'  
Section: 17 Township: 7N Range: 18E I.M.  
County: Pittsburg State of Oklahoma  
Terrain at Loc.: Location fell in mostly open pasture.

Bottom Hole Loc.:  
Lat: 35°06'59.83"N  
Lon: 95°25'42.33"W  
X: 2769014  
Y: 658769

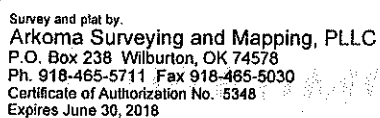
[illegible]

Invoice #7450-A  
Date Staked: 10/26/17 By: H.S.  
Date Drawn: 11/06/17 By: J.H.

This is to certify that this Well Location Plat represents the results of a survey made on the ground performed under the supervision of the undersigned.

  
LANCE G. MATHIS

11/09/17

OK LPLS 1664

