

OKLAHOMA CORPORATION COMMISSION
OIL & GAS CONSERVATION DIVISION
P.O. BOX 52000
OKLAHOMA CITY, OK 73152-2000
(Rule 165:10-3-1)

API NUMBER: 073 25894

Approval Date: 01/12/2018

Expiration Date: 07/12/2018

Horizontal Hole

Oil & Gas

PERMIT TO DRILL

WELL LOCATION: Sec: 13 Twp: 19N Rge: 8W

County: KINGFISHER

SPOT LOCATION: SW SW SW SW FEET FROM QUARTER: FROM SOUTH FROM WEST

SECTION LINES: 225 285

Lease Name: WOODROW 19-08-13

Well No: 1H

Well will be 225 feet from nearest unit or lease boundary.

Operator Name: CHISHOLM OIL & GAS OPERATING LLC

Telephone: 9184886400

OTC/OCC Number: 23991 0

CHISHOLM OIL & GAS OPERATING LLC
6100 S YALE AVE STE 1700
TULSA, OK 74136-1921

VERNON D. & RUTH N. BRECKENRIDGE
11165 STATE HIGHWAY 51
HENNESSEY OK 73742

Formation(s) (Permit Valid for Listed Formations Only):

Name	Depth	Name	Depth
1 MISSISSIPPIAN (EX CHESTER)	7426	6	
2		7	
3		8	
4		9	
5		10	

Spacing Orders: No Spacing

Location Exception Orders:

Increased Density Orders:

Pending CD Numbers: 201703967
201703968

Special Orders:

Total Depth: 13069

Ground Elevation: 1175

Surface Casing: 370

Depth to base of Treatable Water-Bearing FM: 320

Under Federal Jurisdiction: No

Fresh Water Supply Well Drilled: No

Surface Water used to Drill: No

PIT 1 INFORMATION

Approved Method for disposal of Drilling Fluids:

Type of Pit System: CLOSED Closed System Means Steel Pits

Type of Mud System: WATER BASED

Chlorides Max: 3500 Average: 1500

Is depth to top of ground water greater than 10ft below base of pit? Y

Within 1 mile of municipal water well? N

Wellhead Protection Area? N

Pit is located in a Hydrologically Sensitive Area.

Category of Pit: C

Liner not required for Category: C

Pit Location is AP/TE DEPOSIT

Pit Location Formation: TERRACE

D. One time land application -- (REQUIRES PERMIT)

PERMIT NO: 18-33728

H. CLOSED SYSTEM=STEEL PITS PER OPERATOR REQUEST

This permit does not address the right of entry or settlement of surface damages.

The duration of this permit is SIX MONTHS, except as otherwise provided by Rule 165: 10-3-1.

Rule 165: 10-3-4 (c) (7) (e) - The Operator shall give 24 Hours notice by telephone to the appropriate District Office of the Conservation Division as to when Surface Casing will be run.

HORIZONTAL HOLE 1

Sec 13 Twp 19N Rge 8W County KINGFISHER

Spot Location of End Point: N2 N2 NW NW

Feet From: NORTH 1/4 Section Line: 165

Feet From: WEST 1/4 Section Line: 660

Depth of Deviation: 6930

Radius of Turn: 1000

Direction: 5

Total Length: 4568

Measured Total Depth: 13069

True Vertical Depth: 8200

End Point Location from Lease,

Unit, or Property Line: 165

Notes:

Category

Description

HYDRAULIC FRACTURING

1/10/2018 - G71 - OCC 165:10-3-10 REQUIRES:

1) PRIOR TO COMMENCEMENT OF HYDRAULIC FRACTURING OPERATIONS FOR HORIZONTAL WELLS, NOTICE GIVEN FIVE BUSINESS DAYS IN ADVANCE TO OFFSET OPERATORS WITH WELLS COMPLETED IN THE SAME COMMON SOURCE OF SUPPLY WITHIN 1/2 MILE;

2) WITH NOTICE ALSO GIVEN 48 HOURS IN ADVANCE OF HYDRAULIC FRACTURING ALL WELLS TO BOTH THE OCC CENTRAL OFFICE AND LOCAL DISTRICT OFFICES, USING THE "FRAC NOTICE FORM" FOUND AT THE FOLLOWING LINK: OCCWEB.COM/OG/OGFORMS.HTML; AND,

3) THE CHEMICAL DISCLOSURE OF HYDRAULIC FRACTURING INGREDIENTS FOR ALL WELLS TO BE REPORTED TO FRACFOCUS WITHIN 60 DAYS AFTER THE CONCLUSION THE HYDRAULIC FRACTURING OPERATIONS, USING THE FOLLOWING LINK: FRACFOCUS.ORG

PENDING CD - 201703967

1/12/2018 - G57 - (640)(HOR) 13-19N-8W
EST MSNLC
COMPL. INT. NCT 660' FB
(COEXIST SP. ORDER #69169 MISS)
REC 12-22-2017 (JOHNSON)

PENDING CD - 201703968

1/12/2018 - G57 - (I.O.) 13-19N-8W
X201703967 MSNLC
COMPL. INT. NCT 165' FSL, NCT 165' FNL, NCT 330' FWL
NO OP. NAMED
REC 12-22-2017 (JOHNSON)

This permit does not address the right of entry or settlement of surface damages.

The duration of this permit is SIX MONTHS, except as otherwise provided by Rule 165: 10-3-1.

Rule 165: 10-3-4 (c) (7) (e) - The Operator shall give 24 Hours notice by telephone to the appropriate District Office of the Conservation Division as to when Surface Casing will be run.

073 25894 WOODROW 19-08-13 1H



Terrain at Loc.: Location fell in a wheat field, North, East and West of existing fence.

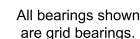

Y:13119028

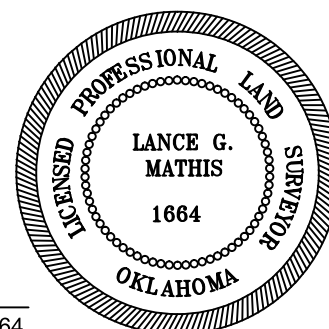

OK LPLS 1664



CHISHOLM OIL & GAS OPERATING, LLC

ROBERT M. ZINKE
CEO

Permit ex 7/12/18
Surety ex 2/08/19
operator #
23991

June 25, 2018

ATTN: Virginia Hullinger
Oklahoma Corporation Commission Oil & Gas Division
P.O. Box 52000
Oklahoma City, OK 73152-2000

RE: WOODROW 19-08-131H ✓
SEC. 13-19N-08W ✓
KINGFISHER COUNTY ✓
API #073-25894 ✓

Ms. Hullinger:

Chisholm Oil and Gas Operating, LLC (Operator #23991) respectfully requests a 6 month extension on our Permit to Drill for the above mentioned well. It is due to expire on 07/12/2018. I am enclosing a copy of the approved permit.

Please advise if you need any other documentation and thank you for your consideration.

Sincerely,

Rosaline Kinard
Regulatory Engineering Tech
rosaline.kinard@chisholmog.com
918-488-6427

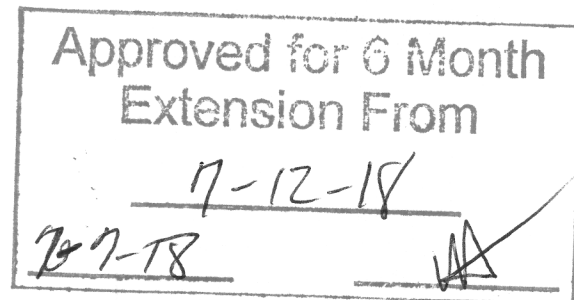

RECEIVED

JUN 26 2018

OKLAHOMA CORPORATION
COMMISSION

CHISHOLM OIL & GAS OPERATING, LLC

One Warren Place, 6100 South Yale Avenue, Suite 1700

Tulsa, Oklahoma 74136

PHONE (918) 488-6400 FAX (918) 488-6570

OIL AND GAS EXPLORATION AND PRODUCTION